

Notice before installation

- 1. Non-professionals should not open or maintain it himself to avoid damaging the sophisticated electronic components.
- 2. Please try to avoid installation the device under rain, over expose to sun or close to metal.
- 3. The actual remote control distance depends on the working environment as they are affected by interference.

Installation Methods

- 1. **For AC receiver:** Just plug receiver into standard outlet in the room, then it will work. You can choose melody you want.
- 2. **For DC receiver:** Plug in batteries, then you can choose whether to hang it up or just put it on desk.
- 3. **For Transmitter:** Please first test if the operating range you choose is working or not.

a) **Transmitter installation method 1:**
use double-side adhesive sticker to fix transmitter cover on the wall.



- b) **Transmitter installation method 2:**
Please prepare electric drill, screwdrivers
- 1. Find the hole on transmitter back cover, use slotted screwdriver to push into the hole.
 - 2. Make marks of location on wall.
 - 3. Make holes in the wall with electric drill. Then insert back cover with screws(provided in the package).
 - 4. Finally, put back front case with PCB board.

Installation Methods



Solving potential problems

1.Receiver suddenly can't get signal from transmitter.

Reason 1: Low power battery in transmitter. The less power in transmitter, the shorter range is.

Solution 1:Use a fresh new battery or plug receiver into a nearer outlet.

Reason 2: Plug of receiver is loose.

Solution 2:Re-plug your receiver.

Reason 3:Reset the receiver by accident so that transmitter is not paired with receiver any more.

Solution 3: Re-pair receiver with transmitter as below.

How to re-pair:

- 1. Press and hold the button for changing volume for 3-4 sec.
 - 2. At the same time bring the transmitter closer to the receiver, and hold down its button for a 3-4 sec. together.
- This way transmitter gets re-pair with receiver.

2. Short operating range

Reason: There are too many obstacles like walls, metal doors between receiver and transmitter

Solution: Test operating range before installation and change location.

Wireless Doorbell
User Manual

Thank you for choosing our doorbell. For better use of this product, please read operating manual carefully before installation, and according to the manual for correct installation and use.

Product Features

- Modern and Stylish design
- IP44 Waterproof transmitter (some model)
- 45 polyphony melodies
- 4 Volume adjustable (mute included)
- Over 150 meters operation range (open air)
- Easy to install and use
- Learning code function
- Low power consumption

Product List

Receiver, transmitter, screw, double-sided adhesive sticker, 12V 23A battery

Parameters

| | |
|-----------------------------|-----------------------------------|
| Voltage of plug-in receiver | AC 85-260V (US,EU,UK,AU) |
| Power consumption | transmitter:<20mA,receiver:<140mA |
| Rating of waterproof | IP44 (Model P,N) |
| Battery in push button | 12V 23A alkaline battery |
| Operating range | over 150meter in open air |
| Selectable ring tone | 45melodies |
| Volume range | 0-100dB, 4 level |
| Working frequency | 433.92MHZ |
| Working temperature | -20℃-65℃ |

Transmitter Structure

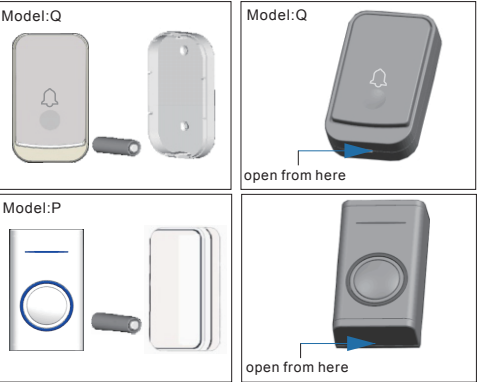

Receiver Structure

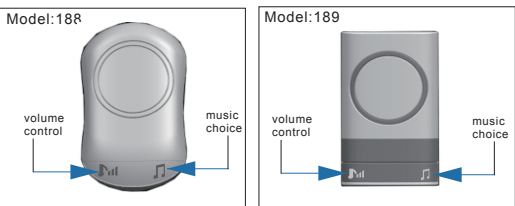

Flash light

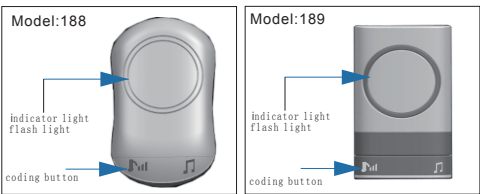

Product size

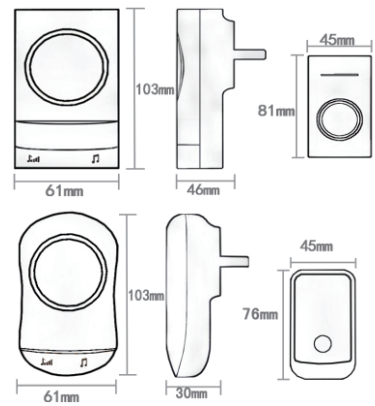

This device complies with part 15 of the FCC Rules. Operation is subject to the following two conditions: (1) This device may not cause harmful interference, and (2) this device must accept any interference received, including interference that may cause undesired operation.

Any Changes or modifications not expressly approved by the party responsible for compliance could void the user's authority to operate the equipment.

Note: This equipment has been tested and found to comply with the limits for a Class B digital device, pursuant to part 15 of the FCC Rules. These limits are designed to provide reasonable protection against harmful interference in a residential installation. This equipment generates uses and can radiate radio frequency energy and, if not installed and used in accordance with the instructions, may cause harmful interference to radio communications. However, there is no guarantee that interference will not occur in a particular installation. If this equipment does cause harmful interference to radio or television reception, which can be determined by turning the equipment off and on, the user is encouraged to try to correct the interference by one or more of the following measures:

- Reorient or relocate the receiving antenna.
- Increase the separation between the equipment and receiver.
- Connect the equipment into an outlet on a circuit different from that to which the receiver is connected.
- Consult the dealer or an experienced radio/TV technician for help.

RF warning for Portable device: The device has been evaluated to meet general RF exposure requirement. The device can be used in portable exposure condition without restriction.