

142\*205mm 风琴折页

Annaror

## SMART CEILING LIGHT WITH REMOTE & APP CONTROL

PRODUCT MODEL: LS-CL-I3-24W-Dim-APPWYRGB

### USER MANUAL

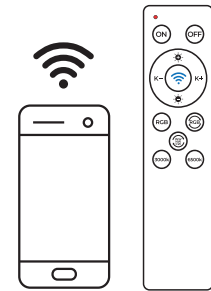
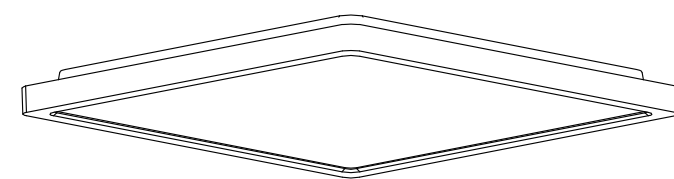

### INTRODUCTION:

Thank you for choosing Annaror ceiling light. This product is suitable for indoor use and we hope that it will bring brightness and comfort to your home or office. If you have any questions or concerns during use, please do not hesitate to contact us via our brand email: [support@annaror.net](mailto:support@annaror.net). Our customer service team will be happy to assist you in a timely manner.

Take full control of your ceiling light with our product that seamlessly integrates with app and remote control. With 7-color RGB options and adjustable color temperature, create the perfect ambiance for any occasion

### SPECIFICATION:

Model	LS-CL-I3-24W-Dim-APPWYRGB
Size	32*2.5CM / 126*0.98 inch
Power	24 Watts
Voltage	AC 120V
Luminous flux	2400 Lumen
Color temperature	3000K-6500K
Color rendering index	90
RGB	7-color RGB & RGB cycle mode
APP	Tuya / Smart Life
Material	PC
Waterproof	IP40
Remote control frequency	2.4G
Remote control distance	10M
Lifetime	30000H

### OVERVIEW OF ANNAROR SMART CEILING LIGHT

- Compatible with Google Home and Alexa, supports voice control.
- Choose from 16 million colors to make your life more colorful. Brightness & color temperature are adjustable (adjustable between 3000K-6500K), and colors can be DIY.
- Easily create different lighting atmospheres for different scenes.
- Music mode (colors change continuously while music is playing).
- Timer control through an app (Timer does not have memory function; the light will turn off when the time is up, and users need to set the timer again for future use).

### 2.4G REMOTE CONTROL INSTRUCTION

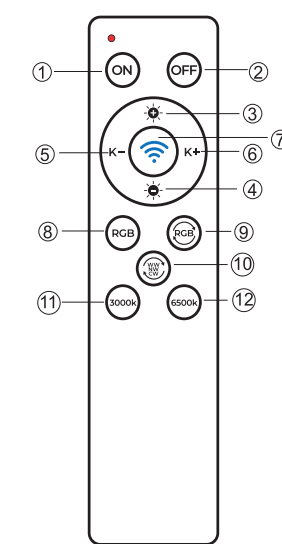

- ON
- OFF
- Stepless dim up to 100% brightness
- Stepless dim down to 10% brightness with seamless adjustment
- Adjust color temperature down to 3000K
- Adjust color temperature up to 6500K
- Signal button: Long press for 3-5 seconds to make the light flash 10 times quickly to enter WiFi connection mode; short press to activate night light mode (3000K, 10% brightness)
- 7 RGB Colors
- RGB cycle mode (fast/slow)
- Different color temperatures (3000K/4000K/6500K)
- Warm white: 3000K
- Cool white: 6500K

### REMOTE CONTROL PAIRING

#### Steps to pair:

- Power off for 10-20 seconds.
- Power ON again.
- Long press the "ON" button for 5 seconds to match the code, the light flashes once and the pairing is successful.

#### Steps to cancel the pairing:

- Power off for 10-20 seconds.
- Power ON again.
- Long press the "OFF" button for 5 seconds to match the code, the light flashes twice and the pairing is canceled.

### NOTE

- Battery not included.
- Not suitable for use with dimmer switches.
- Remote control distance is within 10 meters.

### MEMORY FUNCTION

Remote and APP control: Except for the RGB cycling mode, all other modes can remember the last setting.

Wall switch: The current setting is kept for 1 minute and the ceiling light is turned on for more than 15 seconds, the light will remember the setting when it is turned back on.(except for RGB cycling).

APP and remote control can switch control.

### WALL SWITCH OPERATION INSTRUCTIONS

Change the 6500K+ 3000K+ 4000K+ night light mode+ RGB cycle mode in turn. (Do not fit for home dimmer!)

### ACCESSORIES LIST

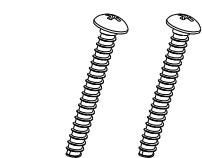

Screw for junction box x2

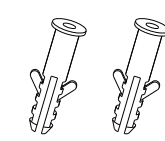

Anchor x2



Screw for anchor x2

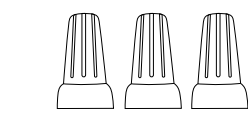

Wire nut x3

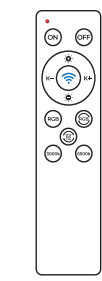

Remote control

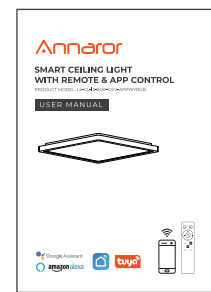

Instruction for installation x1

### INSTALLATION STEPS

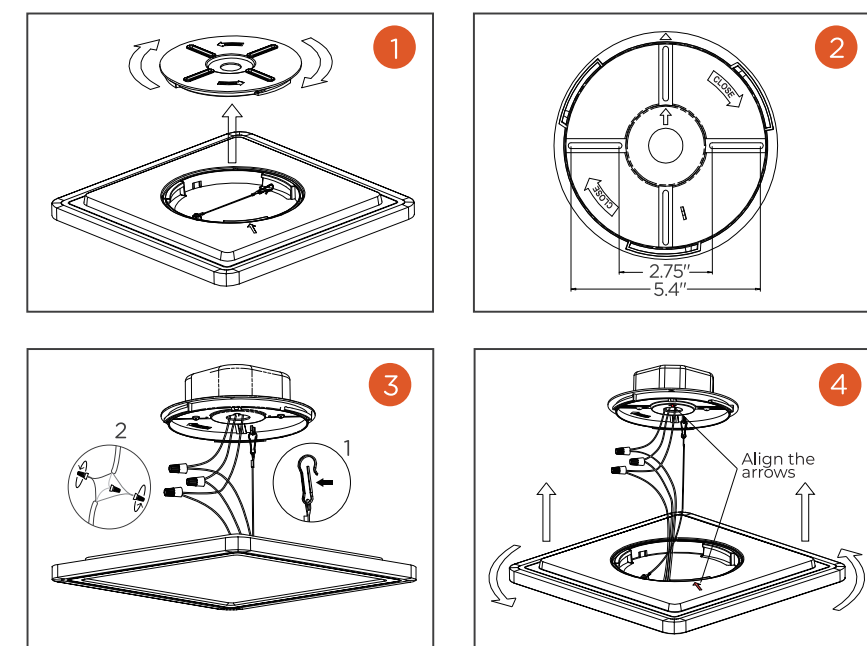

1.Please rotate and remove the base plate, fix the base plate to the junction box with screws provided.

2.Please use the correct size junction box. The screw hole distance of the junction box: 2.75-5.4 inches.

3.Hang up the wire rope and connect the wires of the corresponding color, then push and feed all wires up into the junction box.

(Description of the supply terminals: Black: Hot Wire; White: Neutral Wire; Green: Ground Wire)

4.Please put the arrow on the base plate aiming at the arrow on the back of the lamp, push and rotate the lamp to install it on the base.

### PRECAUTIONS

#### ◆ Precautions Before Installation

- Power off before installation.
- Do not exceed the rated voltage.
- Do not install it on surfaces where are not stable or deformed.
- Do not install it on or above the surface with high temperatures.
- Please make sure that no gas, water, or electricity pipes and wires can be drilled through or damaged in your chosen mounting location.

#### ◆ Precautions During Installation

- There must be no corrosive, explosive, or flammable materials around the lamp.
- User should connect the cable correctly, and the lamp should be installed by a qualified electrician.
- Please pay attention to connecting the wires correctly, and make sure the cable connection comply with national regulations.
- Please make sure that the lampshade is clear in case of low luminous efficiency.
- Please make sure that illuminants are securely fixed during the installation.

#### ◆ Precautions About the Product

- It is not suitable for dimmers switches.
- The LED light source inside the lamp body can not replaceable.
- The lampshade cannot be opened.
- Do not touch the light when it is running.
- Do not look straight into the light source (illuminant, LED, etc.).
- Do not let the children touch this light and packaging to avoid danger.



MADE IN CHINA

Smart LED Ceiling light  
Instructions of APP Usage

The following are instructions about the app. If you have any questions, please feel free to contact us through Amazon or brand email: [support@annaror.net](mailto:support@annaror.net).

#### 1. Download Tuya / Smart Life APP:



#### 2. APP & Light Pairing

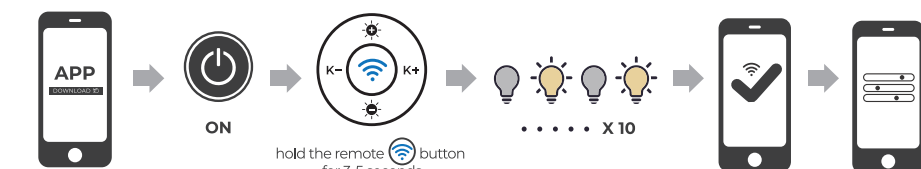

- After the LED ceiling lamp is installed and powered on, press and hold the remote signal button for 3-5 seconds, and the light will blink 10 times to enter the WiFi connection mode.
- Open the Tuya/Smart Life app, click on "Add Device", connect to WiFi, and then add the device "SLRSG". (Tip: Make sure both Wi-Fi and Bluetooth are turned on for your phone.)

2.3 Successfully connected

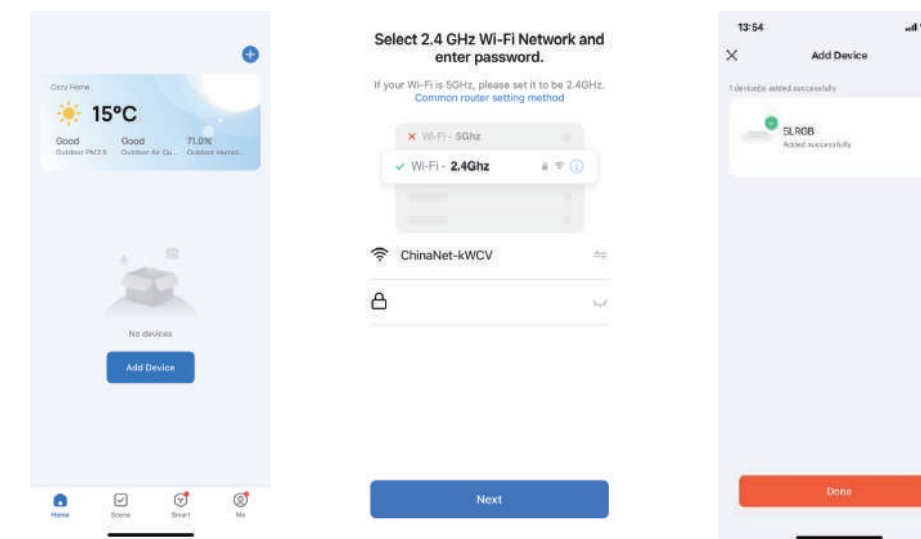

Smart LED Ceiling light  
Instructions of APP Usage

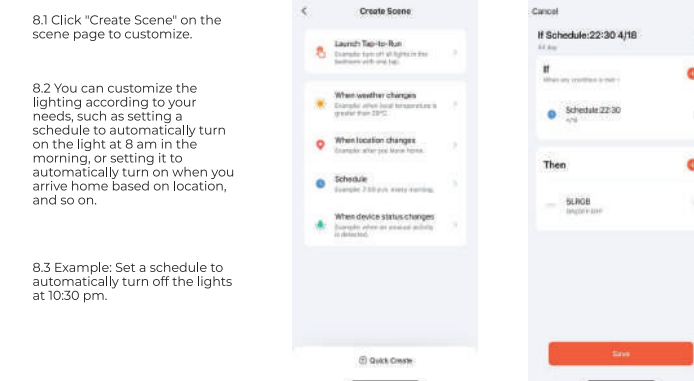
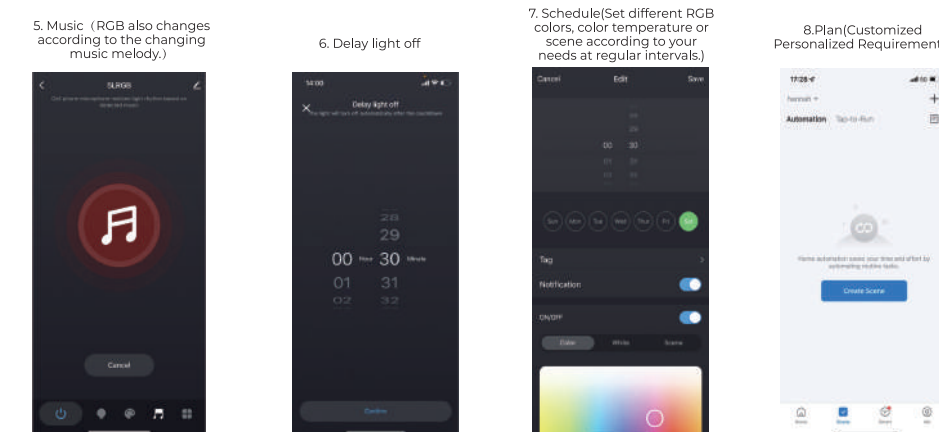
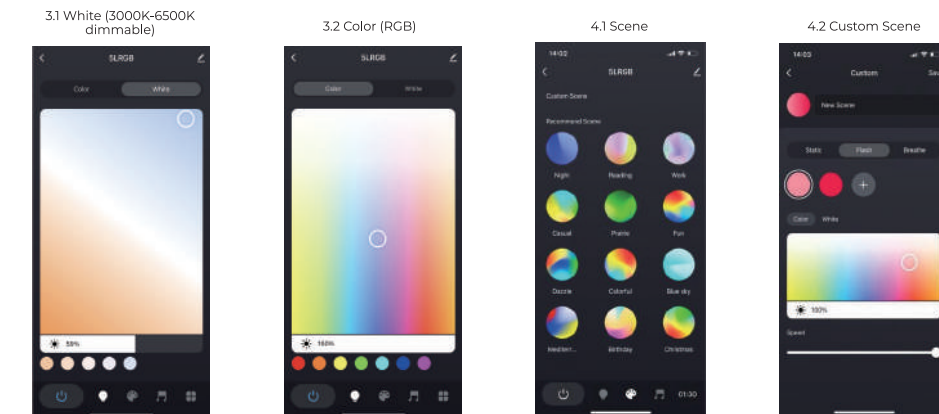

MADE IN CHINA

This device complies with part 15 of the FCC Rules. Operation is subject to the following two conditions: (1) this device may not cause harmful interference, and

(2) This device must accept any interference received, including interference that may cause undesired operation.

Changes or modifications not expressly approved by the party responsible for compliance could void the user's authority to operate the equipment. This equipment has been tested and found to comply with the limits for a Class B digital device, pursuant to Part 15 of the FCC Rules. These limits are designed to provide reasonable protection against harmful interference in a residential installation. This equipment generates uses and can radiate radio frequency energy and, if not installed and used in accordance with the instructions, may cause harmful interference to radio communications. However, there is no guarantee that interference will not occur in a particular installation. If this equipment does cause harmful interference to radio or television reception, which can be determined by turning the equipment off and on, the user is encouraged to try to correct the interference by one or more of the following measures:

- - Reorient or relocate the receiving antenna.
- - Increase the separation between the equipment and receiver.
- - Connect the equipment into an outlet on a circuit different from that to which the receiver is connected.
- - Consult the dealer or an experienced radio/TV technician for help.ct.

This equipment complies with the FCC RF radiation exposure limits set forth for an uncontrolled environment. This equipment should be installed and operated with a minimum distance of 20cm between the radiator and any part of your body.