

(EN)User Manual

(H27)

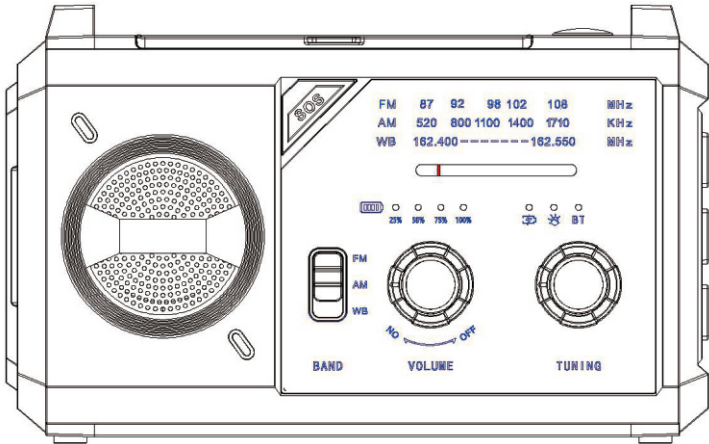

Thank you for choosing our product.

Crafted with advanced, precise, and innovative technology, it ensures stable quality and exceptional performance. For the best experience, please read the user manual carefully. If you encounter any issues, please don't hesitate to contact us—we're always ready to assist you.

Important Instructions:

- Follow the steps outlined in the manual for proper use.

WARNING Do not place this product in fire or high-temperature environments to avoid fire or explosion.

Maintenance & Cleaning:

- Keep the product away from high humidity areas, such as bathrooms.
- This product is not waterproof; avoid cleaning with water.
- Do not use chemicals like alcohol, thinner, or benzene on the surface.
- Regularly clean the charging port to prevent poor contact and charging issues.
- Use only certified chargers from reputable brands.
- For quality-related issues, contact the seller. Do not attempt to disassemble the product.

Introduction to Buttons and Functions

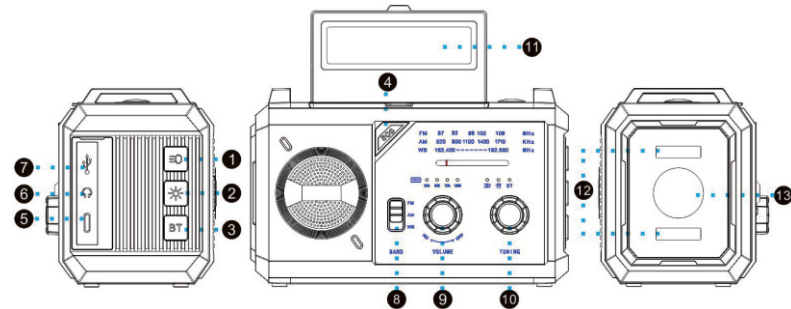

① **Flashlight High Beam and Low Beam Control Button:** The first time you press this button to turn on the high beam of mark ⑬; The second time you press this button to turn off the high beam and turn on the low beam of mark ⑫; The third time you press this button to turn on the high beam and the low beam at the same time; The fourth time you press this button to turn off the high beam and the low beam.

② **Reading Light Button:** Press this button to switch on the reading light ⑪, press this button again to switch off the reading light.

③ **BT Button:** First turn the radio on rotating the radio by knob ⑨ knob to switch on the radio, then Long press the BT button for 3 seconds to turn on Bluetooth, open the phone Bluetooth to search for device "H27", click

"H27" to connect Bluetooth, after you hear the beep, the Bluetooth connection is successful, blue indicator light at the display position; Long press the BT button for 3 seconds to turn off the Bluetooth. (Bluetooth Version 5.3, the transmission distance of Bluetooth is 10m-15m, your phone will be automatically connected to Bluetooth "H27" when your next use)

(**Note:** Before turning on Bluetooth, you need to rotate the ⑨ knob to turn on the power; Rotate the ⑨ knob to turn off the power can be directly off the Bluetooth)

④ **SOS Button:** Long press this button for 2 seconds, the alarm will beep and flash at the same time, short press this button to close the SOS alarm.

⑤ **USB Charging Port:** Please use a 5V charger to connect the USB charging cable to charge the unit.

⑥ **3.5mm Headphone Jack:** Please connect the headphones to use it.

⑦ **USB Output Port:** Connect the USB charging cable here to charge electronic devices with an input of 5V/3A or less.

⑧ **FM/AM/WB Channel Switch Key:** Toggle it to switch channels FM/AM/WB.

⑨ **Radio On/Off Knob:** Rotate this knob to turn on the radio and adjust the volume level.

⑩ **Radio Tuning Knob:** Turn this knob to search for radio stations.

(**Caution:** Recommended to pull out the tie rod antenna after switching on the radio, for better reception of radio signals)

⑪ **Reading Lamp**

⑫ **Flashlight Low Beam**

⑬ **Flashlight High Beam**

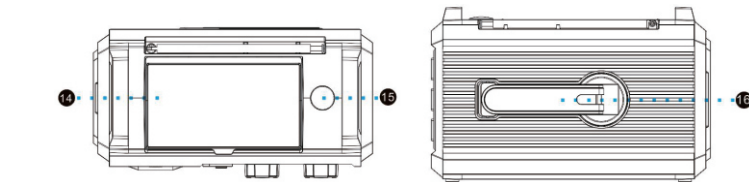

⑭ **Solar Charging Panel:** Aim the solar charging panel at the sunlight, the solar charging panel will automatically charge the machine, when the solar charging panel is charging the display position orange indicator lights up.

⑮ **Compass**

⑯ **Hand Crank Generator:** Turn the hand crank clockwise or anti-clockwise to start the hand crank generator to charge the unit, the orange indicator light in the display position during hand crank charging.

(**Attention:** Hand crank power and solar charging are recommended for emergencies, charging via USB is recommended for non-emergencies.)

Screen Features

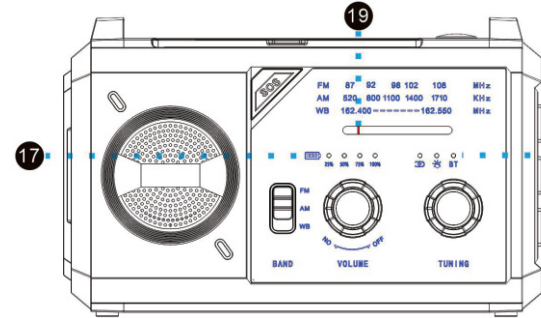

⑰ **Power Indicator:** This machine has a four-grid power display, if the last display light flashes, it means the battery is dead, please charge it in time.

⑱ **Working Indicator Lights:** The power display grid jumps when USB charging; the red indicator light is on when the power output is on, and the battery display grid lights up. Hand crank charging orange light is on; Solar charging orange light is on; Bluetooth on blue light is on.

⑲ **Radio Band Scale Display Bar:** The scale bar shows the position of the band you have searched.

After-Sales Service

This product is made of high quality material and has been fully inspected before shipment. We offer a 6-month warranty. If there are any issues with the product, please contact us, and we will provide a refund or a replacement to ensure your satisfaction.

Product Parameters

Frequency Range	FM:87-108MHz	Time to Fully Charged	USB: 4H
	AM:520-1710KHz		Hand-Cranked: 40H
	WB:162.400-162.550		Solar:91H(UnderFull Sunlight)
Product Size	156*82.5*99mm	Function Usage Time After Fully Charged	Radio: 180H
Weight	732g		High Beam Flashlight: 58H
Battery Capacity	2000mAh		Low Beam Flashlight: 118H
Solar Power	5V/0.65W/130mAH		Bluetooth Playback: 89H
USB Output	5V/3A	Hand-Cranked Generator	Reading Lamp+Radio: 55H
USB Input	5V/3A		
LED Lighting Brightness	High Beam: 600LUX		
	Low Beam: 150LUX		
	Mixed Beam: 650LUX		

Frequently Asked Questions & Answers:

Q:Can I use the radio while it's charging my phone?

A:Yes, you can use the radio while charging your phone. However, charging may cause interference, leading to a weaker signal.

Q: Why is the compass not pointing accurately?

A: There are a couple of possible reasons:

- ① The compass may have lost its magnetism, which typically happens after exposure to high temperatures.
- ② The compass shaft might be stuck due to burrs, preventing it from moving.

Both issues can result in the compass not responding or moving. If the compass moves freely, these are not the causes.

Additionally, nearby magnetic fields from electrical appliances, magnetic materials, or even mines can interfere with the compass, causing it to malfunction.

FCC Warning

This device complies with part 15 of the FCC Rules. Operation is subject to the following two conditions: (1) This device may not cause harmful interference, and (2) this device must accept any interference received, including interference that may cause undesired operation.

Any Changes or modifications not expressly approved by the party responsible for compliance could void the user's authority to operate the equipment.

Note: This equipment has been tested and found to comply with the limits for a Class B digital device, pursuant to part 15 of the FCC Rules. These limits are designed to provide reasonable protection against harmful interference in a residential installation. This equipment generates uses and can radiate radio frequency energy and, if not installed and used in accordance with the instructions, may cause harmful interference to radio communications. However, there is no guarantee that interference will not occur in a particular installation. If this equipment does cause harmful interference to radio or television reception, which can be determined by turning the equipment off and on, the user is encouraged to try to correct the interference by one or more of the following measures:

- Reorient or relocate the receiving antenna.
- Increase the separation between the equipment and receiver.
- Connect the equipment into an outlet on a circuit different from that to which the receiver is connected.
- Consult the dealer or an experienced radio/TV technician for help.

The device has been evaluated to meet general RF exposure requirement. The device can be used in portable exposure condition without restriction.