

USER GUIDE

Please read the instructions carefully before using this product and keep it for future use.

Contents

FUNCTION OVERVIEW.....	1
SPECIFICATION.....	1
START.....	2
HOME SCREEN.....	2
SETTING BASICS.....	3
NETWORK CONNECTION.....	5
APP MANAGEMENT.....	6
INTERNET NAVIGATION.....	8
MULTIMEDIA.....	9
TROUBLESHOOTING.....	10

START

Power on/off

1. Hold down the power button for 2-3 seconds to turn on the tablet. Select the language and follow the start up guide to set up the tablet.
2. Hold down the power button for 2 seconds before releasing it, which will display power off and restart on the screen. Click power off to turn off the tablet.
3. Press and hold the power button for 5 seconds to do a forced shutdown, if it freezes.

Battery

1. A rechargeable Li-ion battery is installed in the tablet.
2. We suggest you drain the battery completely once a month, if you only use your tablet occasionally.
3. DO NOT dispose of tablet in a fire.
4. Charge the device fully each time to increase the battery life.
5. You can charge the tablet, even if the tablet has some power left in it, as the lithium battery does not need to be fully drained to charge.
6. A full charge can be used for an average of 3 hours.

Sleep Mode

Simply press the power button once to switch the tablet to the Sleep Mode when the tablet is ON; press again to wake it up.

Tip:

Go to **Settings > Display > Screen timeout** to set the time of entering the Sleep Mode.

HOME SCREEN

Wallpapers, Home Settings and Screenshot

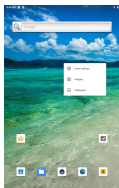

Wallpaper

Tap and hold your finger in any blank space on the home screen, you will see a pop-up menu. You can choose a wallpaper from the Gallery, your downloaded files or those listed as options; set the one you like to be the wallpaper.

Home Settings

Tap and hold your finger in any blank space of the home screen, you will see a pop-up menu with home settings. Tap HOME SETTINGS to enable/disable Add icons to Home screen. This is applicable to the new Apps installed from Play Store.

More Settings

Swipe down from the top of the screen, then tap the  icon to enter the detailed Setting interface. You can also tap the Settings icon on the Home screen to enter the settings.

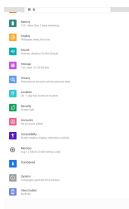
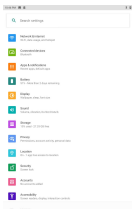

Network & Internet

- . Connect to any working wi-fi
- . Enable / disable the Airplane Mode
- . Hotspot & tethering

Connected devices

- . Turn on / off Bluetooth
- . Pair with Bluetooth devices and check the paired devices
- . cast device and check the cast device
- . Add and check printers

Apps & notifications

- . Check the Apps recently opened
- . Check all the Apps on the tablet
- . Set the App permissions
- . Uninstall the third-party Apps
- . Adjust App notification settings
- . Clear the cache of the Apps

Battery

- . Display the remaining battery power as a percentage
- . Enable/disable the Battery Saver

Display

- . Adjust the screen brightness
- . Adjust the font size and display size

- . Set a screen saver
- . Change the wallpaper

Sound

- . Set volume levels for media, alarms, and notifications
- . Set preferences of Do Not Disturb
- . Set the tunes for notifications and alarms
- . Turn on/off the sound for screen lock, charging and touch

Storage

- . View and manage your storage space

Privacy & Security & location

- . Set screen lock pattern, e.g. password, PIN, Swipe etc.
- . Enable/disable all the notifications while the screen is locked
- . Turn on/off the location services for specific Apps
- . Set to show/hide the password when input a password

Accounts

- . Add and manage the user accounts on your tablet

Accessibility

- . For vision and hearing impaired users, manage settings for Screen readers, Subtitle, and more

Digital Wellbeing & parental controls

- . Set timers for your APPS
- . Set up parental controls with Google's Family link

System

• Set Language

Tap Languages > input > Languages > +add a language. After adding, hold and slide the  to the top to change the language.

• Restore factory setting

Tap Reset options > Erase all data (factory reset) to restore to factory settings.

• Other Settings

Set the date and time
Turn on/off the Backup

About tablet

- . Check detailed information about the tablet.

NETWORK CONNECTION

Go to Wi-Fi Settings in the Settings interface or directly enter through Quick Settings.

Wi-Fi Connection

1. Tap Network and Internet and turn on the Wi-Fi, All Wi-Fi connections available will be listed.
2. Select your Wi-Fi, and input the correct password.

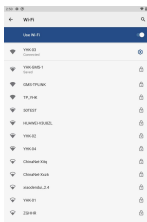

Bluetooth Pairing

Please turn on the Bluetooth on your tablet and your Bluetooth device.

1. Tap Connected devices and turn on the Bluetooth;
2. Tap +pair new device to enter the scanning interface. Devices available will be displayed after a few seconds;
3. Tap the desired device to get a pairing code and click PAIR on both devices.
An automatic connection will be applied to some devices.

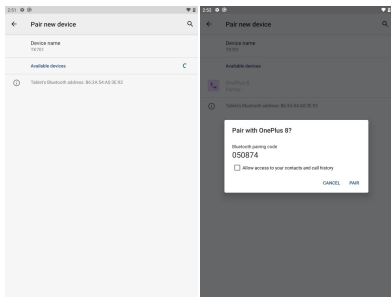

APP MANAGEMENT

App Download and Installation

1. Tap and open Play Store on the Home screen;
2. Log into your Google account, search and download the App you need.

App Management

Move the App

Tap and hold the App, then slide into a desired screen

Remove the App from the Home screen

Tap and hold the App, then slide to the X to remove it from your Home screen.

Uninstall the App

Tap and hold the App, then slide to the trash bin to uninstall the App.

Clear the Cache of the App

1. Go to Settings> Apps & notifications;
2. Select an App> Storage & cache > CLEAR CACHE

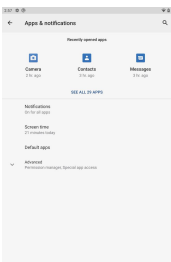

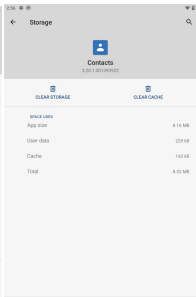
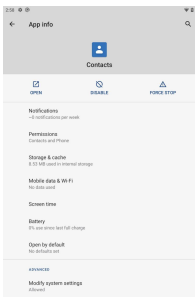

INTERNET NAVIGATION

Please make sure the tablet is connected to a working wifi network before navigating the Internet.

You may use the Chrome browser that is pre-installed or use another browser download from the Play Store.

MULTIMEDIA

Connecting to the Computer

1. Connect your tablet to the computer with the type C cable and go to Quick Settings;
2. Tap Android Systems • charging this device via USB> Tap for more options>File Transfer;
3. Go to your computer and find your tablet TK701 to transfer files between your tablet and computer.

Connecting to an External Device

1. Install a microSD card into the microSD card slot and go to Quick Settings;
2. Tap to set up ;
3. Set the microSD card as a portable storage by selecting Use as portable storage.
Enter micro SD Card storage to move files between the card and tablet.

TROUBLESHOOTING

Q1. The tablet doesn't power on.

- . Reboot your tablet after charging for 30 minutes;
- . Press the power button to see if the tablet is in the Sleep Mode;
- . Press and hold the power button for 5s to turn off the tablet, then reboot it;
- . Press the Reset button with a pin to reset the tablet.

Q2. The tablet doesn't charge

- . Charge the device for at least 30 minutes, in case the battery was completely drained;
- . Make sure the USB cable is properly plugged into the charger port;
- . Try another compatible USB cable and adapter.

Q3. Error message occurs during the operation

- . Uninstall the App with the error message, then download and install again;
- . Press the Reset button with a pin to reset the tablet.

Q4. The tablet cannot be detected by the computer.

- . Make sure the tablet is powered on;
- . Try another USB cable;
- . Try another USB port on the computer;
- . Instead of Charge this device, choose Transfer files or Transfer photos (PTP) when connecting the tablet to the computer.

Q5. The tablet cannot connect to the Wi-Fi

- . Make sure the Wi-Fi on your tablet is ON;
- . Make sure you input the correct password when connecting the Wi-Fi ;
- . Reboot the router;
- . Make sure there is no filter setting or device connection limitation in the settings of the router;
- . Forget the current Wi-Fi, reset the router and connect the Wi-Fi again.

Q6. The storage space of the tablet is not enough.

- . Delete the Apps you don't use;
- . Clear the cache of the Apps regularly;
- . Install a micro SD card to expand the storage.

IC Warning

"This device complies with Industry Canada's license-exempt RSSs. Operation is subject to the following two conditions:

- (1) This device may not cause interference; and
- (2) This device must accept any interference, including interference that may cause undesired operation of the device."

FCC Warning

This device complies with Part 15 of the FCC Rules. Operation is subject to the following two conditions:

- (1) This device may not cause harmful interference, and
- (2) this device must accept any interference received, including interference that may cause undesired operation.

NOTE 1: This equipment has been tested and found to comply with the limits for a Class B digital device, pursuant to part 15 of the FCC Rules. These limits are designed to provide reasonable protection against harmful interference in a residential installation. This equipment generates, uses and can radiate radio frequency energy and, if not installed and used in accordance with the instructions, may cause harmful interference to radio communications. However, there is no guarantee that interference will not occur in a particular installation. If this equipment does cause harmful interference to radio or television reception, which can be determined by turning the equipment off and on, the user is encouraged to try to correct the interference by one or more of the following measures:

- Reorient or relocate the receiving antenna.
- Increase the separation between the equipment and receiver.
- Connect the equipment into an outlet on a circuit different from that to which the receiver is connected.
- Consult the dealer or an experienced radio/TV technician for help.

NOTE 2: Any changes or modifications to this unit not expressly approved by the party responsible for compliance could void the user's authority to operate the equipment.

The device has been evaluated to meet general RF exposure requirement. The device can be used in portable exposure condition without restriction.