

A20Pro Dash Cam

# Biuone



(SD card has been inserted into the dash cam)



# PACKAGE CONTENTS



Front Cam



Suction Cupx2



Car Wire  
Trim Tool  
(helping hiding  
cable)



Rear Cam &  
Rear Cam Cable



USB Reader  
(used to insert SD Card and  
playback on PC)



Card Needle  
(Poke the RES hole to reset  
the dash cam when it  
not work)



64G SD Card  
(already inserted in item)



User Manual



Lens Cleaning  
Cloth



2 set of rear  
cam install tool



8-10 Cable  
Hiding Clip



USB Cable  
(used to connect dash cam and playback on PC)



Cigarette Lighter Charger  
with USB Port

# WARRANTY

We are truly thankful to you to choose our upgraded A20Pro Dash Cam.

We hope that you can not only using our item happily , but also can enjoy Excellent After-sale Service !

## ? MORE QUESTION

- ① Not happy with shopping?
- ② Defective item?
- ③ Missing parts or need accessory replacement?
- ④ Inaccurate website description?

Please contact with us before returning this item.

We can not 100% promise that everyone will satisfied with our item , but we give you 100% SATISFACTION GUARANTEE, Promise!

## 📞 How to contact with us

Way 1: Mail-box: [damai\\_service@163.com](mailto:damai_service@163.com)

Way 2: Enter our listing - Search "HONGGB" to click & enter our shop - Click "Ask a question" (top right corner)

Way 3: Contact with " Amazon Buyer Service" - Ask them to help found the seller's after-sales customer service  
( Due to the nature of the product, Amazon Buyer Customer Service cannot answer your product usage questions, so please contact our seller directly, hope you can understand.)



# TABLE OF CONTENTS

Installation Map ————— 01

Important Notice Before Using ————— 02

Product Structure ————— 03

How to Use the Buttons ————— 05

Icon Instruction ————— 07

How to Connect with WiFi ————— 08

Installation Guidance (details) ————— 12

Menu Setting ————— 18

How to Playback the Video ————— 20

Questions & Answer ————— 22

Product Specification ————— 26

## - Installation Map -



### About the Red Cable:

**If needs the reversing mode** (the dash cam auto shows the full screen of the backward pulling situation when reversing):

Needs connect the red cable to the positive pole of the reversing lamp. In this way, the front and rear cam are recorded during the driving, but during the reversing process, it is not recorded.

### **If reverse mode is not required:**

No need to connect the red cable with the car, directly with the tape wrapped it is ok.

In this way, the front and rear cam always keep the video recording while the car is driving and reversing.

## - Important Notice Before Using -

- 1 Any using question or not satisfied, please feel freely contact with our seller: [damai\\_service@163.com](mailto:damai_service@163.com)
- 2 When playback on computer , need download TS format player.
- 3 Please do test both cam before installation. (use our cigarette lighter to charge it) When the front cam is on, please do not insert/unplug the rear cam otherwise it will easily cause a short circuit. (the AV-IN Port)
- 4 Our dash cam comes with 64G SD card (already inserted in dash cam), if you want to change it, please use High Speed, Class 10 32-268G SD card. Please format the sd card before first time's using.
- 5 Please always keep charging the dash cam when using it, the internal battery is for emergency recording when parking. We also is the supplier of other dash cam's seller, all the 3 inch dash cam in the market like this.
- 6 If FREEZING or KEEP POWER ON & OFF issues, please use the card needle to insert the [RES little hole](#) (at the bottom of the dash cam).
- 7 When the dash cam connected to WiFi, can 't operate the dash cam, only can start/pause the recording on the mobile phone, or Playback/Delete the recorded files on the mobile phone.

## - Product Structure



Lens

Speaker

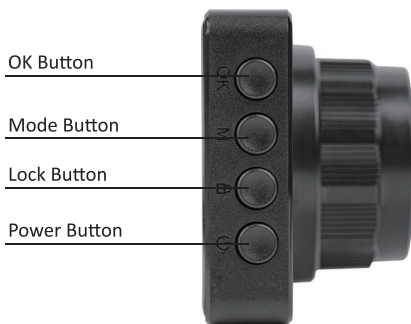

OK Button

Mode Button

Lock Button

Power Button



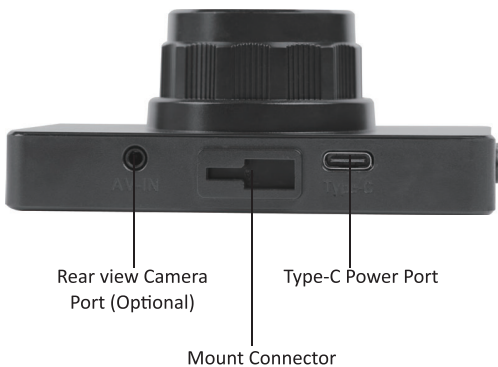
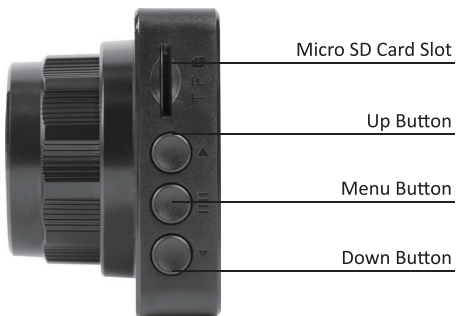



## - How to Use the Buttons -

<b>Power Button</b>	Long Press to turn on/off the camera. Shot Press to turn on/off the screen but still recording
---------------------	---

<b>Lock Button</b>	When recording, shot press to lock/unlock the recording file
--------------------	--

<b>Mode Button</b>	Short press to enter the Playback Mode, Recording File & the Photo File
--------------------	---

<b>OK Button</b>	In playback, short press to enter and choose and playback the video /photo In setting menu, short press to enter and confirm selection. In recording, short press to manual pause/star the recording
------------------	--

## Up Button

Short press: connect front & rear cable, then short press to switch 4 display way of dual dash cam (see below image)  
Long press: one key turn on/off the WiFi  
when in Menu Setting / Playback Mode, you can press it and choose what you need.

## Menu Button

In Standby/, press Menu button to enter the menu/function setting  
Another function of this button: Return to the previous step or exit the current operation

## Down Button

Short press : one key to take a photo  
Long press: one key to turn on /off the microphone  
when in Menu Setting / Playback Mode, you can press it and choose what you need.



Display Mode 1: dual  
cams display



Display Mode 2: dual  
cams display



Display Mode 3: front  
camera display only



Display Mode 4: rear  
camera display only

# - Icon Instruction -

(when some function was turn off , the icon will not display on screen)

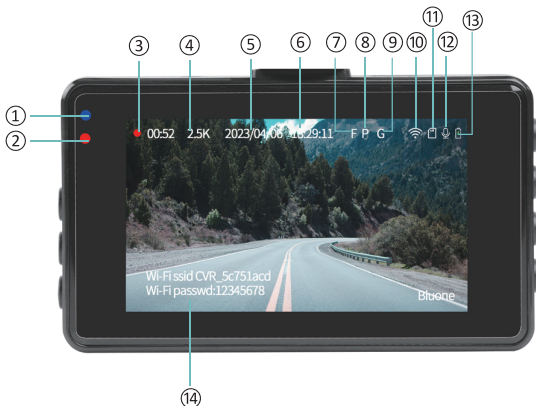

- ① Blue light : when flashing means dash cam is recording
- ② Red light: when it was on means dash cam is charging
- ③ Circle icon: when it was red and flashing means dash cam is recording the unlocked file, when it was yellow and flashing means it is recording the locked file.
- ④ Resolution
- ⑤ Date
- ⑥ Time
- ⑦ F - Motion Detect
- ⑧ Parking Monitor
- ⑨ G-sensor
- ⑩ WiFi
- ⑪ SD card
- ⑫ Microphone
- ⑬ Battery Capacity
- ⑭ WiFi Account and Password

# - How to Connect with WiFi -

Here is the video of connection to WiFi :



Or enter this link to see how to connect with Wi-Fi:

<https://www.youtube.com/watch?v=iflkY7lVnRA>

Please note: When connecting to WiFi successfully, the icon on the dash cam will turn green, and can't operate the dash cam any more unless disconnect with your phone.

## 1 Download the APP:

- Press "Menu Button" enter menu and found the "Wi-Fi"
- Press twice "OK Button" to enter and turn on the "Wi-Fi"
- Then you can see as below picture, scan code and download the APP



Wi-Fi Account & Password

Or directly scan the below code to down the APP:



## 2 Use your phone to link the dash cam's WiFi:

- Open your “ WLAN”
- Found the Wi-Fi Account like “ CVR-5c751...” & connect it
- WiFi Password: 12345678
- When dash cam's WiFi icon display Green color



## 3 Open the APP “ viidure”

**Camera:** Click “Into Camera” then you can enter another interface like step 4

**Album:** The video/photo which download on your phone

**More:** App Setting, like Language setting , date choice, app question feedback ( not seller, if want to contact with us , please mail with [damai\\_service@163.com](mailto:damai_service@163.com) )



## 4 How to Playback on your Phone.

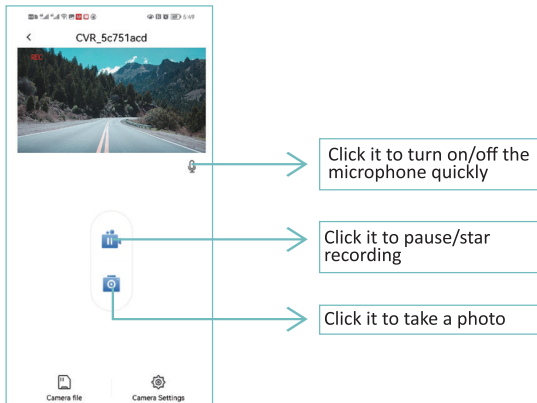

**Camera file:** 4 folder

Loop

Snapshot

Locked

Parking

Click to select the file to playback

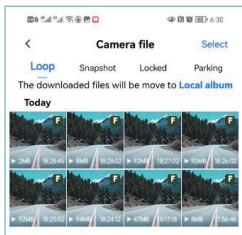

**Camera Setting:** You can do some dash cam setting here, like Microphone, Volume, Loop-Recording, Collision Sensing, Parking Monitor, Format SD Card, change WiFi Account & Password...

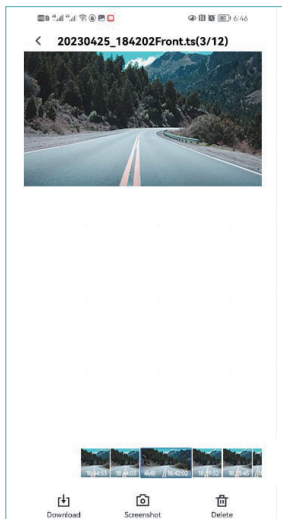

playback recording file

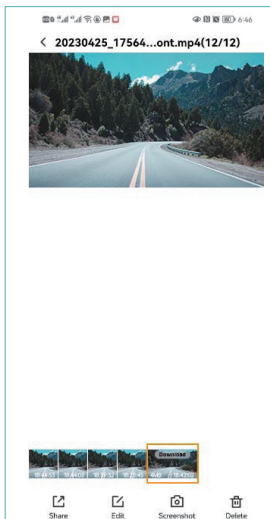

playback download file

**Download:** you can choose to download the recording file on your phone directly . After download the file, you can choose [ONE-KEY Share it with Your Friends](#).

**Screenshot:** you can pause the recording and click screenshot , then easily save that moment in your phone.

**Delete:** choose and delete the recording file.



## - Installation Guidance (details) -

Before installation , Please test and confirm both cam can be used well. ( please use our cigarette lighter charger to charge) Any question please mail with us : [damai\\_service@163.com](mailto:damai_service@163.com)

(If there is a problem with the dash cam before installation, you can contact with us to deal with it in time without wasting installation time. If there is a problem after installation, it can also be ruled out that it is not a machine problem but an installation problem.)

### - Install Front Cam -



Connect the car charger to the camera and the cigarette lighter, hide the rest of the cable in the gap of the Interior trim board.  
( If you want to use the rear cam , please plug the AV-IN port rear cable before turn on the dash cam )

The camera will auto-start recording once powered on.

## ◆ Insert the Memory Card

Gently push the memory card in until you hear a click, and allow the spring release to push the card in/out.



Please insert the card in the right direction.



Please format the SD Card at first time using.



( please confirm the direction of SD Card firstly )

## ◆ Mount the Front Cam onto the Windshield

### ① Clean the front windshield



## ② Install the suction cup



## ③ Adjust the angle of item

Loosen the screw, adjust the main camera's angle and then tighten it to lock at the desired angle.



You can rotate the camera 360° to record to record the your preferred direction.

## ④ Install the suction cup on the windshield and lock it



## ⑤ Connect the power



### - Install Rear Cam -



This dash cam does not have a reverse mode.

There are two ways to place the camera. (If don't have rear camera, please ignore)

**Way 1:** Mount on the rear windshield. There is a 3M glue in the pack age for the rear camera . Please clean the rear windshield and find a suitable position, then paste the rear camera on the windshield.

**Way 2:** (Recommended!) Install it near the license plate. There are fixing screws inside the package to help you fix it