

145mm

Bamboo charging station

Model: 8801



User Manual

Declaration:

This is a Patented Product and all rights are reserved. You are expressly forbidden to directly or indirectly infringe on our patented rights and through the receipt of our product you agree to accept and be bound by the terms and conditions set forth herein.

Warning:

- 1.Read this manual carefully prior to using your product.
- 2.The station should be kept clean, dry and away from the sun at all times.
- 3.Ensure the station is in a safe and secure environment at all times.
- 4.DO NOT expose to flame or extreme heat.
- 5.DO NOT disassemble, deform, puncture or submerge in liquids.
- 6.DO NOT subject the device to extreme force such as dropping or rough handling
- 7.Children should not handle the product. **KEEP OUT OF REACH OF CHILDREN.
- 8.Warranty is void if the product is damaged in any way.
- 9.No amendment of, variation or addition to these conditions will be binding unless express permission is given in writing.

Specifications:

Model No.	8801
Input	DC 9V 3A
Wireless output 1	5W-7.5W-10W-15W (Max) (For cell phone)
Wireless output 2	5W-7.5W-10W-15W(Max) (For cell phone)
Wireless output 3	5W (For earphone box)
Wireless output 4	3W (For Apple watch)
USB A output	5V 2A (Max)
Protection circuit	Over-current, over-charge, over-discharge, short-current, temperature protection
Total Output	27W Max

Package includes:
1x wireless charging stand (body 1 + body 2), 1x AC adaptor, 1x User manual

Product Structure Drawing:

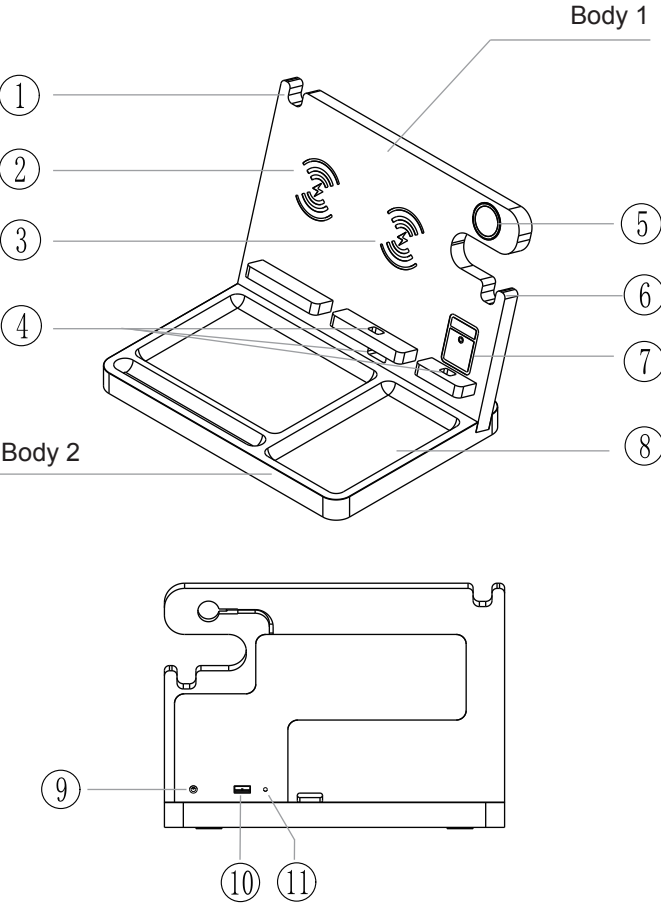

- ① Clasp for glasses
- ② Wireless output 1 for phone
- ③ Wireless output 2 for phone
- ④ The hole for charging cable
- ⑤ Wireless charging for iWatch
- ⑥ Clasp for key
- ⑦ Wireless charging for TWS
- ⑧ Storage for wallet, pen etc
- ⑨ Power input port
- ⑩ USB output port
- ⑪ Power indicator

How to use

1. Assembled body 1 and body 2 together first.
2. Charge your devices

Use provided AC adaptor to plug the product's input port, power LED is on, then put your phone, iWatch, Airpod box to correct position to charge.

Tips:

- 1) All charging devices should be supported wireless charging function.
- 2) When your devices do not support wireless charging, please use charging cable to charge your device. Our product provides extra USB A port port for device charging, please connect the USB cable across the cable hole to charge your device.
- 3) Our product supports 5W-7.5W-10W-15W wireless charging for phone, the charging speed of your phone will be based on the charging protocol of your phone.

FCC Statement

Note: This equipment has been tested and found to comply with the limits for a Class B digital device, pursuant to part 15 of the FCC Rules. These limits are designed to provide reasonable protection against harmful interference in a residential installation. This equipment generates, uses and can radiate radio frequency energy and, if not installed and used in accordance with the instructions, may cause harmful interference to radio communications. However, there is no guarantee that interference will not occur in a particular installation. If this equipment does cause harmful interference to radio or television reception, which can be determined by turning the equipment off and on, the user is encouraged to try to correct the interference by one or more of the following measures:
—Reorient or relocate the receiving antenna.
—Increase the separation between the equipment and receiver.
—Connect the equipment into an outlet on a circuit different from that to which the receiver is connected.
—Consult the dealer or an experienced radio/TV technician for help.

This device complies with part 15 of the FCC Rules. Operation is subject to the following two conditions:(1) This device may not cause harmful interference, and (2) this device must accept any interference received, including interference that may cause undesired operation.

Any changes or modifications not expressly approved by the party responsible for compliance could void the user's authority to operate the equipment.

This equipment complies with FCC radiation exposure limits set forth for an uncontrolled environment. This equipment should be installed and operated with minimum distance 20cm between the radiator & your body.

Warranty Policy & Support

- 1.Thank you for purchasing our product! This Bamboo Wireless Charging Staton will help you keep your room clean and tidy. Simplify your Life!
- 2.We are dedicated to designing and manufacturing product with superior performance and 100% customer satisfaction. All of our products come with a 12-month warranty from date of purchase.
- 3.Please kindly note that our warranty does not cover any damage caused by human factors, such as the owner modifying, attempting to fix, and etc.
- 4.Our warranty covers only the original purchaser of the product. The limited warranty is not transferable to subsequent owners or purchasers of this product.
- 5.If you have any quality problems, please contact us.

Made In P.R.C.

Warranty

Product Name: Bamboo charging station

Model No.: 8801

Purchase Date: _____

Purchase From: _____

100mm