

FCG02

arrows We2

INSTRUCTION MANUAL

Introduction

Thank you for purchasing "FCG02" mobile terminal.
Before using your terminal, or when necessary,
read this manual to ensure safe use and handling.

About manuals

クイックスタートガイド (Quick start guide) (included with the terminal) (in Japanese only)

This guide provides information of parts names and functions.

"Instruction Manual" application (e-manual) (installed in the terminal) (in Japanese only)

This manual provides detailed information and operations of the functions.

You can search by free word, open the setting screen or launch the application from the displayed page, etc. Use the terminal more conveniently with this application.



[Using method]

From the Home screen,  → [Tools] → [Instruction Manual]

*When using this application for the first time, follow the on-screen instructions to download and install this application.

* Also, you can call up "Instruction Manual" (e-manual) application from "my daiz" (in Japanese only).



"INSTRUCTION MANUAL" (PDF file)

This manual provides detailed information and operations of the functions.

Viewing this manual

- In this manual, "FCG02" mobile terminal is usually referred to as "the terminal".
- In this manual, descriptions are based on the default state of the terminal when you purchased.
- The terminal may upgrade the operating system (OS) for quality improvement or additional functions. In that case, the operation procedure may be changed. For the information on additional function or change of the operation procedure, refer to XXXXX website. Also, some applications used in the previous OS version may not be available or some unintended bugs may occur.
- Some applications or services are not available depending on your contract detail. For details, refer to XXXXX website.
- Contacts to XXXXX vary depending on your contract detail. For details, see the last page of this manual.
- The contents in this manual and URL are subject to change without prior notice.
- The images or illustration used in this manual are examples. They may differ from the actual displays.
- Unauthorized copying of parts of or this entire manual is prohibited.

Basic package

■ FCG02

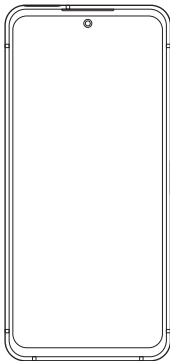

■ Quick start guide (in Japanese only)

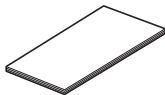

Contents

■ Basic package	1
-----------------------	---

Precautions 5

Before using the terminal	5
Recommended functions	7
Precautions (Always follow these directions)	9
Handling precautions	18
Waterproofness/Dustproofness, shock resistance	25

Before using the terminal 36

Part names and functions	36
nano SIM card	38
eSIM	40
microSD card	40
Charging	42
Turning power on/off	44
Initial settings	46
Security codes used for the terminal	48

Basic operation 51

Basic operation	51
Character entry	54
Screen/icon	61
Task manager	67
Magnifying the screen display	67
Split screen	68

SuguApp	68
Emergency buzzer	69
Imitation call	70

Home screen 71

Switching the home applications	71
Home screen	71
Managing the Home screen	72
Application list screen	74
Using Osusume Apps	78
Searching applications	78
My Magazine	79
my daiz NOW	80
Information of home application	80

Phone/Phonebook 81

Making a call	81
Receiving a call	84
Operation during a call	86
Recent calls	87
Phone memo	87
Call settings	88
Phonebook	89
Your phone number	92

Mail/Browser 93

XXXXX mail	93
+Message	93

Gmail	99	Mobile network	136
Early warning "Area Mail"	99	Airplane mode	138
Chrome™	100	Hotspot & tethering	139
Camera	104	Data Saver	140
Camera	104	VPN (Virtual Private Network)	141
Photos	113	Private DNS	141
Applications	114	Connection preferences	142
dメニュー (dmenu)	114	Codec preferences	142
dmarket	114	Apps	143
Play Store	114	Notifications	144
Osaifu-Keitai	116	Battery and device care	145
radiko+FM	118	Storage	146
Lalasia Connect	119	Display	146
FAST Memo	121	Wallpaper	148
FAST AR Size Checker	121	Sound	149
FAST Share	122	Accessibility	150
Location data/GPS	123	Security	152
Schedule	125	Privacy	159
Clock	126	Safety & emergency	159
Calculator	128	arrows feature select	160
Search	129	XXXXX service/cloud	168
XXXXX Data Copy	129	Passwords & accounts	169
Easy data transfer support	131	Digital Wellbeing & parental controls	170
Settings	132	Google	170
Settings menu	132	Languages & input	171
Wi-Fi	133	Gestures	172
		Pedometer	173
		Date & time	174
		Backup	174
		Reset options	175
		Hardware Feedback	176
		Send diagnostic data	176

About phone	176
-------------------	-----

File management 177

Storage (Internal storage)	177
microSD card (External storage)	177
File operations	177

Data communication 178

Bluetooth® communication	178
NFC communication	181

External device connection 182

Connecting with a PC	182
Connecting with a printer	182
Connecting with other devices	183

Overseas use 184

Outline of international roaming (WORLD WING)	184
Available services for overseas	184
Before using the terminal overseas	184
Making/Receiving a call in the country you stay	187
Setting international roaming	189
After returning to Japan	190

Appendix 191

Troubleshooting (FAQ)	191
Software Update	197

Warranty and After-Sales Service	200
Main specifications	202
Specific Absorption Rate (SAR) Information of Mobile Phones	205
Export Administration Regulations	210
Intellectual Property Right	211

Index 214

Index	214
-------------	-----

Precautions

Before using the terminal

- The terminal supports 5G, LTE, W-CDMA, GSM/GPRS and Wireless LAN Systems and SIM lock is disabled.
- W-CDMA and GSM/GPRS are for overseas use only.
- Since the terminal uses wireless signal, it may not be able to use in a location with no signal reception such as a tunnel, underground, a building, an outdoor location with weak or poor signal reception, or a location outside of the 5G and LTE service areas. Even when you are high up in a tall building or condominium and nothing blocks your view outside, your terminal may not be able to receive or transmit signals. Also, communication may be interrupted even when there are strong radio waves with  signal icon on the terminal and you are not moving (traveling).
- Since the terminal uses wireless signal, there are possibilities that a third party may intercept your telephone call. However, 5G, LTE, W-CDMA, and GSM/GPRS systems support the privacy function covering all telephone calls automatically. Therefore, even a third party intercepts your telephone call, the third party can hear nothing but the noise.
- Your terminal encodes voice communication as digital data. When you are operating your terminal while moving to a location subject to weaker radio wave conditions, the transmitted digital data may not be correctly decoded and as a result the decoded voice may differ from the actual voice.
- If you are using nano SIM card and eSIM at the same time, available services and functions may be limited. XXXXX is not liable to any failures or malfunctions.
- The terminal can accommodate usage by the user and guest users, however, some apps operate only as it being the same user after switching users. XXXXX assumes no responsibility for any damages or trouble incurred by you or third persons arising from use of this functionality.
- Regularly take memos of the data you registered in the terminal or store it in the external memories such as microSD card or PC. XXXXX assumes no responsibility for any loss of your data caused by malfunction, repair, change to a new model or any other reasons.
- Please thoroughly check providers and operation status of the applications, websites, etc. which you want to use beforehand and then use it. In the terminal, some applications that you install or websites that you access may give instability of the operation, or may send your location information or personal information registered to the terminal to outside via the Internet and the information may be used improperly.
- The terminal automatically performs communication for synchronizing data, checking the latest software version, and maintaining a connection with the server, and for other purposes. Additionally, when you download applications or watch video etc., a large amount of packet communication charge is executed. Therefore, it is highly recommended to use packet pack or packet flat-rate service.

- When making initial settings, some applications provided by XXXXX may be installed automatically. If you use mobile network at this time, packet communication charge may be applied. For automatic selection of the applications to install, XXXXX infers the customer's needs based on the information that the customer has provided to XXXXX with the prior consent of the customer or other customer's information XXXXX has retained. Handling the customer information is properly managed in compliance with the terms of XXXXX privacy policy.
- Depending on the applications or service you use, packet communication charge may be applied even in Wi-Fi communication.
- When the memory space of the microSD card or the terminal is low, running applications may not operate normally. In that case, delete the saved data.
- Set a password for the screen lock, etc. to ensure security of the terminal in case of its loss.→P52
- If your terminal is lost, change your each account password or disable the authentication using a PC to prevent other persons from using Google services such as Gmail or Google Play, or SNS, etc.
- For using services and applications provided by the third party's including the applications provided by Google, confirm the terms and conditions specified by Google or the providers. XXXXX assumes no responsibility for any malfunctions resulting from the services and applications.
- When the terms of use screen appears, follow the on-screen instructions.
- Applications and service contents are subject to change without prior notice.
- For details on usage fee, refer to XXXXX website.
- Display is manufactured by taking advantage of highly advanced technology but some dots may be always or never lit. Note that, this shows characteristics of liquid crystal displays and not defects in the terminals.
- The terminal has an organic EL display. Although an afterimage may occur when the same image has been displayed for a long time, it is not a malfunction. To prevent the display from having afterimages, do not display the same image for a long time.
- The display may become partially dark or the colors may be changed if you set the display brightness to brighter than necessary or use the terminal extremely for a long time. Also, unevenness of colors or brightness, or changes of colors may be found depending on direction you are looking. That is because of the structure of organic EL display, not a malfunction.
- For commercially available option devices, XXXXX is not liable to any failures or the malfunctions.

Recommended functions

■ arrows feature select

Check original features of the terminal and make settings for them. →P160

■ Battery monitor

Check the status of the battery charge capacity and display predicted future value. →P145

■ arrows passport

Save and manage your IDs or passwords for web pages and your credit card or account numbers in the terminal to use them. →P157

■ AppDoubleLock®

Security function requiring your own authentication when starting important apps you specified. You can set double authentication methods (face and fingerprint) at the same time. →P162

■ Application pinning

When you let others take a look at photos or videos, you can fix the display or an app you are using so that the photos you do not want to show or other apps do not start. →P67

■ One stop security settings

Advise each individual on the optimal security settings and functions. →P165

■ Emergency buzzer

Power key (1 sec. or more) → [Security tools] → [Emergency buzzer] to sound a buzzer at a loud volume. You can also make a call or send an SMS to a specified contact. →P69

■ FAST Memo

Take memos (text or voice) or pictures quickly during operation or while the lock screen is displayed. →P121

■ FAST FingerLauncher

Touch the fingerprint sensor and slide to unlock and launch frequently used applications. →P156

■ FAST App Drive

Applications can be activated quickly by registering frequently used ones. →P160

■ FAST Wallet

By displaying the application icons on those used for a shop, you can make payments smoothly at the shop where you use multiple applications. →P165

■ Junior mode settings

Set the applications that children can use and the available time, and limit the time period of use in a day so that you can let children use the terminal safely. →P167

■ Various modes to make the screen easier to see

Various functions to make the screen easier to see are available : Simple Home with larger characters and icons, and "Clear Font", which automatically adjusts the character and icon size. →P67, P160

■ Charging for extending battery life

You can save the battery life by setting the battery to stop charging at approximately 85%.→P145

■ Nuisance call countermeasure function

The terminal is equipped with "nuisance call countermeasure" function effective when receiving a call.→P163



■ Easy data transfer support

You can transfer various data such as phonebook, schedule, photos, and videos to the terminal by using a microSD card.→P131

For details of the function, refer to the product information page of FCNT website (<https://www.fcnt.com/product/arrows/>). (In Japanese only)







Precautions (Always follow these directions)

- Before using your terminal, or when necessary, read the precautions below to ensure safe use and handling.
- These precautions are intended to protect you and others around you. Read and follow them carefully to avoid injury, damage to the terminal or damage to property.
- The signs below differentiate between the levels of danger that can occur if the terminal is not used within the specified guidelines.

 DANGER	This sign denotes that "death or serious injury (*1) may directly result from improper use".
 WARNING	This sign denotes that "death or serious injury (*1) may result from improper use".
 CAUTION	This sign denotes that "minor injury (*2) or damage to property (*3) may result from improper use".

- *1 Serious injury: This refers to loss of sight, injuries, burns (high- and low-temperature), electric shock, broken bones, injuries with residual aftereffects from poisoning, etc., and injuries requiring hospital admission for treatment or long-term hospital attendance as an outpatient.

- *2 Minor injury: This refers to injuries, burns (high- and low-temperature), electric shock, etc. that do not require hospital admission for treatment or long-term hospital attendance as an outpatient.
- *3 Physical damage: This refers to extended damage to buildings, furniture, livestock, pets, etc.
- The symbols below show specific directions.

 Don't	This symbol denotes that the action is prohibited.
 No disassembly	This symbol denotes that disassembling the phone or its components is not allowed.
 No liquids	This symbol denotes that using the phone or its components in a bathroom or other highly humid area is not allowed.
 No wet hands	This symbol denotes that using the phone or its components with wet hands is not allowed.
 Do	This symbol denotes that an instruction must be obeyed at all times.
 Unplug	This symbol denotes that the equipment should be unplugged.

◆ Handling the terminal, adapter, and nano SIM card (common)

DANGER



Don't

Do not use, store or leave the terminal in hot places (e.g. by the fire, near a heater, under a kotatsu or futon, in direct sunlight, in a car in the hot sun).

May cause fire, burns, injuries, electric shock, etc.



Don't

Do not put the terminal into or near a heating cooking device such as a microwave oven or IH cooker, or high-pressure container such as a pressure cooker.

May cause fire, burns, injuries, electric shock, etc.



Don't

Do not put sand, dirt, or mud on the terminal or put it on them directly. Do not touch the terminal with hands to which sand or others adhere.

May cause fire, burns, injuries, electric shock, etc.

For the waterproof and dustproof functions, refer to the following.

→P25 "Waterproofness/Dustproofness, shock resistance"



Don't

Do not charge when the terminal is wet with water (drinking water, perspiration, seawater, urine of pet animals, etc.).

Also, do not charge the terminal in a place where it possibly contacts water such as a bathroom or near a humidifier.

May cause fire, burns, injuries, electric shock, etc.

For the waterproof function, refer to the following.

→P25 "Waterproofness/Dustproofness, shock resistance"



Don't

Do not subject the terminal to strong pressure or break the terminal. Especially when bringing the terminal putting in a pocket of clothes, do not let the terminal hit against surroundings or being put between the objects.

May cause fire, burns, injuries, etc. resulting from the damage of the internal battery.

* The following are examples that you should be careful of:

- Sitting or squatting with the terminal put in a pocket of trousers or skirt
- Putting the terminal in a pocket of outer wear and catching them in a door or a door of car
- Stepping on the terminal on a soft object such as a sofa, bed, or bedding, or on a floor
- The terminal being caught in a train or bus seat



Don't

Do not attempt to remove the internal battery from the terminal.

May cause fire, burns, injuries, electric shock, etc.



Don't

The exterior case (back side) cannot be removed. Do not attempt to remove it from the terminal.

May cause fire, burns, injury, etc.



No disassembly

Do not disassemble or remodel the equipment.

May cause fire, burns, injuries, electric shock, etc.



No liquids

Do not let the terminal get wet with water (drinking water, perspiration, seawater, urine of pet animals, etc.).

May cause fire, burns, injuries, electric shock, etc.

For the waterproof function, refer to the following.

→P25 "Waterproofness/Dustproofness, shock resistance"



No liquids

Do not allow liquid (drinking water, perspiration, seawater, urine of pet animals, etc.) to come into the charging jack, external connection jack.

May cause fire, burns, injuries, electric shock, etc.

For the waterproof function, refer to the following.

→P25 "Waterproofness/Dustproofness, shock resistance"



Do

Use the optional devices specified by XXXXX.

Using unspecified devices or devices with unclear manufacturer, distributor, or specifications may cause fire, burns, injuries, electric shock, etc.



WARNING



Don't

Do not drop, trample, or throw the terminal or give a strong force or vibration to the equipment.

May cause fire, burns, injuries, electric shock, etc.



Don't

Keep conductive materials (metal pieces, pencil lead, etc.) from coming in contact with the charging jack or external connection jack, or dust into the terminal.

May cause fire, burns, injuries, electric shock, etc.



Don't

Do not cover or wrap the terminal with a blanket etc. while using or charging.

May cause fire, burns, etc.



No liquids

When cleaning the terminal, be careful not to allow disinfectant or moisture to come into the gaps of the terminal, charging jack, external connection jack, microphone, or speaker.

The terminal is damaged and may cause injuries or electric shock, etc.



Do

If charging cannot be complete after the specified charging time has passed, stop charging.

Not doing so may cause fire, burns, injuries, etc. due to overcharge.



Do

Make sure to turn off the terminal or stop charging before you get close to places where flammable gas or dust can be generated.

May cause explosion, fire, etc. if the flammable gas, etc. catches fire.



Do

Follow the instructions of facility for use in a gas station, etc.

Do not charge the battery in a gas station, etc.

Also, be careful not to drop the terminal when using in a gas station, etc. Do not use it especially during oil feeding.

May cause explosion, fire, etc. if the flammable gas, etc. catches fire.



Do

If the equipment gives off a strange smell, noise, smoke, or generates heat or becomes discolored or deformed during use, charge, or storage, perform the following operations with safety and care.

- Remove the power plug from a power outlet or accessory socket.

- Power off the terminal.

Not doing the above operations may cause fire, burns, injuries, electric shock, etc.



CAUTION



Don't

Do not use the damaged terminal.

May cause fire, burns, injuries, etc.



Don't

Do not leave the terminal on unstable or sloping surfaces. Be careful especially while the vibrator is set.

The terminal may fall and cause injuries etc.



Don't

Do not store the equipment in extremely humid, dusty or hot areas.

May cause fire, burns, electric shock, etc.

For the waterproof and dustproof functions, refer to the following.

→P25 "Waterproofness/Dustproofness, shock resistance"



Don't

When children use the terminal, do not let them use incorrectly without instruction by an adult for proper use.

May cause accidental ingestion, injuries, electric shock, etc.



Don't

Do not store the equipment within the reach of infants or pet animals.

Especially be careful with a storage location for small parts such as the tray of slot cap.

May cause accidental ingestion, injuries, electric shock, etc.



Do

Be careful when using the terminal continuously or while charging as it gets hot. Also, be careful not to touch it unintentionally and continuously when you put the terminal in a pocket of clothes, you fall asleep, etc.

When using applications, call, data communication, video, etc. for a long time or when charging the battery, the terminal and adapter may become hot. Directly touching a hot part for a long time may cause redness, itching or rash on your skin, or it may result in low-temperature burns depending on your constitution and/or health condition. Be careful when you put the terminal in a pocket of clothes, when you sleep, etc.

◆ Handling the terminal



DANGER



Don't

Do not throw the terminal into fire or apply heat.

May cause fire, burns, injuries, etc.



Don't

Do not apply excessive force such as sticking a sharp object (nail etc.), hitting with a hard object (hammer etc.), or stepping on.

May cause fire, burns, injuries, etc.



Do

If the internal substance of the terminal gets into your eyes, mouth, etc., immediately rinse your eyes with clean water and see a doctor right away.

Not doing so may cause blindness, medical problem, etc. due to effects of the internal substance of the terminal etc.

WARNING



Don't

Do not turn on the flash/light with the lighting part close to other person's eyes. Keep enough distance especially from small children.

Not doing so may impair eyesight etc. Also, the light may dazzle or astonish a person resulting in an accident such as injury.



Don't

Do not turn on the flash/light toward drivers of cars, etc.

May disturb driving and cause an accident, etc.



Don't

Do not watch the display that blinks repeatedly for a long time.

May cause spasm, loss of consciousness, etc.



Don't

Do not allow a foreign substance such as water and other liquids (drinking water, sweat, seawater, urine of pet animals, etc.), metal parts (blades of cutter, staples, etc.) or flammables to get in the slot of the slot cap of the terminal. Insert the nano SIM card or the microSD memory card in the correct place and in correct direction.

May cause fire, burns, injuries, electric shock, etc.



Don't

Do not expose the camera lens to direct sunlight for an extended period.

May cause fire, burns, injuries, etc. due to the light-collecting mechanism of the lens.



Don't

Do not sound the emergency buzzer close to the ear.

May affect your ears such as difficulty in hearing.



Do

Turn off the terminal or put it in Airplane mode before boarding an airplane.

The use of mobile phones on airplanes is restricted. Follow the instructions of each airline.

The radio wave from the terminal may adversely affect on-board electronic equipment.

Prohibited acts related to mobile phone usage on an airplane may be punished by law.



Do

When using the terminal in a medical facility, be sure to observe the regulations of the facility.

Turn off the terminal in a place where the use is prohibited. The radio wave from the terminal may affect electronic equipment and electronic medical equipment.



Do

When using the handsfree call, ringtone is ringing loud, or in the standby mode, be sure to keep this terminal off of the ears.

Also, when playing games, video, or music with an earphone microphone connected to the terminal, adjust the volume to the proper level.

Loud sound is emitted from the terminal when calling with hands-free set.

Even in standby mode, a ringtone or alarm may sound suddenly.

Hearing loud sound for a long time continuously may affect your ears such as difficulty in hearing.

Also, too loud sound hinders you from hearing ambient sound and it may cause an accident.



Do

If you have weak heart, be careful when setting the incoming vibrate alert (vibration) or alert volume setting.

Sudden incoming vibration or ringtone may astonish you and it may affect your heart.



Do

When you use electronic medical equipment, check with the equipment manufacturer to determine how the device is affected by radio waves before using.

The radio wave from the terminal may affect electronic medical equipment etc.



Do

Turn the terminal OFF near high-precision electronic control equipment or electronic equipment using low-power signals.

The radio wave from the terminal may interfere with the operation etc. of electronic devices or equipment.

* Examples of electronic equipment to avoid

Hearing aids, implanted pacemakers or defibrillators, other electronic medical equipment, and other automatic control equipment. Users wearing implanted pacemakers or defibrillators, or using other electronic medical equipment should check with the manufacturer or sales outlet about the effect of radio frequencies on the equipment.



Do

When the glass of the display or camera lens, etc. is accidentally broken, be careful of broken glass or exposed internal parts of the terminal.

If you mistakenly touch broken or exposed parts, you may have burns, injuries, electric shock, etc.



Do

If a substance from the internal battery leaks or gives off a strange smell, immediately stop using the terminal and keep it away from the vicinity of fire.

The leaked fluid may catch fire resulting in ignition, explosion, etc.



Do

Be careful not to let your pet bite the terminal.

May cause fire, burns, injuries, etc. resulting from the damage of the internal battery.



CAUTION



Don't

When using the motion sensor, check the safety around you, hold the terminal firmly, and do not shake it unnecessarily.

May cause accident such as injuries.



Don't

If the display breaks and the substance leaks out from inside, do not let the fluid contact with the skin of your face or hands or clothes.

May cause eye or skin problems.

If the substance inside enters your eyes, mouth, etc., or contacts skin or clothes, immediately rinse the contacted area with clean water.

If the fluid etc. enters your eyes, mouth, etc., immediately see a doctor after rinsing.



Don't

Do not discard the old terminal together with general garbage.

May cause fire, burns, injuries, etc. Also, it may cause environmental destruction. Bring the unnecessary terminal into a sales outlet such as XXXXX Shop. If your local municipality has a recycling program, dispose of them as provided for.



Don't

If a substance leaks from the internal battery, do not let the fluid contact with the skin of your face or hands, or clothes.

May cause eye or skin problems.

If the substance inside enters your eyes, mouth, etc., or contacts skin or clothes, immediately rinse the contacted area with clean water.

If the fluid etc. enters your eyes, mouth, etc., immediately see a doctor after rinsing.



To use the terminal in a car, check with the car manufacturer or the dealer to determine how the device is affected by radio waves before using.
In rare cases, the radio wave from the terminal may affect the vehicle's electronic equipment in some vehicle models. In that case, stop using the terminal immediately.



If you develop skin problems, stop using the terminal immediately, and see a doctor.
The use of the terminal may cause itching, rashes, eczema, or other symptoms depending on the user's physical condition.
For materials of parts, refer to the following.
→P18 "Material list"



Make sure that there are no adhered metal pieces (cutter blade, staples, etc.) as the out-camera, earpiece, speaker part, and vibrator part (bottom of back side) of the terminal generates magnetism.
Not doing so may cause injuries, etc. due to adhered objects.



When watching the display screen, keep a certain distance from the display in a fully bright place.
Not doing so may reduce visual acuity.

◆ Handling the adapter

WARNING



Do not use the adapter cord if it gets damaged.
May cause fire, burns, electric shock, etc.



Always use the DC adapter with a negative-ground vehicle. Do not plug it into a positive-ground vehicle.
May cause fire, burns, electric shock, etc.



When it starts to thunder, do not touch the adapter.
May cause electric shock, etc.



Do not short-circuit the charging jack while it is connected to a power outlet or accessory socket. Do not touch the charging jack with your hands, fingers, or any part of your body.
May cause fire, burns, electric shock, etc.



Do not place heavy objects on the adapter cord, or do not pull the cord with excessive force.
May cause fire, burns, electric shock, etc.



When you insert and remove the AC adapter from power outlet, do not contact metal objects with the jack.
May cause fire, burns, electric shock, etc.



Do not use a transformer (travel converter for overseas use) for the AC adapter.
May cause ignition, heat generation, electric shock, etc.



Don't

Do not apply excessive force on the connected part when the adapter is connected to the terminal.

May cause fire, burns, injuries, electric shock, etc.



No wet hands

Do not touch the adapter cord, charging terminal, or power plug with wet hands.

May cause fire, burns, electric shock, etc.



Do

Only use with the specified power source and voltage.

When charging the terminal overseas, use an AC adapter for global use.

If incorrect voltage is used, this may cause fire, burns, electric shock, etc.

AC adapter : 100V AC (Connect to an AC outlet for internal household use)

AC adapter for global use : Between 100V and 240V AC (Connect to the AC outlet for internal household use)

DC adapter : 12V or 24V DC (specific for negative ground vehicle)



Do

When replacing the DC adapter's fuse, replace it only with a specified fuse.

Replacing with a different type of fuse might cause fire, burns, electric shock, etc. For the specified fuse, see the provided instruction manual.



Do

Wipe off any dust that accumulates on the power plug.

Not doing so may cause fire, burns, electric shock, etc.



Do

When you connect the adapter to an outlet or accessory socket, firmly connect it to the outlet.

Not doing so may cause fire, burns, electric shock, etc.



Do

When you disconnect the power plug from an outlet or accessory socket, do not pull the adapter cord with excessive force. Instead, hold the adapter to disconnect.

Not doing so may cause fire, burns, electric shock, etc.



Do

When you remove or insert the adapter from/to the terminal, do not pull the adapter cord with excessive force. Instead, remove or insert the adapter straight.

Not doing so may cause fire, burns, injuries, electric shock, etc.



Do

Immediately stop using the terminal if the charging jack is deformed. Do not use it with the deformation restored.

May cause fire, burns, injuries, electric shock, etc. due to short circuit of the charging jack.



Unplug

Always remove the power plug from an outlet or accessory socket when not using the adapter.

Not doing so may cause fire, burns, electric shock, etc.



Unplug

Immediately disconnect the power plug from an outlet or accessory socket if liquid such as water (drinking water, sweat, seawater, urine of pet animals, etc.) is on the device.

Not doing so may cause fire, burns, injuries, etc. due to short-circuit from the adhered liquid etc.



Unplug

Always remove the power plug from an outlet or accessory socket when cleaning.

Not doing so may cause fire, burns, electric shock, etc.



CAUTION



Don't

Do not touch the adapter continuously while it is connected to an outlet or accessory socket.

May cause burns, etc.

◆ Handling the nano SIM card



CAUTION



Do

Be careful of the cut surface when handling a nano SIM card as it may damage a part of your body such as fingers.

The cut surface may be sharp and it may cause injuries, etc.

◆ Handling mobile phones near electronic medical equipment



WARNING



Do

Wearers of medical equipment such as implanted pacemakers or defibrillators must carry or use the terminal at least 15 cm away from the implanted part.

The radio wave from the terminal may affect the performance of electronic medical equipment.



Do

When using electronic medical equipment other than implanted pacemaker or defibrillator outside of medical facilities (such as in home care setting), check with the manufacturer to determine how the medical equipment is affected by radio waves.

The radio wave from the terminal may affect the performance of electronic medical equipment.



Do

Make sure that the terminal will not emit any radio waves (turn off power, put it in Airplane mode, etc.) if within 15 cm of those around you, such as where crowded and you cannot move freely.

There may be wearers of medical equipment such as implanted pacemakers or defibrillators around you. The radio wave from the terminal may affect the performance of electronic medical equipment.



Do

When using the terminal in a medical facility, be sure to observe the regulations of the facility.

The radio wave from the terminal may affect the performance of electronic medical equipment.

◆ Material list

■ FCG02

Part		Material/Surface treatment
Display panel		Hardened glass/AF coating
Exterior case (side)		Aluminum + PBT resin/Alumite treatment, none
Exterior case (back side)		PC + PMMA/Hard coating
Earpiece		Aluminum/Alumite treatment
Flash/Light panel		PC resin/None
Out-camera panel		Hardened glass/AF coating
Camera frame		Aluminum/Alumite treatment
Power key/Fingerprint sensor		Epoxy resin/Acrylic coating treatment
Volume key		PC resin/Acrylic UV curing coating treatment
Slot cap	Cap body	PC resin/Acrylic UV curing coating treatment
	Cap body packing part	Silicon rubber/None
	Cap body tab part	Polyester elastomer resin/None
	Tray	POM resin/None
USB Type-C jack		PA resin/None

Handling precautions

◆ General

- **FCG02 is waterproof/dustproof; however, do not allow water or other liquid (drinking water, perspiration, seawater, urine of pet animals, etc.) or dust to enter into this terminal or to come in contact with optional accessories.**
 - The adapter and nano SIM card are not waterproof/dustproof. Do not use in a highly humid area such as bathroom, or a place exposed to the rain. Or putting them on your body, humidity of sweat may cause internal corrosion and malfunction. Malfunctions which are determined to be caused by water as result of inspections are not covered by the warranty. For repairs, see "Warranty and After-Sales Service" (→200).
- **Clean the terminal with a dry soft cloth (such as a cloth for eyeglasses).**
 - Rubbing roughly may scratch the display.
 - Drops of water or dirt left on the display may cause stains.
 - If the terminal is wiped with thinner or benzene, the printing may disappear or color may fade.
- **Disinfection and sterilization**
 - You can disinfect this terminal or remove certain amount of virus from it with an alcoholic sanitizing wipe or spray.*¹ When you disinfect or sterilize the terminal, turn off the display beforehand to avoid malfunction.

If you spray this terminal with alcohol disinfectant, keep it off about 5 cm from the terminal and wipe off the disinfectant, and then wipe the terminal with a damp cloth to remove alcohol and disinfectant.

If you use an alcoholic sanitizing wipe or paper towel soaked in alcohol disinfectant, wipe the terminal with it and then wipe it with a damp cloth to remove alcohol and disinfectant.

- The following agents can be applied to this terminal. Alcohol*2, Hypochlorous acid water, Surfactant (kitchen detergent), Surfactant (furniture detergent) However, use the agents in which 0.05w/v% or less chlorine or chlorinated additive is contained.

*1 Verified by FCNT in-house testing based on the disinfection method released by Ministry of Health, Labour and Welfare, Ministry of Economy, Trade and Industry (National Institute of Technology and Evaluation: NITE) and Consumer Affairs Agency. (Performance of this terminal is confirmed under the test environment, and the test does not guarantee all disinfectants or detergents can be applied to this terminal.)

*2 Commercially available alcohol (ethanol) disinfectant and alcohol (ethanol) wet tissue

- **On occasion, clean the jack, fingerprint sensor, etc. to use it.**
 - If the jack etc. is dirt, you may not use the terminal normally.
When cleaning, be careful not to damage the jack etc.
- **Do not place the terminal near an air-conditioner outlet.**
 - The rapid change in temperature may cause condensation, causing internal corrosion and malfunction.

- **Do not apply excessive force to the terminal.**

- Putting the terminal into a tightly packed bag or sitting on the terminal in your pocket might cause malfunction or damage of the display, internal circuit board, internal battery, etc.

And, if an external device is plugged into the external connection jack, malfunction or damage may result.

- **Use the optional devices specified by XXXXX.**

- Using unspecified devices may cause malfunction or damage.

- **Read the instruction manuals supplied with individual optional devices.**

- **Do not let the terminal or the accessory fall or do not give a strong impact to it.**

- May cause malfunction or damage.

◆ The terminal

- **Do not press the display strongly or do not use sharp-pointed object when operating.**

- The display may get scratched and it may cause malfunction or damage.

- **Avoid extreme high or low temperature.**

- Use the terminal in a place where the temperature ranges between 5 and 35°C and humidity ranges between 45 and 85%.

For using in a bath room, refer to "What you can do with waterproofness of FCG02" (-27).

- **The terminal may affect household electronic equipment (TV, radio, etc.) in use nearby, so use it as far as possible from these appliances.**

- **Be sure to back up the data you saved in the terminal on a microSD card, PC, or cloud service, or keep a separate note.**
 - Note that XXXXX is not liable for any loss of saved data.
- **Do not plug an external device into the external connection jack at a slant, or do not pull it forcibly while it is plugged.**
 - May cause malfunction or damage.
- **It is not abnormal if the terminal becomes warm while in use and charging. Continue to use it.**
- **Do not leave the terminal with the camera lens in areas under strong direct sunlight.**
 - May cause discoloring or burn-in of elements.
- **Use the terminal with the slot cap closed.**
 - Not doing so may cause malfunction due to entering foreign objects such as water or other liquid (drinking water, perspiration, seawater, urine of pet animals, etc.) or dust to the terminal
- **Do not subject the fingerprint sensor to strong impact or scratch the surface.**
 - Doing so not only may cause a malfunction of the fingerprint sensor, but also authentication may become unavailable.
- **While microSD card is being used, do not take the card out or do not turn off the terminal.**
 - May cause data loss or malfunction.
- **Do not let a magnetic card or magnetized object close to the terminal.**
 - Magnetic data in cash cards, credit cards, prepaid IC cards, etc. may be erased.
 - Bringing strong magnetism near may cause malfunction of the terminal.
- **Do not decorate the terminal with films or stickers.**
 - May hinder the proper operations for functions using the proximity sensor.
 - For a location of the proximity sensor, see the following.
→P36 "Part names and functions"
- **The internal battery is not covered by the warranty because it is consumable.**
 - The internal battery may swell out as it comes to near the end of its lifetime depending on the usage conditions.
 - Replace the internal battery if the terminal has extremely short operation time on a full charge or when the internal battery is swelled out. Upon request, XXXXX will replace the internal battery for a fee. We will take repairs at the repair reception. See "Warranty and After-Sales Service" (→P200).
- **Charge the battery in an area within the proper ambient temperature range (5-35°C).**
- **The operation time provided by the internal battery varies by the operating environment and internal battery deterioration.**
- **When storing the terminal, avoid the following conditions so as not to deteriorate the performance or lifetime of the internal battery.**
 - Storing under the state of the full charge (right after charging ends)
 - The battery has run out (the terminal cannot be turned on)
 - The appropriate battery level for storing is about 40%.
- **The terminal has the following type of internal battery.**

Display	Battery type
Li-ion 00	Li-ion battery

◆ Adapter

- Charge the battery in an area within the proper ambient temperature range (5-35°C).
- Do not charge the battery in the areas below.
 - In areas of excessive humidity, dust or vibrations
 - Near household electronic equipment (TV, radio, etc.)
- It is normal for the adapter to become hot while charging. Continue to use it.
- When using the DC adapter for charging, keep the vehicle engine running.
 - The vehicle's battery could become flat.
- When using an outlet with a mechanism preventing unplugging, follow the handling instructions for that outlet.
- Do not give strong shock. Do not deform the charging terminal
 - May cause malfunction.

◆ nano SIM card

- Do not use excessive force to install/remove nano SIM card.
- Note that XXXXX assumes no responsibility for malfunctions occurred as the result of inserting and using nano SIM card with another IC card reader/writer.
- On occasion, clean the IC part to use it.
 - If the IC part has dirt, the terminal may not operate normally.
- For cleaning, use a soft, dry cloth (such as a cloth for eyeglasses) to wipe.
- Be sure to back up the data you saved in the nano SIM card on a microSD card, PC, or cloud service, or keep a separate note.
 - Note that XXXXX is not liable for any loss of saved data.
- Take an unnecessary nano SIM card to a sales outlet such as a XXXXX Shop for proper disposal in order to protect the environment.
- Take care not to scratch, touch accidentally or short-circuit the IC.
 - May cause data loss or malfunction.
- Do not drop nano SIM card or subject it to impact.
 - May cause malfunction.
- Do not bend nano SIM card or place a heavy object on it.
 - May cause malfunction.
- Do not install nano SIM card into the terminal with a label or sticker put on.
 - May cause malfunction.

◆ Bluetooth function

- The terminal is equipped with the security features, that are compliant with Bluetooth standards for communication via Bluetooth. However, depending on the settings, there may not be enough security. Be aware of security risks when using Bluetooth.
- XXXX assumes no responsibility for any information which may be leaked during communication via Bluetooth.

- Frequency bands

Frequency bands used by the terminal Bluetooth function are as below.



- ① 2.4 : Radio equipment that uses the 2400 MHz band.
- ② FH/XX : The modulation is the FH-SS method or other method (method other than DS-SS method/DS-FH method/FH-OFDM composite method/OFDM method).
- ③ 1 : The expected interference distance is 10 m or shorter.
- ④  : All bandwidths between 2400 MHz and 2483.5 MHz are used, and the bandwidth used by mobile object identification devices cannot be avoided.

Use of Bluetooth function is limited in some countries.

Confirm regulations of the country/region to use it.

To use in airplane, confirm with airline company in advance.

Cautions on using Bluetooth devices

In the bandwidth used by the terminal, in addition to home electric appliances such as a microwave oven and industrial/scientific/medical devices, in-plant radio stations used to identify mobile objects used in production lines of a factory that require a license, specified low power radio stations, or amateur radio stations that do not require a license (hereafter "other radio stations") can be in operation.

1. Before using the terminal, check whether "other radio stations" are in operation in your neighborhood.
2. If radio wave interference occurs between the terminal and "other radio stations", use the terminal in a different location or "Turn the power OFF" to avoid the radio wave interference.
3. For details, contact the contacts on the last page of this manual.

◆ Wireless LAN (WLAN)

- **Wireless LAN (WLAN) exchanges information using radio waves, and allows you to freely establish LAN connection if you are within an area where radio wave reaches. On the other side, if you communicate without appropriate security settings, communications may be intercepted or hacked by malicious parties. It is recommended to make necessary security settings on your judgment and responsibility.**
- **XXXXX assumes no responsibility for any information which may be leaked during communication via wireless LAN.**
- **Wireless LAN**
Do not use wireless LAN in a place where magnetized by electric products, AV, OA equipment, etc. or where electromagnetic wave is generated.
 - If magnetism or electrostatic noise affects the terminal, noise may be increased or communication may not be available (especially when using microwave oven, it may affect the terminal).
 - Using near TV or radio may cause poor reception or TV screen may be blurred.
 - When multiple wireless LAN access points exist near the terminal and they use the same channel, search may not be performed correctly.

● Frequency bands

The frequency band used by the terminal's wireless LAN function is written as follows:

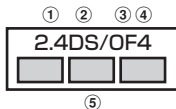

- ① 2.4 : Radio equipment that uses the 2400 MHz band.
- ② DS : The modulation is the DS-SS method.
- ③ OF : The modulation is the OFDM method.
- ④ 4 : The expected interference distance is 40m or shorter.
- ⑤  : All bandwidths between 2400 MHz and 2483.5 MHz are used, and the bandwidth used by mobile object identification devices can be avoided.

Available channels vary by countries. To use WLAN overseas, check the conditions such as available frequency and regulation for the country.

To use in airplane, confirm with airline company in advance. When the terminal is out of service area, channels 12 and 13 of 2.4 GHz band are not available regardless of whether you are in Japan or abroad.

Cautions on using 2.4 GHz devices

In the frequency band used by WLAN devices, in addition to home electric appliances such as a microwave oven and industrial/scientific/medical devices, in-plant radio stations for identification of mobile objects used in production lines of a factory (a license is required), specified low power radio stations (a license is not required), or amateur radio stations (a license is required) can be in operation.

1. Before using this device, confirm that in-plant radio stations for identification of mobile objects, specified low power radio stations or amateur radio stations are not in operation in your neighborhood.
2. If this device generates harmful radio wave interference against in-plant radio stations for identification of mobile objects, change the using frequency promptly or stop using wireless LAN function, and contact the contacts on the last page of this manual, then consult about treatment for prevention of the interference (for example, installation of partitions etc.).
3. If this device generates harmful radio wave interference against in-plant radio stations for identification of mobile objects or amateur radio stations, or if any trouble, contact the contacts on the last page of this manual.

Cautions on using 5 GHz devices

Using wireless LAN in 5.2/5.3 GHz outdoors is prohibited by law (except when communicating with a base station of data communication system for 5.2 GHz high power frequency band or relay station).

Channel numbers and frequency bands available in Japan are as follows.

- 5.2 GHz band : 5,180 to 5,240 MHz (36, 38, 40, 42, 44, 46, 48 ch)
- 5.3 GHz band : 5,260 to 5,320 MHz (52, 54, 56, 58, 60, 62, 64 ch)
- 5.6 GHz band : 5,500 to 5,720 MHz (100, 102, 104, 106, 108, 110, 112, 116, 118, 120, 122, 124, 126, 128, 132, 134, 136, 140, 144 ch)

◆ FeliCa and NFC reader/writer

- **The FeliCa and NFC reader/writer, P2P function for the terminal handle delicate signals that require no radio station license.**
- **They use 13.56 MHz frequency band. When the other FeliCa or NFC reader/writer, P2P function is used in the surroundings, keep the terminal away sufficiently from them.**
Before using, confirm that there are no radio stations using the same frequency band nearby.
- **To use in airplane, confirm with airline company in advance. Use is limited in some countries.**
Confirm regulations of the country/region to use it.

◆ CAUTION

- **Do not use a remodeled terminal. Using a remodeled terminal violates the Radio Law/Telecommunications Business Act.**

The terminal is compliant with rules on the technical standard conformance of specified wireless equipment based on the Radio Law/Telecommunications Business Act, and as a proof of it, the "Technical Compliance Mark" is depicted on the electronic nameplate of the terminal.

You can check the electronic nameplate in the terminal as follows.

From the Home screen, [Settings] → [About phone] → [Regulatory labels]

If you remodel the terminal by removing its screws, your certification of technical standard conformance becomes invalid. Do not use the terminal with its certification of technical standard conformance invalid as it violates the Radio Law/Telecommunications Business Act.

- **Be careful when you use the terminal while driving a car etc.** Unless otherwise specified by law, there is a penalty for gazing at the screen of the terminal or holding the terminal while driving.
- **The FeliCa and NFC reader/writer functions are compliant with the wireless standards of Japan. Check the regulations of the country/region beforehand if you try to use the function overseas.**
- **Do not alter the basic software.**

Repairs may be refused as a modification of software.

Waterproofness/Dustproofness, shock resistance

FCG02 provides waterproofness property of IPX5^{*1}, IPX8^{*2}, and dustproofness property of IP6X^{*3} with the card slot cover firmly closed. Also, the terminal comprises the shock resistant structure which passed the test^{*4} in accordance with United States Military Standard.

- *1 IPX5 means that a communication device keeps functioning after applying a jet flow of 12.5 L/min. from every direction from a distance of approximately 3 m for at least 3 minutes using water nozzle in 6.3 mm inner diameter.
- *2 IPX8 means that a communication device keeps functioning after it is slowly submerged to depth of 1.5 m in static tap water at room temperature, left there for 30 minutes and then taken out.
- *3 IP6X, a degree of protection, indicates that the mobile phone can maintain its functionality to prevent dust particles from entering into the terminal even when it has been shaken for 8 hours in an apparatus containing dust particles 75 μm or less in diameter.
- *4 Carried out a drop test compliant with MIL-STD-810H Method 516.8 Procedure IV set forth by the U.S. Department of Defense.

Drop	Drop test from 1.22 meters height to iron plate in 26 directions
Shock resistance	Apply 40 G shock from 6 directions 3 times
Waterproofness (Immersion)	Immersion test at the depth of 1.5 meters for 30 minutes

Dustproofness (6-hours with specified wind speed)	Dust test for 6 hours consecutively (dust concentration of $10 \pm 7 \text{ g/m}^3$, wind speed of 8.9 m/s)
Dustproofness (90 minutes on weaker side)	Apply sand on the weaker side at least for 90 minutes
Salt water durability	Salt water durability test for 96 hours consecutively (2 cycles of 24 hours spraying of 5% salt water and 24 hours drying)
Dampproofness	High humidity test for 10 days consecutively (95% of humidity, 30°C - 60°C)
Solar radiation resistance (continuity)	Solar radiation test for 24 hours consecutively (total $1,120 \text{ W/m}^2$)
Solar radiation resistance (change) insolation	Solar radiation test with changing the temperature (49°C at the highest) and amount of ($1,120 \text{ W/m}^2$ at most) (3 cycles of 24 hour)
Vibration resistance	Vibration resistance test for 3 hours (1 hour for 3 directions)
Waterproofness (Wind and rain)	Wind and rain of 18 m/s for 30 minutes
Raindrop	Raindrop from 1 m height for 15 minutes
Heat resistance	Temperature durability test against -21 - 50°C sudden changes of temperature for 3 hours consecutively
Operation at high-temperature (60°C fixed)	Operation environment : High temperature test at 60°C

Operation at high-temperature (change 32 - 49°C)	High temperature test of 3 cycles of temperature changes of 32 - 49°C
Storage at high-temperature (70°C fixed)	Storage environment : High temperature test at 70°C
Storage at high-temperature (change 30 - 60°C)	High temperature test for 30 - 60°C changes of temperature
Operation at low-temperature (-20°C fixed)	Operation environment : Low temperature test at -20°C
Storage at low-temperature (-30°C fixed)	Storage environment : Low temperature test at -30°C
Operation at low pressure	Low pressure test for 1 hour consecutively (57.11 kPa /Approx. 4,572 m)
Storage at low pressure	Low pressure test for 1 hour consecutively (57.11 kPa /Approx. 4,572 m)
Freeze (-10°C condensation)	Condensation or mist at -10°C for 1 hour and operation check at 25°C , 95%RH (Freezing-thawing)
Freeze (-10°C freezing)	Freezing test with -10°C cooling water until 6 mm thick ice forms

Our tests which are in accordance with the procurement standard of 23 provisions established by the USA Department of Defense (MIL-STD-810H) are implemented: drop, shock resistance, waterproofness (immersion), dustproofness (6-hours with specified wind speed), dustproofness (90 minutes on weaker side), salt water durability, dampproofness, solar radiation resistance (continuity), solar radiation resistance (change), vibration resistance, waterproofness (Wind and rain), raindrop, heat resistance, operation at high-temperature (60°C fixed), operation at high-temperature (change 32 - 49°C), storage at high-temperature (70°C fixed), storage at high-temperature (change 30 - 60°C), operation at low-temperature (-20°C fixed), storage at low-temperature (-30°C fixed), operation at low pressure, storage at low pressure, freeze (-10°C condensation), freeze (-10°C freezing). Performance of the terminal is confirmed at under the test environment, it does not guarantee the operation of actual use in every situation. Also, it does not guarantee the non-damage and trouble-free.

❖ What you can do with waterproofness of F-52E

- **You can use the terminal to talk without using an umbrella in the rain (with a rainfall of about 20 mm per hour).**
 - When your hands or the terminal are wet, avoid opening/closing the slot cap.
- **The terminal can be washed with tap water at room temperature.**
 - Hold the slot cap so as not to open and wash without rubbing strongly.
 - Do not apply water flow stronger than allowed (→F25).
 - Do not use brush, sponge, soap other than specified one (→F27), etc.
 - If mud or dirt adheres to your terminal, shake the terminal several times in tap water of a washbowl or other container to rinse the mud or dirt off and then wash away with running water.
 - Drain water in the specified steps (→F34) after washing.
- **You can wash the terminal using a foam type hand soap for home use which is manufactured by domestic manufacturer, or liquid type detergent for the tableware which is manufactured by domestic manufacturer (Confirmed by FCNT LLC in-house testing). Do not use soap (bar soap, soap powder, etc.) other than those mentioned above.**
 - For washing, refer to "How to wash" (→F31).
- Performance of the terminal is confirmed under the test environment, therefore, it does not guarantee that all of foam type hand-soap or liquid type detergent for tableware is available for washing.

- Thoroughly rinse the foam from the terminal with somewhat weak water flow (less than 6 L/min., room-temperature tap water). After washing, drain water with a dry clean cloth.
- When washing the terminal, be sure to attach the slot cap.
- You can use the terminal in a bathroom.
 - After using in a bathroom, drain water in the specified steps (→P34).
 - Do not immerse the terminal into a bathtub. Also, do not use the terminal in hot water. May cause malfunction. If you should fall the terminal into the bathtub, immediately pick it up to drain water in the specified procedure (→P34).
 - Never put the terminal in hot spring water or water containing soap, detergent or bath powder which is other than those specified (→P27). In case the terminal gets wet with water other than tap water, wash it in the procedure previously mentioned.
 - In a bathroom, use the terminal under the condition of the temperature 5°C - 45°C and the humidity 45% - 99% (however, temperature of more than 36°C or humidity of more than 86% is limited to temporary use). Note that XXXXX does not guarantee the successive operations of every function.
 - Do not put hot water from a faucet or shower.
 - If you bring the terminal from a cold place to a warm place, dew may be condensed on the display or surface of the case due to sudden changes of temperature. When you are hard to watch the display or make touch operations due to dew condensation, wait for a while until the temperature of the terminal become normal.

◆ To ensure waterproofness/dustproofness

To prevent water or dust from entering the terminal, be sure to observe the following points.

- For installing/removing nano SIM card or microSD card, turn the display side of the terminal down, put your fingertip into the groove to open the slot cap, and then horizontally pull out the slot cap straight in the direction of the arrow.
 - * When the slot cap is open, do not push the slot cap strongly downward. May cause a damage of the slot cap.

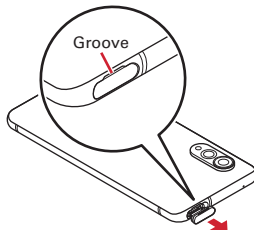

- After using, insert the slot cap straight into the upper slot in the direction of the arrow straight, firmly press  part. Make sure that there is no gap between the terminal and the slot cap.

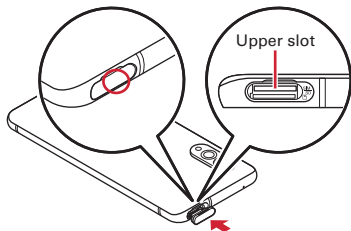

- Make sure to firmly close the slot cap. Even a fine obstacle (one hair, one grain of sand, tiny fiber, etc.) which is put between contact surfaces may allow water or dust to enter.
- Do not poke the USB Type-C jack, mouthpiece/microphone, earpiece, speaker, second microphone, slot cap, etc. with a sharp object.
- Do not let the terminal fall. Doing so may scratch the terminal, causing its waterproof/dustproof performance to degrade.
- The rubber seal in the slot cap plays an important part in waterproof/dustproof property. Do not damage or remove the rubber seals. Also, prevent dust from adhering to them.

It is recommended to replace the parts once every two years to maintain the waterproof/dustproof performance, regardless of whether an abnormality is present. Upon request, XXXXX will replace the parts for a fee at a XXXXX-specified repair office. For inquiries, see the last page of this manual.

◆ Important precautions

Do not perform actions shown in the illustrations below.

<Example>



Using Soap/Detergent/
Bath powder



Washing with
brush/sponge



Machine-washing



Applying strong
water flow



Soaking in
ocean water



Using in
hot spring

Observe the following precautions to use the terminal properly.

- The optional devices are not waterproof/dustproof. Do not use the AC adapter in a bath room, shower room, kitchen, lavatory, other wet area when the AC adapter is connected to the USB Type-C jack of the terminal.
- Do not apply water flow stronger than allowed (→P27). FCG02 is IPX5 waterproof, water may enter inside from a damaged section and cause troubles such as electric shocks or corrosion of the battery.
- If the terminal gets wet with salt water, sea water, refreshing beverage, etc. or mud or soil adhered, wash it immediately. If they dry out, it is hard to remove the dirt and it may cause damage or malfunction.
- Do not put the terminal in hot water, use it in a sauna or apply hot airflow (from a hair dryer etc.) to it.

- Do not move the terminal in water or slam the terminal against the surface of water.
- When you use the terminal in swimming pool, obey rules of the facility.
- The terminal does not float on water.
- Do not leave water droplets on the terminal. In a cold region, may cause the water to freeze, resulting in a malfunction.
- Do not leave water droplets on the mouthpiece/microphone, earpiece, speaker, and second microphone. Such water may interfere with talking.
- Do not let water droplet remain on the USB Type-C jack.
- For washing the terminal, use a foam type hand soap for home use which is manufactured by domestic manufacturer, or liquid type detergent for the tableware which is manufactured by domestic manufacturer. Do not use soap (bar soap, soap powder, etc.) other than those mentioned above.
- Do not use business use/additive-free/alkaline foam type hand soap or business use/additive-free/alkaline detergent for the tableware. Doing so may cause discoloring of the terminal.
- Do not wash with soap other than those specified (→P27), bathing powder, shampoo, hair rinse, facial cleanser, make-up remover, toothpaste, etc. When such substance is put on the terminal, immediately rinse with clean water.
- Hold the slot cap so as not to open and wash with your hands. Do not use a brush or sponge.
- Do not use a laundry machine, ultrasonic cleaning machine, dishwashing machine, etc.

- If the terminal gets wet with water or other liquids with the slot cap open, the liquid may get inside the terminal and cause electric shocks or malfunction. Stop using the terminal and turn it off. Contact the contacts on the last page of this manual for the measures to take.
- If the rubber seal of slot cap is damaged or deformed, replace it at a XXXXX-specified repair office. Note that we will repair the terminal for a fee depending on its status.

XXXXX does not guarantee actual operations under all states. Malfunctions deemed to be caused by inappropriate operation by the customer are not covered by the warranty.

◆ How to wash

For washing the terminal, confirm the precautions and perform in the following procedure.

- Remove the commercially available accessories (terminal cover, case, etc.). For handling commercially available accessories, refer to the notes of each product.
- Use a foam type hand soap for home use which is manufactured by domestic manufacturer, or liquid type detergent for the tableware which is manufactured by domestic manufacturer. Do not use soap (bar soap, soap powder, etc.) other than those mentioned above.
- Use the agents in which 0.05w/v% or less chlorine or chlorinated additive is contained.
- For using detergent for the tableware, thoroughly read the notes on use of the product and then follow the amount of use.
- Do not allow undiluted solution of detergent for the tableware to directly contact the terminal. If the undiluted solution is put on the terminal, immediately rinse with water.
- When washing the terminal, put off your watch, ring, or other decoration such as artificial nail. Doing so may scratch the main unit of the terminal.
- When washing the terminal, turn off the power in advance.
- Make sure to firmly close the slot cap.

- ① **Froth up foam type hand soap or detergent for the tableware in your hands. Put the terminal on your palm, and then rub the front surface and the back surface with the foam.**

- Hold the slot cap so as not to open while washing.

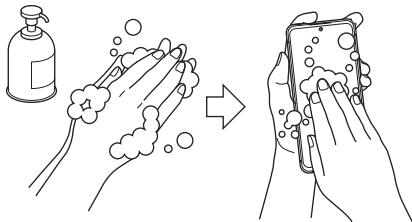

- ② **Completely rinse off the foam on the front surface, back surface, buttons, etc. of the terminal.**

- Wash in a position where the distance is approximately 10 cm from the tap or shower head, with somewhat weak water flow (6 L/min. or less, normal temperature tap water).
- Do not open or close the slot cap.
- Do not pour water directly on the slot cap.

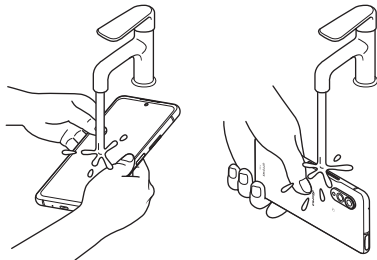

③ **Rinse the earpiece, second microphone, mouthpiece/microphone, USB Type-C jack, and speaker.**

- If substance of foam hand soap or detergent for the tableware is remained on the second microphone, earpiece, mouthpiece/microphone, or speaker, may cause deterioration of the sound quality of ringtone or during a call due to clogging.
- Also, those on the USB Type-C jack may cause malfunction such as charging failure. Thoroughly rinse it away.

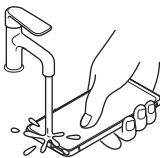

Earpiece



Second microphone



Mouthpiece/microphone
USB Type-C jack
Speaker

④ **Drain water. → P34**

- Dry well and then confirm that there is no water drop remained.

◆ Draining water

When the terminal is wet, water may flow out after wiping it off; drain the water in the following steps.

- ① Hold the terminal firmly and wipe off moisture on the front surface and back surface with dry, clean cloth etc.

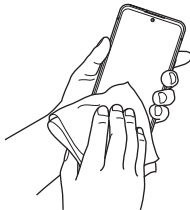

- ② Hold the terminal firmly and shake it approximately 20 times until there is no more water splattering. Turn the terminal over to switch the position of the earpiece and flash/light and then shake in the same way.

- Firmly hold the terminal so as not to drop it.



- ③ Push the terminal against a dry, clean cloth etc. about 10 times to completely wipe off the water in the gaps of the USB Type-C jack, mouthpiece/microphone, earpiece, speaker, second microphone, keys, etc.

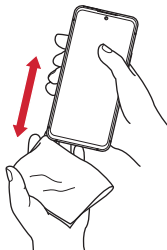

- ④ Wipe off water drained from the terminal with dry, clean cloth etc., and dry naturally.

- Water, if any, remaining in the terminal may ooze up after wiping off.
- Do not wipe off the remaining moisture in the gaps directly with a cotton swab etc.

◆ Charging

Check the following during and after charging.

- Never try to charge the battery when the terminal is wet.
- When charging the battery after the terminal gets wet, adequately drain the terminal and then wipe off the remaining water with a dry, clean cloth or something similar.
- Ensure that there are no water droplets or foreign objects on the USB Type-C jack before use.
- Do not use the AC adapter in a bathroom, shower room, kitchen, lavatory or other highly humid area. May cause fire or electric shock.
- Do not touch the AC adapter with wet hands. May cause electric shock.

Before using the terminal

Part names and functions

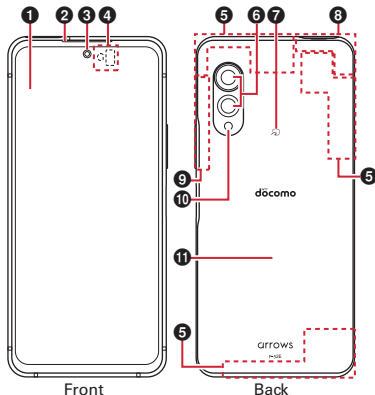

- ❶ Display (touch panel)→P51
- ❷ Earpiece
- ❸ In-camera→P104

- ❹ Proximity/Light sensor*1
Detects a face approach during a call to prevent misoperation of touch panel, and it is used for automatic control of the screen brightness.
- ❺ 5G/4G antenna section*2
- ❻ Out-camera→P104
- ❼  mark→P116
- ❽ 4G/Wi-Fi/Bluetooth®/GPS antenna section*2
- ❾ 5G/4G/GPS antenna section*2
- ❿ Flash/Light
- ⓫ Exterior case (back side)



Right side

12 Volume key

Use for adjusting of sound volume or shooting with the camera.

13 Power key/Fingerprint sensor→P44, P69, P70, P82, P155

Use when turning on/off the power or screen. Press and hold for 1 second or more to display the menu where you can turn off or restart the terminal, make an emergency call, and use security tools (Emergency buzzer/Imitation call).

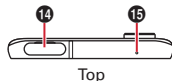

Top

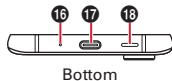

Bottom

14 Slot cap*3

15 Second microphone*4

Reduces noise during a call. Or, use as a mouthpiece during hands-free call.

16 Mouthpiece/microphone*4

17 USB Type-C jack (Waterproof)*5

Use when charging the terminal or connecting an earphone microphone, PC, etc. Compatible with USB Power Delivery.

18 Speaker

*1 Putting a protective sheet or sticker on the sensor or covering the sensor with fingers may cause erroneous operation or incorrect sensing result.

*2 It is built-in the terminal. Covering around the antenna by the hand may affect the communication quality.

*3 Install/remove after turning off the power. To avoid water or dust infiltration, be sure to close firmly.

*4 Do not put protective sheet, stickers, etc. or cover with your finger, etc.

*5 If you listen to a FM broadcast with radiko+FM, use an analog Type-C earphone cable (commercially available) or analog Type-C earphone conversion adapter (commercially available).

■ Notes

- The exterior case (back side) cannot be removed. Attempting to remove it with excessive force may cause damage or a malfunction.
- The battery is built into the terminal. You cannot replace it by yourself.

nano SIM card

A nano SIM card is an IC card that stores user information, such as the users phone number.

- You can use the terminal only with a nano SIM card. If you have a XXXXX mini UIM card, XXXXX UIM card, or FOMA card, bring it to a XXXXX Shop to replace it with a nano SIM card.
- If nano SIM card is not inserted to the terminal, some functions such as making/receiving calls, sending/receiving SMS, packet communication, etc. are not available.
- Do not draw out or insert the slot cap with the nano SIM card set when the power is turned on.
- For details on handling the nano SIM card, refer to XXXXX website.

◆ Installing/Removing a nano SIM card

- Install/remove after turning off the power.
- Be sure to use the slot cap when inserting a nano SIM card. Inserting of a nano SIM card alone may cause a malfunction.

■ Installing

- ① **Face the display side of the terminal down, put your fingertip into the groove, and then open the slot cap→P28**
- ② **Draw the slot cap in the direction of the arrow straight and horizontally**
 - The slot cap is designed to be separated from the terminal.

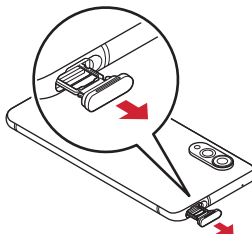

- ③ With the IC side the facing down, fit the nano SIM card into the tray (for nano SIM card) of the slot cap

- Check the orientation of nano SIM card corner cut.
- Be sure to fit the nano SIM card into the tray of the slot cap so that it does not shift.

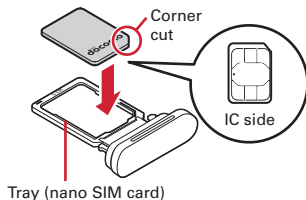

- ④ Check that the display side of the terminal faces down, and then insert the slot cap straight into the upper slot in the direction of the arrow horizontally

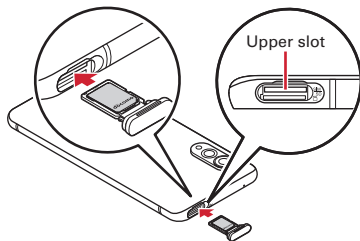

- ⑤ Firmly press the slot cap to close→P29

■ Removing

- ① Face the display side of the terminal down, put your fingertip into the groove, and then open the slot cap→P28
- ② Draw the slot cap in the direction of the arrow straight and horizontally→P38
- ③ Remove the nano SIM card from the tray of the slot cap
- ④ Check that the display side of the terminal faces down, and then insert the slot cap straight into the upper slot in the direction of the arrow horizontally→P39
- ⑤ Firmly press the slot cap to close→P29

✓INFORMATION

- When handling nano SIM card, take care not to touch or scratch the IC. Also, be aware that trying to insert or remove the nano SIM card using excessive force may cause it to break.
- For drawing/inserting the slot cap from/into the slot, do not draw or insert forcibly. Doing so may damage the slot cap.

◆ Security code for the nano SIM card

You can set up a security code called a PIN code for the nano SIM card.→P48

eSIM

The terminal supports eSIM, to which information such as user's phone number, etc. is registered.

- Setup is required to use eSIM.→P136

✓INFORMATION

- Be sure to back up the data you saved in eSIM on a microSD card, PC, or cloud service, or keep a separate note. Note that XXXXX is not liable for any loss of saved data.
- For details on eSIM, refer to XXXXX website.

microSD card

Save the data of the terminal to a microSD card or import the data of a microSD card to the terminal.

◆ microSD card

- The terminal supports microSD card of up to 2 GB, microSDHC card and microSDHC UHS-I card of up to 32 GB, microSDXC card and microSDXC UHS-I card of up to 1 TB (as of January, 2023).
- Note that XXXXX does not guarantee actual operations of all microSD cards. For information on compatible microSD cards, contact manufacturers of microSD cards.
- Do not power off the terminal while loading microSD card or editing the data of microSD card. Doing so may break the data or may affect operation of microSD card.
- Data transferred from the other device to a microSD card may not be displayed or played on the terminal. Data transferred from the terminal to a microSD card may not be displayed or played on other devices.

✓INFORMATION

- microSDXC card can be used only SDXC devices. Inserting a microSDXC card into a device that does not support SDXC may damage or destroy the data saved on the microSDXC card. Do not insert one. If you want to reuse a microSDXC card on which data is destroyed, format the microSDXC card (all data will be erased) on an SDXC device.
- When copying data to/from a non-SDXC-compatible device, use a microSDHC card or microSD card complying with standards of device to share data.

- When using an application handling large amount of data such as video recording, use a high-speed microSD card (Class 10 or more is recommended).
- For speed class of microSD card, up to Class 10 can be available.
- The terminal supports up to UHS Class 3 speed microSD card.
- Speed class is an efficiency of the microSD card and it does not guarantee all of the operations of the efficiency of speed class.

◆ Installing/Removing microSD card

- When installing/removing a microSD card with the nano SIM card installed to the slot cap, turn off the power in advance.
- When removing a microSD card without the nano SIM card installed to the slot cap, unmount the microSD card (→P146) or turn off the power in advance.

■ Installing

- ① Face the display side of the terminal down, put your fingertip into the groove, and then open the slot cap →P28
- ② Draw the slot cap in the direction of the arrow straight and horizontally →P38
- ③ With the metal contacts of the microSD card facing down, insert it into the lower slot horizontally until it clicks
 - Check that the orientation of the microSD card is correct.

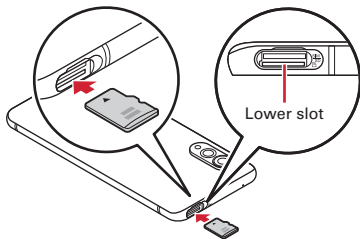

- ④ Check that the display side of the terminal faces down, and then insert the slot cap straight into the upper slot in the direction of the arrow horizontally →P39

- ⑤ Firmly press the slot cap to close→P29

■ Removing

- ① Face the display side of the terminal down, put your fingertip into the groove, and then open the slot cap→P28
- ② Draw the slot cap in the direction of the arrow straight and horizontally→P38
- ③ Push the microSD card slightly and release your finger, and then pull it out straight horizontally.

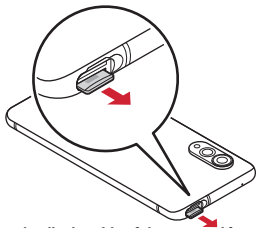

- ④ Check that the display side of the terminal faces down, and then insert the slot cap straight into the upper slot in the direction of the arrow horizontally→P39
- ⑤ Firmly press the slot cap to close→P29

✓ INFORMATION

- Note that the microSD card may jump out when removing it.

Charging

❖ Precautions on charging

- If you use applications while charging, it may take time to complete charging or charging may not complete due to drop-off of battery. To finish charging, end applications beforehand.
- It is normal for the terminal or AC adapter to become warm while charging. When the terminal becomes warm, charging may stop temporarily for the safety. When the terminal becomes extremely hot, stop using immediately.
- If the temperature of the internal battery or the terminal becomes out of range for charging, a charging error is notified. Wait until the temperature is dropped and then retry charging.
- If charging takes for very long time, a charging error is notified. Remove the terminal from the charger and retry.
- When the power voltage of the internal battery is abnormal, charging error occurs. Immediately exit any applications if you are using. Remove the terminal from the charger and charge it again in the proper manner. If you still fail to charge the terminal normally, remove the terminal from the charger, turn off the power, then contact "Repairs" on the last page of this manual (in Japanese only) or a XXXXX-specified repair office.
- When charging starts with the battery empty, the terminal may not be immediately activated after turning the power ON. In this case, charge the terminal with powered OFF, and turn it ON after a while.
- For charging time, see "Main specifications".→P202

- You can check the latest charging equipment compatible with the terminal in the XXXXX online shop.
<https://onlineshop.smt.xxxx.ne.jp/options/search.html>
(in Japanese only)

❖ Internal battery life

- The internal battery is a consumable part. Each time the internal battery is recharged, the battery usage time per one charge gradually decreases. Talking on the phone for a long time while charging may reduce the internal battery lifetime.
- You can check performance of the internal battery (charging ability) from "Battery and device care". → P45
- When the battery usage time per one charge becomes about half of that at the time of purchase, replacing the internal battery is recommended because the internal battery is near the end of life. For replacing the internal battery, contact "Repairs" on the last page of this manual (in Japanese only) or XXXXX-specified repair office.
- This is the recycle mark of li-ion batteries.
Manufacturer: FCNT LLC



Li-ion 00

❖ Available charging adapter

For details, refer to the manual of AC adapter, DC adapter, or USB cable.

AC Adapter 08 (optional) : Supports 100V to 240V AC. The shape of AC adapter plug is for 100V AC (Japanese specification). A conversion plug adapter for the destination country is required when using an AC adapter compatible from 100V to 240V AC. Do not use an electrical transformer for overseas use to charge the terminal.

DC Adapter (optional) : Used to charge in a car. For using, USB cable A to C 02 (optional) is required.

◆ Charging with AC adapter

Follow the procedure below to use AC Adapter 08 (optional) for charging.

- ① **Insert the Type-C plug of the AC adapter horizontally into the USB Type-C jack of the terminal**
- ② **Insert the AC adapter power plug into an outlet**
- ③ **When charging is complete, remove the AC adapter's power plug from the outlet**
- ④ **Remove the Type-C plug of the AC adapter horizontally from the USB Type-C jack of the terminal**

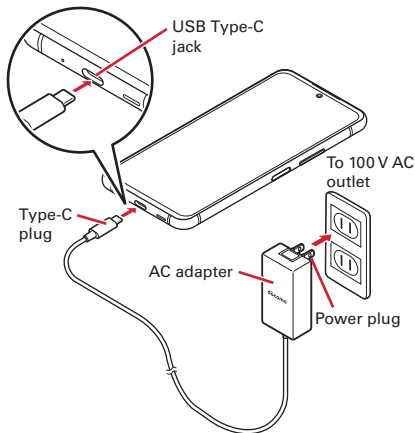

◆ Charging with a PC

You can charge the terminal via a PC using USB Cable A to C 02 (optional), etc.

- When the window of new hardware detection or the operation selection appears on the PC, close the window.

Turning power on/off

◆ Turning power on

- Before turning on the power, make sure that there is no gap between the terminal and the slot cap.

1 Press and hold Power key (2 sec. or more)

The terminal vibrates and the lock screen appears following the startup screen.

- For the first activation, make initial settings. → P46

2 Unlock the screen lock

- For unlocking method for screen lock, refer to "Unlocking screen lock". → P45

◆ Turning power off

1 Power key (1 sec. or more)

2 [Power off] → [OK]

The terminal turns off vibrating.

◆ Sleep mode

When the sleep mode is set, the screen backlight turns off so that you can avoid misoperation of the touch panel and lock the screen. You can also reduce the battery consumption.

1 Power key

✓INFORMATION

- Alternatively, when no operation is performed in a certain period of time, the screen automatically turns off according to the setting of [Screen timeout] (→P147) and goes into sleep mode.
- When receiving a call in sleep mode, sleep mode is deactivated.





◆ Unlocking screen lock

1 In sleep mode, Power key

2 On the lock screen, swipe up

The lock is canceled.



- Depending on the setting of [Security unlock preference] (→P152), authentication is required after swiping on the lock screen.
- Swipe  left on the lock screen to activate the out-camera.
- Slide  left on the lock screen, shift the finger on one of  /  / , and then release the finger to activate FAST Memo.→P121

✓INFORMATION

- The lock screen goes into sleep mode after approximately 10 seconds.

Initial settings

When you turn on the terminal for the first time, make initial settings following the on-screen instructions.

- Finish initial settings first if you make settings for eSIM when you use the terminal for the first time. →P136
- Depending on Google account settings, indicated items may vary.

1 Tap [日本語(日本) (Japanese)] and in "言語の選択 (Select language)", select [English]→[United States] or other option from the candidates of "All regions", and then [START]

- After selecting the language and region, the terminal restarts.
- From here on, follow the on-screen instructions to set.
 - Set network connection→P133
 - Select copying method of apps and data
 - Google account→P47
 - Google services
 - Set screen lock→P152
 - Unlock with fingerprint and register apps→P155
 - Google Assistant
 - Select Home screen→P71
 - My physical profile→P169
 - Electricity off-peak charging→P145
 - Easy data transfer support→P131
 - Send diagnostic data→P176

2 On the XXXXX initial settings screen, [Next]

3 On the confirmation screen for using functions, [NEXT]

4 Set up your d ACCOUNT following the onscreen instructions

Set d ACCOUNT for using in XXXXX apps.→P47

5 On the confirmation screen for using functions, [NEXT]

6 Set up each item

Easy bulk setting/Safety and ease of use : Make settings for functions and services to use this terminal safely and easily all at once.

7 In Anything else? screen, set each item→[Done for now]

The Home screen appears.

✓INFORMATION

- When the screen of Get started a new home screen!, a Function usage verification screen, a screen indicating how to use the Home screen (my daiz initial confirmation), a screen of xxxxx service selection, a Function usage verification screen appears, confirm the content and then operate following the on-screen instruction.

◆ Setting up Google Account

Google account is a user name/password for using the Google services. By setting up your Google account to the terminal, you can use Gmail to send/receive emails or Google Play to download applications or games.

1 From the Home screen,  → [Settings] → [Passwords & accounts]

2 [Add account] → [Google]

- After that, follow the on-screen instructions.

✓INFORMATION

- Multiple Google accounts can be set up in the terminal.

◆ Setting up d ACCOUNT

d ACCOUNT is an ID/password that is necessary for using services provided by XXXXX such as d POINT, dmarket, etc. on smartphones, tablets, PCs.

In this section, creating a new account is explained.

1 From the Home screen,  → [Settings] → [XXXXX service/cloud] → [d ACCOUNT setting]

2 [Create new d ACCOUNT]

- After that, follow the on-screen instructions to set the following items.
 - Email address
 - ID
 - Password
 - User information

Security codes used for the terminal

Some functions provided for convenient use of the terminal require the security code to use them. Make use of the terminal using an appropriate security code according to the purpose.

Notes on the security codes

- Avoid using a number that is easy to guess, such as "birth date", "part of your phone number", "street address number or room number", "1111", and "1234". Make sure to make a note of the security code you set lest you should forget it.
- Be very careful not to let others know your security code. If your security code is known by anyone else, XXXXX shall have no liability for any loss due to any unauthorized use of it.
- If you forget your security codes, you need to bring your official identification (such as driver's license), the terminal, and nano SIM card with you to the nearest xxxxx Shop. For details, contact the contacts on the last page.
- The PUK code is written on the subscription form (copy for customer) handed at the subscription in the xxxxx Shop. For customers who made subscription at a retailer other than xxxxx shop, contact the contacts on the last page.

❖ Pattern/Security code/Password for screen lock

Requiring authentication when unlocking the screen lock ensures the terminal security. For authentication types that can be set, pattern that is tracing at least 4 dots, security code consisting of 4- to 16-digit number, and password consisting of 4- to 16-digit alphanumeric including symbols.→P152

❖ Network security code

The network security code is a 4-digit number necessary for identification or using the XXXXX network services at reception of your request in XXXXX Shop, or at XXXXX Information Center or "お客様サポート (Customer support)". It can be set any number at the subscription and also changed later by yourself.

- For details on network security code, refer to XXXXX website.

❖ PIN code

You can set up a security code called a PIN code for your nano SIM card/eSIM. The code is set to "0000" at subscription, which you can change by yourself.→P50

PIN code is a 4- to 8-digit security number (code) that must be entered for user authentication to prevent unauthorized use of nano SIM card/eSIM by a third party every time you install the nano SIM card into the terminal or when the terminal is powered on. Entering the PIN code enables making/receiving calls and terminal operation. If you are using eSIM, entering the PIN code enables making/receiving calls and terminal operation.

- For using the nano SIM card that you have used on another terminal by inserting to this terminal, use the set PIN code on the former terminal. If you did not change the setting, the code is "0000". If you are using eSIM, the code is reverted to "0000" (default value) by reissuing eSIM.
- If you enter a wrong PIN code 3 times consecutively, the PIN code is locked (PUK lock) and cannot be used anymore. In this case, unlock with "PUK". Unlock the PIN code before setting new PIN code. A new PIN code cannot be set until the lock is unlocked.
- If nano SIM card is PIN locked or PUK locked, remove the nano SIM card to display the Home screen so that communication via Wi-Fi connection is available. If you are using eSIM, tap [Disable eSIM] on the PIN lock/PUK lock screen to display the Home screen.

❖ PUK code

The PUK code is an 8-digit number for canceling the locked PIN code. The PUK code cannot be changed by yourself.

- If you failed to enter PUK code 10 times consecutively, the nano SIM card/eSIM is locked. Please contact a XXXXX Shop.
- If nano SIM card/eSIM is PIN locked or PUK locked, remove the nano SIM card to display the Home screen so that communication via Wi-Fi connection is available. If you are using eSIM, tap [Disable eSIM] on the PIN lock/PUK lock screen to display the Home screen.

◆ Setting PIN code (SIM card lock)

Set to require entry of PIN code when powered on.

1 From the Home screen, → [Settings] → [Security] → [SIM card lock]

- If you are using the nano SIM card and eSIM at the same time, select the SIM to set.

2 [Lock SIM card] → Enter a PIN code → [OK]

✓INFORMATION -----

- When entering the PIN code for the first time, enter "0000".
- To cancel the setting, set [Lock SIM card] to OFF in Step 2.

❖ Entering PIN code

1 Turn on the power → on the PIN code entry screen, enter the PIN code →

❖ Unlocking PUK

When PIN code is locked (PUK lock), unlock the lock and then set a new PIN code.

1 On the code entry screen, enter the PUK code →

2 Enter a new PIN code →

3 Enter the new PIN code again →

◆ Changing PIN code

Set the PIN code (set [Lock SIM card] to ON) in advance.

1 From the Home screen,  → [Settings] → [Security] → [SIM card lock]

- If you are using the nano SIM card and eSIM at the same time, select the SIM to change the PIN code.

2 [Change SIM PIN]

3 Enter the current PIN code → [OK]

4 Enter a new PIN code → [OK]

5 Enter the new PIN code again → [OK]

Basic operation

Basic operation

◆ Using touch panel

Touch the touch panel directly to operate the terminal.

❖ Notes for using the touch panel

The touch panel is designed for being touched lightly with fingers. Do not push it forcibly with a finger or press it with sharp objects (nail, ballpoint pen, pin, etc.).

- Touching the touch panel may not work in the following cases. Note that it may cause malfunction.
 - Operation with tip of fingernail
 - Operation with a foreign object on the display
 - Operation with protective sheet or seal on the display
 - Operation with the touch panel wet
 - Operation with finger wet by sweat or water
 - Operation under water

❖ Tap/Double-tap

Tap : Touch the screen lightly and release the finger quickly.

Double-tap : Tap twice quickly.

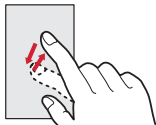

Example : Tap

❖ Touch and hold

Touch the screen for a while. Some operations can be operated by keeping touching the screen with a finger.

❖ Drag/Slide (Swipe)/Pan

Drag : Touch an item or icon on the screen and move it to the desired position.

Slide (Swipe) : Touch the screen with your finger and drag to the desired position.

- For some applications, you can touch the screen with your fingers and move them up and down or rotate them to operate.

Pan : Drag the screen in a direction to view the desired part when whole web page etc. is not displayed in one screen.

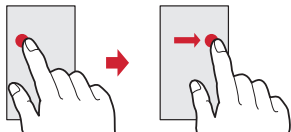

Example : Drag

❖ Pinch

Touch the screen with two fingers and widen (pinch-out) or narrow (pinch-in) the fingers distance.

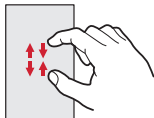

❖ Flick

Touch the screen and sweep the finger quickly.

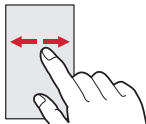

◆ Switching the portrait/landscape view automatically

With the motion sensor which detects orientation or movement, you can switch the screen display by tilting the terminal vertically or horizontally (Auto-rotate screen→P147).

- Even when you change the orientation of the terminal, the screen may not change depending on the screen displayed.
- Alternatively, you can set with "Auto-rotate" in the Panel switch (→P64).

◆ Screenshot

You can save a screen displayed on the terminal as an image.

- Some screens may not be saved.

1 Power key and volume down key

The screenshot is saved and the thumbnail of the saved image is displayed at the lower left of the screen.

- You can check the saved image by tapping [Photos].

✓INFORMATION

- You can also save a screenshot by tapping [Screenshot] while recent apps are displayed.→P67

❖ Extending the captured area for screenshot

You can extend the captured area of a vertically long screen and save it as an image.

1 Power key and volume down key

The screenshot is saved and the thumbnail of the saved image is displayed at the lower left of the screen.

2 [Capture more]

3 Drag the frame on the image to specify the captured area

4 [SAVE]

The specified area of screenshot is saved.

- You can check the saved image by tapping [Photos].

◆ Application permissions

The first time you launch an application or function that accesses other functions and information on the terminal, a confirmation screen that requests authorization for access rights appears. When you approve these access rights, the corresponding functions and information become available to the application or function.

- Confirmation screens vary depending on the application or function. Check the displayed content carefully and operate.

<Example> When launching "かんたん電話帳 (Easy phonebook)" application for the first time

- 1** From the Home screen, []→[arrows]→[かんたん電話帳 (Easy phonebook)]→Check the contents, [次へ (Next)]

The confirmation screen is displayed.

- 2** [ALLOW]/[DON'T ALLOW]

Follow the on-screen instructions.

✓ INFORMATION

- If permission is not granted, some applications and functions may not work, or use of the functions may be limited.
- If an application is not used for a long time, permission is reset and the confirmation screen may appear when you start the application even though permission is granted.
- To change permission settings, operate from the Home screen, []→[Settings]→[Apps]→[See all XX apps]→Select the application→[Permissions]→Set each permission.

Character entry

Enter characters using software keyboard displayed on the screen.

- Entering characters with Super ATOK ULTIAS is mainly described in this section.
- Switching to other input method is available.→P58
- You can connect an external keyboard to enter characters.→P60

◆ Using keyboard

You can enter characters using numeric keypad, QWERTY keypad or handwritten input.

- You can activate voice input from each keypad.→P55
- When the overwrite handwritten input option is enabled, handwritten input is available with the numeric or QWERTY keypad displayed.→P58

■ Numeric keypad

Multiple characters are assigned to a key.

- You can select input method from Flick input, Numeric keypad input, Gesture input, or 2-touch input.→P57

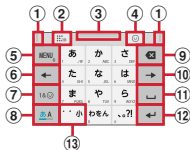

■ QWERTY keypad

Enter characters using Romaji input.

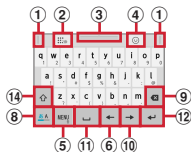

■ Handwritten input

Enter characters in handwriting.

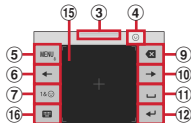

- Some key displays may be changed depending on the setting or condition.

- Drag left or right to adjust the width of the keypad
- Enable/disable Overwrite handwritten input
- Drag up or down to adjust the height of the keypad
- Display a list of number/symbol/smiley/pict
- MENU** : Display menu

- When the menu is displayed, the following operations are available.

テンキー (Numeric keypad) : Switch to Numeric keypad

QWERTYキー (QWERTY keypad) : Switch to QWERTY keypad

手書き (Handwritten input) : Switch to handwritten input

上書き手書き (Overwrite handwritten input) : Enable/disable overwrite handwritten input

定型文 (Common phrase) : Display common phrases

記号・顔文字・絵文字 (Symbol/Smiley/Pict) : Display a list of number/symbol/smiley/pict

テーマ切替 (Switch theme) : Switch the keyboard themes
引用アプリ (Quotation app) : Select from Search phonebook or arrows passport

Tap **[設定 (Settings)]** to select an application that is activated by flicking key up.

arrows passport: Quote arrows passport

設定 (Settings): Settings for Super ATOK ULTIAS→P58

- Flick up to activate the specified quotation app. Flick right and enter a postal code→**[変換 (Convert)]** to enter an address corresponding to the postal code.

MENU (Touch and hold) : Activate voice input

- Activating voice input displays **↓** on the upper right of the screen for a few seconds.

↔ : Display characters assigned to a key in the reverse order

- Move the cursor to left

- On the numeric keypad and handwritten input, flick up or down to move the cursor up or down, or flick right to move the cursor to the right.











On the QWERTY keypad, flick up to move the cursor up, or flick right to move the cursor down.

- Display a list of number/symbol/smiley/pict

- あひ** : Switch input mode to Kana/Alphabet



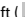

あひ : Switch input mode to Kana/Alphabet/Number

あひ : Switch input mode to Kana/Number

- ⑨ Backspace (Delete a character to the left of the cursor)
- After a character is fixed, flick a key up to delete the character on the right to the cursor and flick to the left to delete all characters on the left to the cursor.
 - Flick down on the key to restore a character deleted after it was fixed.
- ⑩ Move the cursor to right
- On the numeric keypad and handwritten input, flick up or down to move the cursor up or down, or flick left to move the cursor to the left.
On the QWERTY keypad, flick up to move the cursor up, or flick left to move the cursor down.
- ⑪  : Enter space
- Flick up to enter a one-byte space in two-byte input mode, or a two-byte space in one-byte input mode.
-  : Convert character
- ⑫  : Fix or enter linefeed
-  : Fix
-  : Move the cursor to the next entry field
-  : Search
-  : Execution
- ⑬  : Switch to lowercase/uppercase, voiced sound/semivoiced sound mark
-  : Switch uppercase and lowercase of alphabet
- ⑭ Shift key
- No shift ()/Shift ()/Shift locked () : Switch to lowercase letter/uppercase at the first letter/uppercase letter
- Symbols assigned to the key are also switched.

- ⑮ Handwritten input area : Write a character with your finger to enter
- When you write a character, a recognized character appears on the top of input area. You can select a character from the correction candidate list displayed when a recognized character is tapped. You can rewrite on the correction candidate list.
- ⑯  : Return to the numeric keypad or QWERTY keypad

✓INFORMATION

- To hide the keypad, tap . To show the keypad again, tap the character entry field.
- When you type and fix a word that is not on the list of candidates,  may appear in the area indicated by ②. Tap  to save the entered word to the personal dictionary.
- In the entry screen for the password etc., relate the entry screen to an ID (account) or password registered in arrows passport to enter the quotations.
Tap [Use arrows passport] displayed above the keyboard and then tap [New registration] to register authentication information to arrows passport to relate to the entry screen.
Tap [Use arrows passport] to input characters by quotation.
Depending on the type of input box for ID or password, [Use arrows passport] may not be displayed. If not, display the list screen from  → [arrows passport] on ULTIAS keyboard, and then select the item to input by quotation.

❖ Numeric keypad input

You can use the following 4 input methods in the numeric keypad.

- Select the input method you want to use in [Numeric keypad].→P58

■ Flick input

If you touch and hold the key assigned the character you want to enter, characters (flick guide) will be displayed on that key. Flick towards the desired character without releasing your finger from the screen.

- To enter voiced/semi-voiced sound/small/geminate consonant characters, flick "っ" or "っ" in the direction of the intended character after flicking.

■ Numeric keypad input

Tap continuously a key assigned the character you want to enter until the desired character is displayed.

- To enter voiced/semi-voiced sound/small/geminate consonant characters, tap "っ" or "っ" once or twice after tapping.

■ Gesture input

If you touch and hold the key assigned the character you want to enter, characters (gesture guide) will be displayed around that key. Slide your finger to the desired character without releasing your finger from the screen.

- To enter voiced/semi-voiced sound/small/geminate consonant characters, slide down once or twice without releasing your finger from a key. Gesture guide for voiced/semi-voiced sound/small/geminate consonant characters appears around the key. Slide your finger to the desired character without releasing.



Example : Entering "っば"

- In the alphanumeric input mode, you can switch between uppercase and lowercase characters by sliding downwards without releasing your finger from the screen.

■ 2-touch input

Tap a key assigned a character you want to enter first, then tap a desired character.

- To enter voiced/semi-voiced sound/small/geminate consonant characters, tap "っ" or "っ" once or twice after tapping.

◆ Switching input method

1 While entering characters,  in the navigation bar (→P61)

2 Select the input method

◆ Setting character entry

Set by character entries.

1 From the Home screen, →[Settings]→[System]→[Languages & input]

2 [On-screen keyboard]

The on-screen keyboard list is displayed.

3 [Gboard]/[Super ATOK ULTIAS]/[Google Voice Typing]/[Google Voice Typing [Legacy]]

- Tap [Manage on-screen keyboards] to set the keyboard displayed in the on-screen keyboard list.

4 Set required items

- Available items vary depending on input method.

◆ Setting Super ATOK ULTIAS

Set entry actions or design for each keyboard. Also, you can register words (Personal dictionary) or edit common phrases, initialize settings, etc.

1 From the Home screen, →[Settings]→[System]→[Languages & input]→[On-screen keyboard]→[Super ATOK ULTIAS]

2 Set required items

ULTIAS Feature select : Set Keyboard selection, Smartphone input (flick) learning mode, ATOK Keyword Express (Enable, Select genres, Notify updates, Receive right away, Auto receive, Interval, Auto receive on Wi-Fi only).

Operation sound/Vibrate : Set Keypad sound and Keypad vibration.

Numeric keypad : Set Input mode (Flick input/Numeric keypad input/Gesture input/2-touch input), Flick input (Flick guide, Flick Sensitivity, 「や」 key flick, Modifier key flick, Alphabet key flick), Multi-tap input, Auto cursor moving (Auto cursor moving, Time of auto cursor moving), Gesture input (Gesture guide, Gesture sensitivity, Around touch position, Show faster, Close faster, Time of gesture guide, 「や」 key gesture), Direct numeric input.

QWERTY keypad : Set Direct alphanumeric input, Show numeric keys (Vertical screen/Horizontal screen).

Handwritten input : Set Overwrite handwritten input (Numeric keypad, QWERTY keypad) and confirm explanations.

Conversion setting : Set keyboard selection type for Hiragana/Alphabet/Numeric, Available keyboard, Select referred app of MENU flick, Input prediction, Showing prediction candidates before next input, Learning function, Use half-width space, Auto space insert, Character delete key, Function key flick guide, Back key, Auto full screen (horizontal), Hardware keyboard preferentially, Multi-touch.

- Prediction conversion candidates do not appear for character entry on some applications.

- Full screen may not be available depending on the application even if [Auto full screen (horizontal)] is enabled.

Set selection list : Set Font size, Number of lines to display (Vertical screen/Horizontal screen), Expression mode, Punctuation marks, Prediction correction, Proofreading support.

Design : Set Keyboard selection, Theme, Dark Theme link, Adjust keyboard height (Numeric keypad (Vertical display/Horizontal display), QWERTY (Vertical display/Horizontal display), Handwriting (Vertical display/Horizontal display)), Keyboard sizing bar, Floating keyboard (Horizontal screen/Vertical screen).

- The floating keyboard is disabled in full screen even if [Horizontal screen] is enabled for [Floating keyboard].

Utility : Set Personal dictionary registration/edit, Phrase registration/edit, ATOK Sync (Enable, Show shared words, Update right away, Auto update, Interval, Update on Wi-Fi only), Export/Import settings (Export Settings, Import Settings), Export/Import all (Export all, Import all).

Initialize : Initialize settings or Initializing learning data.

- Learned data, edited personal dictionary/common phrase are not deleted even if [Initializing settings] is executed.

Open source software license : Display the open source software license.

Super ATOK ULTIAS : Check the version of Super ATOK ULTIAS.

◆ Editing text

You can copy texts in the character entry field, website, or received mail and cut and paste texts, register words in the character entry field.

- Operation method may vary by application.

◆ Copying/Cutting text

1 Touch and hold a text

Selected text is highlighted.

- Drag knobs on the both ends of text range to adjust selected range.
- To select all, tap ⋮ → [Select all].
- To deselect, tap out of selected range.
- For some websites, you can perform operations such as [Copy link text] from the menu displayed by touching and holding link.

2 [Copy]/[Cut]

✓ INFORMATION

- Touch and hold text and tap [Share] to send the selected text using an application.
- This feature may not be available or the displayed menu may differ depending on displayed text.

◆ Pasting text

1 Touch and hold a position to paste → [Paste]

The text is pasted to the cursor position.

- To paste into an entered text, tap a position you want to paste → Tap the cursor tab → [Paste].

◆ Using an external keyboard

You can connect a Bluetooth keyboard (HID/SPP) or USB keyboard to the terminal to enter characters.

- 101 keyboard, 104 keyboard, 106 keyboard, OADG 109 keyboard and OADG 109A keyboard are supported.
- For connecting with Bluetooth keyboard, refer to "Connecting with Bluetooth devices". → P179

◆ Setting an external keyboard

- A keyboard is displayed when the external keyboard is connected.

- 1** From the Home screen,  → [Settings] → [System] → [Languages & input]
- 2** [Physical keyboard] → Select the keyboard → [SET UP KEYBOARD LAYOUTS] → Select the keyboard layout

◆ Displaying the on-screen keyboard

You can set whether to display the software keyboard when an external keyboard is connected.

- 1** From the Home screen,  → [Settings] → [System] → [Languages & input]
- 2** [Physical keyboard] → Tap [Use on-screen keyboard] to set to ON/OFF

◆ Displaying shortcuts of the keyboard

Display the shortcuts to use a connected external keyboard.

- 1** From the Home screen,  → [Settings] → [System] → [Languages & input]
- 2** [Physical keyboard] → [Keyboard shortcuts]

Screen/Icon

◆ Navigation bar

Operation icons are displayed in the navigation bar at the bottom of the screen.



◀ Back icon

Tap : Return to the previous screen, exit out of application

○ Home icon

Tap : Return to the Home screen→P71

Touch and hold : Activate Google Assistant

□ History icon

Tap : Display recently used applications→P67

✓ INFORMATION

- You can switch the operation of the navigation bar to "Gesture navigation".→P172

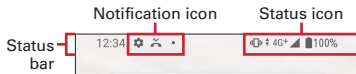

◆ Icons on the status bar

The status bar along the top of the screen shows notification icons and status icons that allow you to check various conditions.































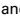

■ Main notification icon

- ✉ : New Gmail→P99
- ✉ : New xxxxx mail→P93
- ✉ : New +Message→P93
- 📶 : Wi-Fi is ON and Wi-Fi network is available→P133
- 📞 : Missed call→P87
- 📅 : Phone memo exists→P7
- 📞 : Message in Voice Mail Service→P88
- ⬆️ / ⬆️ : Data uploaded/downloaded
- 📻 : Using radio+FM→P18
- 🕒 : Sounding alarm/snoozing/within 2 hours from alarm→P126
- 📱 : Notification from Lalasia Connect→P119
- ❤️ : Automatic heart rate measuring→P119
- When "Automatically measure heart rate" is set to ON in Heart rate setting of Lalasia Connect, the icon is blinking during automatic heart rate measuring.
- 📄 : Notification from XXXXX Data Copy→P29
- 🔄 : Software update→P97
- 📍 : Location providing is ON→P68
- 🔒 : Omakase Lock is set
- 💾 : Available memory on the terminal is low
- ⚠️ : Error/alert message
- 📱 : SuguApp function is available

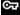
-  : Camera ended automatically→P104
-  : Some notifications are not displayed

■ Main status icon

-  : Signal level (4 levels)
-  : Out of service area
-  : Weak signal reception or connected to mobile network with no Internet access→P136
-  : During international roaming
-  : 5G/4G (LTE)/3G/GSM available*
- △ (Uploading) or ▽ (Downloading) appears in white during communication.
- 3G/GSM are not available in Japan.
- * "4G+" is always displayed when connected to LTE.
-  : Airplane mode is set →P138
-  : Wi-Fi connected (4 levels) →P133
- △ (Uploading) or ▽ (Downloading) appears in white during communication.
- The number indicates the connected Wi-Fi standard.
-  : Connected to Wi-Fi network with no Internet access→P133
-  : Wi-Fi tethering is enabled→P139
-  : Bluetooth device is connected→P179
-  : Omakase Lock is set on the terminal.
-  : Speaker phone is ON→P86
-  : Microphone is muted→P86
-  : Ringtone volume 0 (vibration) or incoming vibration ON→P149
-  : Ringtone volume and notification volume 0 (mute)→P150
-  : Alarm is set→P126
- Appears when opening the Notification panel.→P63
-  : Positioning with GPS→P123

-  : Battery level 0 - 15%
-  : Battery level 16 - 30%
-  : Battery level 31 - 100%*
- * Battery indicator of the icon changes according to remaining battery level.
-  : Charging→P42
-  (White) : Keep lit when held is set (movement is detected and screen ON)→P146
-  (Gray) : Keep lit when held is set→P146
-  : VPN connection→P141
-  : Kana input mode→P54
-  : Alphabet input mode→P54
-  : Number input mode→P54
-  : Handwritten input mode→P54
-  : Number/symbol/smiley/pict, common phrase input→P54
-  : There are hidden notifications

◆ Notification panel

Flick the status bar downward to open the Notification panel. In Notification panel, you can check information of notification icon or make settings.

1 Flick the status bar downward

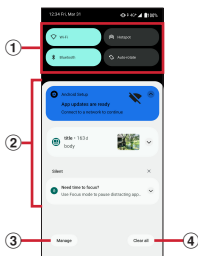

① Panel switch

- A part of the panel switches is displayed.→P64
- Tap the panel switch to switch ON/OFF of the function or setting.
- Flick the Panel switch downward to display the hidden panel switches.→P64

② Notifications

- Tap the notification to check details or activate the corresponding application.
- Touch and hold the notification to make settings of Notifications.

③ Manage/History

Display the applications whose notifications come from when [Manage] is displayed and you can switch ON/OFF of app notifications

- When the notification history is set to ON, [History] is displayed and shows the notification history.

④ Clear all

Clear all the notifications and close the Notification panel. Some notifications may not be cleared depending on notification content, or [Clear all] may not be displayed.

✓INFORMATION

- To close the Notification panel, flick the Notification panel upward or tap  (Back).
- Tap [CALL] or [MESSAGE] displayed below the missed call notification to dial or send SMS.

◆ Panel switch

Click the status bar downward with two fingers to open the Panel switch. Tap the panel switch to switch ON/OFF of the function or setting.

1 Flick the status bar down with two fingers

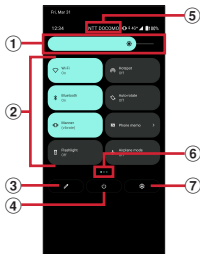

① Screen brightness level

Slide the slider to adjust the brightness.

② Panel switches

Tap each panel switch to ON/OFF of the function or setting. Touch and hold the panel switch to open the corresponding setting menu.

- Wi-Fi : →P133
- Hotspot : →P139
- Bluetooth : →P179
- Auto-rotate : →P147
- Manner : Set/cancel Manner mode.
- Phone memo : →P87
- Flashlight : Turn on/off the light.
- Airplane mode : →P138

- FAST App Drive : →P160
 - FAST FingerLauncher : →P156
 - Dolby Atmos : Turn on/off Dolby Atmos.
 - Clear Font : →P160
 - Loupe : Activate Loupe (Out-camera) so that you can magnify text, etc. by holding over. Pinch-in or out the screen to change the magnification, or set on/off of the light.
 - Blue Light cut mode : Set whether to cut down blue light emitted from the screen.
 - Extra dim : →P150
 - Nearby Share^{*1} : Share files with devices near this terminal.
 - Location data : →P124
 - Screen Cast : Show videos and images by connecting the terminal to a Wi-Fi Miracast device.
 - Battery Saver : →P145
 - Dark theme : →P146
 - Glove touch : →P151
 - Device control : Control a smart home device (commercially available), etc. connected to the terminal.
 - Internet^{*2} : Display the setting screen for internet connection.
 - Do Not Disturb^{*2} : →P149
 - Alarm^{*2} : →P126
 - Screen Record^{*1*2} : Record the screen of the terminal.
 - Invert colors^{*2} : →Turn on/off color inversion.
 - Data Saver^{*2} : Restrict background data communication by applications.
 - NFC/Osaifu-Keitai^{*2} : →P181
- You cannot switch ON/OFF of this function in Europe and north America while charging the terminal in these areas, as this function is not available.

- Mic access : →P159
- Camera access : →P159
- Storage*2 : →P177
- Focus mode*2 : Pause distracting apps.
- Bedtime mode*2 : Pause distracting notifications during bedtime or make the screen monochrome.
- TV Remote*2*3 : You can use the terminal as a remote controller when watching Google TV.
- group messages*2 : Switch ON/OFF of group notification setting in +Message.

*1 This displayed item may be different depending on your usage condition.

*2 To use, add it to the Panel switch. →P65

*3 Appears when starting Google TV.

③ Edit

Touch and hold the panel switch and then drag it to delete or add. To reset the edited content,  in the edit screen→ [Reset].

④ Power menu

Display operation menus such as turning power off, restarting the terminal, making an emergency call, etc.→ P37

⑤ Network operator

⑥ Indicator

Indicates the number of Panel switch pages and the which page you are in.

⑦ Settings

Display the settings menu.→P132

✓INFORMATION

- To close the Panel switch, flick the Panel switch upward or tap  (Back).

◆ Using Slide-in function

You can call out Slide-in launcher by sliding your finger from the slide spot (start point for sliding) at the corner of the screen.

- For setting of the Slide-in function, refer to "Slide-in function".→P161

❖ Slide-in launcher

Activate an application from a shortcut saved in Slide-in launcher.

1 Slide your finger from the slide spot to the center of the screen, then release the finger at a shortcut in Slide-in launcher

- When Slide-in function is set to ON, Slide-in launcher is set in the slide spot at the upper right of the screen.
- You can set the Slide-in function by releasing your finger at the position of , which is called up at the same time as the Slide-in launcher.

2 Perform an operation

✓INFORMATION

- Touch and hold the slide spot and slide it up/down along the right end of the screen (left end when the slide spot is at the left side) to move the slide spot position.

❖ Capture & Draw

Capture displayed screen to edit as an image or share with other application.

- Some screens may not be captured.

1 Slide your finger from the slide spot to the center of the screen, then release the finger at  in Slide-in launcher

2 Select a target operation

Editing image : Tap tools and edit→[Save]

- You can check the image in Photos (→P113), etc.
- With drawing tools, you can write texts or draw pictures on an image by handwriting, crop or zoom in/out.

Sharing with another application : [Share]→Select an application→Follow the on-screen instructions

- You can also activate an application by tapping an app icon displayed next to [Share].

❖ Highlight & Copy

Text strings selected by tracing on the screen with your finger can be copied or shared with another application.

1 Slide your finger from the slide spot to the center of the screen, then release the finger at  in Slide-in launcher



2 Trace text strings you want to copy with your finger

Recognized texts are marked and displayed in preview.

- Tap the preview to display the keyboard to edit the texts.
- Selected texts may not be recognized properly depending on the text strings or due to background images.

3 Perform an operation

Copying texts : [COPY]

- Tap  /  to display/hide preview. Tap [CLEAR] to cancel selecting texts.

Sharing with another application : Select an application to paste

- Displayed applications differ depending on the selected texts.

Task manager

If you stop operating application by tapping  (Home), etc., the application may remain active in the background. Also, 2 or more applications may be running depending on the operations. This function allows you to check running applications, switch the display, or exit applications.

(History)

The recently used applications appear.

- Flick the screen left or right and tap a thumbnail to display application, or flick down to switch applications.
- Flick a thumbnail up to exit the application. To exit all applications, flick the screen right and then tap [CLEAR ALL].
- You can also save a screenshot of recent apps displayed by thumbnails by tapping [Screenshot]→P53
- Tap [Application pinning] to display the setting screen for pinning the app displayed as a thumbnail, and tap [Use] to pin the app. Press Power key to cancel application pinning.

✓INFORMATION

- When [Application pinning] (→P158) is set to ON, you can pin an application so that other applications cannot be used by tapping the application icon on the thumbnail→[Pin]→[GOT IT].

Magnifying the screen display

The terminal has magnification features so that the screen display can be easily viewed. Use according to your purpose.

■ Clear Font

Adjust the size of character or icon automatically so that they are always seen clearly.

Timing of magnifying : When the setting is enabled

Setting steps→P160

Split screen

Split the screen in two and operate two different applications at the same time in each screen.

- Activate an application to display beforehand.
- If the application does not support the split screen, it cannot be displayed with this function.

1 (History)



The recently used applications appear.

2 Tap the icon to display the application → [Split screen]

3 In the lower screen, tap a thumbnail of application

- If the application thumbnail is not displayed, tap  (Home) to activate the application to display.

✓ INFORMATION

- The split screens can be displayed upper and lower in the vertical screen and left and right in the horizontal screen.
- The application displayed in the lower screen (right in the horizontal screen) can be switched.
To switch applications, tap  and select the thumbnail in the recently-used applications, or tap  (Home) to activate the application to be displayed.
- To end the split screen, drag  in the center of the screen to the upper part or lower part of the screen (left end or right end in landscape view).

SuguApp

Perform settings for "SuguApp", which enables you to start the application quickly by shaking the smartphone.

1 From the Home screen, → [Settings] → [XXXXX service/cloud]

2 [SuguApp]

3 Set each item

SuguApp : Specify the application to start them by shaking the terminal.

Also, you can set to display other application icons on the screen of an application started by shaking the terminal.

- Shake 1-time : Specify the application to start by shaking the terminal once.
- Simultaneous display of icons (Shake 1-time): Specify the application to display on the screen simultaneously when using the Shake 1-time function.
- Shake 2-times : Specify the application to start by shaking the terminal twice.
- Simultaneous display of icons (Shake 2-times): Specify the application to display on the screen simultaneously when using the Shake 2-times function.
- SuguApp Operation Deterrence : Specify the application to avoid starting by SuguApp.

✓ INFORMATION

- In the following cases, SuguApp does not work correctly.
 - When you are lying
 - While running or going up and down stairs

- By default, "d払い (d payment)" is set for Shake 1-time.
- You cannot use SuguApp while the screen is OFF or locked.
- If you place the terminal in a bag or pocket with the screen ON, in rare cases, SuguApp may recognize the action as a motion and the application may start.
- When SuguApp is available, the notification icon appears. You can check detailed information about notifications from the status panel.
- For details of SuguApp, refer to XXXXX website.
- Depending on the application you assigned as Shake 1-time or Shake 2-times, icons may not appear simultaneously.

Emergency buzzer

You can sound a buzzer at a loud volume in case of emergency. When you sound the buzzer, you can make a call automatically or notify where you are by the GPS function.

- Make settings for the emergency buzzer beforehand. → P164

1 Power key (1 sec. or more)

2 [Security tools]→[Emergency buzzer]

The buzzer sounds at a loud volume.

Turning off the buzzer : Tap [STOP BUZZER SOUNDING]

- You can also turn off the buzzer by Power key (1 sec. or more)→[Security tools].

■ If automatic phone call is set

When the buzzer sounds, the terminal makes a phone call to the specified contact automatically (→P164). When the other party answers the call, the buzzer turns off and the voice guidance saying "緊急通話です (This is an emergency call)" is heard three times. When the voice guidance finishes, the buzzer sounds again. Note that the other party's voice cannot be heard.

- The terminal repeats phone calls in order until one of the registered contacts answers the call.
- Your phone number is notified to the other party regardless of the setting of caller ID notification.
- Tap  to cancel making a call or to finish the voice guidance or call.

■ If automatic SMS transmission is set

When the buzzer sounds, an SMS is sent to the specified contact automatically. (→P164)

■ If location providing is activated

You can make a setting to send the location providing request when the buzzer sounds (→P164). When the terminal receives the request, location information is measured and the measurement result will be sent.

✓INFORMATION

- During international roaming, the GPS function of the emergency buzzer is not available.
- When the PIN code is locked, the buzzer sounds, but the terminal does not make a call or provide location information.
- When the security lock is set and if the terminal has not been unlocked since it started, the buzzer sounds, but the terminal does not make a call or provide location information.

- If the nano SIM card is not installed, the terminal does not make a call or provide location information.
- You cannot adjust the volume of the emergency buzzer. The buzzer sounds at a loud volume, so please be careful.
- The emergency buzzer sounds even in Manner mode.
- When the silent mode is set, the mode is deactivated temporarily while the buzzer is sounding.
- If automatic phone call is performed, you cannot mute/hold on the call or cannot perform additional operations.
- When a phone call arrives while the emergency buzzer is sounding;
 - If automatic phone call is set, you can receive a call from the registered contacts only. (The terminal answers to it automatically.) Calls from other than those will be rejected and it will be recorded as a missed call.
 - If automatic phone call is not set, you can receive a call from anyone. (The terminal does not answer to it automatically.)
- If the other party does not answer after about 30 seconds, the call will be suspended. If multiple contacts are registered, the terminal continues to make a call to them according to the order of registered numbers.
- The emergency buzzer is intended to draw attention of surrounding persons, not to prevent crime or guarantee your safety. XXXXX assumes no responsibility for any loss due to using this function.

Imitation call

Imitation call is a function which allows you to pretend that you are receiving or making a call.

- As no communication is done by imitation call, you can use it regardless of the radio wave condition and no call fee is charged.

1 Power key (1 sec. or more)

2 [Security tools]→[Imitation call]

The ringtone sounds and the display like an incoming screen appears.



The ringtone stops, the display like a voice call screen appears, and then you hear the guidance of imitation call from the earpiece.



Imitation call ends.

✓INFORMATION

- When you use imitation call, the ringtone sounds even though the earphone is inserted into the terminal.
- The ringtone sounds even in Manner mode.
- The ringtone to sound is fixed as the default ringtone.
- No buttons other than the button to end imitation call can be operated, as they are dummies.
- The following operations ends imitation call.
 - When you receive or make an actual call
 - When the emergency buzzer sounds

Home screen

Switching the home applications

Change the screen (Home screen) displayed by tapping  (Home). "XXXXX LIVE UX", "arrows Home" and "Simple Home" home apps are available in the terminal.

1 From the Home screen,  → [Settings] → [Homescreen selector]

2 Select a home application to switch to
✓INFORMATION -----

- The wallpaper for the lock screen may be changed by switching the home application depending on the home application.

Home screen

In the Home screen, you can activate applications or use widgets. All applications are stored in the application list. Application icon shortcuts are placed on the Home screen.

- Flick left or right to switch pages on the Home screen.
- A dot or number may appear on the upper right of the icon or folder when you have a notification from the application.

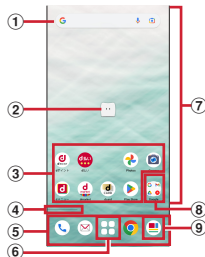

① Widget

- Activate widget (Google Search).
- Depending on a widget, touch and hold to display the shortcut menu where you can perform specified operations.

② Machi-Chara

- Tap to ask something you want to know through dialog.

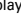

- ③ **Application icon shortcut**
 - Tap to activate the application.
 - Touch and hold to display the shortcut menu where you can perform specified operations or check the application information. When  is displayed, touch and hold and then drag it to any location to add a shortcut of specified operation to the Home screen.
- ④ **Indicator**
 - Indicates the number of pages of the Home screen and which screen you are in.

* Appears only when flicking the screen.
- ⑤ **Dock**
 - Displayed even if the home screen page is changed.
- ⑥ **Application list button**
 - Displays all applications. Search applications and use "Osusume Apps" (recommended applications) (→P78).
- ⑦ **Customize area**
 - You can locate applications, widgets, and folders.
- ⑧ **Folder**
 - Stores multiple application icons etc.
- ⑨ **My Magazine button**
 - Display My Magazine. →P79

Managing the Home screen

◆ Moving application icon etc.

- 1 In the Home screen, touch and hold the icon or widget to move
- 2 Drag it to a position you want to locate
 - Drag to the edge of the home screen to go to the next page.

◆ Adding application icon

- 1 In the Home screen,  Touch and hold the icon to add on the Home screen
- 2 [Add to Home screen]
 - Drag to the edge of the home screen to go to the next page.
 - Multiple same icons can be pasted.



◆ Deleting application icon from the Home screen

- 1 In the Home screen, touch and hold the application icon to delete
- 2 Drag to [Remove] on the top of the screen
 - Icon is deleted from the Home screen, but the application is not uninstalled.

◆ Removing widget etc.

- 1 In the Home screen, touch and hold the widget etc. to remove
- 2 Drag to [Remove] or [x] on the top of the screen

◆ Uninstalling application

- 1 In the Home screen, touch and hold the application icon to uninstall
 - To uninstall the application in a folder, tap a folder and then touch and hold the application to uninstall.
- 2 Drag to  on the top of the screen→[OK]
 - For applications that cannot be uninstalled,  does not appear.
 - If you uninstall the application, it is also deleted from the application list.

◆ Renaming folder

- 1 In the Home screen, select the folder
- 2 Tap the folder name
- 3 Enter a folder name
 - Tap  displayed in the keyboard.

◆ Setting the Home screen

- 1 Touch and hold an area of the Home screen where no icons, etc.→[Home settings]
- 2 Select an item

Notification dots : Set ON/OFF of a dot to indicate the app notification.

Add icons to home screen : Select whether to automatically paste the icon of newly installed application on the Home screen, or to display the icon on the application list only.

* By default, installed apps are displayed on the last row of the application list.

Add home settings icon : Set ON/OFF of  on the Home screen.

Wallpapers : Change the wallpaper of the Home screen and lock screen.

Machi-Chara : Set ON/OFF of Machi-Chara, or set the Machi-Chara settings such as changing the character.

Osusume Apps settings : Set the display setting of "Recommendations" that appears on the application list screen.

Display my daiz NOW : Perform display setting for my daiz NOW on the left end of the Home screen.

My Magazine : Set ON/OFF of My Magazine activation by flicking up.

Get started : Check the tutorial on the Home screen.

Help : Check the details about how to use the Home screen.