

Instruction Manual

CORDLESS MOP & VACUUM CLEANER COMBO (ADVANCED VERSION)

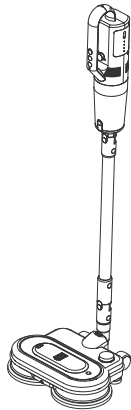

HE-413

1. Use

Simply and easily complete the cleaning work of mopping and vacuuming at home/office.

2. Product features

- Free combination of use - the mop or vacuum cleaner can be used alone, or it can be vacuumed while mopping the floor.
- Wireless operation - mobile without restraint.
- Powered by dual battery boxes - the mop and vacuum cleaner are powered by separate battery boxes for longer use.
- Detachable rechargeable batteries - can be removed for charging and replaced if damaged.
- Simple operation - easy to assemble, disassemble and clean.
- Dual spin mops (each with one separate motor) design - easier to clean dirty floors than traditional roller kind or dual spin mops with a shared motor.
- Two-speeds - high speed to remove heavy dirt, low speed to save power.
- Efficient transmission - the umbrella-shaped gear transmission structure is twice as efficient as the general worm gear transmission.
- Installed with anti-collision strips - to avoid damage to furniture.
- Mist water spray - more even.
- Condenser lens spot light design - no dirt can escape.
- No residual water marks after mopping - installed with a long mop at the rear edge to wipe away residual water marks.
- Double rear wheel design - making the mop easier to move and store.
- Automatic shutdown (for Mop part) - when the control handle is stowed (locked into the main head), the machine automatically shuts down.
- Removable and washable four-layer high-efficiency filter - cyclone separation air duct / stainless steel primary filter / sponge medium-efficiency filter / HEPA high-efficiency filter.
- Comprehensive dust removal accessories - floor brush / flat nozzle / brush nozzle / bedding and sofa brush, which can be freely replaced.
- Three levels of vacuum intensity - the highest suction power can reach 18KPA.
- One-click dumping - no need to disassemble the dust bin to dump the dust.

3. Technical parameters

Model NO.	HE-413
Power Supply	2 units of 22.2V (3.7V cell x 6) 2000mAh rechargeable lithium ion power battery (detachable for charging)
Rated Power	mopping machine 45W / vacuum ceaner 45W-100W
Motor	2 units for mop part; one (brushless) unit for vacuum cleaner part
Transmission gear	bevel type
Charging time	2~3 hours
Usage time	each part runs about 1 hour (mopping part: at high speed and full water tank)
Water Tank Capacity	250ml

4. Parts & accessories description

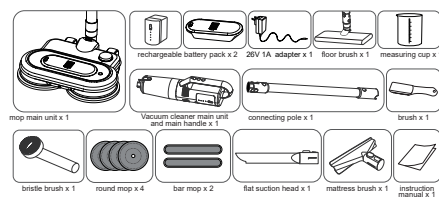

5. Appearance and function description

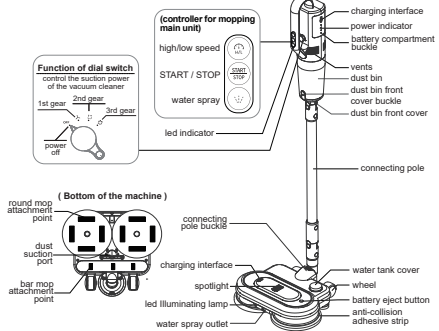

6. Product assembly steps

Step.1 Install the battery into the vacuum cleaner main unit

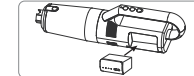

Step.3 Insert the batteries into the mop main unit

1. Insert the left end of the rechargeable battery pack into the mop main unit, as shown in below diagram

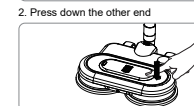

Step.4 Install mops

Align the mop with the center of the turntable on the bottom of the main head and press down to make the Velcro and mop stick firmly.

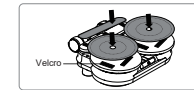

Step.2 Connect the two main units with the connecting pole

- Insert the connecting pole into the mop main unit.
- Insert the vacuum cleaner main unit into the connecting pole.

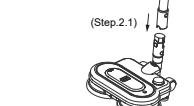
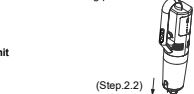

Step5 Add water

Fill the measuring cup with 250ml of water or floor cleaning solution, align it with the water inlet and slowly pour it in.



7. How to use the product

Step.1 Turn on the mop:

Press the mop main unit with one foot and pull the control handle away from it then the power is turned on.

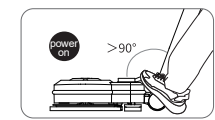

2. Adjust the speed:

If you need high-speed mopping, press the high-speed button (H) to switch to high-speed rotation.

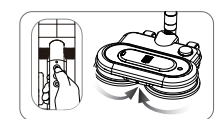

Step.3

1. Turn on the vacuum cleaner:

Turn the gear selector clockwise to select suction of different strength.

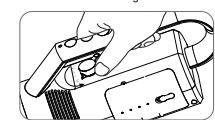

Step.2

1. Control the mop main unit:

Press the Start/Stop button (S) on the control handle, the front light of the mop main unit will be lit up, and the speed is preset to "low speed"

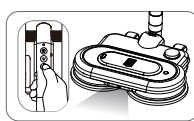

3. Spray water:

Every time you press the water button (W), it sprays twice, one second each time.

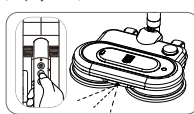

2. Turn off the vacuum cleaner:

Turn the gear selector counterclockwise to the off position, and the vacuum cleaner stops working.

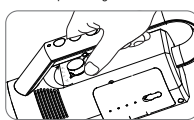

8. Storage steps

Step.1
Press the mop main unit with one foot and push the control handle back to the mop main unit to turn it off.

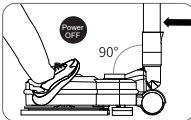

Step.3
Wheel to storage

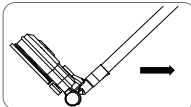

Step.2
Lay down the whole unit and remove the round and bar mops.

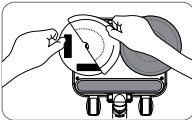

Step.4
Put on storage rack:
Just clamp the connecting pole into the storage rack buckle.

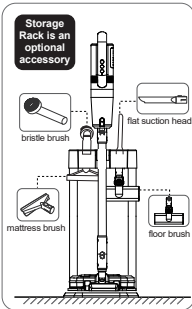

9. Dust bin dumping, disassembly, and installation

One-button dumping

Press the buckle of the front cover of the dust bin, and the front cover will automatically open, allowing the dust particles to be poured out of the dust bin.

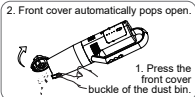

How to disassemble the dust bin

Remain the dust bin stationary and rotate the vacuum cleaner main unit in the OPEN direction until the two triangular arrows are aligned to remove the dust bin.

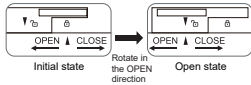

How to install dust bin

Connect the dust bin to the vacuum cleaner main unit, align the triangular arrow on the vacuum cleaner main unit with the triangular arrow on the dust bin, and then turn to the CLOSE direction.

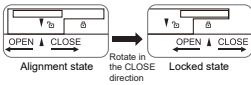

10. Cleaning of dust bin and filters

Deep cleaning steps

1. Disassemble the dust bin:
Can be disassembled layer by layer according to the following diagram.

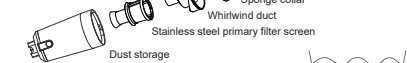

2. Deep Cleaning

Blow the disassembled parts with strong wind or wash them with water and dry them before installing them in order.

(Attention: After washing, it is necessary to blow dry or air dry before use.)



11. Low battery indicator

Low power display of the mop main unit

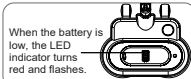

Low power display of the vacuum cleaner main unit

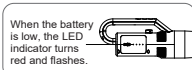

12. Charging instructions

You can directly plug the whole machine into the power socket for charging, or remove the battery packs for charging.

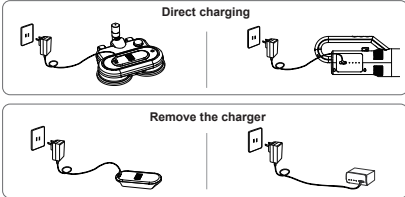

LED indicator light shows status during charging

- A: When the charge level is <25%, the 1st LED indicator light flashes blue.
- B: When the charge level is between 25% and 50%, the 2nd LED indicator flashes blue.
- C: When the charge level is between 50% and 75%, the 3rd LED indicator flashes blue.
- D: When the charge level is between 75% and 99%, the 4th LED indicator flashes blue.
- E: When is fully charged, the whole LED indicator lights will be on.

13. Precautions for mop cleaning

Cleaning method

After removing the mop, rinse it with clean water once, and then clean it with soap solution or cleaning agent.

Notes:

- 1. After cleaning, it must be air dried
- 2. Before using the mop, please confirm that there are no hard objects sticking to the mop.
- 3. If there are hard objects or glue on the mop that cannot be removed, please replace it with a new mop.



14. Precautions for using the rechargeable battery packs

- 1. Do not use the battery pack when it is swollen, otherwise it may explode or burn, and please contact seller immediately.
- 2. Please use the charging adapter included with the product to charge the battery pack. If you use a substitute, there may be no charging or short circuit.
- 3. Do not place the product near ignition sources or flammable and explosive materials.
- 4. Please store the product in a cool and dry place.
- 5. Do not disassemble, squeeze or drop the battery pack.
- 6. Make sure the machine is powered off before removing the battery.
- 7. Please refer to the manufacturer's instructions for correct charging.
- 8. When the machine might not be used for a long time, in order to ensure the best performance of the battery, the battery pack needs to be charged and discharged once a month.
- 9. The battery pack performs best when started at room temperature.

15. Troubleshooting methods

Fault phenomenon	Possible causes	Handling method
Mop does not start	1. The battery is low 2. The power switch is not turned on 3. Overuse causes the motor to suspend work	1. Charge the battery 2. Turn on the power switch 3. Let it cool down and then turn it on again
There are many water marks on the ground	Mop too wet	Wring out excessive moisture on the mop
Serious shaking of machine body during dragging	Mop not properly installed	Install the mop correctly
Making strange noises when mopping the floor	There may be foreign matter on the base rotating disc	Remove foreign objects from the surface of the base rotating disc
The vacuum cleaner does not work	1. The battery is low 2. The vacuum cleaner power switch is not turned on 3. Used too long and the temperature is too high 4. Motor damage / battery damage	1. Charge the vacuum cleaner 2. After cooling down, restart the machine to use. 3. Turn on the power switch 4. Contact after-sales service
Suction weakened	1. The dust bin is full 2. The suction port is blocked 3. The filter is blocked or not fully dried after cleaning	1. Clean the dust bin 2. Clean the dust suction port 3. Clean the filter or dry it thoroughly
Excessive noise	1. The dust bin is full 2. The air duct is blocked	1. Clean the dust bin 2. Clean the air duct (floor brush, connecting tube or dust bin)
Unable to charge	1. The adapter is not firmly connected to the AC power supply 2. The adapter is not well connected to the charging port 3. The adapter is damaged	1. Plug the adapter firmly into the AC outlet 2. Securely connect the adapter to the charging port 3. Please contact after-sales service

(Note: Do not disassemble the machine by yourself. If there is a malfunction, please contact a professional or supplier in time for handling.)

This device complies with part 15 of the FCC Rules. Operation is subject to the following two conditions: (1) this device may not cause harmful interference, and (2) this device must accept any interference received, including interference that may cause undesired operation.

Any changes or modifications not expressly approved by the party responsible for compliance could void the user's authority to operate the equipment.

NOTE: This equipment has been tested and found to comply with the limits for a Class B digital device, pursuant to Part 15 of the FCC Rules. These limits are designed to provide reasonable protection against harmful interference in a residential installation. This equipment generates, uses and can radiate radio frequency energy and, if not installed and used in accordance with the instructions, may cause harmful interference to radio communications. However, there is no guarantee that interference will not occur in a particular installation.

If this equipment does cause harmful interference to radio or television reception, which can be determined by turning the equipment off and on, the user is encouraged to try to correct the interference by one or more of the following measures:

- Reorient or relocate the receiving antenna.
- Increase the separation between the equipment and receiver.
- Connect the equipment into an outlet on a circuit different from that to which the receiver is connected.
- Consult the dealer or an experienced radio/TV technician for help.

The device has been evaluated to meet general RF exposure requirement. The device can be used in portable exposure condition without restriction

料号：AMUHE41309A1A

尺寸：成型105x142.5mm

展开尺寸525x142.5mm

材质：80 克书纸

印刷：单色双面印刷



折叠方式：

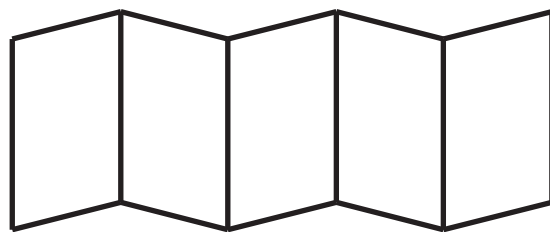

风琴折页