



In order to ensure the safe and correct use of the product, please read this manual carefully before use, and properly save it for viewing.

## Product parameters

|                     |      |
|---------------------|------|
| IP Rating           | IP65 |
| Voltage and current | 5V2A |
| Power               | 5W   |

2

## What is in the box ?

|                |   |
|----------------|---|
| LED lights     | 1 |
| Remote control | 1 |
| User manual    | 1 |

## How to connect to APP?

- (1) Search for iDeal Led in App Store for iPhone and Google Play for Android.
- (2) Use mobile browser to scan the QR code and enter the download page. Select the appropriate way to install.
- (3) When the app is installed for the first time, the page will pop up "Allow browser to install apps" option, please check "Allow".



3

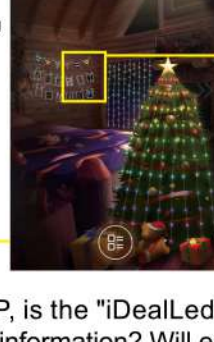

Note: When you first enter APP, is the "iDealLed" option allowed to get device location information? Will emerge. Please select Allow only when in use.

## Language settings



4

## Function of buttons

First of all, be sure to turn on bluetooth and GPS on your phone.

Open the App and click the searched intelligent lamp string to enter the operation interface, click button ①, connect intelligent lamp string will automatically connect next time.

Click on the button and scroll to the right, indicating that the connection is successful.

Change the corresponding number of lights in the settings according to the specifications of the purchased product

- ② to enter the DIY interface.
- ③ to enter the scene display interface.
- ④ to enter the collection display interface.
- ⑤ to enter the loop playing interface.
- ⑥ to enter the camera color selection interface.
- ⑦ to enter the interface of music rhythm and sound control.
- ⑧ to enter the timing interface.
- ⑨ to enter the setting interface.
- ⑩ to control the on and off of the lamp string system.

Click on the button to link two sets of lights together (buy two sets and support up to four sets)

Click on the button two sets of lamps can be connected in parallel (two sets must be purchased and up to four sets are supported)

5

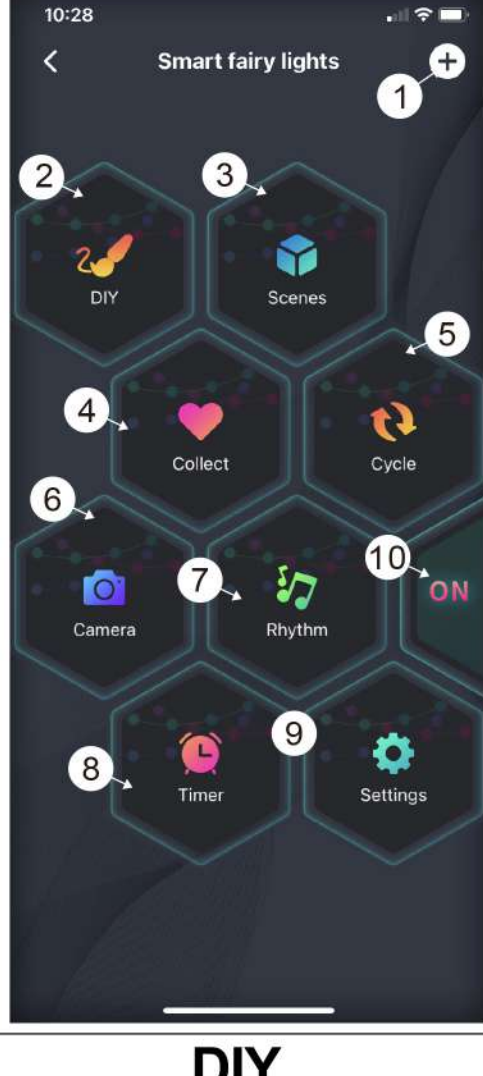

6

## DIY

1. Paint your favorite color into the position of any lamp
2. The brightness of the light can be adjusted arbitrarily
3. The following figure shows the detailed operation panel



8

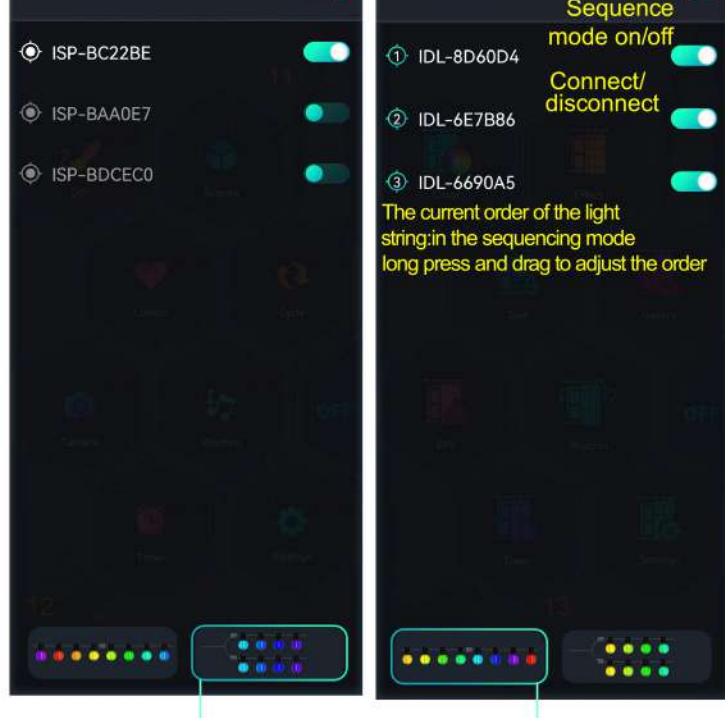

7

## Scenes



- A: A variety of scene mode can be choose.
- B: You can add and delete colors according to your preferences. And you can adjust the direction of running, the brightness and speed.

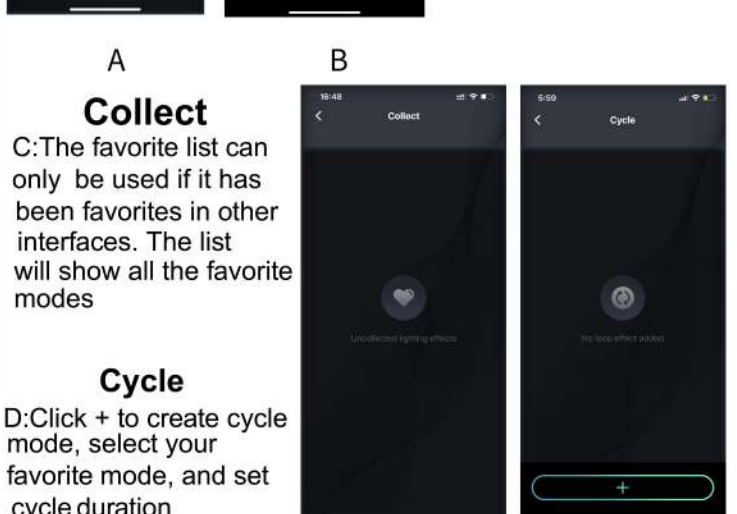

**Collect**  
C: The favorite list can only be used if it has been favorites in other interfaces. The list will show all the favorite modes

**Cycle**  
D: Click + to create cycle mode, select your favorite mode, and set cycle duration

C D 9

## Camera



E1

E2: Aim at the color you want to take, press the color button to take the color

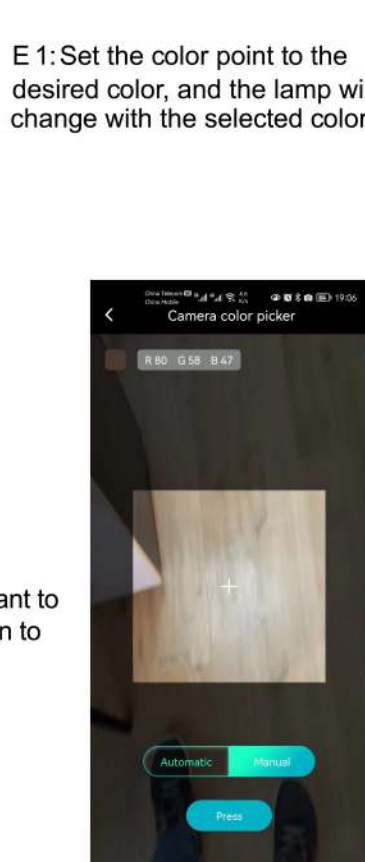

E2 10

## Rhythm

F: Music rhythm interface. The APP will read the local song of the phone, and the light will root when the music is played Rhythm according to the melody of the song, you can also choose different patterns of rhythm.

F1: Turn on the microphone mode of the phone, the phone will recognize the surrounding sound, and the light will follow the sound

The size of the volume for rhythm, can choose different rhythm mode.

F2: Turn on the microphone mode, and the speaker module of the smart string recognizes the sounds around it and beats them according to the volume.

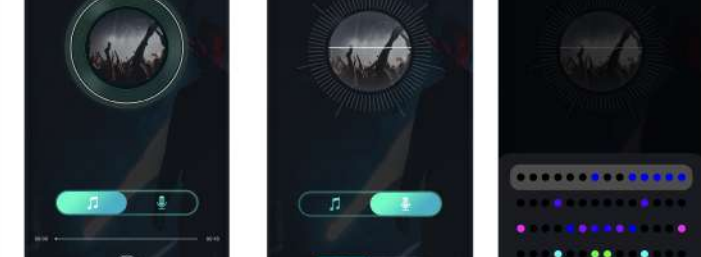

Note: The following dialog box will appear when you use the APP for the first time. Please check "Allow" and continue operation.



11

## Timer

The timing function, you can set multiple switch lights at the same time.

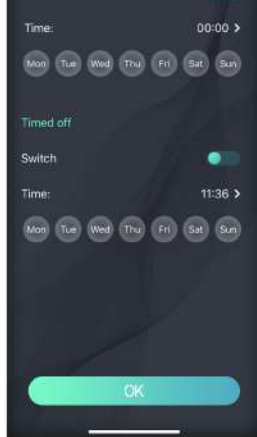

G

## Settings

Color correction : Can be used to calibrate the color of the headlight bar.

Number of lights : You can set the number of lights in each segment of the string.

Device information : Displays the hardware and software information of the device.

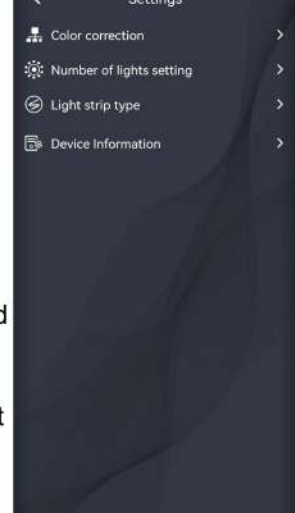

H

12

## FCC Statement

This equipment has been tested and found to comply with the limits for a Class B digital device, pursuant to part 15 of the FCC Rules. These limits are designed to provide reasonable protection

against harmful interference in a residential installation. This equipment generates, uses and can

radiate radio frequency energy and, if not installed and used in accordance with the instructions,

may cause harmful interference to radio communications. However, there is no guarantee that

interference will not occur in a particular installation. If this equipment does cause harmful

interference to radio or television reception, which can be determined by turning the equipment

off and on, the user is encouraged to try to correct the interference by one or more of the

following measures:

- Reorient or relocate the receiving antenna.
- Increase the separation between the equipment and receiver.
- Connect the equipment into an outlet on a circuit different from that to which the receiver is connected.
- Consult the dealer or an experienced radio/TV technician for help.

13

Caution: Any changes or modifications to this device not explicitly approved by manufacturer could void your authority to operate this equipment.

This device complies with part 15 of the FCC Rules. Operation is subject to the following two

conditions: (1) This device may not cause harmful interference, and (2) this device must accept

any interference received, including interference that may cause undesired operation.

## RF Exposure Information

This equipment complies with FCC radiation exposure limits set forth for an uncontrolled

environment. This equipment should be installed and operated with minimum distance 20cm

between the radiator and your body.

14

## Notes

1. Please take care of children aged 0-6 to prevent accidental ingestion.
2. Do not put this product in water or use it near a fire source.
3. If there is a knot during use, please do not pull it hard.
4. Do not disassemble the product without authorization.
5. Frequent switching will affect the service life of the product. If you do not use this product for a long time, please cut off the power and keep it in a cool and dry place.

We will test each set of products before delivery, but it may be damaged during transportation, please test after receiving the product, if you encounter any problems during use, please contact the seller in time, we will find the most suitable best solution.



iDeal LED

CE FC RoHS

MADE IN CHINA

15



Monochrome goes to the next color

Monochrome turn to next mode

Speed+/-

Timer

Direction of horse racing

Collection mode cycle

Rhythm mode+/-

Fixed mode

16