

TUVACS

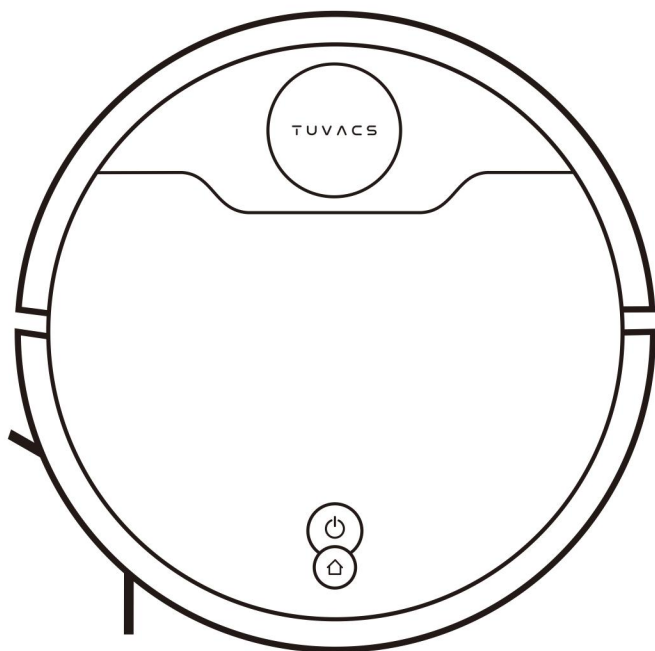

USER MANUAL

T10 Pro

Welcome

Thank you for choosing TUVACS.

Please read this manual and related illustrations carefully before using your robot to ensure the best experience possible.

If you experience any problems while using your robot, please contact TUVACS customer support using the contact information below:

1. You are welcome to reach us at support@tuvacs.com for any questions, inquiries and suggestions.
2. Steps to contact us via Amazon
 - Log in to your Amazon account and find the order for your robot vacuum.
 - Click on "Sold by [storefront name]".
 - Click "Ask a question".
 - Select "An item for sell".

We hope you have a simple and hassle-free home cleaning experience with TUVACS products.

Important Safety Information

READ AND SAVE THESE INSTRUCTIONS

To reduce the risk of injury or damage, please read and follow the safety precautions when setting up, using, and maintaining your robot.

This appliance is suitable for use by children aged 8 and older, as well as individuals with reduced physical, sensory, or mental capabilities, or those with limited experience and knowledge, provided that they are under supervision or have received instruction on how to operate the appliance safely and are aware of the associated risks. Children shall not play with the appliance. Cleaning and user maintenance shall not be done by children without supervision.

General

Warning

1. **Battery and Charging Base Usage:** Use only the charging base provided by the manufacturer. Avoid unauthorized battery replacements. In case of battery damage, contact the manufacturer, an authorized distributor, or qualified professionals for a safe replacement.
2. **Environment Restrictions:** Do not operate the robot vacuum in areas containing fire hazards or fragile items.
3. **Temperature Guidelines:** The robot vacuum should not be used in environments where the temperature exceeds 104°F (40°C) or falls below 32°F (0°C).
4. **Proximity to Robot Parts:** Keep hair, clothing, fingers, and other body parts away from the robot's openings and moving parts to prevent injury or damage.
5. **Floor Conditions:** Avoid using the robot vacuum on water-soaked or wet floors to prevent malfunction or damage.
6. **Debris Precautions:** Do not use the robot vacuum to pick up stones, paper, or other objects that may cause the device to jam.

7. **Flammable Materials:** Refrain from using the robot vacuum to pick up flammable substances like gasoline or printer toner. Additionally, do not operate the robot vacuum in areas containing flammable materials.
8. **Burning Objects:** Never use the robot vacuum to pick up burning or smoldering items such as cigarettes, matches, ashes, or any other materials that could ignite a fire.
9. **Suction Opening Maintenance:** Ensure the suction opening is unobstructed. Do not operate the robot vacuum if the suction opening is blocked. Regularly clean the suction opening of dust, fibers, and hair to maintain proper airflow.
10. **Power Cord Safety:** Exercise caution with the power cord. Avoid dragging or pulling the appliance or charging base with the cord. Do not use the power cord as a handle. Prevent the cord from being squeezed in door cracks or wrapped around corners and sharp edges. Keep the power cord clear of heat sources.
11. **Charging Base Malfunction:** If the charging base is not functioning correctly, do not use it. To minimize risks, ensure that only the manufacturer, an authorized agent, or professional personnel service the charging base.
12. **Handling Damaged Appliances:** Never attempt to set the appliance on fire, even if it is severely damaged. The battery may pose an explosion risk when exposed to heat sources.

Caution

1. **Pre-Operational Checks:** Before use, clear the area of any potential hazards such as power cords and small objects that may obstruct the robot's movement. Tuck in rug tassels and ensure that curtains or other soft furnishings are not in contact with the floor.
2. **Stairway Precautions:** When cleaning a room with stairs or steps, confirm that the robot can detect edges to prevent falls. If unsure, place a physical barrier at the edge and verify its effectiveness before use.
3. **Operational Instructions:** Operate the appliance strictly according to the instructions provided in this manual. Use only accessories recommended or sold by the robot manufacturer.
4. **Voltage Compatibility:** Ensure that the power supply voltage corresponds with the specifications indicated on the charging base.
5. **Component Verification:** Check that the dustbin and filter are correctly installed prior to use.
6. **Power Cord Replacement:** In the event of power cord damage, ensure replacement is carried out by a qualified manufacturer, service center, or service personnel.
7. **Maintenance Safety:** Before cleaning or maintaining the robot, ensure it is switched off and the power supply is disconnected.
8. **Cleaning and Servicing:** The power plug must be removed from the outlet before any cleaning or servicing of the product takes place.
9. **Disposal Procedures:** When discarding the product, remove it from the charging base, switch it off, and remove the battery in accordance with local laws and regulations.
10. **Battery Disposal:** Dispose of the battery in compliance with local laws and environmental regulations.
11. **Long-Term Inactivity:** Power off the product if it is not going to be used for an extended period.
12. **Used Batteries:** Handle and dispose of used batteries in accordance with local laws and regulations.

13. **Intended Use:** The product is designed exclusively for indoor residential use. Do not use it outdoors or for commercial or industrial applications.
14. **Infant Safety:** Do not operate the product in a room where an infant is sleeping.
15. **Damaged Components:** Do not use the appliance with a damaged power cord or socket. If the robot malfunctions due to damage, outdoor use, a fall, or exposure to water, cease operation immediately and have it serviced by a qualified manufacturer or customer care center.
16. **Proper Use:** Adhere to the instructions provided in this manual for the safe use of the product. The company assumes no liability for any damage or injury resulting from improper use of the appliance.

Battery

Warning

1. Do not open, crush, heat above 176°F: 80°C, or incinerate the product. Follow the instructions in the Owner's Guide for proper use, maintenance, handling, and disposal.
2. Avoid short-circuiting the battery by preventing metal objects from contacting battery terminals or immersing them in liquid. Do not subject batteries to mechanical shock.
3. Lithium-ion batteries and products containing them are subject to stringent transportation regulations. If you need to ship this product with the battery included for service, travel, or any other purpose, please ensure that you comply with all applicable regulations. Please refer to your manual or contact customer support for shipping instructions.
4. Regularly check the battery pack for damage or leakage. Do not charge or use damaged or leaking battery packs. In case of contact with skin or eyes, wash the affected area with plenty of water and seek medical advice. Dispose of the battery safely according to local environmental regulations by placing it in a sealed plastic bag for recycling or disposal.

Notice

1. **Battery Disposal and Recycling:** Prior to recycling or disposing of the robot vacuum, it is essential to remove the battery pack. Please follow local regulations and guidelines for proper battery disposal to minimize environmental impact.
2. **Recommended Battery Type:** For optimal performance and safety, use only the original TUVACS Lithium-Ion Battery that is included with your robot vacuum. This battery is specifically designed for your device and ensures compatibility and efficiency.
3. **Battery Usage Guidelines:** The robot vacuum is equipped to work with rechargeable batteries only. Do not attempt to use non-rechargeable batteries with this product, as they are not designed for the charging and discharging cycles required for the robot's operation and may pose a safety risk. Always use the rechargeable battery provided with your robot vacuum to maintain the device's performance and safety standards.

CEC Test Instructions

To perform the CEC test, the robot vacuum must be in a special mode.

Follow these steps to activate the special mode:

1. Press and hold the power button to turn on the machine, or place the machine in the charging dock to turn it on.
2. After the machine has finished starting, press the power button, recharge button, and the bumper simultaneously for 10 seconds. The machine's light will turn off, indicating that it has entered special mode.

CONTENTS

1. PRODUCT INTRODUCTION	P01
1.1 What's in the box	
1.2 Product overview	
1.3 Indicator light status instructions	
2.INSTALLATION AND USE	P04
2.1 Before start	
2.2 Getting the robot ready for first use	
2.3 Charging	
2.4 Connect to the APP	
2.5 Use	
3.ROUTINE MAINTENACE	P13
3.1 Maintenance and replacement frequency	
3.2 Maintenance methods	
4.PRIMARY PARAMETERS	P17
5.TROUBLE SHOOTING	P18
5.1 Common issues	
5.2 Voice prompts in case of errors	

1. PRODUCT INTRODUCTION

1.1 What's in the box

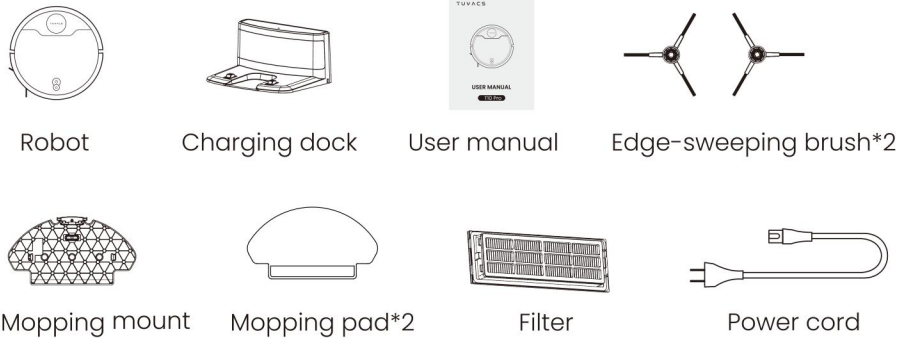

*Pictures shown in this manual are for illustrative purposes only.
The actual product may vary.

1.2 Product overview

Top view

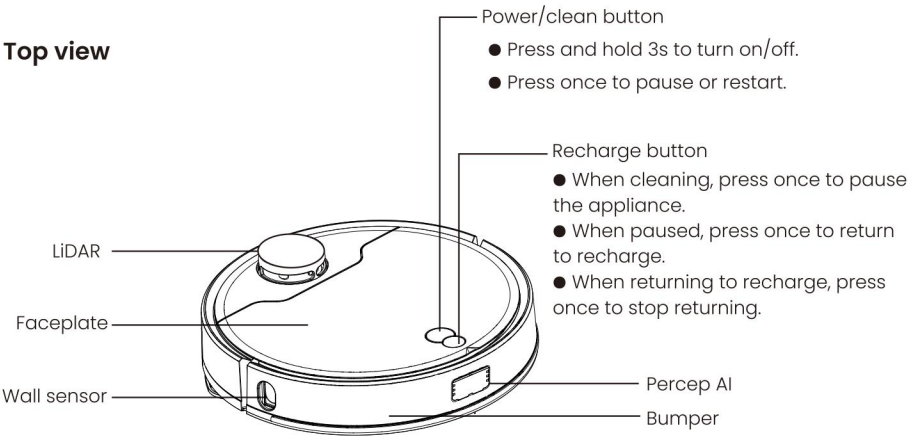

Dustbox

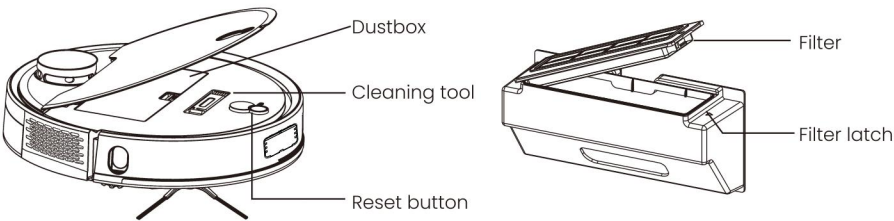

Bottom view

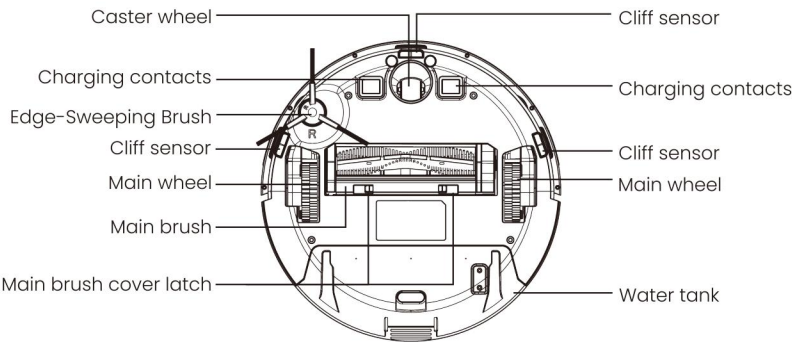



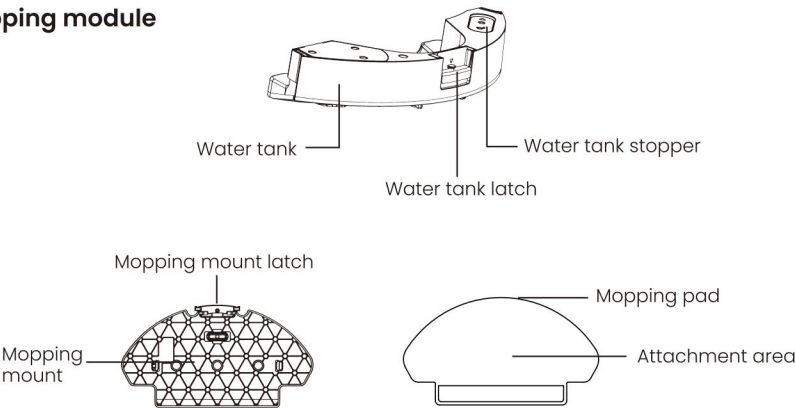



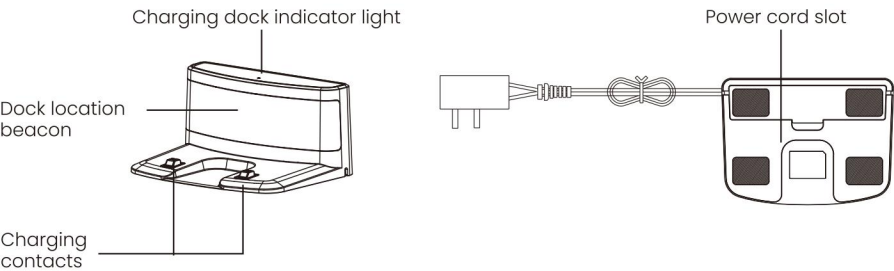







Mopping module



Charging dock



1.3 Indicator light status instructions

Device status	Indicator light status	
ON	 	White lights
OFF	Lights off	
Stand-by mode	Lights off	
Battery power >20%		Red light: return to recharge Red light flashing: charging
		White light: Cleaning
Battery power >20% (No network connection)		White light: return to recharge/charging completed White light flashing: charging
		Blue light: Cleaning
Battery power >20% (Network connected)		Blue light: return to recharge/charging completed Blue light flashing: charging
	 	Red lights flashing
Failure	 	White lights flashing
Network reconfiguration	 	Blue lights
Network connected	 	

1.4 Button descriptions

	Stand-by mode	Cleaning	Pause	Auto recharge	Pause auto recharge	OFF
Press the power button once	Start cleaning	Pause cleaning	Resume cleaning	Pause auto recharge	Resume cleaning	
Press the power button once	Recharge	Pause	Resume cleaning	Pause auto recharge		
Press and hold the power button and recharge button for 3s	Start network configuration					Self-detection mode
Press and hold the power button for 3s	OFF					ON
Press and hold the recharge button for 3s	Spot cleaning					
Press the reset button once (Under the faceplate)	Forced shutdown					

2. INSTALLATION AND USE

2.1 Before start

2.1.1 Prepare the home environment for optimal cleaning

- Before starting the cleaning process, it is advisable to arrange your furniture neatly to ensure unobstructed access.
- Remove or cover any objects with low-height bases, such as fans, weighing scales, etc., that may affect the normal operation of the robot vacuum.
- Remove any loose items from the room, such as cables, duster cloths, and slippers.
- If the room contains a rug with tassels, to prevent tangling, please fold the tassels under the rug before operating the device. Do not use the mopping function on carpets or rugs.

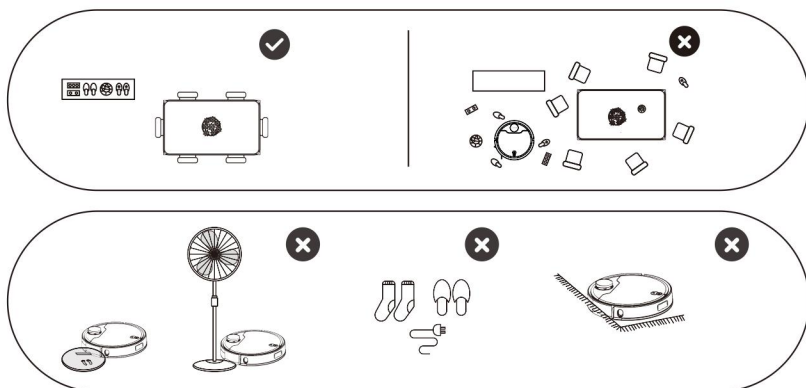

2.1.2 Prevent the robotic cleaner from falling

- Position a barrier on the edge of staircases or balconies to prevent the robot from falling.

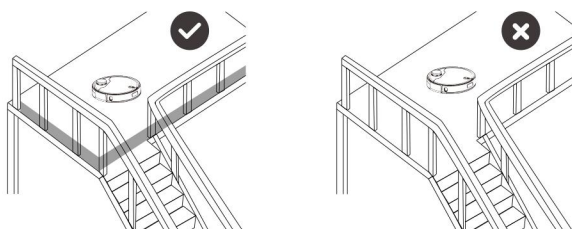

2.1.3 Cover reflective surfaces

- Cover any reflective surfaces, such as mirrors and glass, within 10 cm of the floor to avoid confusing the robot's route detection.

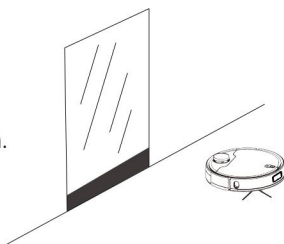

2.1.4 Your position may affect the robot's sensors

- Please avoid standing in narrow places, such as halls or thresholds, as the robot may not be able to identify the areas to be cleaned.

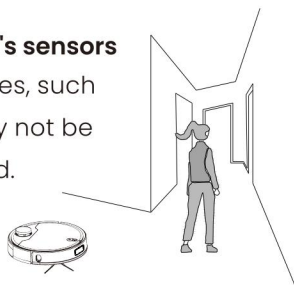

Note: When using the robot for the first time, please walk behind it to address any issues and ensure smooth operation. Please avoid walking in front of the robot.

2.2 Getting the robot ready for first use

2.2.1 Remove the protectors

Open the faceplate and remove the protective strip. Remove the protective films on the faceplate and charging base.

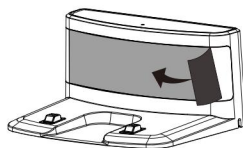
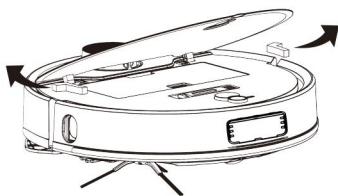

2.2.2 Install the edge-sweeping brush correctly

Align the edge-sweeping brush with the slots then install the edge-sweeping brush. You should hear the brush snap into position.

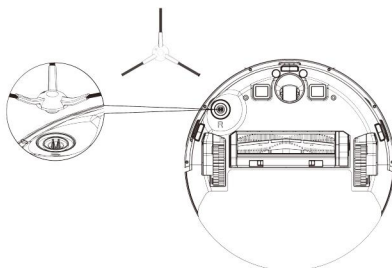

2.3 Charging

2.3.1 Position the charging dock

Position the charging dock on a flat surface against the wall. Connect the power cord and store any excess cord in the designated slot. For optimal app performance, ensure that the charging dock is placed in an area with strong Wi-Fi coverage.

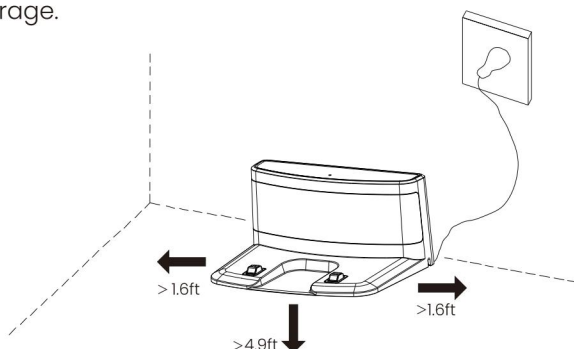

Note:

- To ensure proper charging, make sure the charging dock has at least 1.6ft of clear space on both the left and right sides, and 4.9ft of clear space at the front.
- If the power cord is on the floor, it may be dragged by the robot, causing the charging dock to move or disconnect from the power supply.
- The indicator light on the charging dock remains constant when it is powered on, and turns off when the robot is being charged.
- To ensure successful docking, avoid placing the charging base in direct sunlight or obstructing the location beacon.

2.3.2 Power on and charge

Activate the robot vacuum by pressing and holding the power button for 3 seconds until the indicator light illuminates and you hear "Robot start up." For charging, simply position the robot on the charging base. Your robot vacuum comes with a high-performance Li-ion battery pack. To maintain peak battery efficiency, keep the robot charged when in regular use.

Note:

- If the battery level is insufficient, the robot may fail to start. Please place the robot on the charging dock to charge it.
- To ensure the robot can successfully return to the charging dock, it is recommended to start the robot from the charging dock and avoid moving the charging base during each cleaning session.

2.4 Connect to the APP

2.4.1 Download the app

Search for "TUVACS" in the APPLE Store or Google Play or scan the QR code to download and install the app.



2.4.2 Register for an account and log in

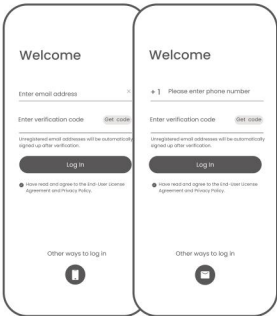

2.4.3 Follow the in-app prompts to add your robot

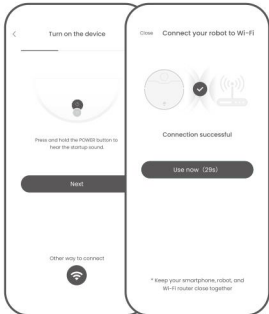

2.5 Use

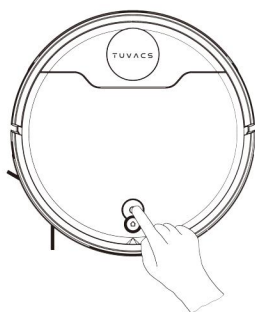

2.5.1 Power ON/OFF

To power on the unit, press and hold the power button for 3 seconds. Once the power button and recharge button are backlit, the robot is ready to clean. Press the power button once to start cleaning. To end the cleaning task and shut down the robot, press and hold the power button for 3 seconds.

Note:

- The robot cannot be turned off while it is charging.
- If the robot has been paused for more than 24 hours, it will automatically power off.

2.5.2 Start cleaning

Press the power button to start the cleaning process. The robot will plan its cleaning route based on the map it created. It will clean along the walls first and then clean the divided area in a Z pattern, covering the entire area in an orderly and efficient manner.

Note:

- Recharge the robot if the battery level is low to ensure it can clean effectively.
- Tidy any cables, including the charging dock power cord, and fragile items on the floor. Loose wires and objects may get caught in the robot, causing disconnection or wire/item damages.
- The robot will clean twice by default if a cleaning task is completed in less than 10 minutes.
- If the battery runs low during the cleaning task, the robot will automatically return to the charging dock to recharge. It will then continue from where it left off.