

01



Downloading and connecting the "LED Lamp" app:

Use your mobile phone to scan the QR code to download the "LED Lamp" app.

The app is compatible with Android and Apple iOS systems.

(使用手机扫描二维码下载“LED 灯”APP。

该应用程序兼容安卓和苹果 iOS 系统。)

02

Connecting the projection lamp to the app:

Connect the projection lamp to the power supply and turn it on.

Open the "LED Lamp" app and swipe down on the blank area of the home page to search for available devices.

(将投影灯连接到应用程序：

将投影灯连接到电源并打开它。

打开“LED 灯”APP，在首页空白处向下滑动，搜索可用设备。

控制 RGB 颜色和亮度：)

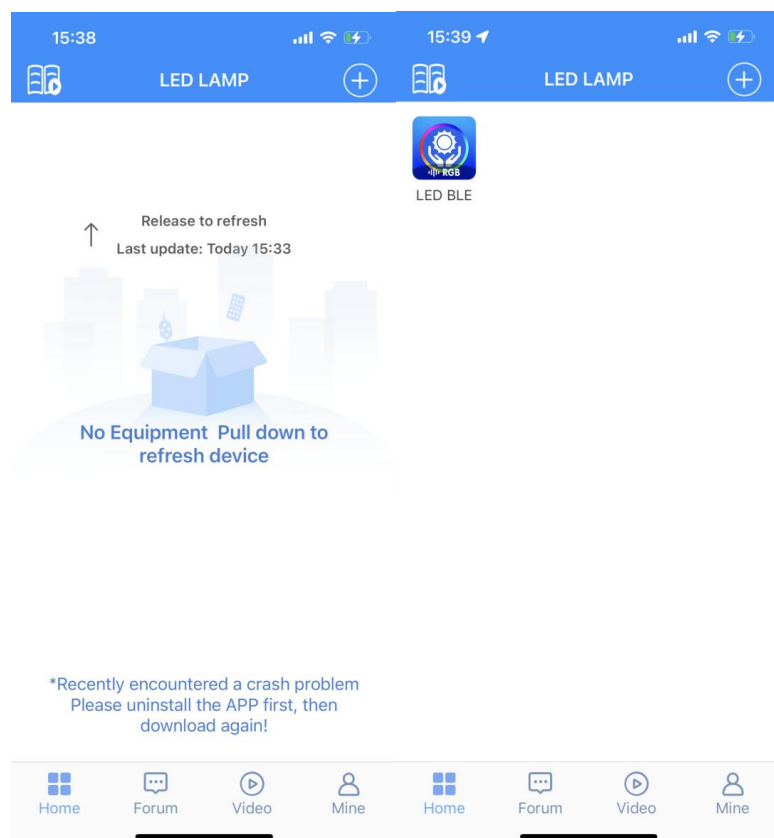

03

Controlling the RGB color and brightness:

Click on the "LED BLE" icon to enter the control page.

The number "1" will appear in the marked position to indicate that the device has been successfully connected.

On this page, you can adjust the color and brightness of the lamp as desired.

控制 RGB 颜色和亮度：

点击“LED BLE”图标进入控制页面。

标记位置会出现数字“1”，表示设备连接成功。

在此页面上，您可以根据需要调整灯的颜色和亮度。

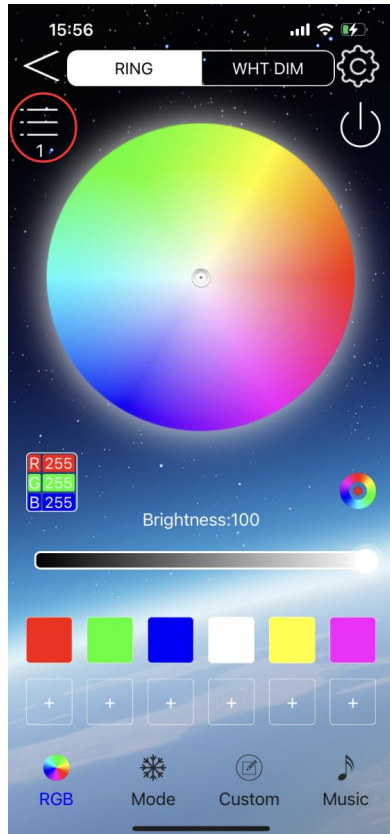

04

Selecting the lighting mode:

On the control page, you can select the lighting mode by clicking on the "Mode" option.

By clicking on the "+" symbol, you can set the parameters of different lighting modes.

选择照明模式：

在控制页面上，您可以通过单击“模式”选项来选择照明模式。

通过点击“+”号，可以设置不同灯光模式的参数。

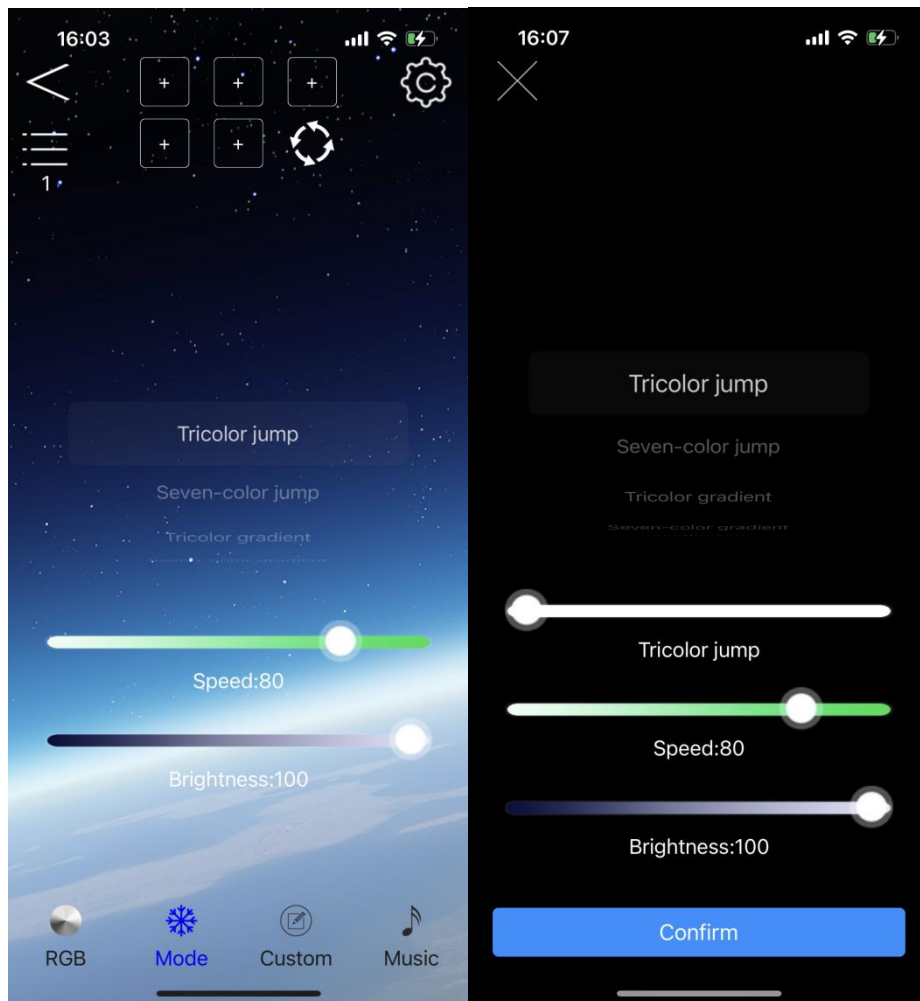

05

Customizing the lighting effects:

On the control page, you can customize the color, speed, and brightness of the lamp by clicking on the "Custom" option.

To delete a color, long-press on the color block. To add a new color, click on the "+" symbol and select a color.

自定义灯光效果：

在控制页面上，您可以通过点击“自定义”选项来自定义灯的颜色、速度和亮度。

要删除颜色，请长按色块。 要添加新颜色，请单击“+”符号并选择一种颜色。

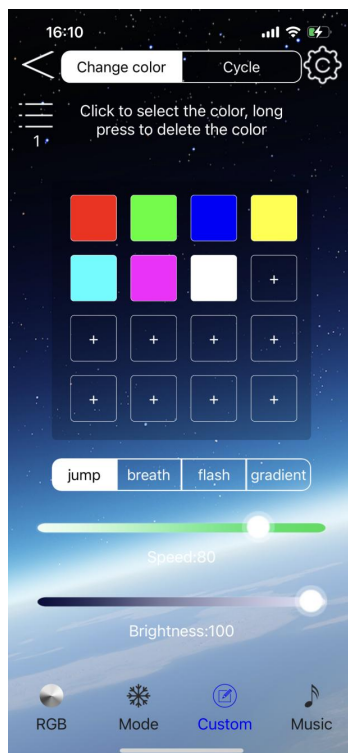

06

Synchronizing the lighting with music:

On the control page, you can activate the music mode.

The lamp's lighting effects will change in sync with the rhythm of external

sounds or music playing on your phone.

灯光与音乐同步：

在控制页面上，您可以激活音乐模式。

灯泡的灯光效果会随着外部声音或手机上播放的音乐的节奏同步变化。

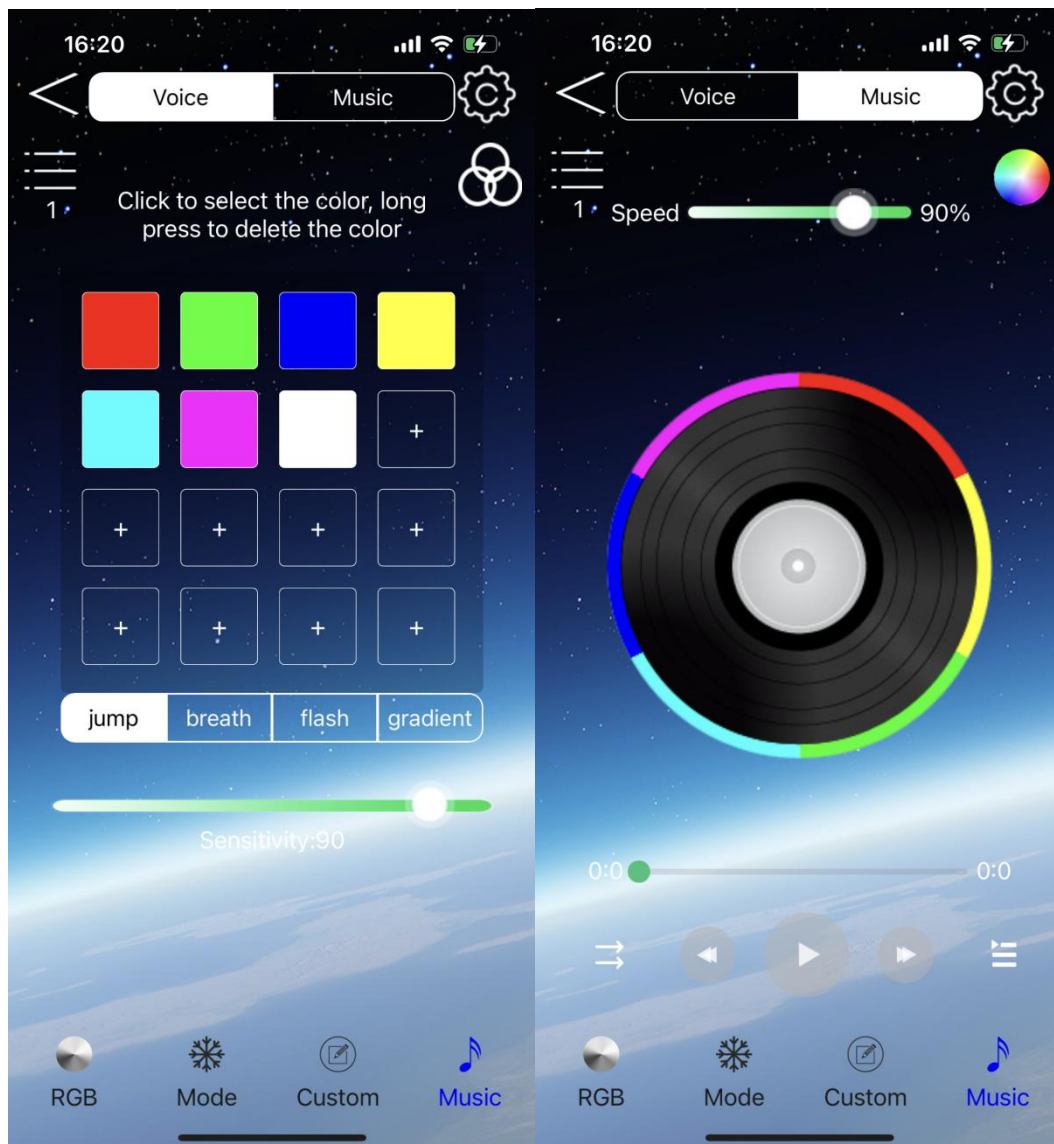

FCC Warning Statement: Changes or modifications to this unit not expressly approved by the party responsible for compliance could void the user's authority to operate the equipment. This equipment has been tested and found to comply with the limits for a Class B digital device, pursuant to Part 15 of the FCC Rules. These limits are designed to provide reasonable protection against harmful interference in a residential installation. This equipment generates, uses and can radiate radio frequency energy and, if not installed and used in accordance with the instructions, may cause harmful interference to radio communications.

However, there is no guarantee that interference will not occur in a particular installation. If this equipment does cause harmful interference to radio or television reception, which can be determined by turning the equipment off and on, the user is encouraged to try to correct the interference by one or more of the following measures:

- Reorient or relocate the receiving antenna.
- Increase the separation between the equipment and receiver.
- Connect the equipment into an outlet on a circuit different from that to which the receiver is connected.
- Consult the dealer or an experienced radio/TV technician for help.

This device complies with Part 15 of the FCC Rules. Operation is subject to the following two conditions: (1) this device may not cause harmful interference, and (2) this device must accept any interference received, including interference that may cause undesired operation.

FCC Radiation Exposure Statement

The device has been evaluated to meet general RF exposure requirement. The device can be used in portable exposure condition without restriction.