

SODI

Product User Manual.

C50

MAGNETIC
WIRELESS CAR
CHARGER.

Product Features

Water drop-shaped breathing lights, the overall shape is round and delicate, and the mechanical aesthetic turbine heat dissipation holes cool down quickly.

The strong magnetic suction module has stable adsorption; the new fixed claw is solid and not easy to damage.

MAGNETIC WIRELESS CAR CHARGER.

Aluminum alloy with frosted matte finish and a smooth, high-gloss glass mirror. The combination of glossy and rough sandwich materials gives the product a deep sense of technology and layering.

Supports up to 15W wireless fast charging.

MAGNETIC WIRELESS CAR CHARGER.

Product Specifications

Brand: SODI

Product Name: Magnetic Wireless Car Charger

Model No: C50

Product Size: 121.8x96.2x24.7mm

Product Weight: 119.5g

MAGNETIC WIRELESS CAR CHARGER.

Input: 5V = 3A/9V = 2A

Output Power: 15W Max

Material: Aluminum Alloy+ABS+Tempered Glass

MAGNETIC WIRELESS CAR CHARGER.

MAGNETIC
WIRELESS CAR
CHARGER.



SODI

Magnetic Wireless Charger

► Magnetic Charging Area

► LED Indicator

► Type-C Interface





Functional Definition

Magnetic Charging Area

Strong magnetic suction module, stable adsorption ability. Support up to 15W wireless fast charging.

Align the back of the phone with the magnetic charging position to charge.

LED Indicator

The lights are available in two colors, which can be seen on the indicator information page. When the indicator light flashes green slowly, it is standby in normal charging mode, and when it is constantly green, it is standby in fast charging mode. When the indicator is blue in breathing status, it means charging; and when the indicator is solid blue, it means that charging is complete. The indicator light flashes blue and green alternately, indicating that a foreign object has been detected in the charging area.

Type-C Interface

Connect the USB cable to the wireless charger to connect the wireless charging source.

The indicator light remains on.



Indicator Information

Always on - charging complete
Breathing status - charging

► Blue Indicator



Green slow flashing
- powered on/in standby (5V)
Always on
- powered on /in standby (9V)

► Green Indicator



Support Structure

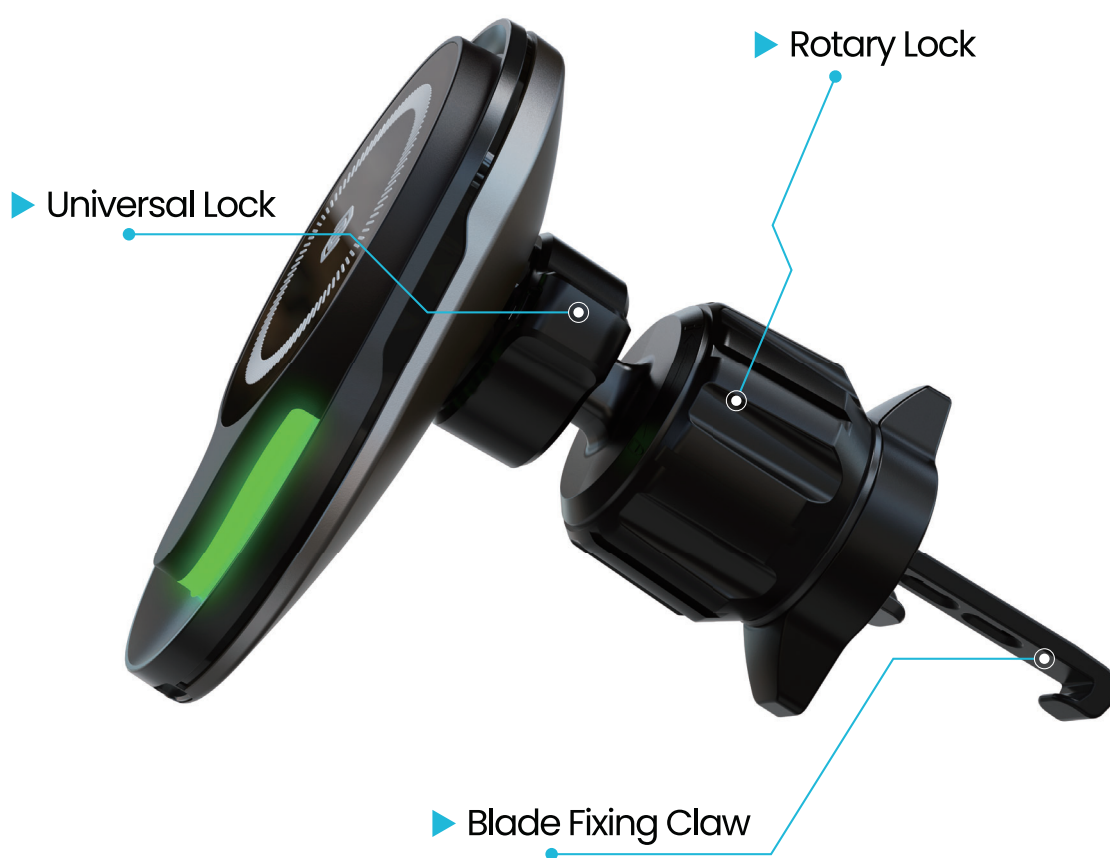



Functional Definition

Universal Lock

The lock that connects the wireless charger to the bracket can secure the wireless charger at any angle on the bracket. 3 and 4 are the directions of opening/locking twisting. (See diagram page)

Rotary Lock

The air vent blades of the car is different in size, so we should reverse twist in the direction of the arrows 1 and 2 to adjust the length of the support arm to fit different air vent blades. (See diagram page).

Blade Fixing Claw

Twist the rotary lock to control the length of the support arm, which is used to fasten the air outlet blades of the car to hold them in place. (See diagram page)

Only for iPhone with MagSafe.

For models that do not have MagSafe, please wear a mobile phone case with magnetic pads.



Diagram

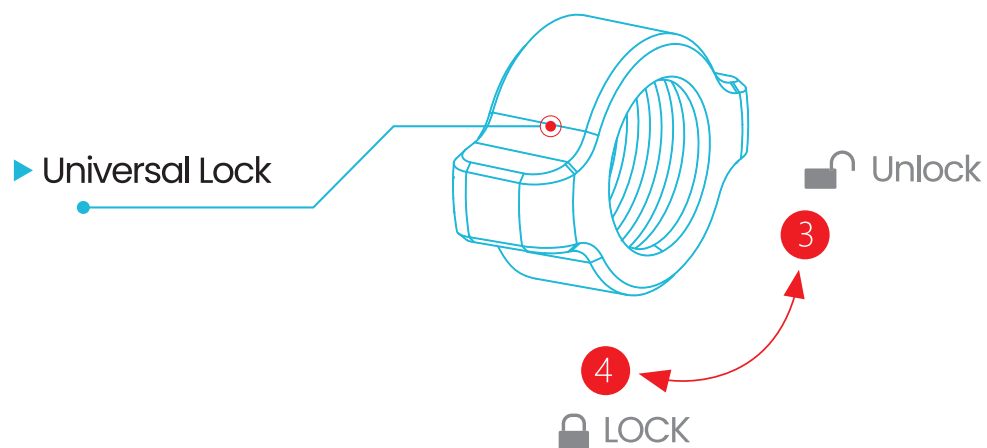
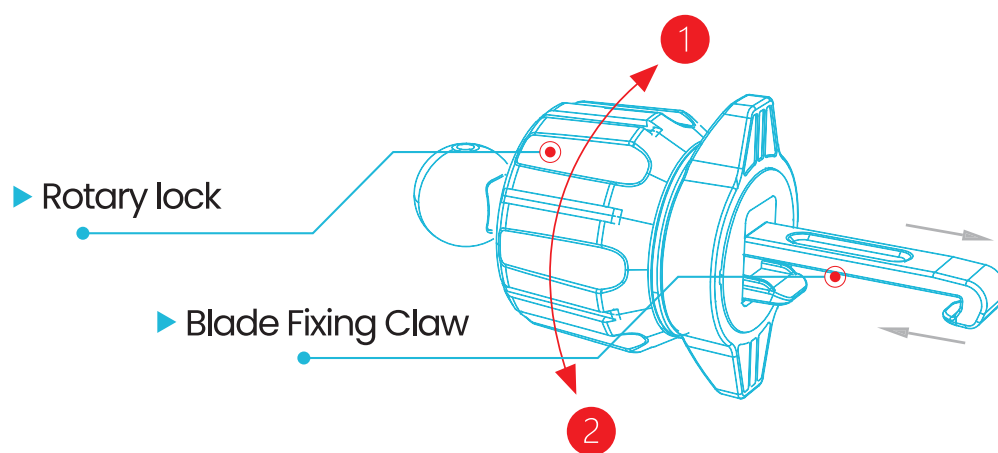



Installation Step 1

Assemble parts A/B/C in order.

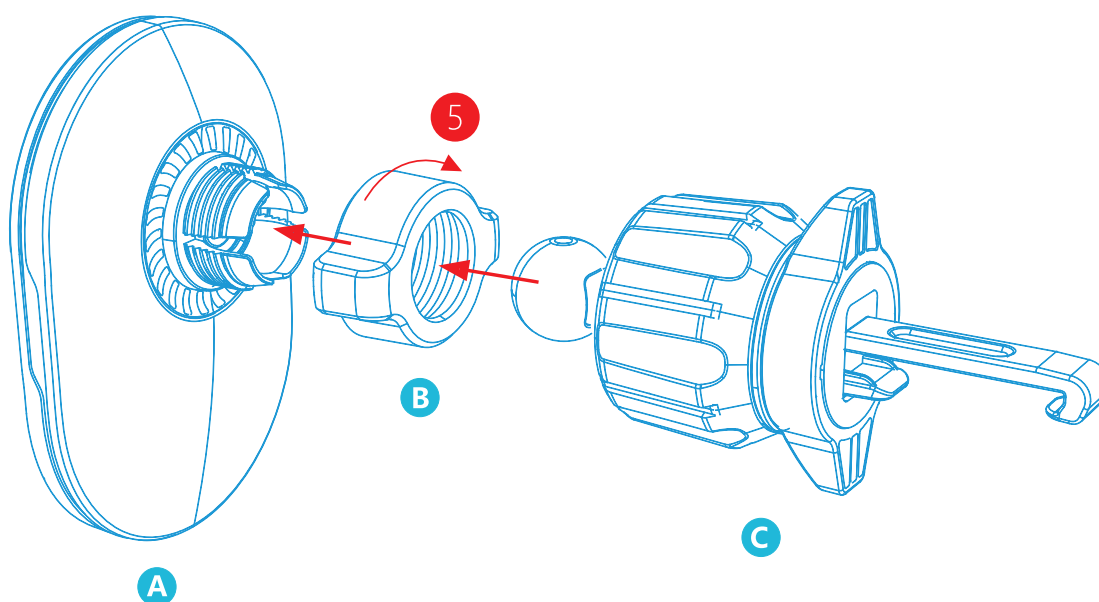

- After assembling the three fittings, turn the B fittings in the direction of the red arrow to fix the A and B fittings.

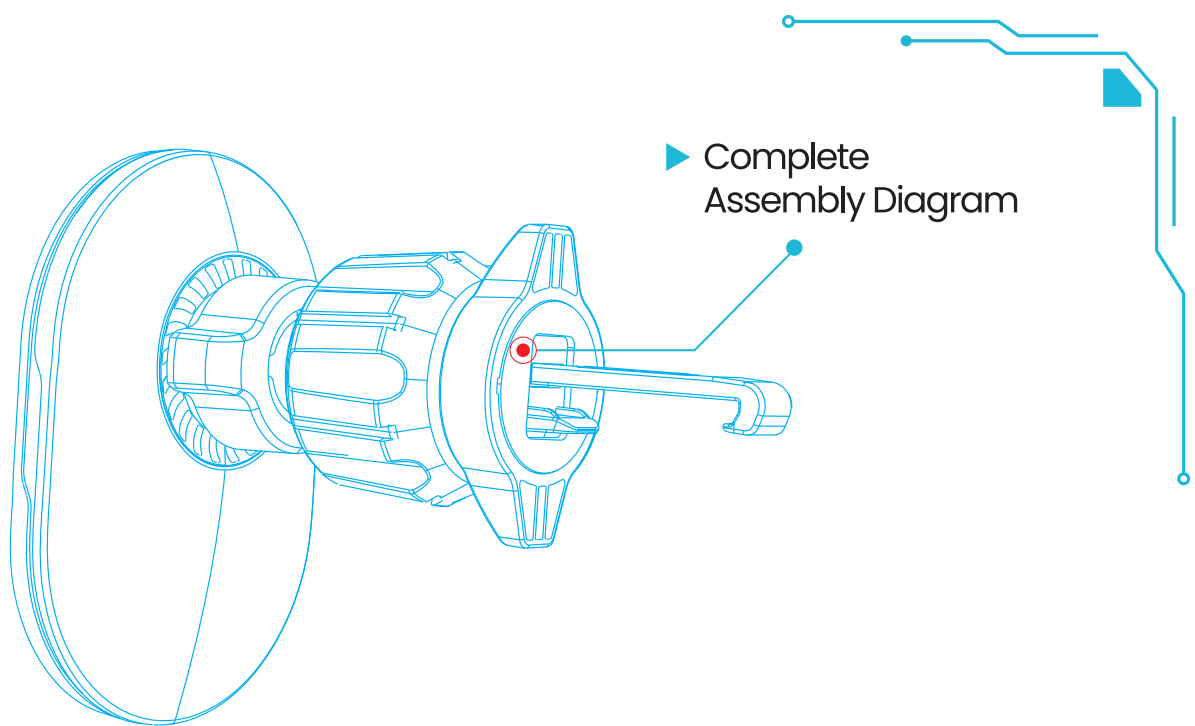

- ▶ Once the magnetic wireless charger and bracket are completely assembled, the support arm can be mounted to the car's air vent blades.
- ▶ Turn the regulator appropriately during installation. Detailed instructions and illustrations can be found in Installation Step 2.



Installation Step 2

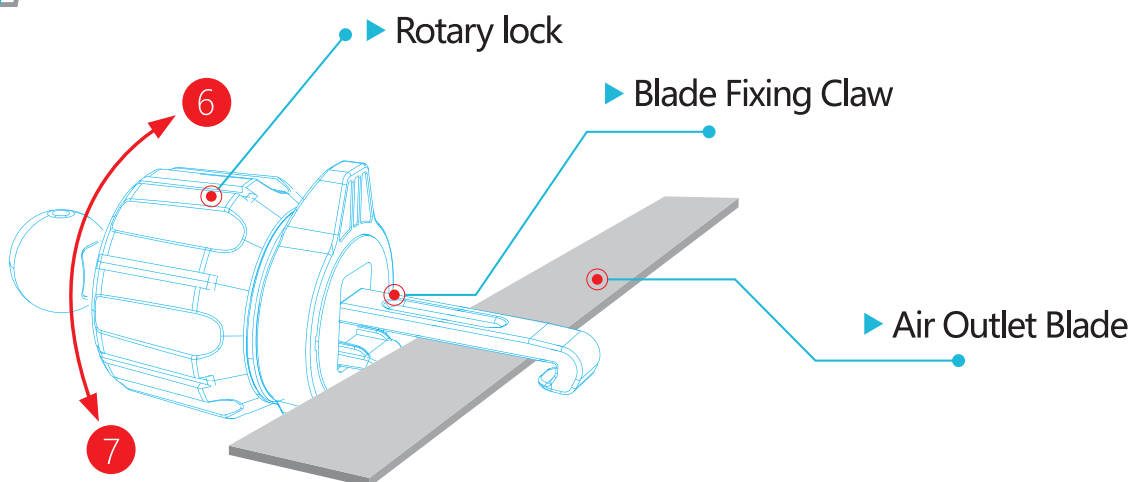

- ▶ When installing, please rotate in the direction of the 6 arrow to extend the support arm and then buckle it onto the air outlet blade, and finally rotate in the direction of the 7 arrow to retract the support arm to complete the fixing.

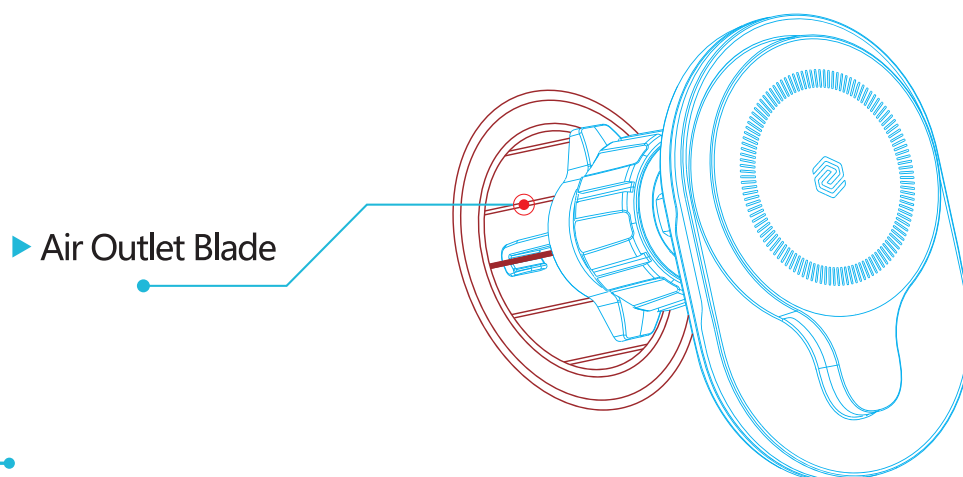

Precautions

Please do not place metal or magnetic objects (such as coins, bank cards, keys, etc. in the charging area when charging, which may cause the charger to be damage or abnormality).

Please do not use the product in high temperature, humid, or corrosive environments.

If the charger overheats and stops charging during use, please remove the charging unit and allow it to cool before charging again.

Please keep the charger away from water or other liquids.

This equipment should be installed and operated with a minimum distance of 20 centimeters between the radiator and the body.

MAGNETIC WIRELESS CAR CHARGER.





FCC WARNING

This device complies with part 15 of the FCC Rules. Operation is subject to the following two conditions: (1) this device may not cause harmful interference, and (2) this device must accept any interference received, including interference that may cause undesired operation. Any changes or modifications not expressly approved by the party responsible for compliance could void the user's authority to operate the equipment.

NOTE: This equipment has been tested and found to comply with the limits for a Class B digital device, pursuant to Part 15 of the FCC Rules. These limits are designed to provide reasonable protection against harmful interference in a residential installation. This equipment generates, uses and can radiate radio frequency energy and, if not installed and used in accordance with the instructions, may cause harmful interference to radio communications. However, there is no guarantee that interference will not occur in a particular installation. If this equipment does cause harmful interference to radio or television reception, which can be determined by turning the equipment off and on, the user is encouraged to try to correct the interference by one or more of the following measures:

- Reorient or relocate the receiving antenna.
- Increase the separation between the equipment and receiver.
- Connect the equipment into an outlet on a circuit different from that to which the receiver is connected.
- Consult the dealer or an experienced radio/TV technician for help.



FCC WARNING

To maintain compliance with FCC's RF Exposure guidelines, This equipment should be installed and operated with minimum 20cm distance between the radiator and your body: Use only the supplied antenna.