

**FCC Part 15:**



**CAUTION:** Risk of Fire and Burns. Do Not Open, Crush, Heat Above 45°C/113°F or Incinerate. Follow Manufacturer's Instructions.

**ATTENTION:** Risque d'incendie et de brûlures. Ne pas incinérer, ouvrir ou endommager, ne pas exposer 45°C/113°F. Merci de suivre à une chaleur au-dessus de les instructions du fabricant.

## KP2236S Wireless Charging Notebook Instruction Manual

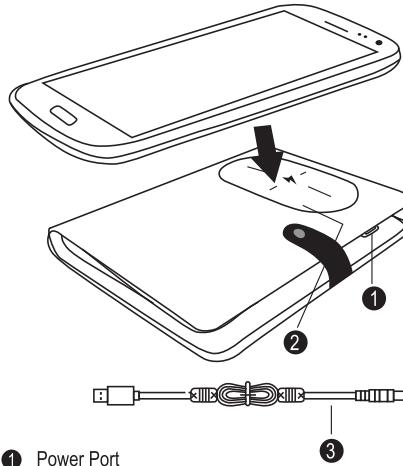

- ① Power Port
- ② Charging Area
- ③ Micro USB Power Cable (included)

### IMPORTANT SAFETY INSTRUCTIONS

- WARNING** - When using this product, basic precautions should always be followed, including the following:
- Read all the instructions before using the product.
  - To reduce the risk of injury, close supervision is necessary when the product is used near children.
  - Do not put fingers or hands into the product.
  - Do not expose the product to rain or snow.
  - Use of a power supply or charger not recommended or sold by the product manufacturer may result in a risk of fire or injury.
  - Do not use the product in excess of its output rating. Overload outputs above rating may result in a risk of fire or injury.
  - Do not use the product if it is damaged or modified. Damaged or modified batteries may exhibit unpredictable behavior resulting in fire, explosion or risk of injury.
  - Do not disassemble the product. Take it to a qualified service person when a service or repair is required. Incorrect reassembly may result in a risk of fire or injury to persons.
  - Do not expose the product to fire or excessive temperature. Exposure to fire or excessive temperature may cause an explosion.

### WIRELESS CHARGER OPERATION:

- 1) Connect wireless charging notebook to a power source via included micro USB cable.
- 2) Place portable device on center of charging area.
- 3) Phone charges immediately upon contact.

### TROUBLESHOOTING:

- Always place phone centrally on charger
- Phone case should be less than 4mm ( $\frac{3}{16}$ " ) thick
- Do not use magnetic cases
- Do not use credit card cases
- Do not use cases with metal rings

### PRODUCT SPECS:

Item No.: KP2236S  
Input Specs: DC:5V/ 2A  
Output Specs: 5V/1A  
Conversion efficiency:  $\geq 60\%$   
Accessories: USB cable; wireless charging notebook; instruction sheet.

### FCC STATEMENT

This device complies with Part 15 of the FCC Rules. Operation is subject to the following two conditions:  
1) This device may not cause harmful interference.  
2) This device must accept any interference received, including interference that may cause undesired operation.

**WARNING:** Changes or modifications not expressly approved by the party responsible for compliance could void the user's authority to operate the equipment.

**NOTE:** This equipment has been tested and found to comply with the limits for a Class B digital device, pursuant to Part 15 of the FCC Rules. These limits are designed to provide reasonable protection against harmful interference in a residential installation.

This equipment generates uses and can radiate radio frequency energy and if not installed and used in accordance with the instructions, may cause harmful interference to radio communications. However, there is no guarantee that interference will not occur in a particular installation. If this equipment does cause harmful interference to radio or television reception, which can be determined by turning the equipment off and on, the user is encouraged to try to correct the interference by one or more of the following measures:

- Reorient or relocate the receiving antenna.
- Increase the separation between the equipment and receiver.
- Connect the equipment into an outlet on a circuit different from that to which the receiver is connected.
- Consult the dealer or an experienced radio/TV technician for help.

This equipment complies with FCC radiation exposure limits set forth for an uncontrolled environment. This equipment should be installed and operated with minimum distance 20cm between the radiator & your body.

### CAUTION:

- Do not expose to moisture, sunlight, or other heat sources.
- Keep away from children and ensure all adults who use this product read and follow these instructions.
- Operation temperature range between 32° F and 113° F.
- Use correct voltage charge, 5V only.