



Kingbei Fit

## 产品使用流程:

### ● APP下载与安装

扫描下方二维码直接下载, 或者在应用市场/APP Store搜索"Kingbei Fit", 下载并安装"Kingbei Fit" APP。



请使用浏览器扫描二维码

Kingbei Fit

应用市场/APP Store搜索下载

### ● 绑定/连接设备

绑定设备的方法有两种: 附近设备、手动添加

① 附近设备: 打开附近设备页面自动搜索附近可匹配设备, 点击搜索出来的设备即可自动进行绑定 (请先确认产品属于开机亮灯状态);

② 手动添加: 选择需要添加的设备, 根据操作指引进行操作, 即可添加;

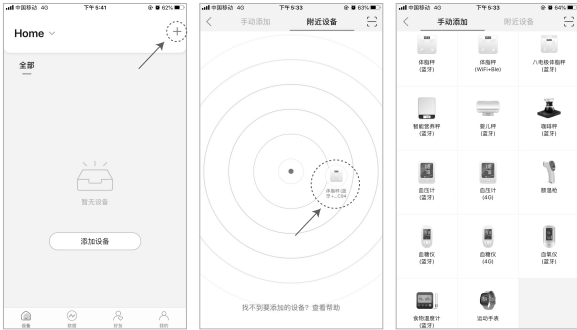

点击右上角 "+" 开始添加设备

自动搜索附近可用设备

手动选择需要添加的设备

### ● 数据功能

数据功能主要展示和用户相关的测量数据汇总, 例如用户有两个体脂秤都产生了同一个用户的体重数据, 将统一汇总在数据页面中的同一个用户上, 点击相应的数据类型可以查看所有数据汇总。

Kingbei Fit



点击用户头像切换用户  
查看不同用户数据

点击相应的模块可  
进入数据详情

### ● 家人管理

Kingbei Fit上的很多设备都可以和家人共同使用, 使用时切换不同的家人, 即可将数据保存在不同的家人下。

### ● 创建/管理家人

打开“我的”, 选择“我的家人”, 即可管理和创建家人。选择相应的家人则是编辑家人基础信息, 选择“添加家人”则是创建新的家人。创建家人需要设置: 头像、关系、昵称、生日、性别等信息, 生日、性别用于数据的计算分析和判断, 请认真填写。

注: 关系为家人与主账户之间的唯一标识, 一旦填写无法修改。

### ● 移除家人

选择相应的家人后进入家人管理页面, 点击右上角“垃圾桶”图标, 可以删除家人, 家人一旦删除所有数据将清空, 不可恢复。

### ● 设置

切换APP语言, APP语言默认按照手机系统进行切换, 用记也可以根据使用情况手动切换。

### ● 好友功能

添加好友有两种方法: 扫一扫添加、搜索账号ID/账号。通过验证后则成为好友, 可以查看开放好友的数据。

方法一: 扫一扫添加: 打开扫一扫功能扫描需要添加的好友的二维码;

方法二: 搜索账号ID/账号: 打开“搜索ID/账号”功能输入需要添加的好友的ID或者账号, 进行搜索添加;

### ● 如何查看好友数据

搜索或者是扫一扫后出现用户概况页面, 在“隐私保护”中打开“数据开放用户”, 在这里可以选择需要开放给好友查看的家人, 只有选择的家人才会被对方好友查看, 如果未选择好友则无法查看;

注: 主账户默认开放数据, 如果未有可查看数据的用户, 则不会显示在好友中。

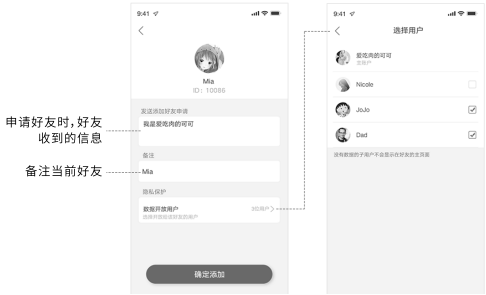

申请好友时, 好友  
收到的信息

备注当前好友

## 重要说明:

本说明书配套产品的测量数据仅供参考, 不能作为医疗意见!

## 产品保修卡

|       |  |      |  |
|-------|--|------|--|
| 产品名称  |  | 产品型号 |  |
| 购买日期  |  | 购买商店 |  |
| 经销商盖章 |  |      |  |
| 顾客姓名  |  | 顾客电话 |  |
| 顾客地址  |  |      |  |
| 故障描述  |  |      |  |

\*\*\* 本资料内容均经过认真核对, 如有任何印刷错漏或内容上的误解, 本公司保留最终解释权。



Kingbei Fit

## Product use process:

### ● APP download and installation

Scan the QR code below to download directly, or search for "Kingbei Fit" in the application market/APP Store, download and install the "Kingbei Fit" APP.



Scan to download Kingbei Fit

Kingbei Fit

Application market/APP  
Store search and download

### ● Bonding/connecting devices

There are two ways to bind devices: Devices nearby, Add manually

① Devices nearby: Automatically search for nearby matching devices, and click the searched device to automatically bind (Please confirm that the product is turned on and lighted);

② Add manually: Select the type of device to be added, and operate the binding device according to the operating instructions.

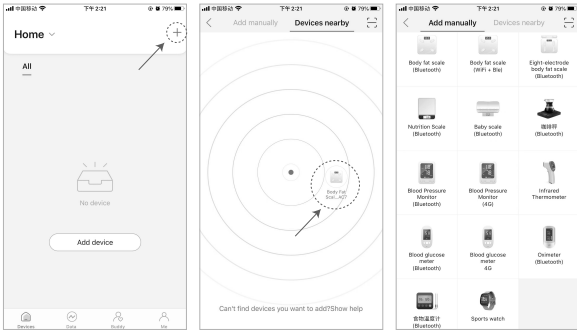

Click "+" to start adding devices

Automatically search for  
nearby available devices

Manually select the device to  
be added

### ● Data function

User measurement data statistics, for example: the user has two body fat scales that both generate the same user's weight data, which will be unified and summarized on the same user

in the data page. Click the corresponding data type to view all the data summary.

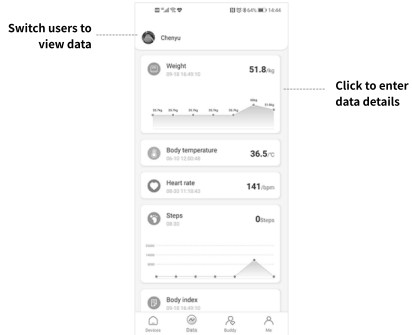

Switch users to  
view data

Click to enter  
data details

### ● Family management

The devices on Kingbei Fit can be used together with family members. Switch between different family members to save data under different family members.

### ● Create/manage family

Open "Me" and select "Family" you can manage and create members. Select the member you can edit it, and "Add family member" to create a new family member. To create a family member, you need to set: Profile picture, Relationship, Nickname, Birthday, Gender and other information. Birthday and gender are used for data calculation analysis and judgment. Please fill in carefully.

Note: The relationship is the only identifier between the family member and the main account. Once filled in, it cannot be modified.

### ● Remove family

Select the family member and click the "trash can" in the upper right corner to delete the family member. After the family member is deleted, all data will be cleared and cannot be restored.

### ● Setting

Switch the language, the APP language is switched according to the mobile phone system by default, and the user note can also be switched manually according to the usage.

### ● Add Friends

Two ways to add friends: Scan it or search ID/Account. After the other party is verified, you can view the friend's data.

Scan it: Turn on "Scan it" to scan the QR code of the friend to be added;

Search ID/Account: Open the "Search ID/Account", enter the ID or Account of the friend you want to add, search and add.

### ● View friend data

During the adding process, open the user settings interface and open the "Data open user" in the "Privacy Protection". You can select the members who need to be opened to friends to view. Only the selected family members will be visible to the other's friends, otherwise they cannot be viewed;

Note: The main account opens data by default. If no data, it will not be displayed in friends list.

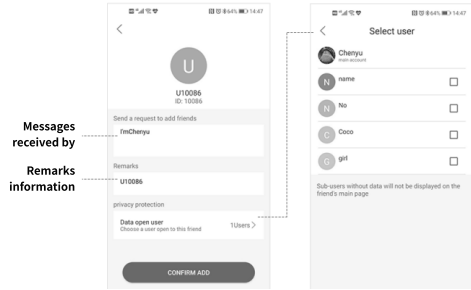

Messages  
received by

Remarks  
information

## Important explanation:

The measurement data of the supporting products in this manual is for reference only and cannot be used as medical advice!

## WARRANTY CARD

|                   |  |                |  |
|-------------------|--|----------------|--|
| Product name      |  | Product model  |  |
| Purchase date     |  | Buy the shop   |  |
| Dealer stamp      |  |                |  |
| Customer name     |  | Customer phone |  |
| Customer address  |  |                |  |
| Fault description |  |                |  |

The content of this information has been carefully checked. If there are any printing errors or misunderstandings in the content, the company reserves the right of final interpretation.

## FCC Statement

This device complies with part 15 of the FCC Rules. Operation is subject to the following two conditions: (1) This device may not cause harmful interference, and (2) this device must accept any interference received, including interference that may cause undesired operation.

This equipment has been tested and found to comply with the limits for a Class B digital device, pursuant to part 15 of the FCC Rules. These limits are designed to provide reasonable protection against harmful interference in a residential installation. This equipment generates, uses and can radiate radio frequency energy and, if not installed and used in accordance with the instructions, may cause harmful interference to radio communications. However, there is no guarantee that interference will not occur in a particular installation. If this equipment does cause harmful interference to radio or television reception, which can be determined by turning the equipment off and on, the user is encouraged to try to correct the interference by one or more of the following measures:

- Reorient or relocate the receiving antenna.
- Increase the separation between the equipment and receiver.
- Connect the equipment into an outlet on a circuit different from that to which the receiver is connected.
- Consult the dealer or an experienced radio/TV technician for help.

Caution: Any changes or modifications to this device not explicitly approved by manufacturer could void your authority to operate this equipment.

### RF Exposure Information

The device has been evaluated to meet general RF exposure requirement. The device can be used in portable exposure condition without restriction.