

witcaremed™ Smart Body Composition Analyzer

User manual

Model: BC-CA380

Thank you for choosing

witcaremed

Web: www.witcaremed.com

Packing list

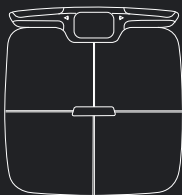

main unit



charging cable



user manual



greeting card

Content

01	Safety Guidelines	P.01
02	Functions	P.02
03	Display	P.04
04	Product Instructions	P.05
05	Specifications	P.07
06	Maintenance	P.08
07	Warranty	P.08

Safety Guidelines

Read all instructions before using the witcoremed smart body composition analyzer.



- Read all instructions carefully before using this product.
- For the convenience of product using and after sale service communication ,please keep this manual well.
- The appearance is different from the actual product,please refer to the actual product.
- This manual is subject to change without prior notice. We apologize for any inconvenience caused.

Warnings:

- Individuals with medical implant devices such as pacemakers,or essential support devices such as patient monitoring systems, must not use this equipment. Safe,low-level current will flow through the body during the test,which may cause malfunctioning of the device or endanger lives.
- We do not recommend pregnant women use the function of Bioelectrical impedance analysis (BIA)(Do not take the handle for testing)
- The body analyzer may become slippery in humid places.Please watch your steps and do not slip.

Caution:

- Put the body analyzer on a flat, hard and stable surface.
- Avoid contact with the examinee during testing.
- Stand upright for about 5 minutes before testing.Avoiding a slight change in the test result, take thetest immediately after lying in bed or sitting for a long time.
- Do not exercise before testing.Strenuous exercise or sharp movements can cause temporary changes in body composition.
- Take the test 2 hours before or after eating.
- Thoroughly wipe the palms and soles with the tissue before testing.
- Take the test in the morning to make sure the result is accurate
- Take the test at the same condition each day to maintain consistency.

Functions

This product uses TFT color screen display and high-precision sensor to measure weight, with automatic weighing function, using tempered glass ITO conductive film contact with the human body, can measure 51 body parameters. Tempered glass scale surface design, making the product safe and non-slip, beautiful and generous, suitable for family measurement of body weight and body composition.

- Support the measurement of small gadget.
- The product is not a medical analyzer, so the result can only be a reference

Measuring items

*App shows 51 items

	weight		left leg fat mass		skeletal muscle mass		BMI
	fat ratio		right leg fat mass		skeletal muscle ratio		health score
	left arm fat ratio		muscle ratio		skeletal muscle quality index		body age
	right arm fat ratio		muscle mass		minerals		waist-hip Ratio
	left leg fat ratio		left arm muscle mass		bone mass		visceral fat
	right leg fat ratio		right arm muscle mass		extracellular water		subcutaneous fat ratio
	fat mass		trunk muscle mass		intracellular water		adiposity level
	fat-free mass		left leg muscle mass		body cell mass		adiposity class
	left arm fat mass		right leg muscle mass		subcutaneous fat mass		BMR
	right arm fat mass		water ratio		body type		standard weight
	trunk fat mass		protein ratio		recommended Calorie intake		weight control
	trunk fat ratio		total body water		heart rate		fat control
	protein mass		health evaluation		muscle control		

*screen shows the 10th item

	heart rate		target weight		body age		segmental muscle mass
	weight		BMI		water ratio		segmental fat mass
	weight tendency				fat ratio		

FCC regulatory conformance:

This device complies with Part 15 of the FCC Rules. Operation is subject to the following two conditions:

- (1) This device may not cause harmful interference.
- (2) This device must accept any interference received, including interference that may cause undesired operation.

NOTE: This equipment has been tested and found to comply with the limits for a Class B digital device, pursuant to part 15 of the FCC Rules. These limits are designed to provide reasonable protection against harmful interference in a residential installation.

This equipment generates uses and can radiate radio frequency energy and, if not installed and used in accordance with the instructions, may cause harmful interference to radio communications. However, there is no guarantee that interference will not occur in a particular installation. If this equipment does cause harmful interference to radio or television reception, which can be determined by turning the equipment off and on, the user is encouraged to try to correct the interference by one or more of the following measures:

- Reorient or relocate the receiving antenna.
- Increase the separation between the equipment and receiver.
- Connect the equipment into an outlet on a circuit different from that to which the receiver is connected.
- Consult the dealer or an experienced radio/TV technician for help

NOTE: The manufacturer is not responsible for any radio or TV interference caused by unauthorized modifications to this equipment. Such modifications could void the user's authority to operate the equipment.

RF Exposure

This equipment complies with FCC radiation exposure limits set forth for an uncontrolled environment.

Screen indication

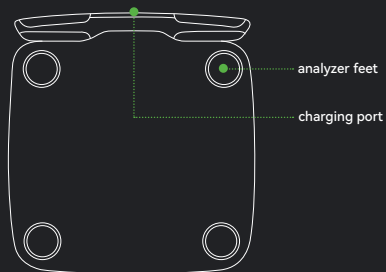
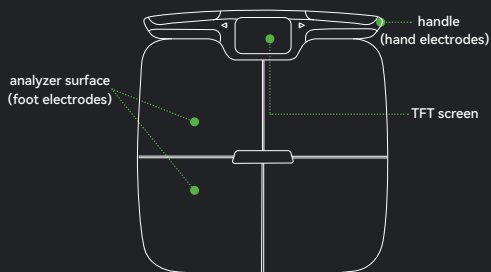
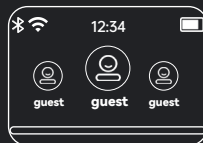
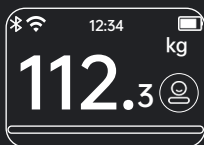

Instructions

1.Download,install,register App

- iOS system,please search "Unique Health" in App store, or you can scan the following QR code to download,install and register the App.
- Android/HarmonyOS system, please search for "Unique Health" in the application store, or you can scan the QR code to download, install and register the App.



App Store



Android

2.Pair the smart body composition analyzer to the App

Turn on the Bluetooth of the mobile phone, launch the Unique Health App,and complete the pairing of the smart body composition analyzer according to the prompts.

3.Measurement guidelines

- 1) Place the smart body composition analyzer on a flat and hard ground, lightly step on the scale with bare feet, and wait for the screen to light up.



2) Open the Unique Health App and click Add Device - Search Device - Device Binding - Configure Network - Connection successful.

*Note: Weighing with shoes only provides weight measurement and does not assess body fat ratio or heart rate.

*Note: Unbind, forcibly unbind, and restore factory Settings. keep pressing the left and right keys of the handle for more than 10 seconds to restore factory Settings.



1.Add device



2.Device pairing

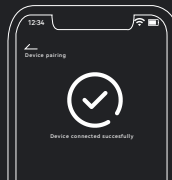

3.Pairing successfully



4.Network configuration

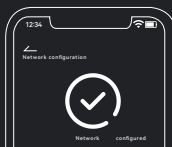

5.Network configured successfully

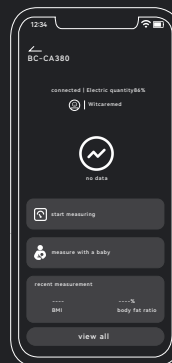

6.Connected successfully

Specification

Product name	Smart Body Composition Analyzer
Model	BA-CA380,BC-CA680,BC-CA980
Electrodes	8-electrode
Ooutput	weight, fat ratio, left arm fat ratio, right arm fat ratio, left leg fat ratio, right leg fat ratio, fat mass, fat free mass, left arm fat mass, right arm fat mass, body fat mass, percent body fat, protein mass, left leg muscle mass, right leg muscle mass, muscle ratio, muscle mass, left arm muscle mass, right arm muscle mass, trunk muscle mass, left leg muscle mass, right leg muscle mass, total body water, protein ratio, total body water, health evaluation, skeletal muscle mass, skeletal muscle ratio, skeletal muscle quality index, minerals, bone mass, extracellular water, intracellular water, body cell mass, Subcutaneous fat ratio, body type, recommended calorie intake, heart rate, muscle control, BMI, health score, body age, waist hip ratio, visceral fat, subcutaneous fat ratio, adiposity level, adiposity class, BMR, standard weight, weight control, fat control
Measuring method	Tempered glass ITO conductive film contact human body
Rated working voltage	DC3.7V (li-battery)
Blue tooth version	blue tooth 5.1 low power consumption
Display type	3.5" tft screen, 320xRGB powex480
Size	375*352*35mm
Lowbattery warning	The voltage is lower than 3.5V±0.2V, showing low power UI, indicating that the battery is inefficient, and the device should be charged as soon as possible
Li-battery capacity	800mAh
Charging	Type-C
Weighing range	0.1kg-180kg
Storage environment	Operating temperature range: 5-40°C Operating humidity range: ≤90%RH Storage temperature: -20°C-50°C
Automatic shutdown time	Fat measurement, weight locking, zero, no operation 10s off

Maintenance



- Attention! Do not stretch the handle beyond its limit.
- Do not place any other items on this device.
- Do not use this device violently.
- Do not allow any liquid substance to come into direct contact with the device.
- Please keep the equipment properly to avoid falling from high places.
- If you do not use the device for a long time, you are advised to charge the device periodically.
- To avoid damage to the force measuring part, please keep the equipment on a horizontal and hard place, do not make the equipment work in a sudden change of temperature environment and weighing the maximum weight do not exceed 150% of the rated range during the measuring process.

***If you have problems operating this device, please contact our customer service team.**

***We are not responsible for any problems caused by self-maintenance.**

Warranty description



Thank you for purchasing Witcaremed smart body composition analyzer. This product is guaranteed for one year from the date of purchase. If you encounter any problems, please contact us with details of your problem.

After-service Hotline: 86-755 27742781

Please read the product manual carefully and strictly follow the instructions in the product manual.

This warranty does not cover damage to the product due to normal wear, scratches, improper use, failure to follow instructions in the product manual, or use for commercial purposes.

Version 1.0



EU regulatory conformance:

RF exposure information: The EIRP power of the device at maximal case is below the exempt condition, 20mW specified in EN62479: 2010. RF exposure assessment has been performed to prove that this unit will not generate the harmful EM emission above the reference level as specified in EC Council Recommendation(1999/519/EC).

CE DOC

Hereby, Shenzhen Witcaremed Medical Technology Co., Ltd declares that the radio equipment type BC-CA380 is in compliance with Directive 2014/53/EU. The full text of the EU declaration of conformity is available at the following internet address:
www.witcaremed.com

Manufacturer information:

Shenzhen Witcaremed Medical Technology Co., Ltd
1301, Building 3, Phase 2, Yinxing Zhijie, No. 1301-80 Guanguang Road, Xinlan Community, Guanlan Street, Longhua District, Shenzhen

Operation frequency(Max power)

Bluetooth: 2402-2480 (0dBm)

Wifi:2412MHz-2472MHz(16dBm)

Web:www.witcaremed.com

Email:service@witcaremed.com

Brand Owner: Shenzhen Witcaremed Medical Technology Co.,Ltd

Add: 1301, Building 3, Phase 2,Yinxing Zhijie,No. 1301-80 Guanguang Road,