

MINEE TIMER 4

Safety Rules & Warranty Certificates

Read this guide before you set you set up and use your product.



< Direct Support Channel >



General Guidelines for Battery Usage

Please charge the battery following the instructions provided in the user manual. Do not attempt to open, disassemble, or repair the battery. Avoid subjecting the battery to impacts or puncturing it. Do not dispose of the product/battery in fire. This could lead to an explosion.

Battery Disposal

As this product includes electronic equipment with a battery, it must be disposed of separately from regular household waste when its lifespan ends. Do not dispose of the battery by landfilling. Follow the legal regulations of your jurisdiction, as disposal guidelines may vary by region.

Product Warranty Coverage

Melike Co., Ltd. guarantees that the minee timer 4 is free of material and workmanship defects under normal usage conditions for the original purchaser during the warranty period. The warranty period for the product is maintained for **one year** from the date of purchase, as indicated on the sales receipt or invoice. This quality guarantee may vary depending on the country or region where the product was purchased. The warranty applies only to devices purchased for your use and does not apply to machines purchased for resale. Melike does not guarantee that the device will operate without interruption or error and does not assure correction of all defects. Accessories, supplementary parts, consumables, and batteries are not covered under warranty as they are considered consumables.

How to Obtain Warranty Service

To receive warranty service, the following steps must be followed: Contact the designated inquiry point, provide the required information, and follow the procedure. Once the inquiry is confirmed, deliver the product using the original packaging or packaging that provides an equivalent level of protection to the address specified by Melike. It is your responsibility to back up any data, software, or other materials you may have stored or preserved on the product. Melike is not responsible for any data loss that occurs during the warranty service.

Contact Information : Email Inquiry : cs@melike.company

Precautions During Use

Keep away from fire or sources of ignition. Avoid storing or using the battery in high-temperature environments. Do not subject the battery to abnormal shocks, such as dropping it from heights. Ensure the battery is not exposed to moisture.

Cases Where Warranty Does Not Apply

If the product operates without interruption or error. Loss or damage of customer data. Damage or malfunction due to abuse, misuse, accidents, modifications, unsuitable physical or operating environments, natural disasters, overload, or failure to follow the product instructions.

Front

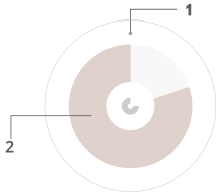

Back

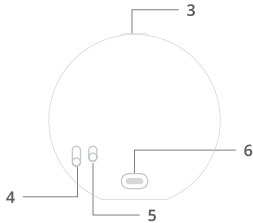

Top

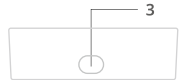

Name and function

1. LED indicator
2. Front screen
3. Top button
4. Volume control switch
5. Power switch
6. USB-C port



LED indicator / LED 표시등 / 作動表示 / 啓動標誌	Color
Power on / 전원 on / 電源on / 打開電源	
Start / 시작 / スタート / 開始	
Pause / 일시정지 / 一時停止 / 臨時停車	
End of the session / 세션 종료 / セッション終了 / 結束會話	 X 5
Breaktime / 휴식 시간 / 休憩時間 / 休息時間	
Shortage of electricity / 전력 부족 / 電力不足 / 電力不足	 X 3
Charging / 충전 중 / 充電中 / 充電中	
Reset / 리셋 / リセット / 復位	
Initialization / 초기화 / 初期化 / 初始化	

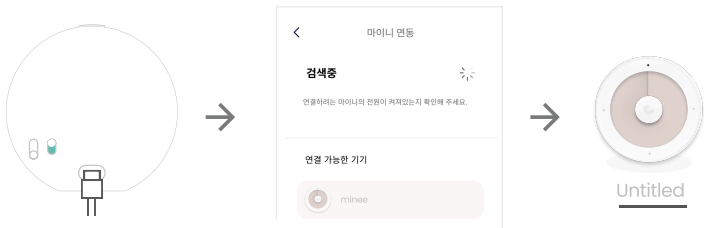

How to set up the first

1. After charging with the USB-C cable, turn on the power of the mine timer.
2. Search for 'minee' in the App Store, Google Play, download the  application, and log in.
3. After linking the machine in the App, write a timer name.



The General FCC Requirements in Labeling and Instruction Manual for Part 15 Devices Subject to Supplier's Declaration of Conformity

This device complies with part 15 of the FCC Rules. Operation is subject to the following two conditions: (1) This device may not cause harmful interference, and (2) this device must accept any interference received, including interference that may cause undesired operation.

The users manual or instruction manual for an intentional or unintentional radiator shall caution the user that changes or modifications not expressly approved by the party responsible for compliance could void the user's authority to operate the equipment.

Note: This equipment has been tested and found to comply with the limits for a Class B digital

NOTE: This equipment has been tested and found to comply with the limits for a Class B digital device, pursuant to part 15 of the FCC Rules. These limits are designed to provide reasonable protection against harmful interference in a residential installation. This equipment generates, uses and can radiate radio frequency energy and, if not installed and used in accordance with the instructions, may cause harmful interference to radio communications. However, there is no guarantee that interference will not occur in a particular installation. If this equipment does cause harmful interference to radio or television reception, which can be determined by turning the equipment off and on, the user is encouraged to try to correct the interference by one or more of the following measures:

- Reorient or relocate the receiving antenna.
- Increase the separation between the equipment and receiver.
- Connect the equipment into an outlet on a circuit different from that to which the receiver is connected.
- Consult the dealer or an experienced radio/TV technician for help