

FLAMING SKOUL

IMMERSE YOURSELF

N70C | ACTIVE
NOISE CANCELLATION
WIRELESS HEADPHONES

USER MANUAL

FIRST TIME SETUP: BLUETOOTH PAIRING

- 1 Turn on the Bluetooth in your device settings.

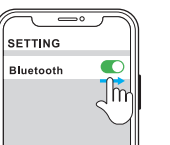

- 2 Press and hold button for 5 seconds. Release. Lights will flash blue/red.

- 3 Select "Flaming Skull N70C" in your device Setting to connect.

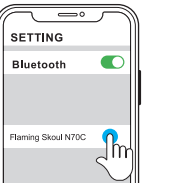

Once successfully connected, the headphone will memorize your device and automatically pair when turned on in the future.

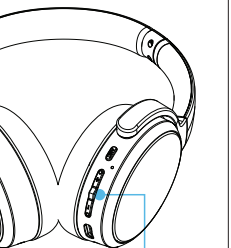

Power on 3S,
Pairing 5S.

BUTTON FUNCTIONS

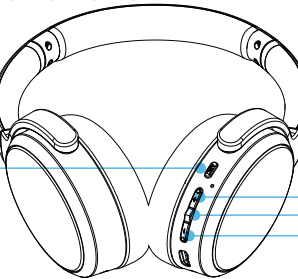

Connected To Bluetooth: Press Once to Cycle Transparency / ANC On / ANC Off.
Press Twice to Active "Spatial Audio"
Press Triple to Active "Children Mode"

Volume Down: Press Once

Track Backward: Press & Hold 1+ Seconds

Power On / Off: Press & Hold 3+ Seconds

Play / Pause / Answer / Hang Up Calls: Press Once

Reject Incoming Call: Press & Hold 1 Second

Activate Siri (iOS) Or "Ok Google" (Android): Press Twice

Bluetooth Pairing: See First Time Setup

Low latency Gaming mode: Press Triple

Volume Up: Press Once

Track Forward: Press & Hold 1+ Seconds

CHARGING

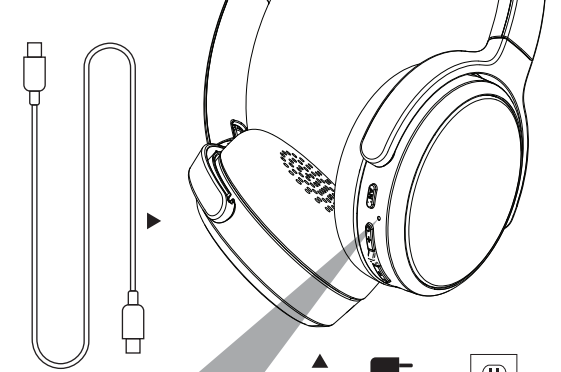

CHARGING CABLE

Red light when charging, off when fully charged.

White light when Noise Canceling / Transparency mode is on.

Connect to computer or USB 5V 1A (or less) output device.

Audio INPUT

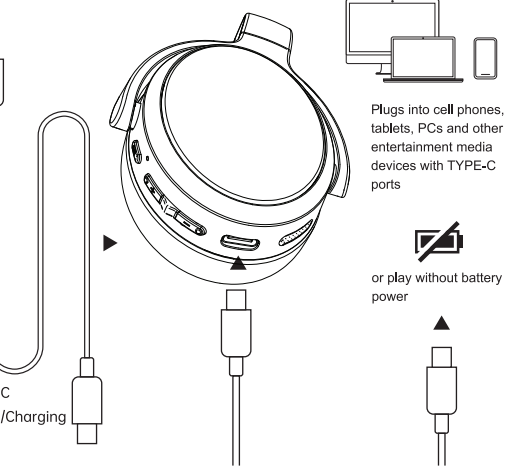

TYPE-C
Audio/Charging
Cable

NOTE :

- The TYPE-C INPUT will override your Bluetooth device connection. Unplug and press power button 3 + seconds to revert back to Bluetooth.
- Answer/hang up/reject of the button will not work when the audio input is connected.
- The volume will be dependent on your TYPE-C device settings, Adjust accordingly.

Audio INPUT

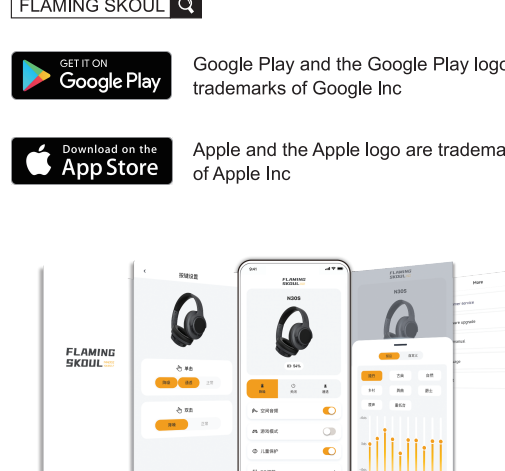

TYPE-C
Audio/Charging
Cable

NOTE :

- The TYPE-C INPUT will override your Bluetooth device connection. Unplug and press power button 3 + seconds to revert back to Bluetooth.
- Answer/hang up/reject of the button will not work when the audio input is connected.
- The volume will be dependent on your TYPE-C device settings, Adjust accordingly.

Audio INPUT

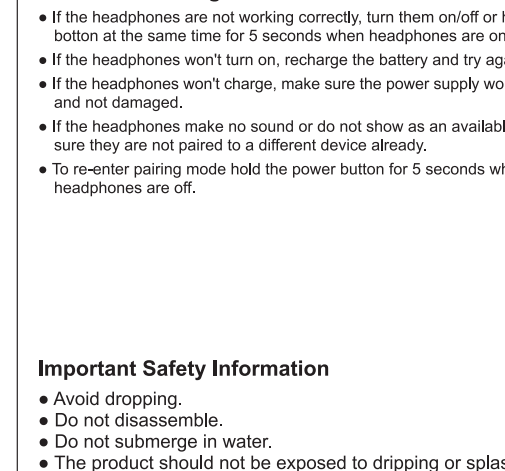

TYPE-C
Audio/Charging
Cable

NOTE :

- The TYPE-C INPUT will override your Bluetooth device connection. Unplug and press power button 3 + seconds to revert back to Bluetooth.
- Answer/hang up/reject of the button will not work when the audio input is connected.
- The volume will be dependent on your TYPE-C device settings, Adjust accordingly.

Audio INPUT

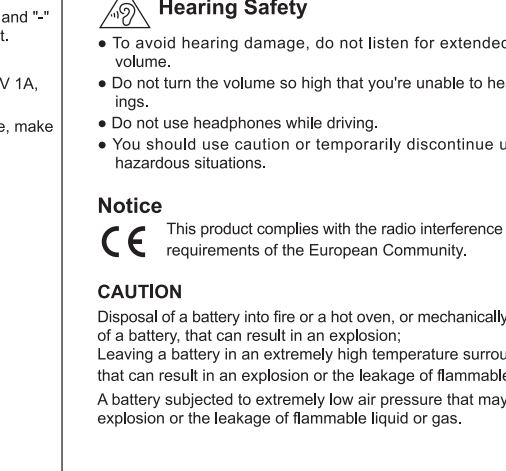

TYPE-C
Audio/Charging
Cable

NOTE :

- The TYPE-C INPUT will override your Bluetooth device connection. Unplug and press power button 3 + seconds to revert back to Bluetooth.
- Answer/hang up/reject of the button will not work when the audio input is connected.
- The volume will be dependent on your TYPE-C device settings, Adjust accordingly.

Audio INPUT

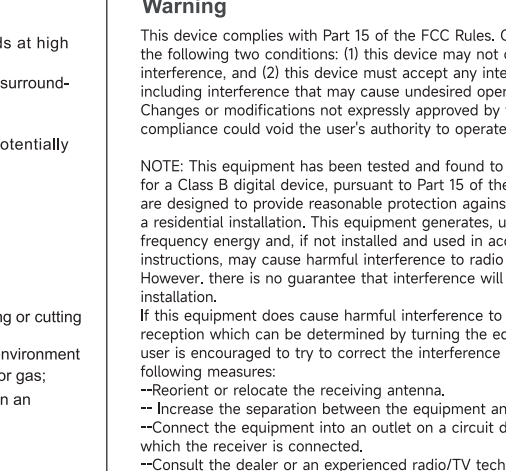

TYPE-C
Audio/Charging
Cable

NOTE :

- The TYPE-C INPUT will override your Bluetooth device connection. Unplug and press power button 3 + seconds to revert back to Bluetooth.
- Answer/hang up/reject of the button will not work when the audio input is connected.
- The volume will be dependent on your TYPE-C device settings, Adjust accordingly.

Audio INPUT

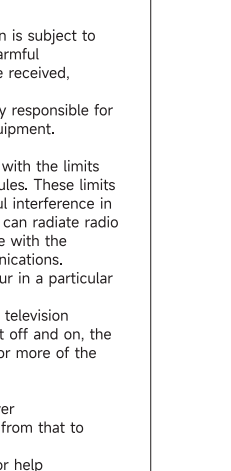

TYPE-C
Audio/Charging
Cable

NOTE :

- The TYPE-C INPUT will override your Bluetooth device connection. Unplug and press power button 3 + seconds to revert back to Bluetooth.
- Answer/hang up/reject of the button will not work when the audio input is connected.
- The volume will be dependent on your TYPE-C device settings, Adjust accordingly.

Troubleshooting

- If the headphones are not working correctly, turn them on/off or hold "+" and "-" button at the same time for 5 seconds when headphones are on to reset.
- If the headphones won't turn on, recharge the battery and try again.
- If the headphones won't charge, make sure the power supply works, is 5V 1A, and not damaged.
- If the headphones make no sound or do not show as an available device, make sure they are not paired to a different device already.
- To re-enter pairing mode hold the power button for 5 seconds when headphones are off.

Troubleshooting

- If the headphones are not working correctly, turn them on/off or hold "+" and "-" button at the same time for 5 seconds when headphones are on to reset.
- If the headphones won't turn on, recharge the battery and try again.
- If the headphones won't charge, make sure the power supply works, is 5V 1A, and not damaged.
- If the headphones make no sound or do not show as an available device, make sure they are not paired to a different device already.
- To re-enter pairing mode hold the power button for 5 seconds when headphones are off.

Troubleshooting

- If the headphones are not working correctly, turn them on/off or hold "+" and "-" button at the same time for 5 seconds when headphones are on to reset.
- If the headphones won't turn on, recharge the battery and try again.
- If the headphones won't charge, make sure the power supply works, is 5V 1A, and not damaged.
- If the headphones make no sound or do not show as an available device, make sure they are not paired to a different device already.
- To re-enter pairing mode hold the power button for 5 seconds when headphones are off.

Troubleshooting

- If the headphones are not working correctly, turn them on/off or hold "+" and "-" button at the same time for 5 seconds when headphones are on to reset.
- If the headphones won't turn on, recharge the battery and try again.
- If the headphones won't charge, make sure the power supply works, is 5V 1A, and not damaged.
- If the headphones make no sound or do not show as an available device, make sure they are not paired to a different device already.
- To re-enter pairing mode hold the power button for 5 seconds when headphones are off.

Important Safety Information

- Avoid dropping.
- Do not disassemble.
- Do not submerge in water.
- The product should not be exposed to dripping or splashing.
- Avoid extreme temperatures.
- The product should not be exposed to excessive heat such as sunshine, fire or the like.
- Use original or certified cables.
- Clean with a dry, soft lint-free cloth. Do not use any corrosive cleaner or oil.
- Do not use the product outdoors during thunderstorms.

Important Safety Information

- Avoid dropping.
- Do not disassemble.
- Do not submerge in water.
- The product should not be exposed to dripping or splashing.
- Avoid extreme temperatures.
- The product should not be exposed to excessive heat such as sunshine, fire or the like.
- Use original or certified cables.
- Clean with a dry, soft lint-free cloth. Do not use any corrosive cleaner or oil.
- Do not use the product outdoors during thunderstorms.

Important Safety Information

- Avoid dropping.
- Do not disassemble.
- Do not submerge in water.
- The product should not be exposed to dripping or splashing.
- Avoid extreme temperatures.
- The product should not be exposed to excessive heat such as sunshine, fire or the like.
- Use original or certified cables.
- Clean with a dry, soft lint-free cloth. Do not use any corrosive cleaner or oil.
- Do not use the product outdoors during thunderstorms.

Important Safety Information

- Avoid dropping.
- Do not disassemble.
- Do not submerge in water.
- The product should not be exposed to dripping or splashing.
- Avoid extreme temperatures.
- The product should not be exposed to excessive heat such as sunshine, fire or the like.
- Use original or certified cables.
- Clean with a dry, soft lint-free cloth. Do not use any corrosive cleaner or oil.
- Do not use the product outdoors during thunderstorms.

Hearing Safety

- To avoid hearing damage, do not listen for extended periods at high volume.
- Do not turn the volume so high that you're unable to hear your surroundings.
- Do not use headphones while driving.
- You should use caution or temporarily discontinue use in potentially hazardous situations.

Notice

This product complies with the radio interference requirements of the European Community.

CAUTION

Disposal of a battery into fire or a hot oven, or mechanically crushing or cutting of a battery, that can result in an explosion;
Leaving a battery in an extremely high temperature surrounding environment that can result in an explosion or the leakage of flammable liquid or gas;
A battery subjected to extremely low air pressure that may result in an explosion or the leakage of flammable liquid or gas.



This symbol means the product must not be discarded as household waste, and should be delivered to an appropriate collection facility for recycling. Follow local rules and never dispose of the product and rechargeable batteries with normal household waste. Correct disposal of old products and rechargeable batteries helps prevent negative consequences for the environment and human health.

Warning

This device complies with Part 15 of the FCC Rules. Operation is subject to the following two conditions: (1) this device may not cause harmful interference, and (2) this device must accept any interference received, including interference that may cause undesired operation. Changes or modifications not expressly approved by the party responsible for compliance could void the user's authority to operate the equipment.

NOTE: This equipment has been tested and found to comply with the limits for a Class B digital device, pursuant to Part 15 of the FCC Rules. These limits are designed to provide reasonable protection against harmful interference in a residential installation. This equipment generates, uses and can radiate radio frequency energy and, if not installed and used in accordance with the instructions, may cause harmful interference to radio communications. However, there is no guarantee that interference will not occur in a particular installation.

If this equipment does cause harmful interference to radio or television reception which can be determined by turning the equipment off and on, the user is encouraged to try to correct the interference by one or more of the following measures:
--Reorient or relocate the receiving antenna.
-- Increase the separation between the equipment and receiver
--Connect the equipment into an outlet on a circuit different from that to which the receiver is connected.
--Consult the dealer or an experienced radio/TV technician for help
NOTE: This device and its antenna(s) must not be co-located or operation in conjunction with any other antenna or transmitter

The device has been evaluated to meet general RF exposure requirement. The device can be used in portable exposure condition without restriction.