

PORTABLE PROJECTOR
USER'S GUIDE
用户说明书
Android OS

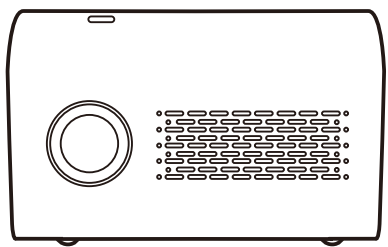

HD

| Specifications

Image unit	TFT LCD	Color	16.7M
Native resolution	480*360	Support resolution	1920*1080
Lamp	LED	Lamp life	>20000 hours
Power consumption	30W(max)	Power supply	15V-2A
Lens	coated lens	Operation mode	Manual/Remote
Projection distance	60-330cm	Projection size	16-100inches
Size(mm)	150*85*81mm	Net weight	0.34kg
Aspect ratio	16:9/4:3	Speaker	402W
Interface	USB/AUX		

| Support format

Files	Format	Suffix	Decoding
Music	Mpeg	mp3	
	WMA	mp4	
	JPEG	jpg	
Picture	BMP	.bmp	
	TIF	.tif	
	MPEG	.mpg	
Video	MPEG1	DATA,MPEG,MPEG	
	MPEG2	MPG	
	MPEG4	AVI,MP4	DivX,XVID
	RM,WMVB	RM,WMVB	RVB,RPV,RV10
	H264	MP4,MOV	H264
	MPEG	AVI	
	DivX	DivX,AVI	MPEG2,DivX,H264
	FLV	FLV	H264
	TXT		

| PARTS AND FUNCTIONS OF PROJECTOR

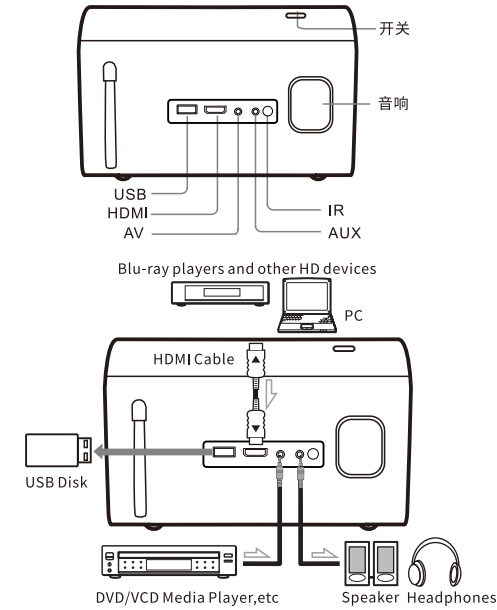

| Remote control

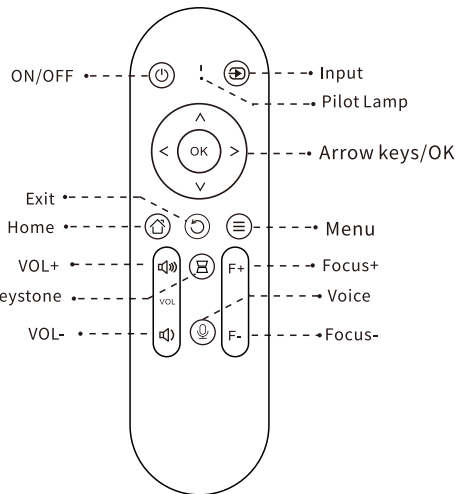

| Projection distance and size

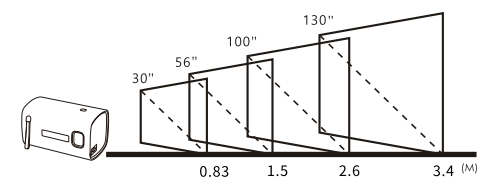

Remarks: The display size is for reference only, there are more projection sizes for you choosing, it depends on your needs.

| Installation and commissioning

1. Power On/Power Off

Plug in the AC power cord, after the projector is powered on, click the power button on the operation panel of the machine or on the remote control, the power indicator flashes 3s quickly and the projector starts to work.

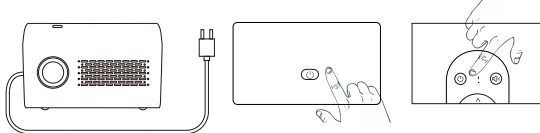

| Installation and commissioning

2. Connect to a wireless network

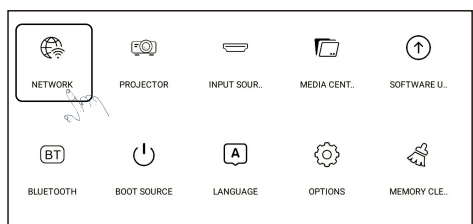

- Click the settings icon on the homepage to enter the option settings, select "WIFI", and click "OK" to confirm.

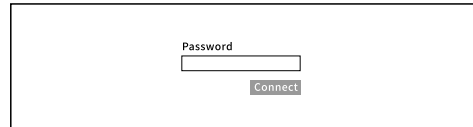

- Press the OK button to turn on the WiFi switch, the network list appears after searching for the network, select the wireless network that needs to be connected and press the OK button to confirm, enter the network password interface.
- Click the connect button after entering the password.

| Installation and commissioning

3. Bluetooth Settings

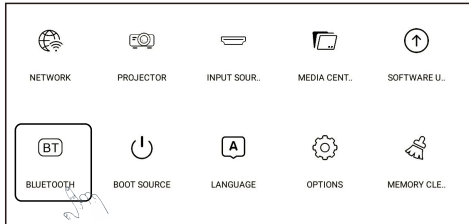

- Click the settings icon on the homepage to enter the Bluetooth settings, select "Bluetooth".
- Turn on Bluetooth and select the Bluetooth signal that needs to be connected.

| Android system operating steps

1. Bluetooth Speaker Mode

Click "APPS" on the homepage and select "Bluetooth Sound" Settings. The interface displays the Bluetooth speaker mode and enters the waiting pairing mode at this moment. You can connect to the projector through Bluetooth settings such as the mobile phone to play music, and press the return button to exit the Bluetooth speaker mode, and the machine enters the projection mode.

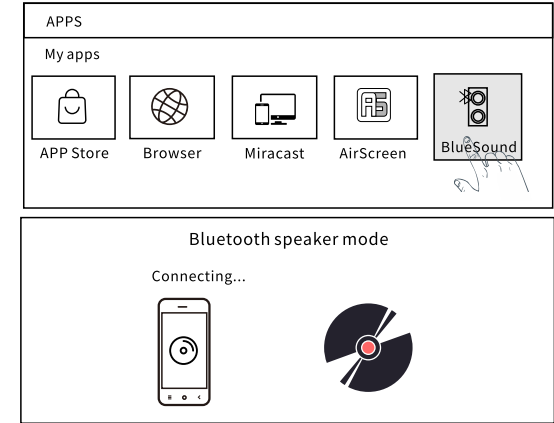

| Android system operating steps

2. Wireless same screen iPhone

-1: Enter "Miracast" in the "APPS" interface.

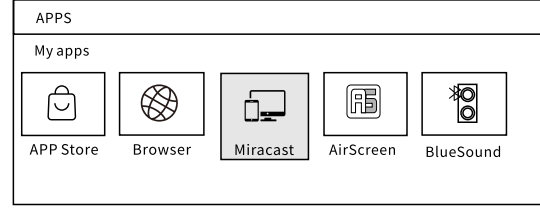

- 2: Mobile phone operation: Use iPhone to draw up from the bottom, call up the menu, and select "ScreenMirroring" to enter.
- 3: Check the device on the same screen, and complete on the same screen.

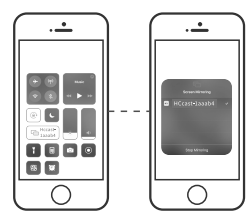

| Android system operating steps

3. Wireless same screen Android phone

-1: Enter "Miracast" in the "APPS" interface.

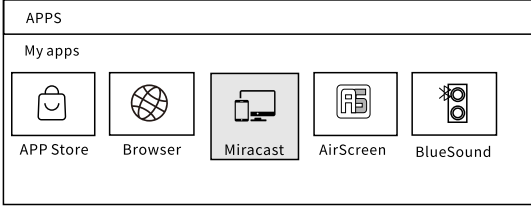

- 2: Mobile phone operation: Enter the mobile phone settings and click "Mobile network".
- 3: Select "Wireless projection", and click the name of the projector at the bottom of the phone to complete the connection.
- 4: Open the android mobile video APP and select "ip", Complete the same screen function.

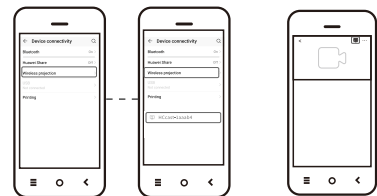

This device complies with part 15 of the FCC Rules. Operation is subject to the following two conditions: (1) This device may not cause harmful interference, and (2) this device must accept any interference received, including interference that may cause undesired operation.

Any Changes or modifications not expressly approved by the party responsible for compliance could void the user's authority to operate the equipment.

Note: This equipment has been tested and found to comply with the limits for a Class B digital device, pursuant to part 15 of the FCC Rules. These limits are designed to provide reasonable protection against harmful interference in a residential installation. This equipment generates uses and can radiate radio frequency energy and, if not installed and used in accordance with the instructions, may cause harmful interference to radio communications. However, there is no guarantee that interference will not occur in a particular installation. If this equipment does cause harmful interference to radio or television reception, which can be determined by turning the equipment off and on, the user is encouraged to try to correct the interference by one or more of the following measures:

- Reorient or relocate the receiving antenna.
- Increase the separation between the equipment and receiver.
- Connect the equipment into an outlet on a circuit different from that to which the receiver is connected.
- Consult the dealer or an experienced radio/TV technician for help.
- This equipment complies with FCC radiation exposure limits set forth for an uncontrolled environment. This equipment should be installed and operated with minimum distance 20cm between the radiator & your body.