

ATKGEAR.COM

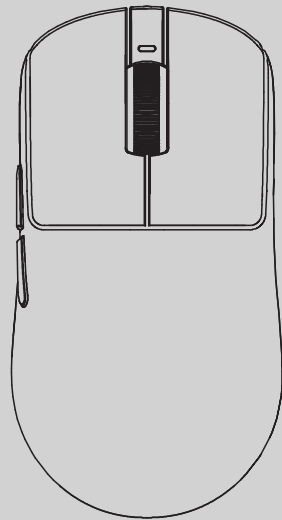

VX≡ Studio

VX≡

VX≡ R1 SERIES
SMART SPEED WIRELESS

折后反面

折后正面

尺寸：320x280mm

纵向三折/横向对折

01 按键和配件说明 / Introduction / 紹介 / 소개

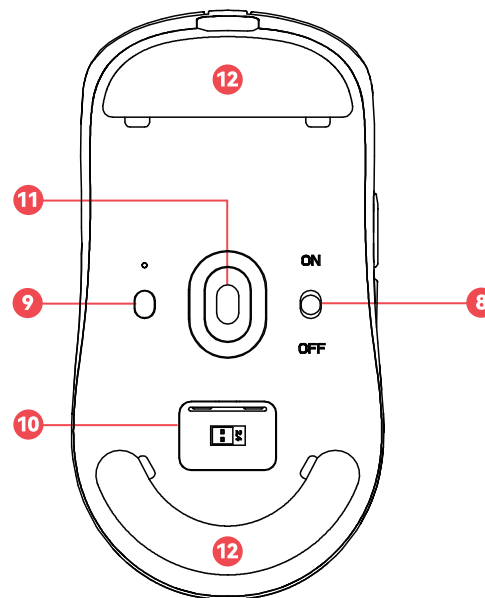
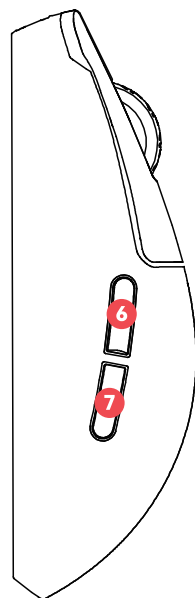
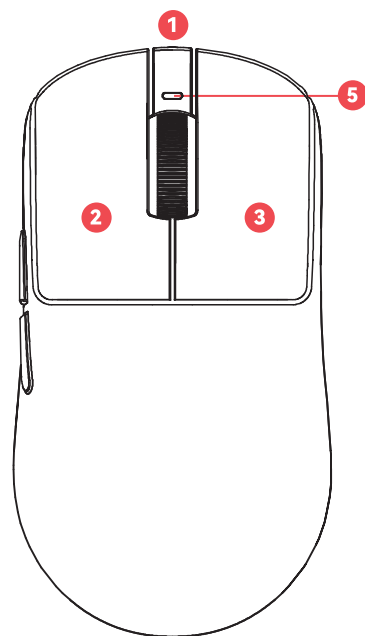

- 1 Type-C口 / Type-C Port / Type-C インタフェース / Type-C 인터페이스
- 2 鼠标左键 / Left Mouse Button / マウスの左ボタン / 마우스 왼쪽 버튼
- 3 鼠标右键 / Right Mouse Button / マウスの右ボタン / 마우스 오른쪽 버튼
- 4 滚轮 / Scroll Wheel / マウスホイール / 마우스 휠
- 5 LED指示灯 / LED Indicator / LEDインジケータ / LED 표시등

- 6 前进侧键 / Forward Button / 前進側キー / 전진 측면 키
- 7 后退侧键 / Back Button / 後退側キー / 뒤로 측면 키

- 8 无线开关 / Power Switch / 電源スイッチ / 전원 스위치
- 9 DPI切换键 / DPI Button / DPIボタン / DPI 버튼
- 10 接收器收纳仓 / Receiver Storage Slot / 레シーバ収納ボックス / 수신기 수납창고
- 11 光学传感器 / Optical Sensor / 光センサ / 광학 센서
- 12 脚贴区 / Feet / フィート / 피트

*鼠标底壳存在新旧版本，具体以实物为准 / The mouse bottom housing may have new and old versions; please refer to the actual product for confirmation. / 마우스의底部カバーには新旧バージョンが存在する可能性がありますので、実際の製品をご確認ください / 마우스 하우징에는 신규 및 기존 버전이 있을 수 있으니 실제 제품을 기준으로 확인해 주시기 바랍니다.

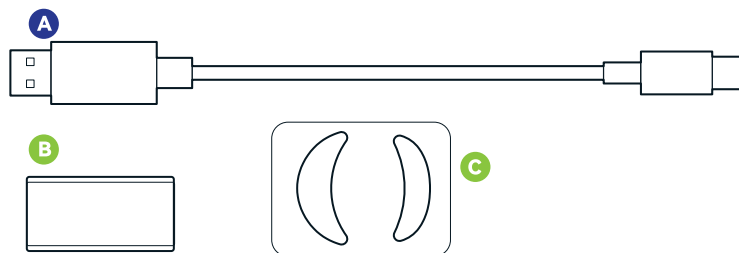

- A 数据线 / Cable / 데이터線 / 데이터 케이블
- B 接收延长器 / Extender / 익스텐더 / 확장기
- C 鼠标脚贴 / Mouse Feet / 마우스의足 / 마우스발
- 部分版本额外赠送：B、C (以实际收到为准)
Some versions come with additional gifts of B and C
幾つかのバージョンにはギフトBまたはギフトCが付いてきます
일부 버전 추가 제공:B、C



微信扫码关注
了解更多资讯

Scan the QR code on wechat
for more information

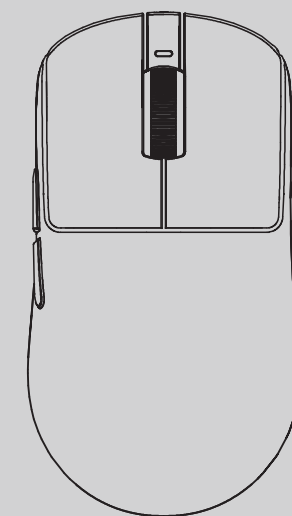

VXE Studio

VXE

VXE R1 SERIES
SMART SPEED WIRELESS

02 快速开始 / Quick Start / クイックスタート / 빠른 시작

1 充电/有线使用 | Charge / Wired Mode | 충전/유선 모드

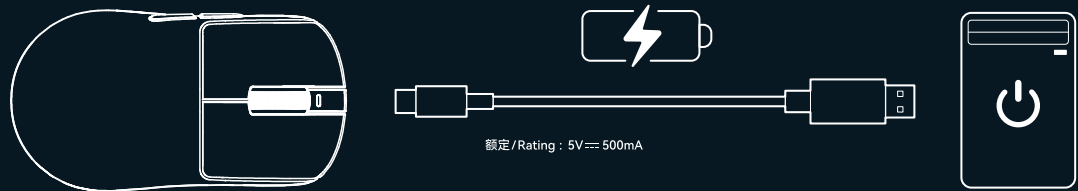

2-1 无线使用 / Wireless Mode / ワイヤレスモード / 무선 모드



2-2 无线使用 / Wireless Mode / ワイヤレスモード / 무선 모드

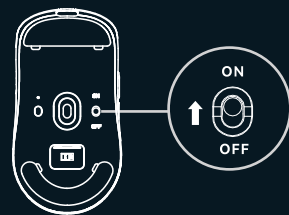

03 蓝牙重新配对 / Bluetooth pairing / Bluetoothペアコード / Bluetooth 코드

长按左中右三键直到指示灯闪烁，进入蓝牙配对模式 / Press and hold the left, middle, and right buttons until the indicator light flashes to enter Bluetooth pairing mode / LED가点滅するまで左中右三ボタンを長押しし、Bluetoothペアモードに入る / 표시등이 깜박일 때까지 좌중우 3키를 길게 눌러 Bluetooth 페어링 모드로 이동

驱动下载 / Software Download /
ソフトウェアのダウンロード / 소프트웨어 다운로드
VXE.COM

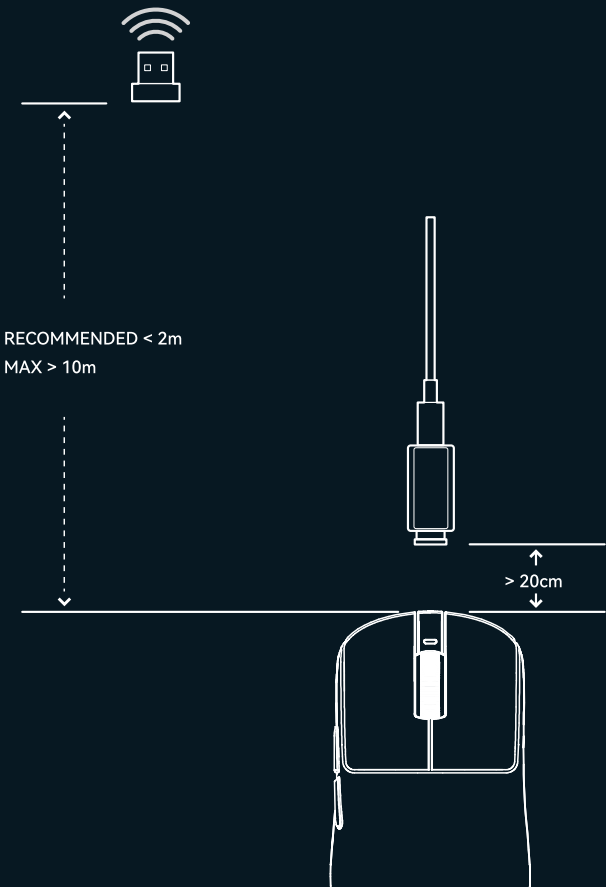

04 DPI调节 / DPI Set / DPI設定 / DPI 튜닝

按底部DPI切换键可以快速切换DPI，免驱提供以下DPI档位和状态指示 / Press the DPI button to quickly switch the DPI. The free drive provides the following DPI set and status indications / DPIボタンを押すと、DPIをすばやく切り替えることができます。無償ドライブには、以下のDPI設定とステータスインジケータが用意されています / DPI 버튼을 눌러 DPI를 빠르게 전환합니다. 무료 드라이브는 다음과 같은 DPI 설정 및 상태 지침을 제공합니다

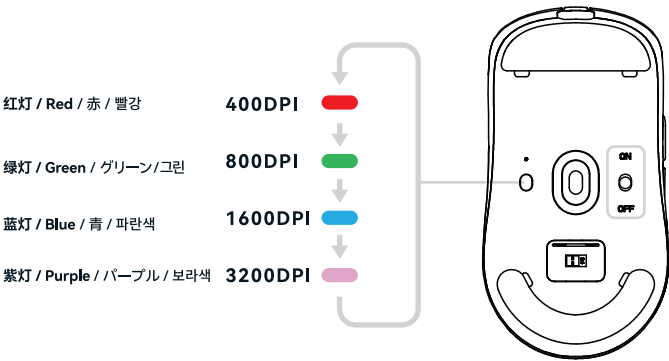

更多DPI设置需要使用驱动修改，支持50~26000DPI之间的设置 / The DPI can be set between 50 to 26000 DPI by software. / DPIは、ソフトウェアを介して50~26000 DPIの間に設定することができます / DPI는 소프트웨어를 통해 50에서 26000 DPI 사이를 설정할 수 있습니다

05 回报率设置 / Polling Rate Set / 폴링레이트設定 / 주파수 설정

可通过驱动直接修改回报率 / Set the rate by software / 소프트웨어を使用して速度を設定します / 소프트웨어를 통해 속도를 설정합니다

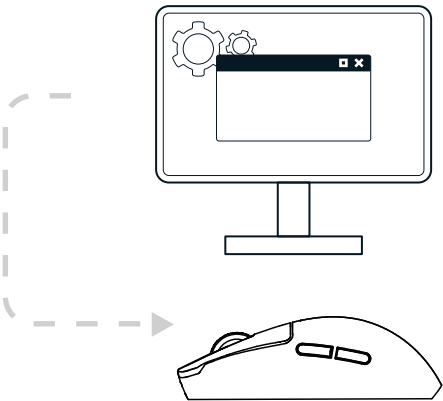

06 电量状态指示 / Battery Indication / 電力量状態指示 / 전력 상태 표시

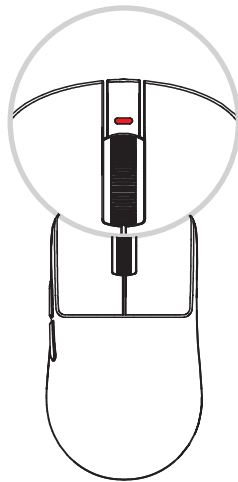

- 指示灯红灯闪烁：电量小于10%，请充电
Blinking In Red: 10%Battery, please charge
赤色点滅: 10%バッテリー、充電してください
빨간색 깜박임: 10% 배터리 충전
- 指示灯黄灯闪烁：充电中
Blinking In Yellow: Charging
黄色点滅: 充電
노란색 깜박임: 충전
- 指示灯常亮：充电完成，恢复至绿色
Staying in Green: Charging completed
緑のまま: 充電完了
녹색 유지: 충전 완료



Removal Instruction for Battery Recycling

FCC Caution.

This device complies with part 15 of the FCC Rules. Operation is subject to the following two conditions:

- (1) This device may not cause harmful interference, and
- (2) this device must accept any interference received, including interference that may cause undesired operation.

Any Changes or modifications not expressly approved by the party responsible for compliance could void the user's authority to operate the equipment.

Note: This equipment has been tested and found to comply with the limits for a Class B digital device, pursuant to part 15 of the FCC Rules. These limits are designed to provide reasonable protection against harmful interference in a residential installation. This equipment generates uses and can radiate radio frequency energy and, if not installed and used in accordance with the instructions, may cause harmful interference to radio communications. However, there is no guarantee that interference will not occur in a particular installation. If this equipment does cause harmful interference to radio or television reception, which can be determined by turning the equipment off and on, the user is encouraged to try to correct the interference by one or more of the following measures:

- Reorient or relocate the receiving antenna.
- Increase the separation between the equipment and receiver.
- Connect the equipment into an outlet on a circuit different from that to which the receiver is connected.
- Consult the dealer or an experienced radio/TV technician for help.

FCC Radiation Exposure Statement:

The device has been evaluated to meet general RF exposure requirement. The device can be used in portable exposure condition without restriction.