

Remote Control Instruction Manual

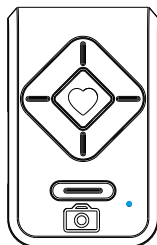

Instructions :

Bluetooth name: LAIGI

Bluetooth version: 4.2

Lithium battery: Rechargeable 60mAh

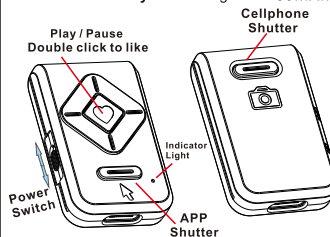

Using:

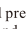
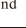
1. Pull the power switch, the indicator light flashes
2. Open the mobile phone Bluetooth and search for the device name: **LAIGI**
3. Click the pairing is successful, the indicator light will no longer flash
4. Open the phone camera and press  to take photo
5. Open the mobile phone video and press  to start, and then press  to end

iPhone need to do the following settings :

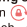

1. Lock screen rotation function 
2. Settings - Accessibility - Touch - Assistive Touch (on)

3. Settings - Accessibility - Touch - Assist - Tracking Sensitivity

(The Tracking Sensitivity function can be found in the drop-down of the Assistive Touch menu content)

Move the white point towards the turtle (best between 1/4 and 1/3 of the progress bar)

4. Open the video software TikTok to take pictures/videos.

5. If pressing  cannot take a photo/video, the small white floating point on the screen isn't aligned with the shutter. Press and hold , click  to adjust up,

down, left and right to make the floating point overlap with the shutter, then you can take photos/videos.

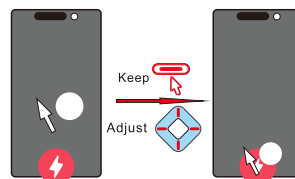

How to open a tripod

Open it in the position of the handle and it will become tripod mode.

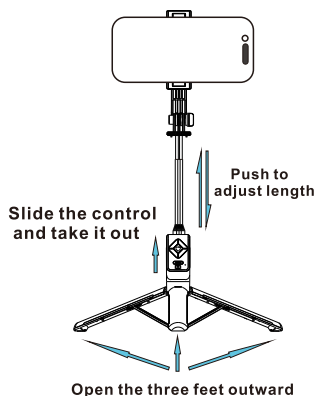

How to clamp the mobile phone

Open an pull up the anti-skid chuck to clamp the mobile phone

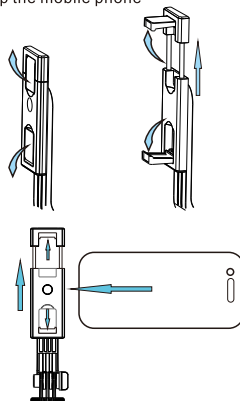

Parts name: Fill Light

Lamp bead model: 2835, warm white/white

Battery: rechargeable lithium battery

Interface voltage: 5V/0.2A

Battery capacity: 60/200 mAh

(Need to buy separately)

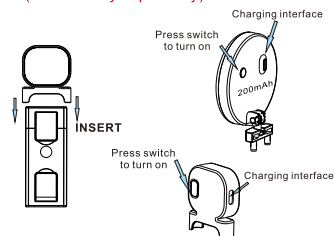

Instructions for use:

1. Insert the fill light into the holes at both ends of the clip
2. Click the switch to turn on/off the light
3. Click the switch to switch the light color and brightness
4. The built-in lithium battery can be recharged

FCC Warning:

This equipment has been tested and found to comply with the limits for a Class B digital device, pursuant to part 15 of the FCC Rules. These limits are designed to provide reasonable protection against harmful interference in a residential installation. This equipment generates, uses and can radiate radio frequency energy and, if not installed and used in accordance with the instructions, may cause harmful interference to radio communications. However, there is no guarantee that interference will not occur in a particular installation. If this equipment does cause harmful interference to radio or television reception, which can be determined by turning the equipment off and on, the user is encouraged to try to correct the interference by one or more of the following measures:

- Reorient or relocate the receiving antenna.
- Increase the separation between the equipment and receiver.
- Connect the equipment into an outlet on a circuit different from that to which the receiver is connected.
- Consult the dealer or an experienced radio/TV technician for help.

Caution: Any changes or modifications to this device not explicitly approved by manufacturer could void your authority to operate this equipment.

This device complies with part 15 of the FCC Rules. Operation is subject to the following two conditions:

(1) This device may not cause harmful interference, and (2) this device must accept any interference received, including interference that may cause undesired operation.

This equipment complies with FCC radiation exposure limits set forth for an uncontrolled environment. This equipment should be installed and operated with minimum distance 0cm between the radiator and your body.