

Pam & babe

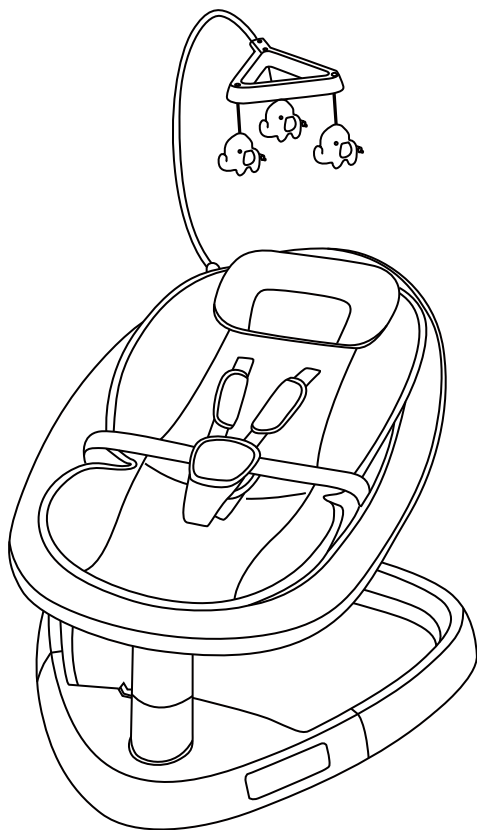

**Luxury Electric Baby Swing
KDD-RS002A**

**IMPORTANT! READ CAREFULLY AND KEEP
FOR FUTURE REFERENCE**

Cradle Swing

WARNING:

FALL HAZARD: Infants have suffered head injuries falling from swings.

- **STOP** using product when infant begins to push up on hands and knees (approximately 5 months)
- **ALWAYS** provide the supervision necessary for the continued safety of your child. When used for swinging, never leave child unattended.

SUFFOCATION HAZARD:

Infants have suffocated:

- on pillows, comforters and extra padding
- in gaps between a wrong-size mattress, or extra padding and product sides
- **NEVER** add soft bedding or padding.
- Please take attention that changes or modification not expressly approved by the party responsible for compliance could void the user's authority to operate the equipment.
- Use **ONLY** mattress provided by manufacturer. This device complies with Part 15 of the FCC Rules.

Operation is subject to the following two conditions:

- (1) This device may not cause harmful interference, and
- (2) This device must accept any interference received, including interference that may cause undesired operation.

CAN ICES-3(B)/NMB-3 (B)

Toys Bar

WARNING:

Possible entanglement injury. Keep out of baby's reach.

Remove mobile from from crib or playpen when baby begins to push up on hands and knees.

- A crib mobile is intended for visual stimulation and is not intended to be grasped by the child.
- If attached to the crib or playpen, remove when baby begins to push up on hands and knees. If so designed, mount on wall or ceiling clearly out of a standing baby's reach.
- If mounted on a wall or ceiling, install the mobile clearly out of a standing baby's reach.
- Always attach all provided fasteners (strings, straps, clamps, etc.) tightly to a crib or playpen according to the instructions. Check frequently.
- Do not add additional strings or straps to attach to a crib or playpen.

COMPONENTS AND PARTS

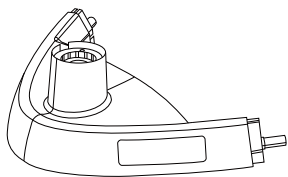

Baby Swing Base x1



Backrest Tube x1

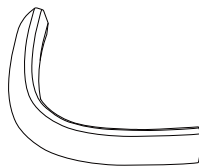

The right side of the
base connection x1

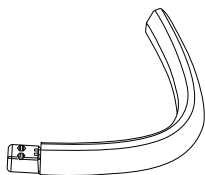

The left side of the
base connection x1

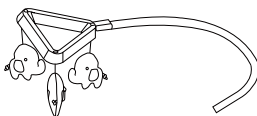

Toy Mobile x1



Seat Cover x1



USB Cable x1



Remote Control x1

INSTALLATION PROCEDURE

Base Assembly



Backrest and Cover Installation

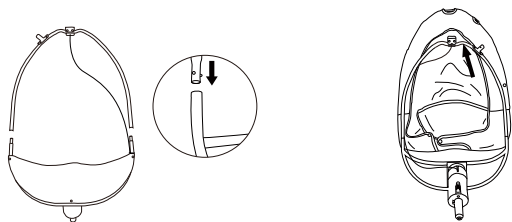

Finished installation

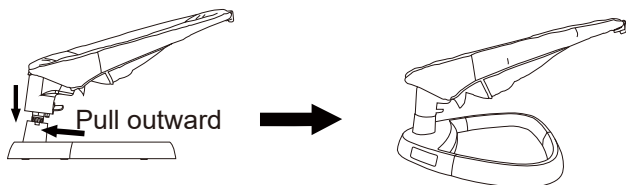

Backrest Adjustment

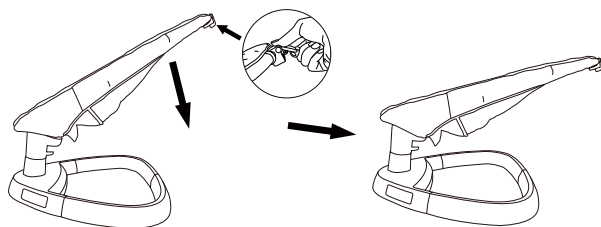

There are 3 gears for backrest adjustment. The initial is in first gear.

1. Don't need to pull the handle upward, directly lift up. One move up to second gear, one move up to third gear,

2. Pull the handle down, and then lower it down, and keep the handle in the pull state when lowering it, put it once into second gear, and put it again into first gear.

Installation of Toy Mobile

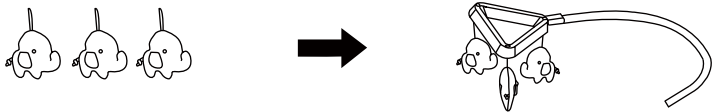

FIVE-POINT HARNESS

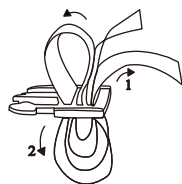
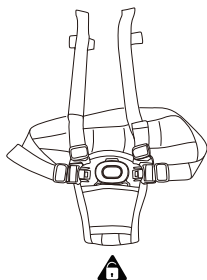
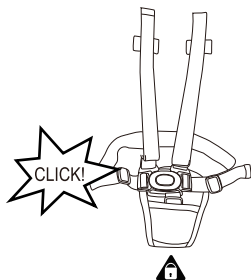

Lock to Not Swing



Unlock to Swing

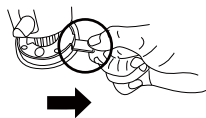

Remove Base

ELECTRONIC PART DESCRIPTION

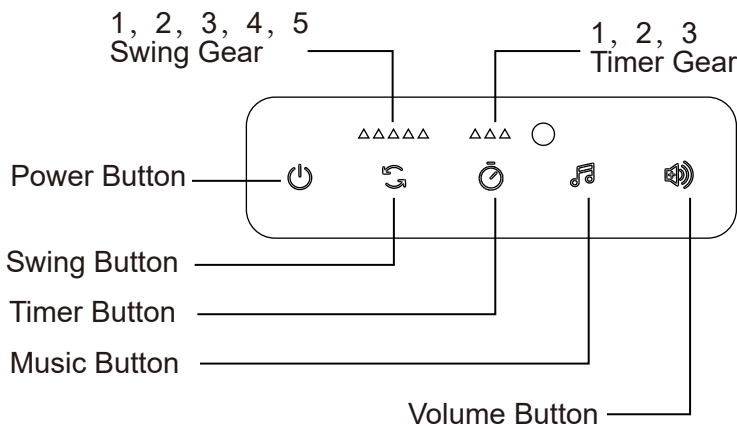

POWER BUTTON

1.Power Button

After powered on, indicator light on, device shutdown by default. Touch the “Power Button” to turn on the device, and the indicator light turn on. Touch the “Power Button” again to turn off the device, all working functions and indicator light (EXC “power button” lights) were turned off.
“Power button” always light on when power on.

2.Timer button

Touch the “Timer Button” to select a time, the selected timer indicator light up. The 3 timing stalls: 8 minutes, 15 minutes, 30 minutes. Stop timing with 4th touch , all timing indicators turn off. Circulable operation.

3.Swing Button

Touch “Swing Button” to select a swing gear, the selected swing gear indicator light up. There are 5 swing gears. Stop with the 6th touch and all swing gear indicators turn off. Circulable operation.

4.Music Button

Touch the “Music Button” to play music, touch again to pause the music, then touch again to continue the current music (11 songs built in) Bluetooth mode: Turn on your phone's Bluetooth and search”cool baby RS002” for pairing.

5.Volume Button

Touch the “Volume Button” to turn the volume up or down. There are five gears for sound increase and decrease). Circulable operation.

Power Supply Mode:

- 1.The product comes with a USB-DC power cord, which can be connected to a mobile phone charging power source;
- 2.The product comes with a USB-DC power cord, which can be connected to a portable portable power source.

REMOTE CONTROL OPERATION

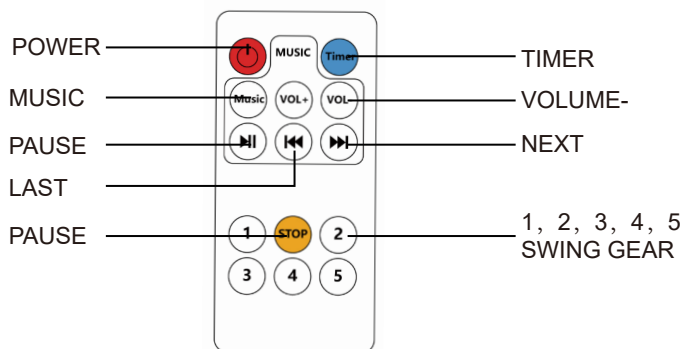

KEY INSTRUCTION

1.Power Button

-- Press the "Power Button" to turn on/off.

2.Timer Button

-- Press the "Timer Button", select a fixed time.

- ① Device timing indicator 1: 8 minutes
- ② Device timing indicator 2: 15 minutes
- ③ Device timing indicator 3: 30 minutes

3.Music Button

-- Press the "Music Button" to play music.

4. VOL+ Volume Increase Button

-- Press the "VOL+ Key" to increase the volume.

5. VOL - Volume decrease button

-- Press the "VOL- Key" to decrease the volume.

6.Music Pause Button

-- Press the "Music Pause Button" to play and pause the music.

7. Previous Song

-- Press the "Previous Song Button" to play the previous song.

8. Next Song

-- Press the "Next Song Button" to play the next song.

9. Swing Button

- Press button 1 briefly to select 1st gear (Gear indicator 1 on),
- Press button 2 briefly to select 2nd gear (Gear indicator 2 on),
- Press button 3 briefly to select 3rd gear (Gear indicator 3 on),
- Press button 4 briefly to select 4th gear (Gear indicator 4 on),
- Press button 5 briefly to select 5th gear (Gear indicator 5 on).

10.Pause Button

-- Press the "Pause Button" to stop swinging, all gear indicators are off.

Use of remote control: directly to the infrared receiver. Remote control distance: within 3 meters.

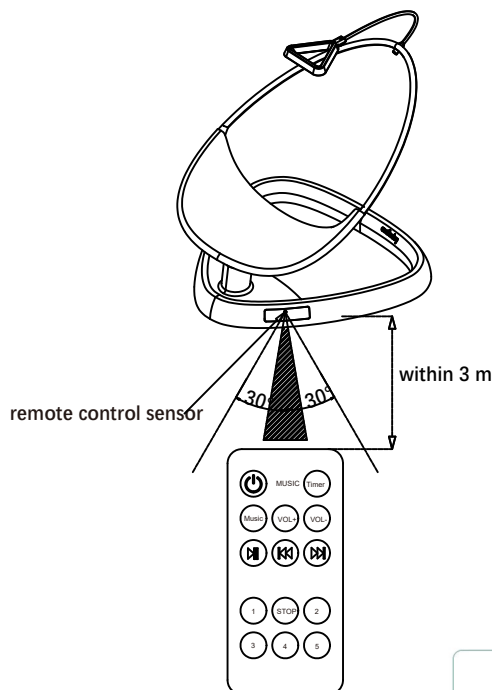

Button Battery CR2025-3V
(INCLUDE)
(You need to remove the
insulating plastic sheet
before you can power on)

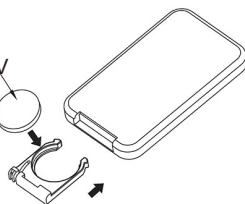

MAINTENANCE & CLEANING

Please make a routine check to make sure that electric rocking chair is secure.

Please use the soft and dry cloth or sponge to clean the electric rocking chair. Do not use alkaline or acidic water to wash the bassinet to avoid the water corrode the iron pipes or hardware.

Do not use or keep the bassinet in a wet, cold or high temperature environment for extended periods of time. Please use a brush or other clean tools to clean any splotches on the fabric.