

无线智能定位终端

快速 使用 指南

(版本 V1.0 XM)

非常感谢您使用 GPS TRACKER，使用指南将详细的说明如何操作本产品。请您在使用之前认真阅读，以便得到正确的使用方法。本产品外观、颜色及配件如有改动，请以实物为准。本公司对使用过程中的过失和疏漏不承担法律责任。

警告：严禁使用本产品实行非法用途，一切后果本公司概不负责

1、终端安装说明

安装前的准备工作：

- ①打开包装盒，检查设备型号是否正确，配件是否齐全。
- ②SIM 卡选择，终端需要插入一张 SIM 卡，选择支持的运营商 SIM 卡。
- ③SIM 卡的安装，根据设备 SIM 卡槽类型，确认好 SIM 卡方向，正确放置 SIM 卡。

注意：（1） 在安装或取出 SIM 卡前，请先将终端的电源切断；

（2） 终端 SIM 卡需要开通联网功能；

（3） 若您的 SIM 卡已开启要求输入 SIM PIN，请参考您的手机用户手册将输入 SIM PIN 功能关闭；

（4） 请确保终端 SIM 卡有资费。

2、设备应用操作

2.1、APP 下载及登录：



2.1.1、APP 下载

IOS/安卓应用程序，在苹果/谷歌应用商店搜索“TuAiot”或扫描二维码下载

2.1.2、登录账号

- (1) 使用“ID 号码”登录，设备标签上的设备 ID 号码。
- (2) 密码：123456（登录后可修改）
- (3) 如果您有多个设备需要管理，可以联系我们为您创建管理账户

邮箱：Xiaolangxing01@outlook.com

2.1.3、APP 界面及功能

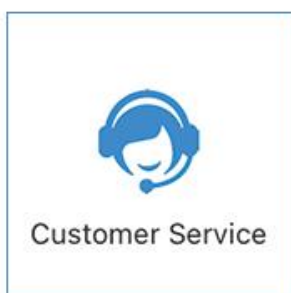
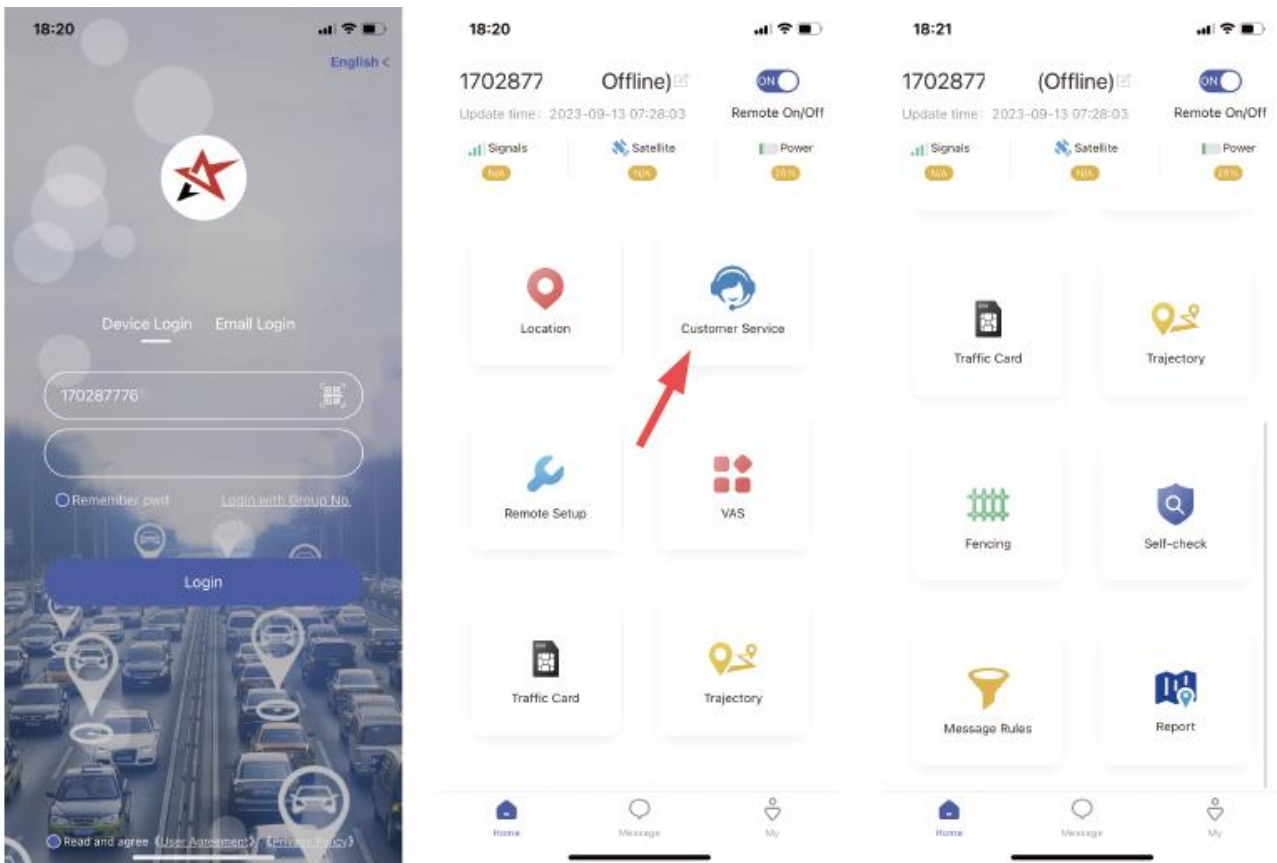

Customer service, any questions
can contact customer service

2.2 、电脑登录查询方法:

个人用户请用设备 ID 号码登录, ID 号码在设备机身和包装盒子上。

服务平台网址: <https://www.tuaiot.com/login.html>

首先 APP 登录绑定邮箱后, 在网址登录平台的时候请选择, 使用邮箱登录。

密码出厂默认为: 123456

如果您有多个设备需要管理, 可以联系我们为您创建管理账户

邮箱: Xiaolangxing01@outlook.com

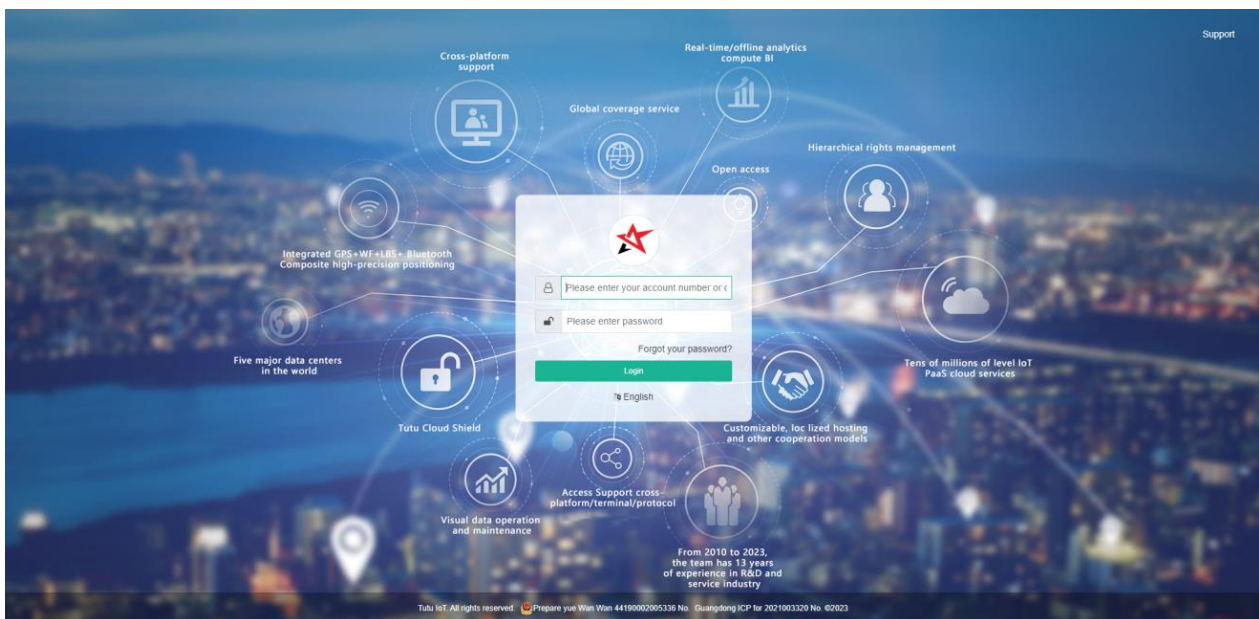

3、产品功能参数

3.1、产品功能:

位置查询、电子围栏、轨迹回放、拐点补传、盲区补传、停靠报表、低电报警、超速报警等。

3.1.1、定位功能

登录平台 点击“定位”就可以实时查看设备位置 (APP 设备位置时间和手机时间相同就是设备的最新位置, 如果时间不一致请点击一下右上方定位图案 20 秒后会自动更新)

3.1.2、电子围栏设置

设置围栏: 在地图上设置安全区域范围, 设备进出此范围手机会收到报警信息

3.1.3、轨迹回放

点击轨迹: 可以选择 180 天内任何一天的运动路线, 如果要求轨迹线路精准可以设置工作模式, 设置工作模式在功能设置里面 (工作模式频率越高越耗电, 日常使用建议省电模)

3.1.4、工作模式：

(1) 设备是不开启 GPS，此模式设备没有轨迹，是最省电的模式。

(2) 有轨迹模式，可以设置多长时间定位一次，比如 30 秒定位一次，10 分钟定位一次，1 小时定位一次。

3.2、注意事项

(1) 请勿将产品浸泡在水中；

(2) 请将产品远离火源、高温高热等极端环境；

(3) 请注意提醒小孩以免误食产品；

(4) 切勿私自拆开，改装，暴力破坏等：本产品在断电状态、服务区外、信号弱、故障时定位功能无法工作、定位有偏差，工作原理类似手机。

3.3、性能参数：

● 充电要求：5V DC - 1000mA ；

● 定位时间：平均热启动：≤3sec (open sky)

平均冷启动：≤35sec (open sky)

● 定位精度：≤10 米 (open sky)

● 工作温度：-20℃-70℃

3.3、安装位置：

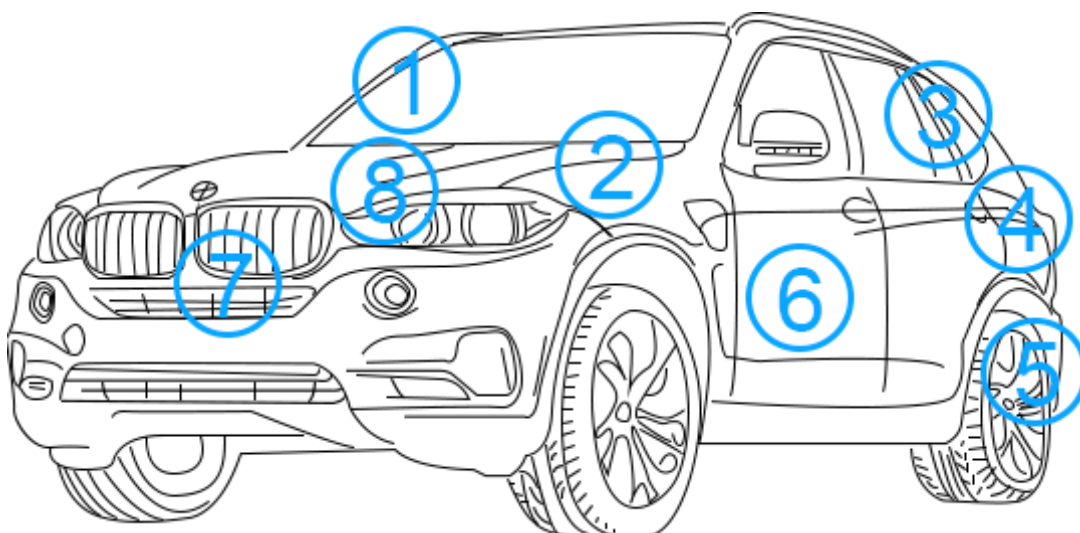

- | | | | |
|---------|---------|---------|----------|
| 1. 副驾驶室 | 2. 中控 | 3. 后备箱 | 4. 后保险杠 |
| 5. 尾部底部 | 6. 车门侧面 | 7. 前保险杠 | 8. 发动机舱内 |

4、产品配件和 LED 灯状态

4.1 产品配件:

标配:设备/充电线/使用说明

4.2 终端 LED 工作状态

4.2.1 红色 LED(电源/充电指示灯)

灯的状态	含 义
常 亮	充电中
不 亮	未充电/已充满/关机

4.2.2 黄色 LED(GSM 信号状态)

灯的状态	含 义
快 闪	网络初始化
常 亮	网络通讯正常
不 亮	休眠/关机

4.2.3 蓝色 LED(GPS 信号状态)

灯的状态	含 义
快 闪	定位信号搜索中
常 亮	已定位
不 亮	休眠/关机

5、短信指令说明及使用方法:

用户手机的 SIM 卡号发送短信指令给设备的 SIM 卡号。

以下各短信指令格式中的逗号为英文输入状态格式，字母按指令要求分大小写。

常用查询功能	短信指令格式	设备回复
终端状态查询	CXZT	版本 ID、IP 等信息
经纬度链接查询	G1234	谷歌链接地址
重启设备	CQ	CQ OK
恢复出厂设置	FORMAT	FORMAT OK

修改 APN	APN, 123456, cmnet	APN SET OK
修改 APN 用户名	APNUSER, 123456, user	APNUSER SET OK
修改 APN 密码	APNPASSWD, 123456, password	APNPASSWD SET OK
上传时间设置	FREQ, 123456, 30	FREQ SET OK
服务器 IP 端口修改设置	IP+空格+IP 地址+空格+端口号 例子: IP 106.3.230.234 8185	IP SET OK

6、故障排除

终端首次安装后一直无法连接至后台服务器，后台显示未上线。请检查终端安装：

在操作终端时，如果感到不正常，请参阅下列问题及解决方案；若仍不能解决问题，请与经销商取得联系。

常见问题	发生问题	解决办法
信号接收不良	在接收不良的地区使用终端，如高楼附近或地下停车场，无线电波无法有效传达	位于信号良好的位置使用终端
首次安装平台显示未启用	SIM 卡未装好	正确安装 SIM 卡
	指示灯不亮	进行充电
	指示灯闪烁	检测 SIM 卡状态
	SIM 卡未开通 GPRS 功能	请联系服务商开通 GPRS
平台地图显示位置不正确	GPS 未定位	请到室外空旷的地方进行定位
	终端安装好后一直静止不动	把终端拿到室外跑几圈
平台显示离线状态	SIM 卡欠费或被取消 GPRS	请检查 SIM 卡状态
	掉线区域信号弱	请到信号强的地方重试

Wireless Smart GPS Tracker

User Manual

(Version V1.0 XM)

Thank you very much for using GPS TRACKER, the user manual will guide how to operate this product, please read it carefully before using it in order to get the correct method of operation. If the appearance, color and accessories of this product are modified, please refer to the actual product. The manufacturer is not liable for faults and omissions which in the user manual.

Warning: It is strictly prohibited to use this product for illegal purposes, and our company is not responsible for any consequences

1. Terminal installation instructions

Preparation before installation:

- ✓ Open the box and check whether the equipment model is correct and whether the accessories are complete.
- ✓ SIM card selection, the terminal needs to insert a standard SIM card, select the supported carrier SIM card.
- ✓ For the installation of SIM card, confirm the SIM card orientation and place the SIM card correctly according to the type of SIM card slot of the device.

Note:

- (1) Before installing or removing the SIM card, please cut off the power supply of the terminal;
- (2) The terminal SIM card needs to enable the networking function;
- (3) If your SIM card is turned on and requires PIN of SIM card input, please refer to your mobile phone user manual to turn off the SIM PIN input function;
- (4) Please make sure that the terminal SIM card has a tariff.

2. Equipment application operation

2.1 APP download and login



2.1.1. APP download

iOS/Android app, search for "TuAiot" in Apple/Google Play Store or scan the QR code to download.

2.1.2. Log in to the account

- (1) Log in with the "ID number" and the ID number on the device label.
- (2) Password: 123456 (can be modified after login).
- (3) If you have multiple devices to manage, you can contact us to create a management account for you.

Email: Xiaolangxing01@outlook.com

2.1.3. APP interface and functions

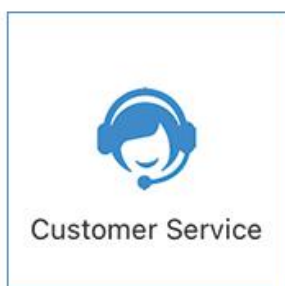
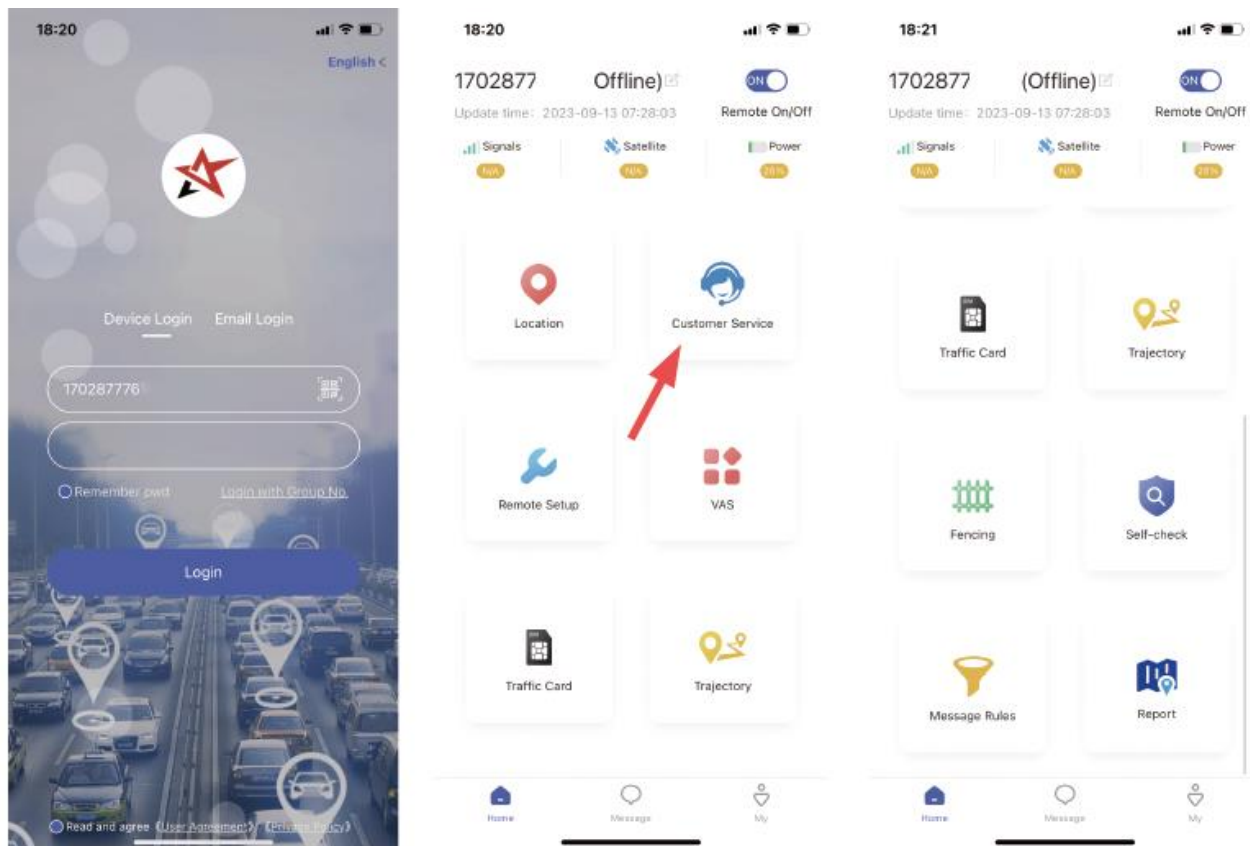

Customer service - Solve all problems(Technical questions, Product) 0questions or Other products.)

2.2. Computer login query method

- ✓ For individual users, please log in with the device ID number, that is on the device body and packaging box.
- ✓ The service platform URL: **<https://www.tuaiot.com/login.html>**
- ✓ First logging in to the app and binding the email, then please use the email when logging in to the platform.
- ✓ The factory default password is: 123456
- ✓ If you have multiple devices to manage, you can contact us to create a admin account for you.
- ✓ **Email: Xiaolangxing01@outlook.com**

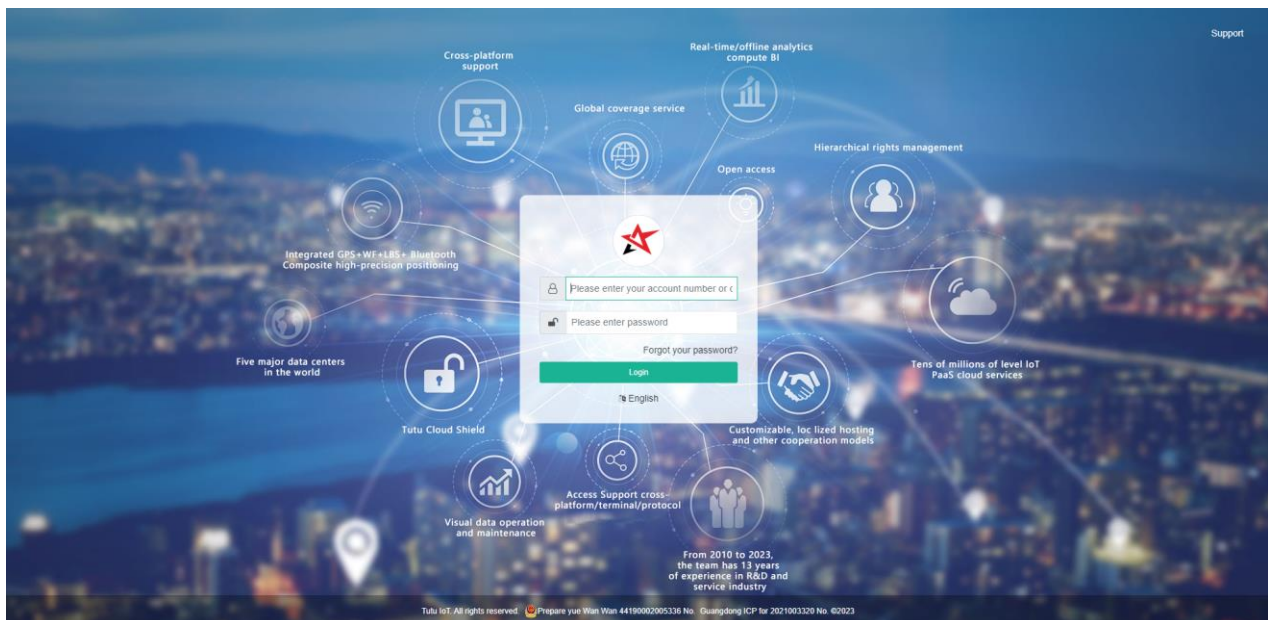

3. Product function parameter installation

3.1. Product Functions:

Location query, electronic fence, trajectory playback, inflection point supplementary transmission, blind spot supplementary transmission, parking report, low power alarm, overspeed alarm, etc.

3.1.1. Positioning function

Log in to the platform Click "Track" to view the device location in real time (APP device location time and mobile phone time is the same is the latest location of the device, if the

time is inconsistent, click once on the upper right positioning pattern will be automatically updated after 20 seconds).

3.1.2 Electronic fence setting

Set up a fence: Set a safe area range on the map, and the mobile phone will receive an alarm message when the device enters and exits.

3.1.3 Track playback

Click the track: choose the exercise route of any day within 60 days, if the track line is required to be accurate that can set the working mode, set the working mode in the function settings (the higher the frequency of the working mode, the more power is consumed, and it is recommended to save power for daily use).

3.1.4 Working mode

- ✓ Power saving mode- The device does not automatically turn on GPS, only when logging in to the APP, the device will automatically refresh once, other times the device does not turn on GPS, this mode of the device does not have track playback.
- ✓ Trajectory mode- Set the frequency of tracking, such as tracking once in 30 seconds, tracking once in 10 minutes, and tracking once in 1 hour.

3.2. Precautions:

3.2.1. Do not soak the product in water.

3.2.2. Please keep the product away from extreme environments such as fire source, high temperature and high heat.

3.2.3. Please remind children not to eat the product by mistake.

3.2.4. Do not disassemble, modify, violently destroy, etc.: This product cannot work when the power is off, outside the service area, the signal is weak, the positioning function cannot work when the fault occurs, the positioning is biased, and the working principle is similar to that of a mobile phone.

3.3. Performance parameters

- ✓ Charging requirements: 5V DC - 1000mA;
- ✓ Positioning time: Average hot start: ≤3sec (open sky)
Average cold start: ≤35sec (open sky)
- ✓ Positioning accuracy: ≤10 meters (open sky)
- ✓ Working temperature: -20°C-70°C

3.4 Installation :

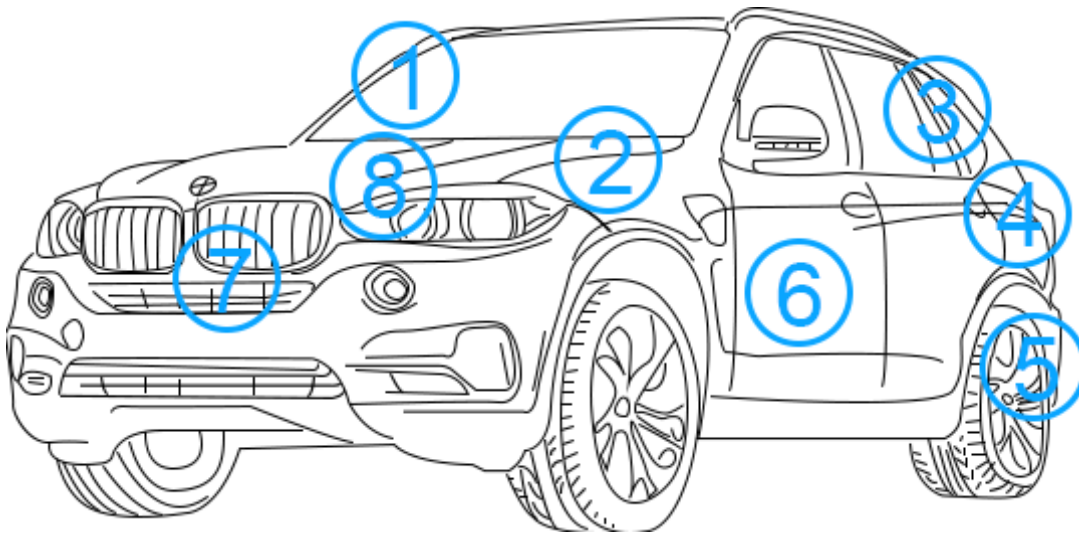

1. Front passenger compartment 2. Central control 3. Trunk 4. Rear bumper
5. Rear bottom 6. Door side 7. Front bumper 8. Inside the engine compartment

4. Product accessories and LED light status

4.1 Product accessories

Standard: Device/Charging cable/Quick Installation Guide

4.2. LED status

4.2.1 Red LED (Power supply/Charging indicator)

Light status	Meaning
Light on	charging
Light off	Not charged/full charged/shutdown

4.2.2 Yellow LED (GSM signal status)

Light status	Meaning
Quick flash	Network initialization
Light on	Normal network communication/online
Light off	sleep/shutdown

4.2.3 Blue LED (GPS signal status)

Light status	Meaning
--------------	---------

Quick flash	Location signal searching
Light on	Located successfully
Light off	Sleep/shutdown

5. SMS instructions

The SIM card number of the user's mobile phone sends SMS commands to the SIM card number of the device.

The commas in the following SMS command format are the English input status format, and the letters are divided into upper and lower case according to the command requirements.

Common query functions	SMS command format	Device reply
Terminal status query	CXZT	Version、ID、IP etc...
Longitude and latitude link query	G1234	Google link address
Reboot the device	CQ	CQ OK
Factory reset	FORMAT	FORMAT OK
Modify the APN	APN,123456,cmnet	APN SET OK
Change the APN username	APNUSER,123456,user	APNUSER SET OK
Change the APN password	APNPASSWD,123456,password	APNPASSWD SET OK
Upload time settings	FREQ,123456,30	FREQ SET OK
Modify the server IP port settings	IP+blank+IP+blank+port Example: IP 106.3.230.234 8185	IP SET OK

6.Troubleshooting

When operating the terminal, it is found that the device is not working properly, please refer to the following problems and solutions;

If you still can't solve the issue, please contact the Customer Service Team.

common problem	a problem occurs	Solution
Poor signal reception	Using the terminal in areas with poor reception, such as near high-rise buildings or	Use the terminal in a location with good signal

	underground parking lots, radio waves cannot communicate effectively	
First time installation platform display Not activated	SIM card not installed	Install the SIM card correctly
	Light does not shine	to charge
	indicator flashes	Detect SIM card status
	SIM card is not enabled for network function	Please contact the service provider to activate the network function
Platform map display Incorrect location	GPS not fixed	Please go to the open space for positioning
	The terminal has been standing still after installation	Take the terminal outside and run a few laps
Platform shows offline status	The SIM card is in arrears or the network function is turned off	Please check SIM card tariff
	Weak signal in drop zone	Please go to a place with strong signal to test

This device complies with part 15 of the FCC Rules. Operation is subject to the following two conditions: (1) This device may not cause harmful interference, and (2) this device must accept any interference received, including interference that may cause undesired operation.

Any Changes or modifications not expressly approved by the party responsible for compliance could void the user's authority to operate the equipment.

Note: This equipment has been tested and found to comply with the limits for a Class B digital device, pursuant to part 15 of the FCC Rules. These limits are designed to provide reasonable protection against harmful interference in a residential installation. This equipment generates uses and can radiate radio frequency energy and, if not installed and used in accordance with the instructions, may cause harmful interference to radio communications. However, there is no guarantee that interference will not occur in a particular installation. If this equipment does cause harmful interference to radio or television reception, which can be determined by turning the equipment off and on, the user is encouraged to try to correct the interference by one or more of the following measures:

- Reorient or relocate the receiving antenna.
- Increase the separation between the equipment and receiver.
- Connect the equipment into an outlet on a circuit different from that to which the receiver is connected.
- Consult the dealer or an experienced radio/TV technician for help.
- SAR limits is used against the body. The SAR limit is 1.6 watts per kilogram averaged over 1 gram of tissue for use against the body.

During testing, the device radios are set to their highest transmission levels and placed in positions that simulate use against the body, with 0mm separation. When placing the device near your body, keep at least 0mm of separation to ensure exposure levels remain at or below the as-tested levels.

The highest SAR values are as follows: Body SAR: 0.657W/Kg