

USER MANUAL

Android system



Contents

- 1、 Home 3
- 2、 Dropdown menu 4
- 3、 Navigation 5
- 4、 Radio 6
- 5、 Music 7
- 6、 Video 9
- 7、 Photo 10
- 8、 AUX and AV-IN 11
- 9、 Bluetooth phone 12
- 10、 Bluetooth Music 14
- 11、 File Explorer 15
- 12、 Theme switching 16
- 13、 SWC 17
- 14、 Third party applications 18
- 15、 Phone Connect 20
- 16、 Split screen 23
- 17、 Settings 24
- 18、 Rearview camera 31

1、Home



- 1 Back、Home、Task、Screen off
- 2 Video widget
- 3 Bluetooth music widget
- 4 Status Bar
- 5 Date & Time widget
- 6 Radio widget
- 7 Music widget
- 8 Display all applications
- 9 Navigation, Settings, Bluetooth, Bluetooth music

2、Dropdown menu

Slide your finger down the top edge to trigger the drop-down menu page; Swipe down again on the drop-down menu page to pull up the brightness adjustment.

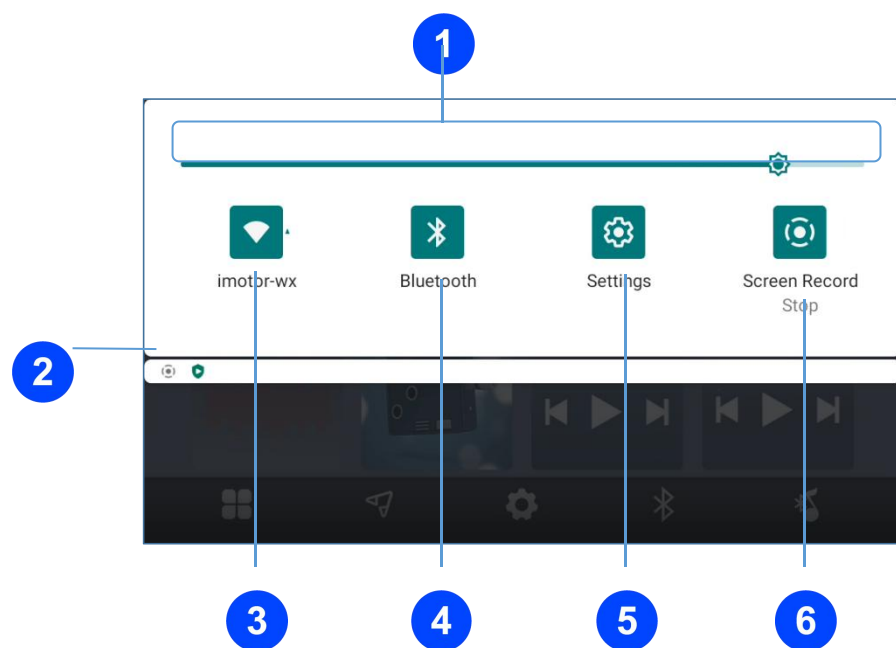

- 1 Screen brightness
- 2 Notifications
- 3 WLAN: Tap to turn on/off WLAN,
long press to enter the WLAN settings.
- 4 Bluetooth: Tap to turn on/off Bluetooth,
long press to enter Bluetooth settings.
- 5 Settings: Tap to enter settings.
- 6 Screen recording: Tap to start/stop screen recording.

3、Navigation

Google Map

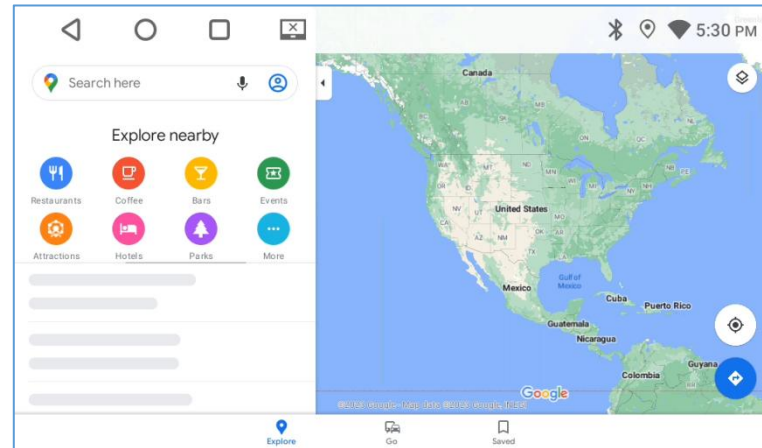

Google Maps is an electronic map service provided by Google, including detailed satellite photos of local areas.

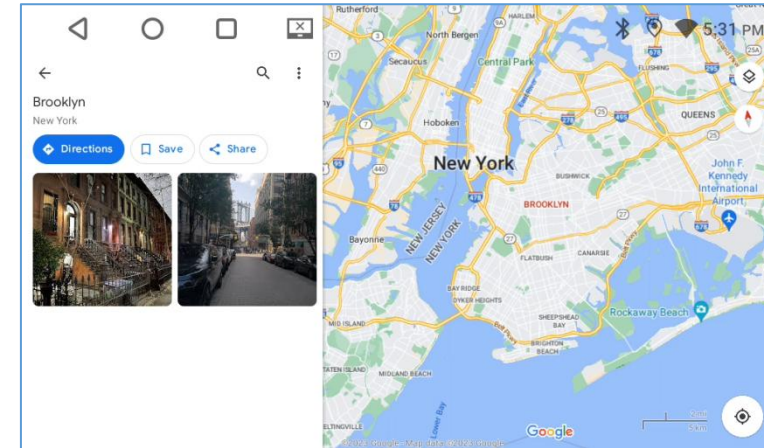

In Google Maps, you can view real-time traffic information, nearby businesses, and points of interest, among other information.

4、Radio

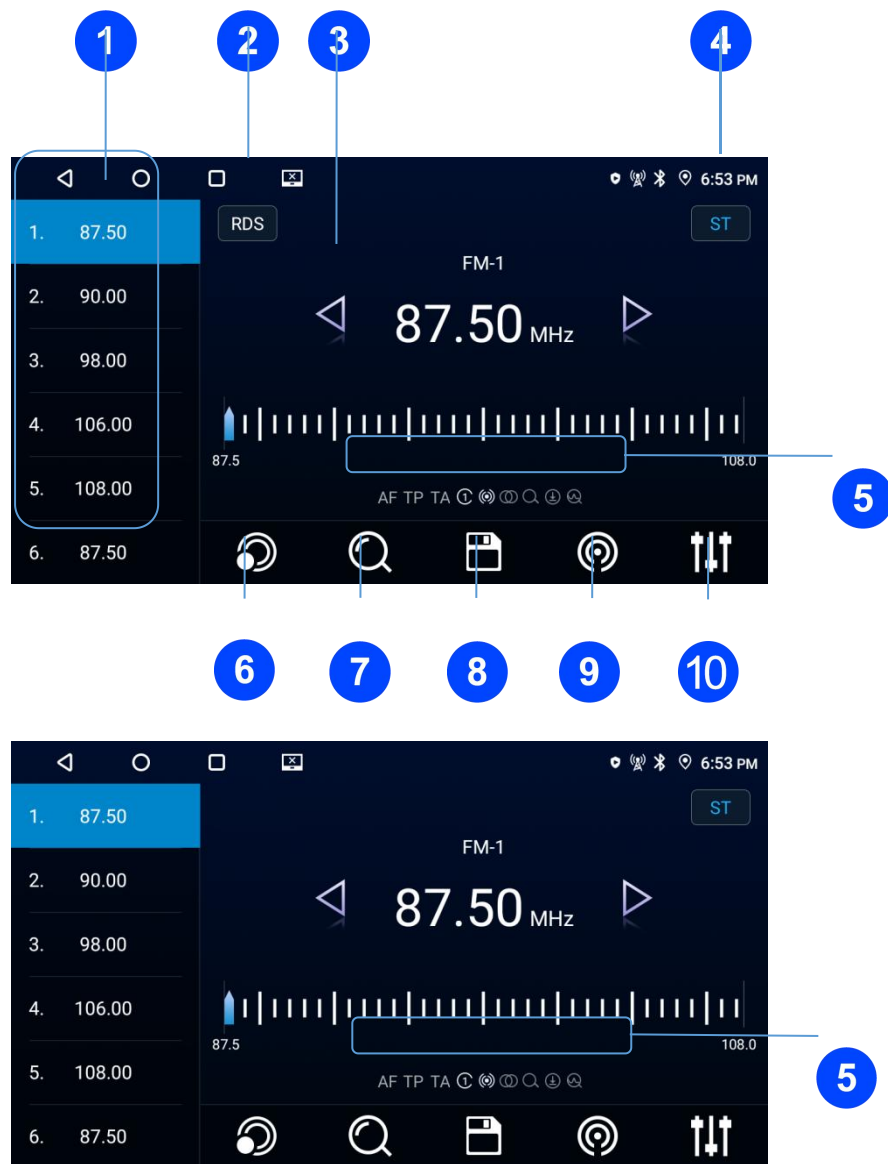

- 1 Available stations list.
- 2 Tap it to enter RDS feature settings.
- 3 Tap it to step manually up and down the frequency.
- 4 To turn on ST function.
- 5 Radio function status display.
- 6 Tap to switch bands (FM/AM).
- 7 Auto scan the available radio station.
- 8 Auto browse the available radio station.
- 9 To turn on local function.
- 10 Tap it to set up sound effects.

! CAUTION

If your radio is not RDS enabled, the RDS icon 2 and the AF, TP, and TA ICONS 5 will not appear on your interface.

5、Music

a、Function description

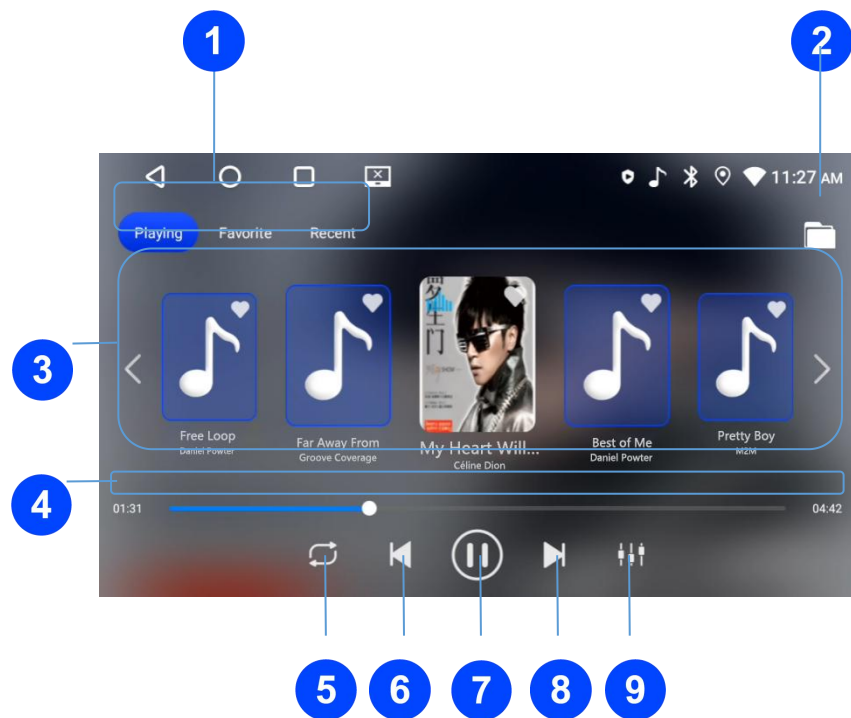

- 1 Tap to select the playing/favorites/recent playlist.
- 2 List music files in folders.
- 3 Playing/Favorites/Recent playlist.
- 4 Tap to play forward or backward.
- 5 Tap to active shuffle/repeating.
- 6 Tap to play last.
- 7 Tap to play or pause.
- 8 Tap to play next.
- 9 Tap it to go to the sound effect setup.

2、Lyrics

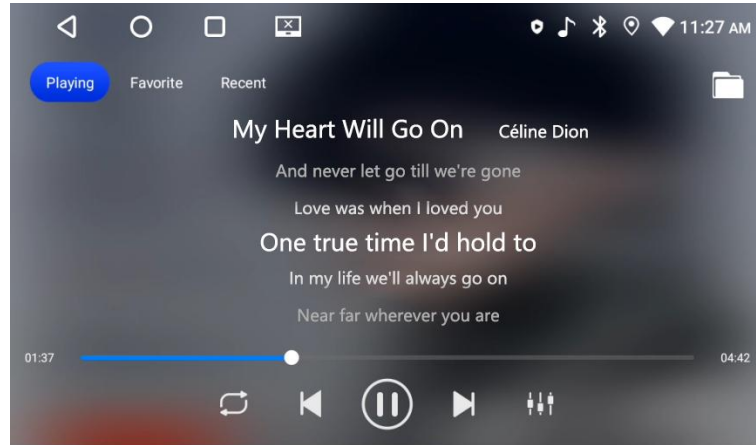

Tap to the album cover of the song to view the lyrics.

3、EQ

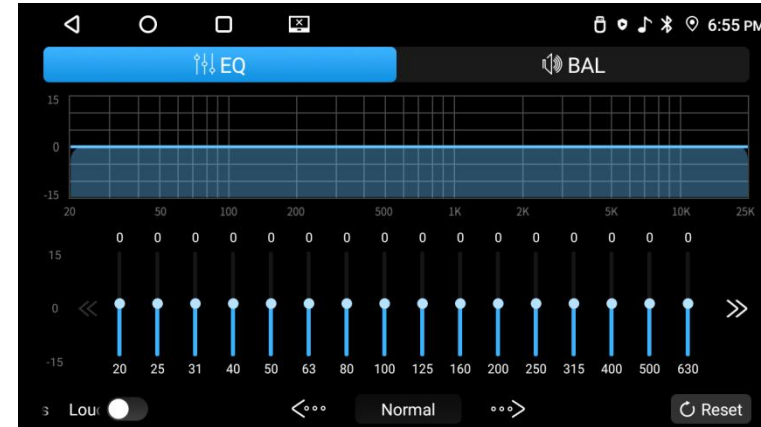

Preset EQ: Custom、Normal、Pop、Rock、Classic、Jazz;

6、Video

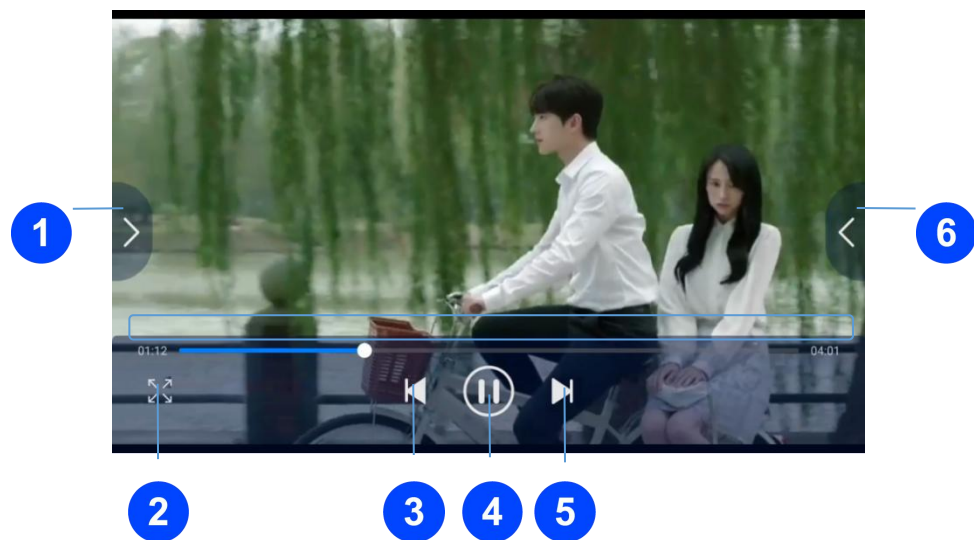

- 1 List video files in folders.
- 2 Fullscreen.
- 3 Tap to play last.
- 4 Tap to play or pause.
- 5 Tap to play next.
- 6 Tap to access the playlist.

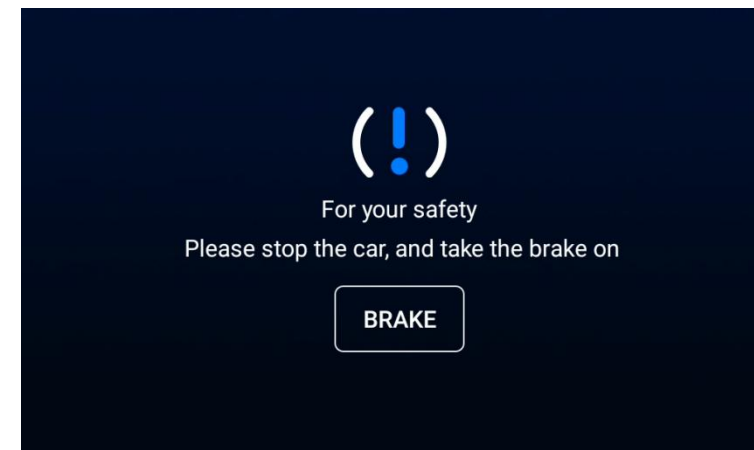

CAUTION

For safety reasons, video images cannot be viewed while your vehicle is in motion. To view video images, stop in a safe place and apply the parking brake.



7、Photo

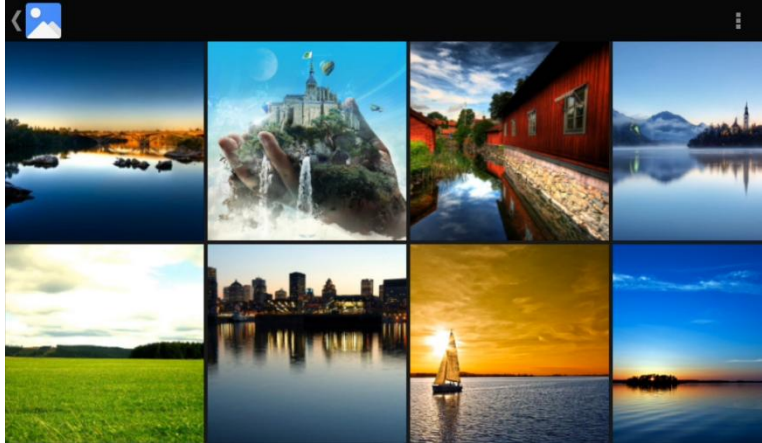

Thumbnail image, can be browsed by swiping left or right.



Spread two fingers apart to zoom in on the picture;
pinch two fingers together to zoom out of the
picture.

You can set the picture as the wallpaper for the
application page.

8、AUX and AV-IN

1、AUX

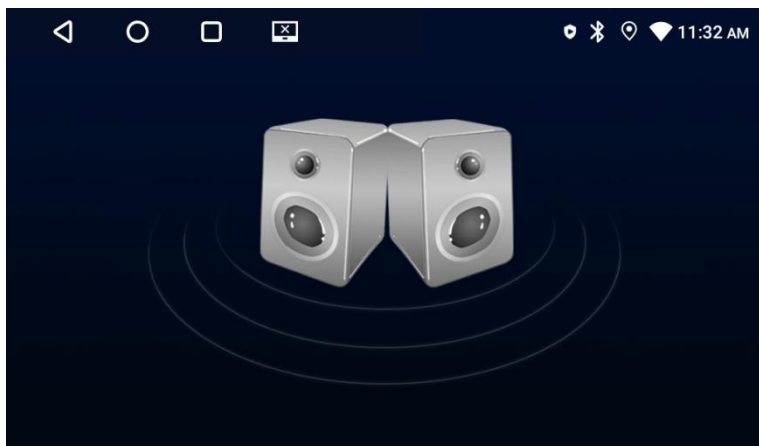

You can play the audio from external portable audio player connected to this unit.

2、AV-IN



You can display the video image output by the device connected to this unit.

CAUTION

For safety reasons, video images cannot be viewed while your vehicle is in motion. To view video images, stop in a safe place and apply the parking brake.

9、Bluetooth phone

1、First-time Bluetooth connection steps

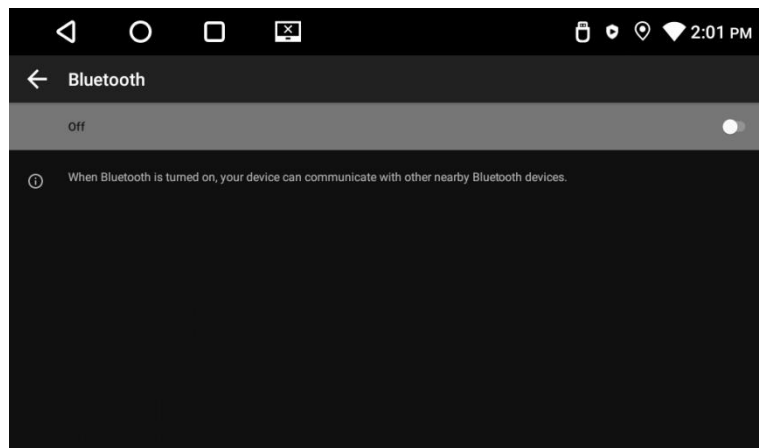

a、 Step 1: Enter [Settings] – [Bluetooth], then tap [ON] to turn on the Bluetooth switch.

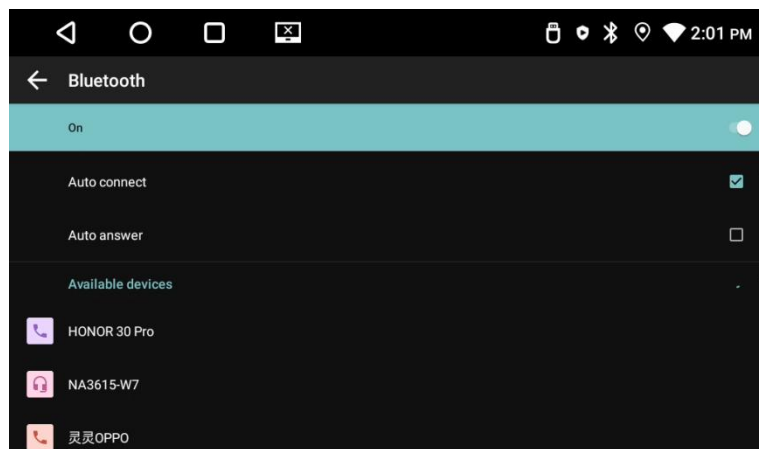

b、 Step 2: Turn on Bluetooth on your mobile phone to allow the car system to detect your mobile device. Click on the name of your mobile device to start the connection.

。

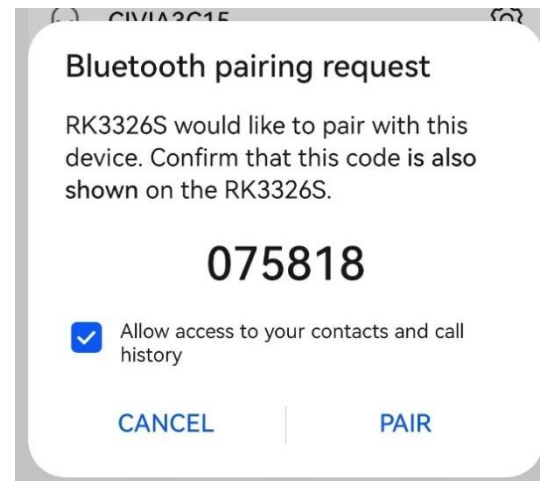

c、 Step 3: On the mobile phone, tap to [PAIR] to confirm the pairing.

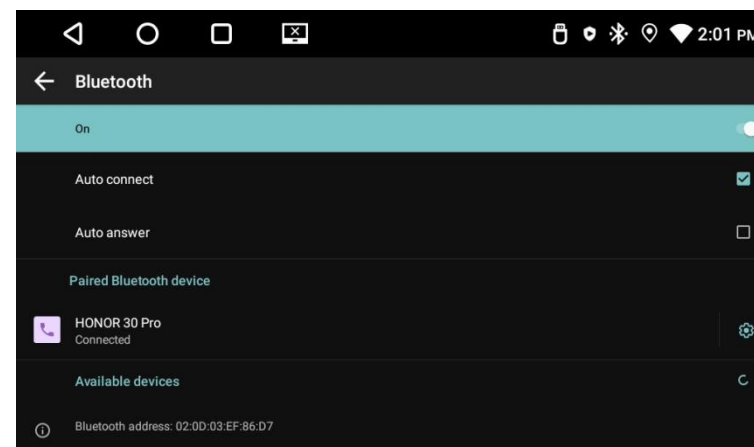

d、 Step 4: After successful pairing, connect the Bluetooth.

Bluetooth phone

2、Dial pad

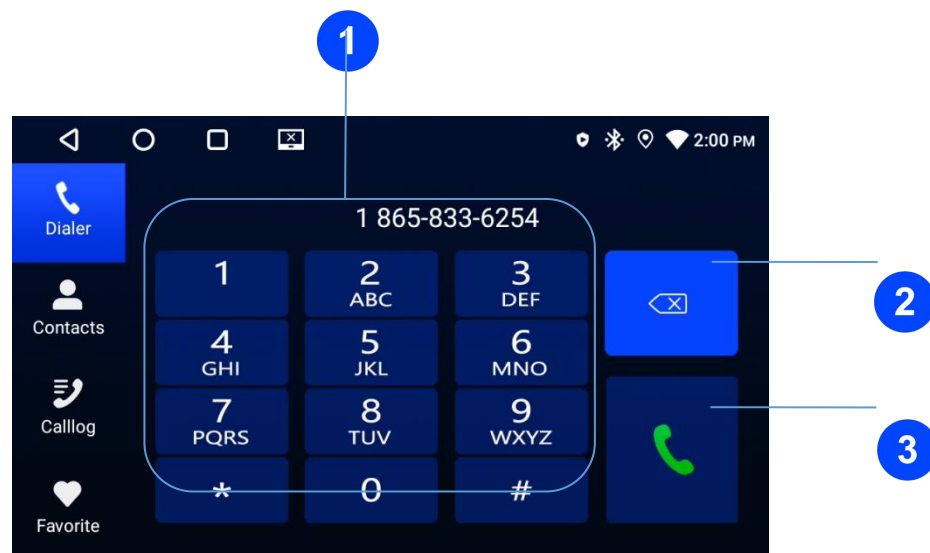

Enter the phone number using the **1** dial pad.
Tap **2** to erase a wrong number.
Tap and hold **2** to erase the entire number.
After entering phone number, tap **3**.



Attention

For your safety, it is prohibited to make phone calls while driving



10、Bluetooth Music

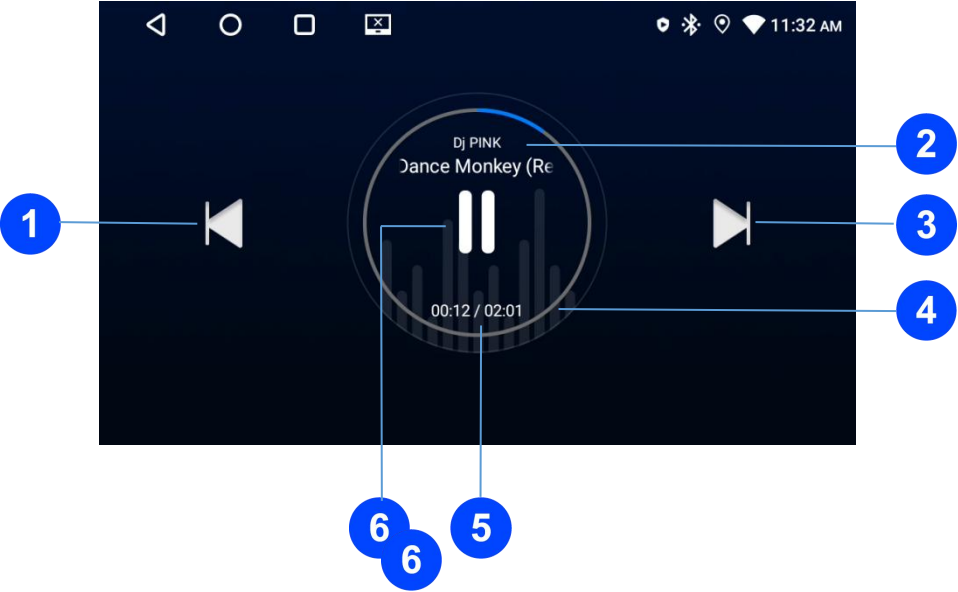

- 1 Tap to play last.
- 2 Song/Album/Singer.
- 3 Tap to play next.
- 4 Play progress bar
- 5 Tap to play forward or backward
- 6 Tap to play or pause.

11、File Explorer



- 1 Back
- 2 Select All/Deselect All
- 3 HD device file
- 4 USB device file
- 5 Folder
- 6 Video file
- 7 Music file
- 8 Photo file
- 9 Select /Deselect

12、Theme switching

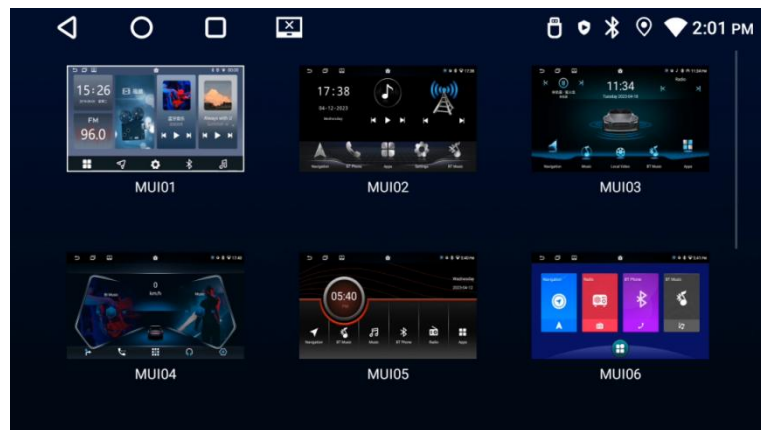

After entering the theme interface, select the theme to switch, tap to the pop-up prompt.

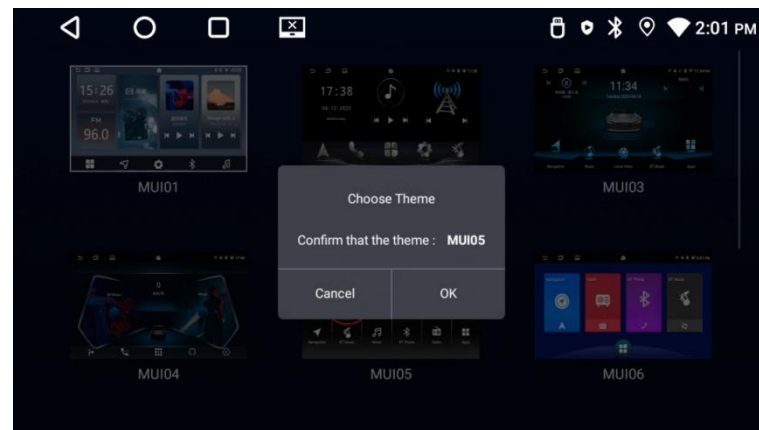

Tap to [OK] confirm the switch. 3 seconds after loading, the switch is successful.



13、SWC

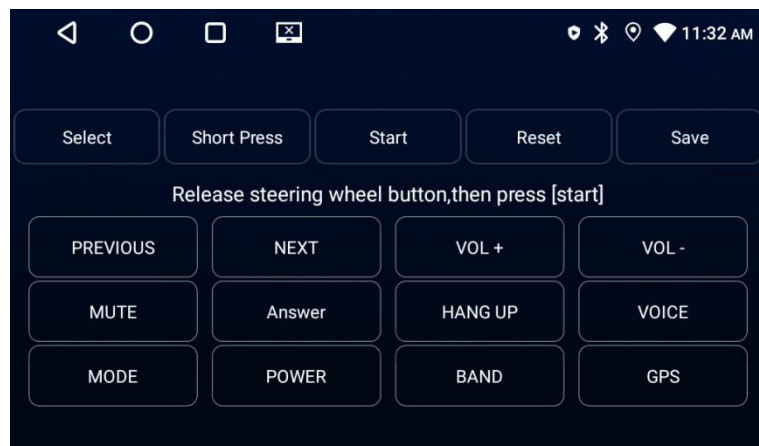

a、Connect SWC1/SWC2/GND wires of the unit to your vehicle SWC wires.

b、Tap to “Reset” and then Tap to “Start” .

c、Select the key you want to set up.

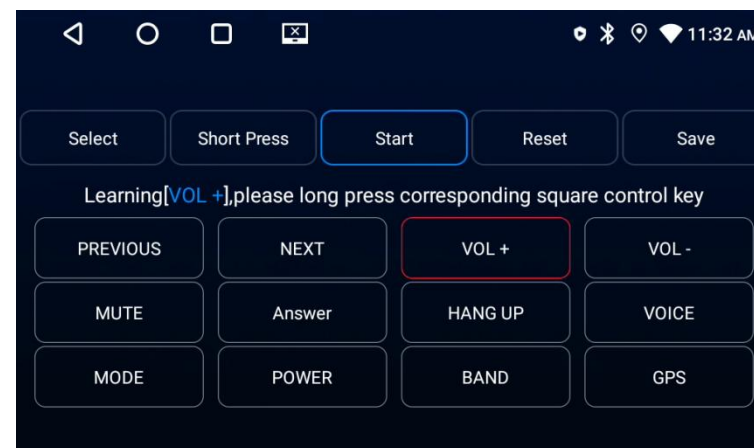

d、Press and hold the corresponding key that needs to be set on the steering wheel. It' s setup successfully when a green tick appears.

e、Repeat 3~4 times to complete the settings of all keys.

f、Tap to “Save” .

14、Third party applications

YouTube

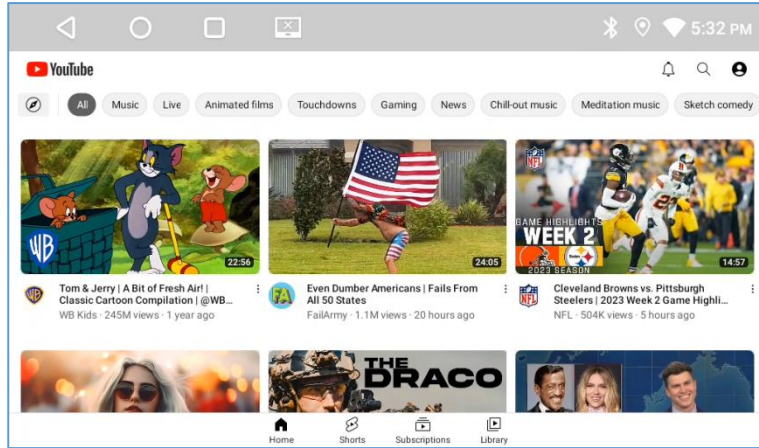

YouTube is one of the most popular video platforms globally, where users can freely upload, watch, and share various types of video content.

Google Chrome

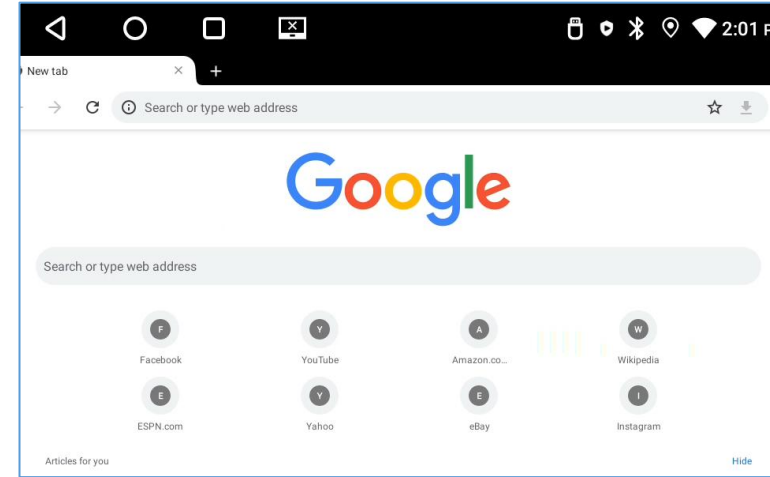

Chrome browser is a free web browser developed by Google. It is known for its fast, lightweight, and secure characteristics, and is widely used for internet browsing, searching for information, watching videos, accessing web applications, and more.



15、Phone Connect

Apple CarPlay (Wireless Connection)

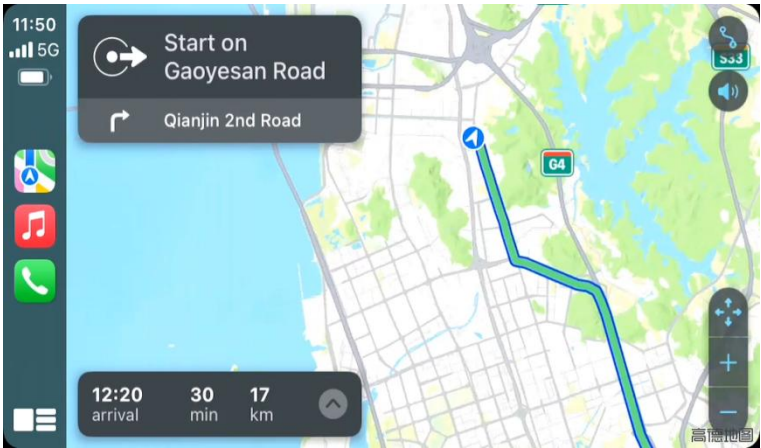

When connected to CarPlay in a driving vehicle, you can intelligently and safely use various iPhone functions, including navigation, making calls, sending and receiving messages, playing music, and viewing the calendar, among others.

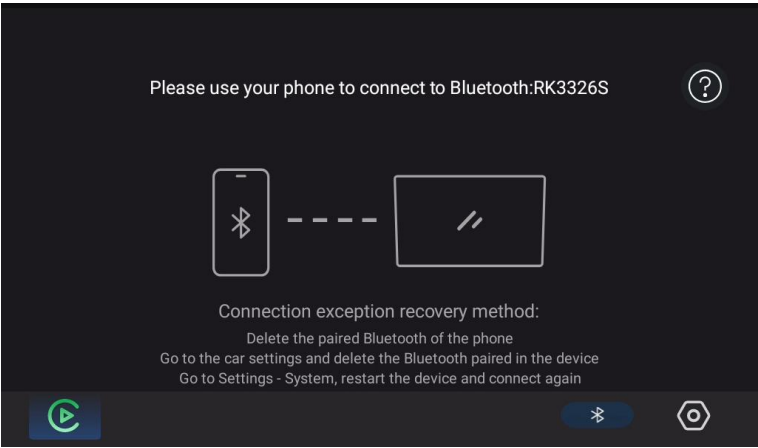

- 1、 The car's infotainment system enters the CarPlay connection interface.
- 2、 The mobile device connects to the car's Bluetooth.
- 3、 On the mobile device, select "Use CarPlay" in the pop-up window to start using wireless CarPlay functionality.

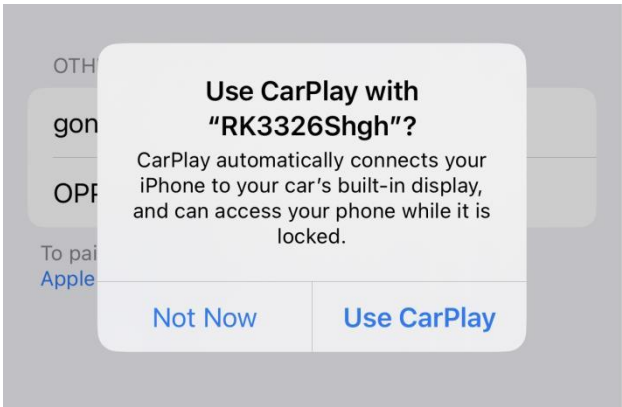

Phone Connect

Android Auto (Wireless Connection)

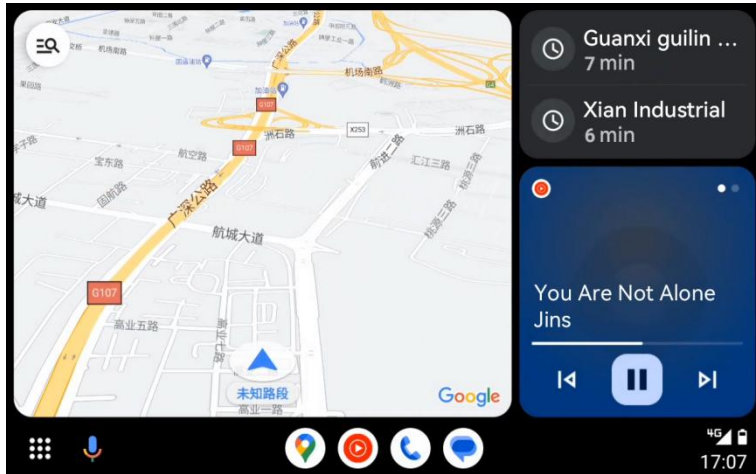

Android Auto is an application framework developed by Google that allows users to wirelessly connect their Android smartphones to the vehicle's entertainment system. It presents the applications, music, navigation, communication, and other features from the phone on the vehicle's touch screen.

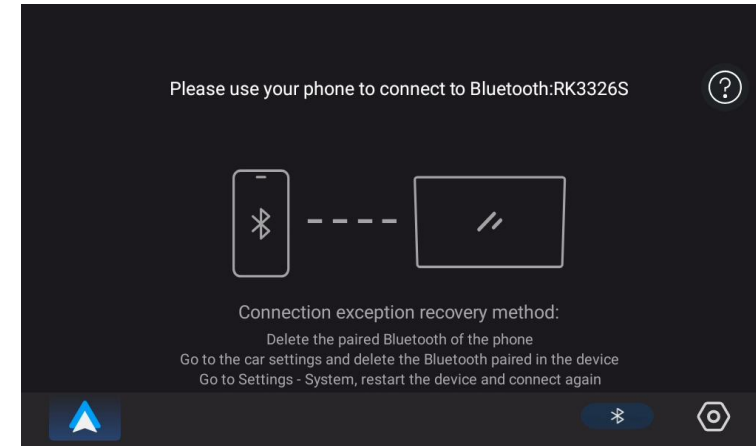

- 1、 The car's infotainment system enters the Android Auto connection interface.
- 2、 The mobile device connects to the car's Bluetooth.
- 3、 On the mobile device, tap to [PAIR] in the pop-up window to start using wireless Android Auto functionality.

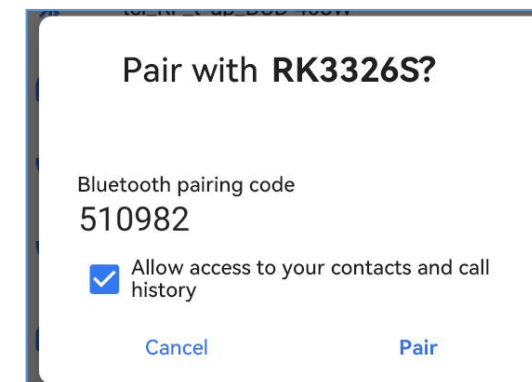

Phone Connect

Yilan



Yilan mobile connectivity is a technology and product that connects mobile devices with vehicle displays to achieve a more convenient and enriching operating and user experience.



- 1、 First, download and install the Yilan app on your mobile device.
- 2、 Open the Yilan app on your mobile device and enter the Yilan connection interface on the vehicle display.
- 3、 Use the original data cable to connect your mobile device to the vehicle.

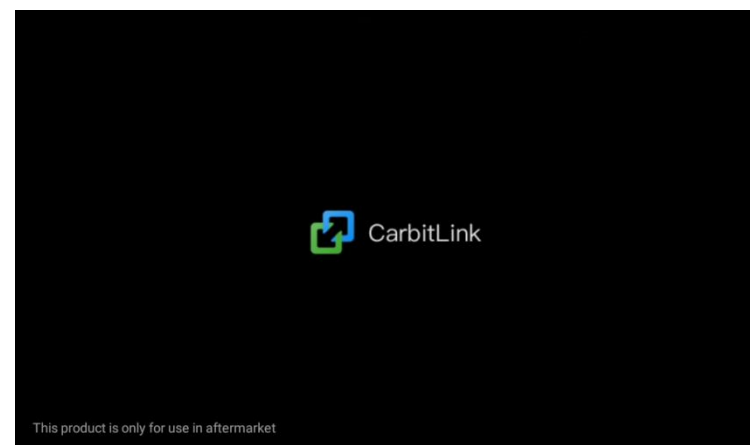

16、Split screen display

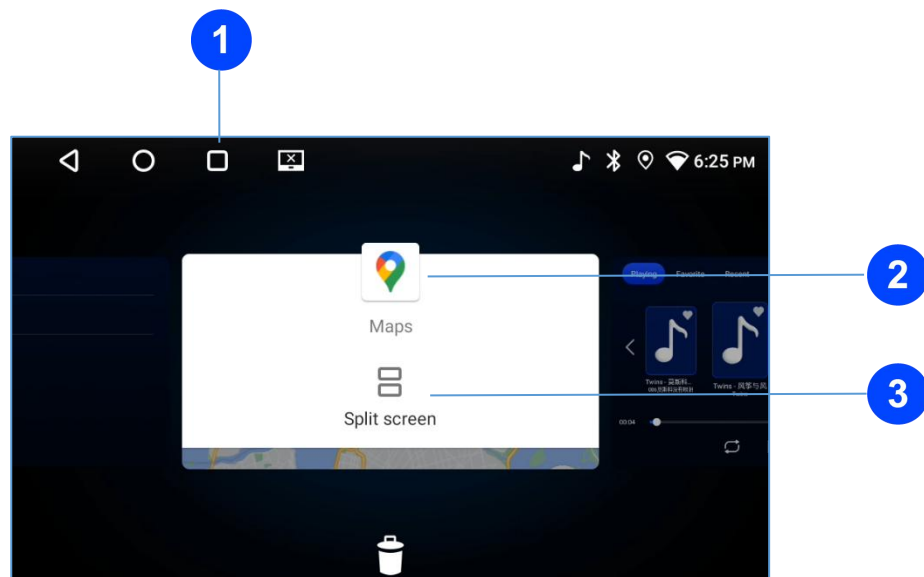

You can display two applications on one screen at the same time.

Tap **1** to enter the task menu interface, tap **2** to display the split screen button, and finally tap **3** to open the split screen display.

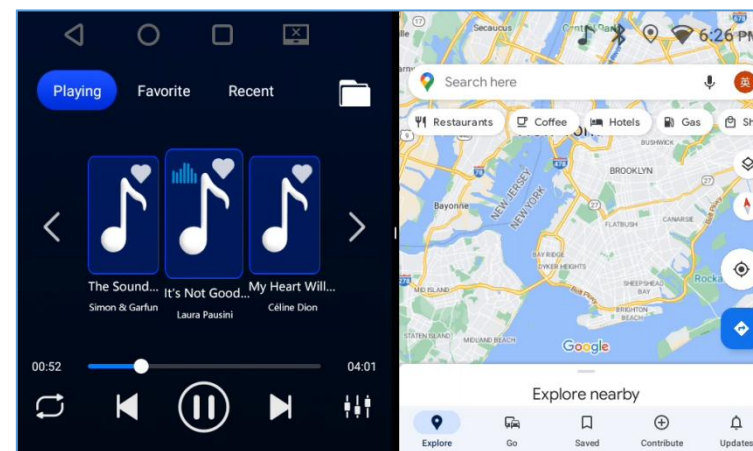

! CAUTION

Support split screen applications: Radio, Music, Navigation, Bluetooth music, Setting.

Unsupported applications cannot enable split screen display.



17、Settings

1、WLAN

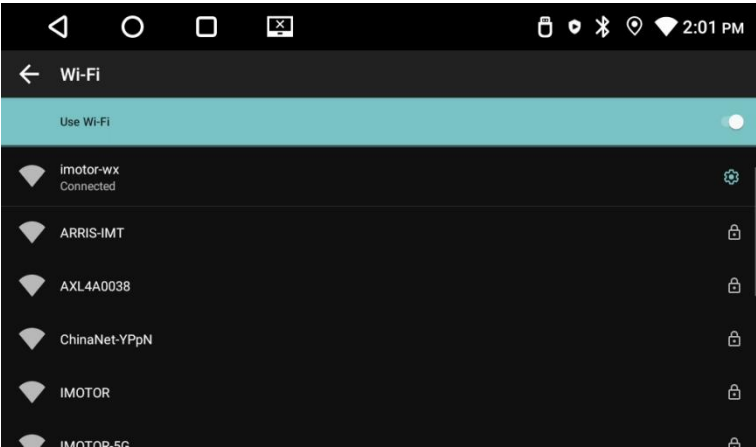

a、WLAN

Turn on the WLAN switch, start scanning for nearby WLAN networks, and list the available networks.

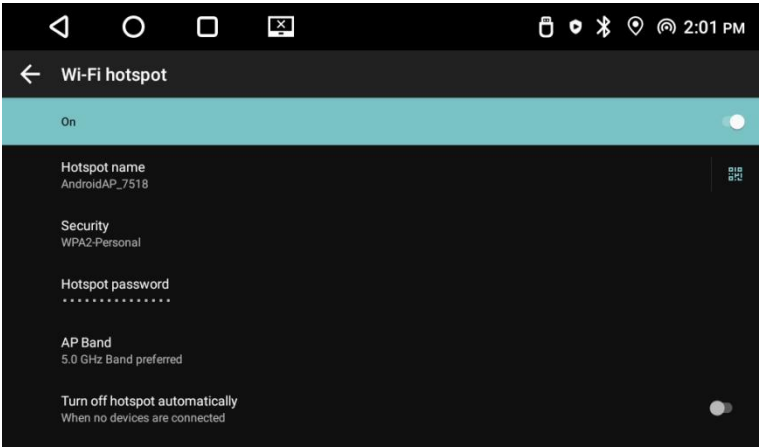

b、Wi-Fi hotspot

Turn on the Wi-Fi hotspot switch, nearby devices can connect to the system via WiFi, enabling shared network access and interconnectivity.

2、Bluetooth

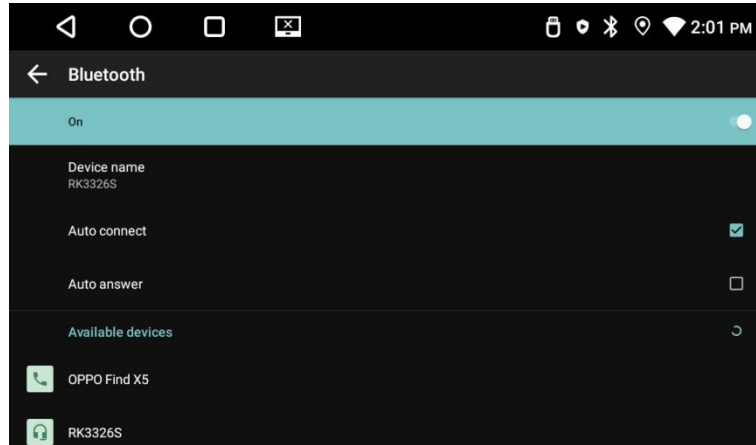

a. Turn on the Bluetooth switch and start scanning for nearby Bluetooth devices.

If there are matched Bluetooth devices nearby and the "Auto connect" option is enabled, the system will automatically connect to those devices.

b. If it is the first time pairing, a Bluetooth connection request pop-up will appear on the mobile device.

Tap to "Pair" to establish the connection.

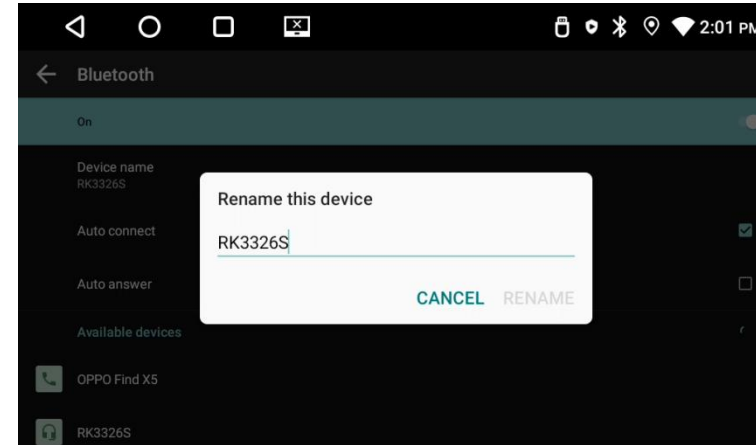

c. Tap to the "Device Name" and a pop-up keyboard will appear, allowing you to rename the device.

3、Sound

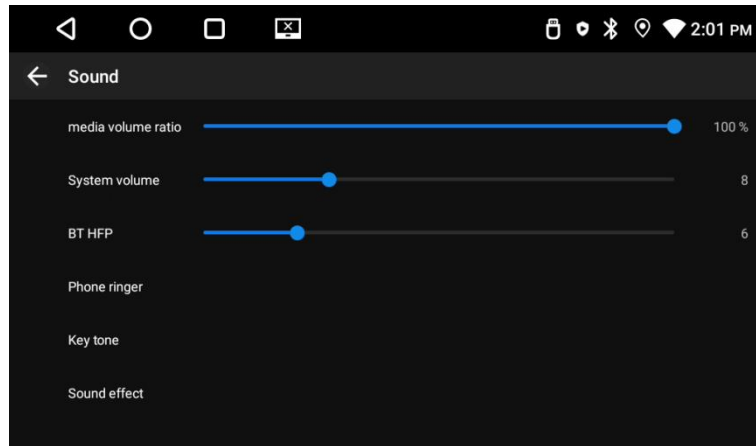

You can to set the: Media volume ratio、 System volume、 BT HFP、 Phone ringer ,etc.

You can set your favorite phone ringer and keypad tone.

4、Display

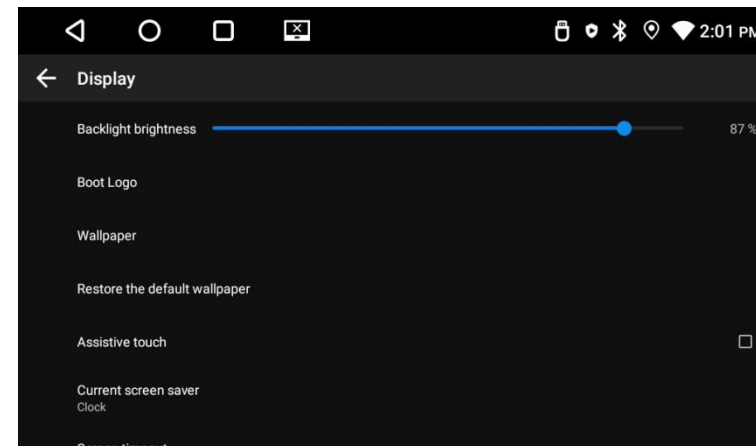

You can to set the: Backlight brightness、 Boot Logo、 Wallpaper、 Assistive touch ,etc.

You can set your favorite picture as wallpaper.

5、Vehicle setting

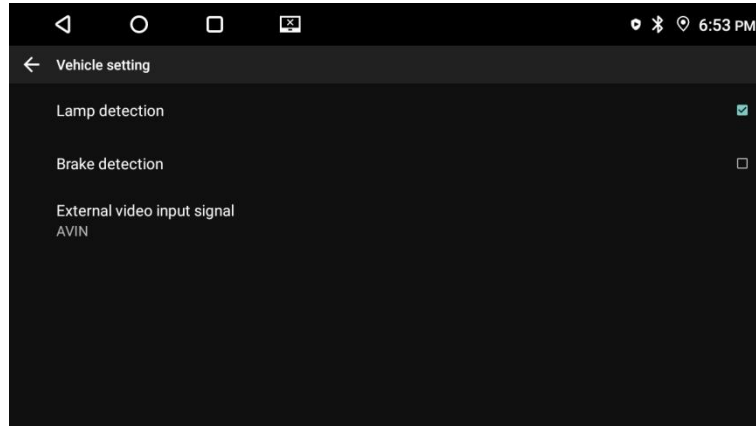

After enabling the lamp detection, when the vehicle's lamp are detected to be turned on, the touchscreen buttons increase the brightness.

Upon enabling the brake detection, when the vehicle's brake is detected to be disengaged, the system prohibits video playback.

6、Navigation

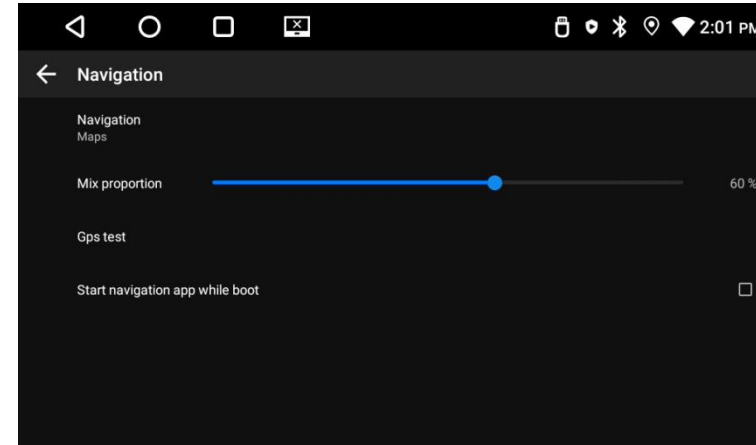

You can to set the: Mix proportion、Gps test、Start navigation app while boot ,etc.

7、Languages and input

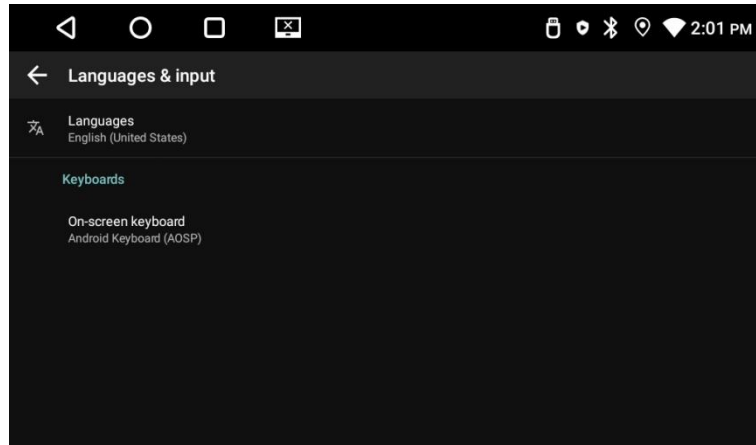

You can to set the: Languages and Keyboards.

You can add a language and arrange preferred language order by dragging them.

The default keyboard is Android Keyboard (AOSP).

You can manage the installed keyboards.

8、Date and time

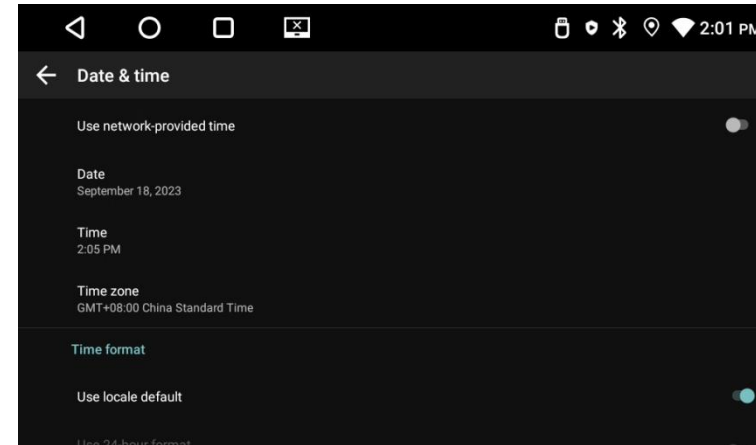

You can to set the: Date、 Time、 Time zone、 Time format,etc.

You can select to set date, time and time zone using this sub-menu.

Use Automatic unless you need to override the network values.

Use 24-hour format: Select to set 24-hour formats on or off.



Settings

9、Accounts

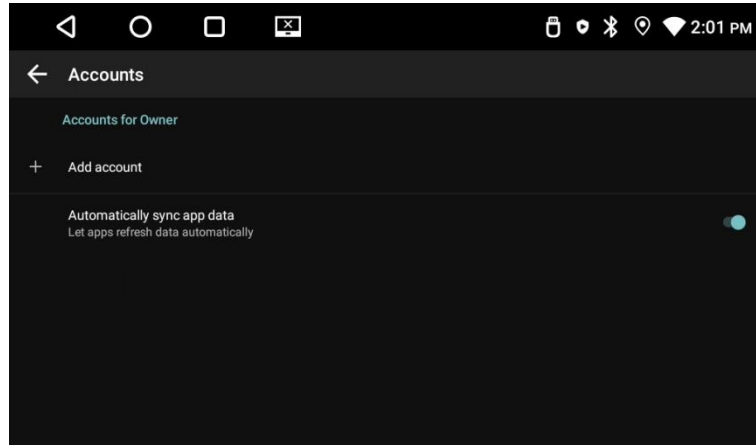

You can tap to "Add Account" to sign in to your Google account.

You can enable automatic sync app data, which will sync the related app data logged in with your Google account to the cloud.

10、System

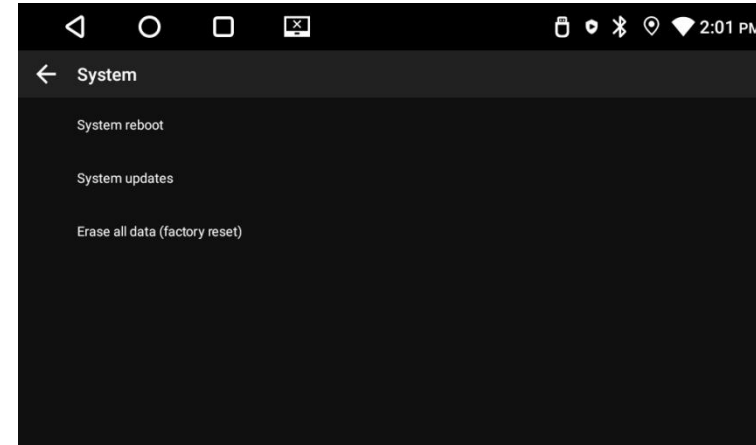

You can tap to "System Restart" to perform a system shutdown and restart.

You can tap to "System Upgrade" to check for upgrade packages and proceed with the upgrade if any are found.

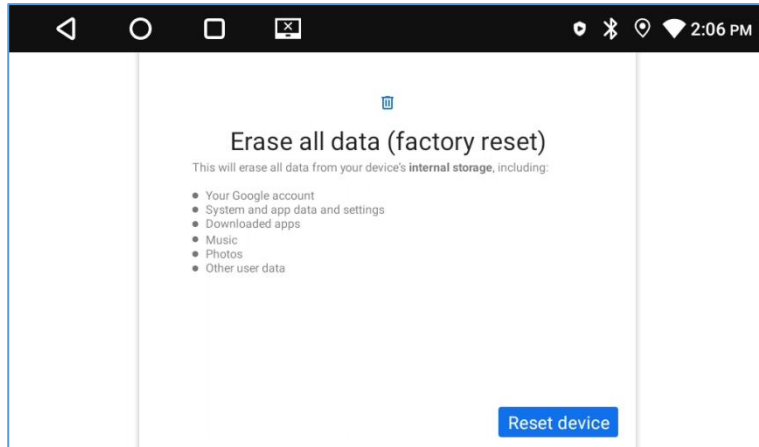

Factory reset: Erases all data from the internal storage of the device, including Google accounts, system and app data and settings, and other user data.

11、About device

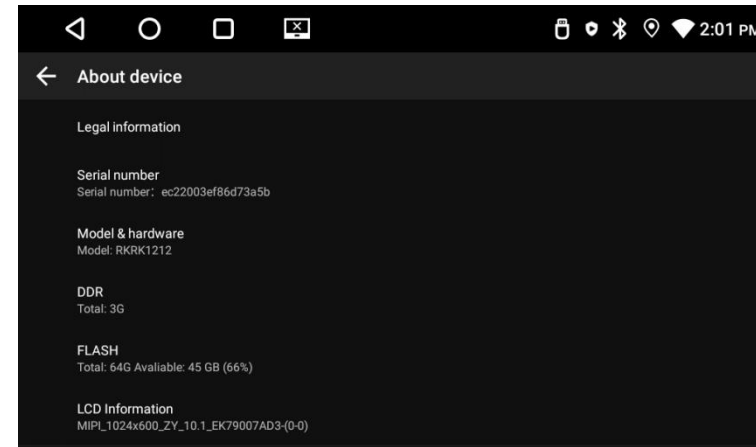

Display the device information, such as: Serial number、Model & hardware、DDR、FLASH、LCD Information, etc.



18、Rearview camera



After the vehicle is put into R gear, the system interface displays a reverse camera screen.

The trajectory line is divided into three sections: 0.5m, 2m, and 3m, with colors of red, yellow, and green respectively.



Attentio

Do not rely solely on the rearview camera system. When driving, please ensure the surroundings are safe. The rearview camera system is only for assistance.

FCC Warning:

This equipment has been tested and found to comply with the limits for a Class B digital device, pursuant to part 15 of the FCC Rules. These limits are designed to provide reasonable protection against harmful interference in a residential installation. This equipment generates, uses and can radiate radio frequency energy and, if not installed and used in accordance with the instructions, may cause harmful interference to radio communications. However, there is no guarantee that interference will not occur in a particular installation. If this equipment does cause harmful interference to radio or television reception, which can be determined by turning the equipment off and on, the user is encouraged to try to correct the interference by one or more of the following measures:

- Reorient or relocate the receiving antenna.
- Increase the separation between the equipment and receiver.
- Connect the equipment into an outlet on a circuit different from that to which the receiver is connected.
- Consult the dealer or an experienced radio/TV technician for help.

Caution: Any changes or modifications to this device not explicitly approved by manufacturer could void your authority to operate this equipment.

This device complies with part 15 of the FCC Rules. Operation is subject to the following two conditions:

(1) This device may not cause harmful interference, and (2) this device must accept any interference received, including interference that may cause undesired operation.

This equipment complies with FCC radiation exposure limits set forth for an uncontrolled environment. This equipment should be installed and operated with minimum distance 20cm between the radiator and your body.