

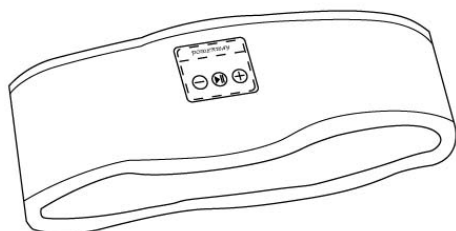

Bluetooth Headband



Manual

We added the concept of high-definition audio speaker design to the headband. In addition to daily use, it can also create a private space for you. You can play music, watch videos and movies while using the headband without wearing additional headphones. This is also a good gift for meditation. Suitable for family, work, travel, leisure, exercise and sports;

1、Instructions for using

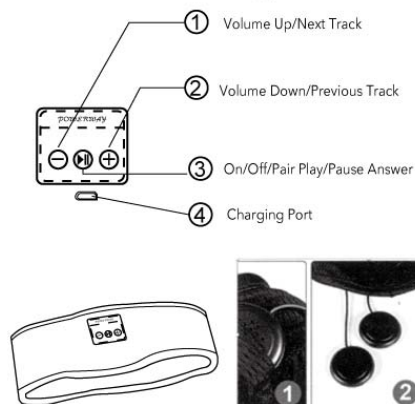

1

2、Assembly diagram



A: Through the direction of Pu Leather Keys, determine the direction of the motherboard and the three assembly points around the ear.
B: Pay attention to the inside and outside of the fabric, the speaker outlet and the motherboard plane (not the convex surface of the button) are inside the fabric close to the skin.
C: The positions of the 3 assembly points correspond to the 3 dedicated wrapping positions of the fabric, and enter from the same direction of the headscarf.
D: The order of entrance is suggested as follows: the left ear speaker first, then the Bluetooth motherboard, and finally the right ear.
E: In order to ensure the wrapping of the main board and the speaker, please enter from the small opening of the unlocking button.
F: To take out the 3 assembly parts, follow the above instructions and operate in reverse.

3、Host performance parameters

Bluetooth master	Actions 3015
Bluetooth version	V5.3
Bluetooth distance	≥10 m
Charging interface	Micro USB, 5V-1A
Recharging current	100MA
Charging time	2 hours
Playing time	About 14 hours(60% volume,Light music)

2

4、Horn performance

Bandwidth 20-3000 hz,
32Ω resistance value ,
Japanese Tony Copper Wire coil.

5、Fabric composition:

95% polyester, 5% SPANDEX.

6、Instructions

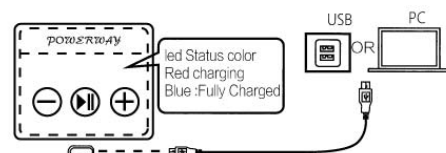

I.Turn it on: Long press the Middle Button for 1.5 seconds, and the machine goes into pairing mode, at which point the red and blue lights flash alternately;
II: Search for Bluetooth matching names: H01 by Swaytail;
III. The key "+" and the key "-": Click the "+" key to increase the volume; Click and long press the "+" key for the next song; Click the "-" key to reduce the volume; Click and long press the "-" key for the last song;
IV. Charge indication: Usually there's a battery indicator on the phone, different systems, different phone locations;
V. Turn it off: Press function key for 5 seconds.

3

FCC Warning Statement Changes or modifications not expressly approved by the party responsible for compliance could void the user's authority to operate the equipment.

This equipment has been tested and found to comply with the limits for a Class B digital device, pursuant to Part 15 of the FCC Rules.

These limits are designed to provide reasonable protection against harmful interference in a residential installation.

This equipment generates uses and can radiate radio frequency energy and, if not installed and used in accordance with the instructions, may cause harmful interference to radio communications.

However, there is no guarantee that interference will not occur in a particular installation.

If this equipment does cause harmful interference to radio or television reception,which can be determined by turning the equipment off and on, the user is encouraged to try to correct the interference by one or more of the following measures:

- Reorient or relocate the receiving antenna.
- Increase the separation between the equipment and receiver.
- Connect the equipment into an outlet on a circuit different from that to which the receiver is connected.
- Consult the dealer or an experienced radio/TV technician for help.

4

This device complies with part 15 of the FCC Rules.

Operation is subject to the following two conditions:

- (1) This device may not cause harmful interference, and
- (2) this device must accept any interference received, including interference that may cause undesired operation.

The device has been evaluated to meet general RF exposure requirement.

The device can be used in portable exposure condition without restriction.

5