



8" 3-WAY P.A. SPEAKER
model: 4001943
USER MANUAL



PACKING CONTENTS

- 1x speaker
- 1x remote control
- 1x user's guide
- 1x power cable

SPECIFICATIONS

- AC input: 110V, 50/60Hz
- Subwoofer: 1x8" woofer, 30oz(120mm) 1.5' (38mm) KSV voice coil
- Tweeter: 25mm
- Middle range: 3" woofer x2
- Sensitivity: 98dB (+/-3dB)
- With MP3, USB, Bluetooth
- DSP function
- Power: 250W
- Woofer with light

PANEL SPECIFICATIONS



- LED display
- DSP: press this button for DSP function on & off
- USB: USB input with MP3 FILE
- BASS
- TREBLE
- MIDDLE
- EQ: press EQ button to select different EQ mode
- Stop: press song to stop current music
- Play/pause
- Mode: USB/Bluetooth/ AUX-in & FM
- ECHO- & ECHO+: press these 2 button to increase & decrease ECHO effect
- MIC- & MIC+: microphone volume level control
- PRE & VOL-: press button to previous song, press & hold for VOL-
- NEXT & VOL+: press button to next song, press & hold for VOL+
- FM- & FM+: press button to previous next FM station

CONTROL PANEL

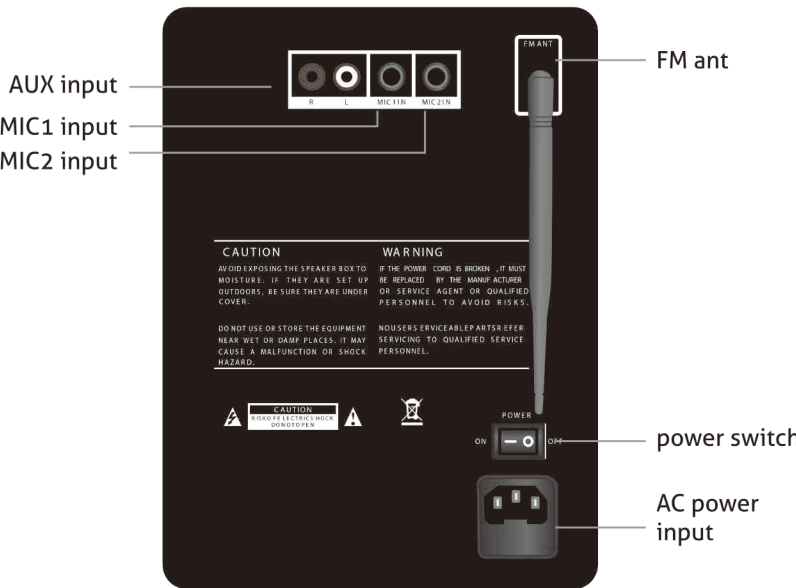

REMOTE CONTROL

1

2

3

4

5

6

7

8

9

10

11

12

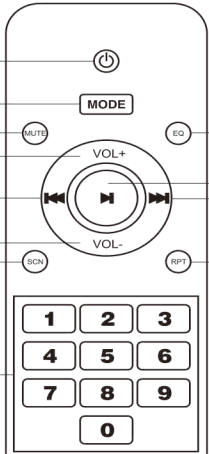

1. ON/OFF switch
only works when speaker box AC switch turn on, remote control ON/OFF switch are used to turn on & turn off MP3 player
Turn on and turn off the MP3 player display
2. Mode button
Switch between audio source
3. Mute button
4. Volume increase button
5. Previous button
6. Volume decrease button
7. Radio station scanning button
Auto scan and store FM stations
8. Digits buttons
9. EQ buttons
10. Play/pause button
11. next button
12. repeat button
repeat one/repeat all/folder & random

CAUTION

- Avoid exposing the speaker box to moisture. If they are set up outdoors, be sure they are undercover
- Do not use or store the equipment near wet or damp places. It may cause a malfunction or shock hazard
- If the power cord is broken, it must be replaced by the manufacturer or service agent or qualified personnel to avoid risks.
- To reduce the risk of fire electronic shock, do not expose this equipment to rain or moisture
- Clean only with a soft, dry cloth

CAUTION:

This device complies with Part 15 of the FCC Rules. Operation is subject to the following two conditions:
(1) this device may not cause harmful interference, and
(2) this device must accept any interference received, including interference that may cause undesired operation

This device has been tested and found to comply with the limits for a Class B digital device, pursuant to Part 15 of the FCC Rules. These limits are designed to provide reasonable protection against harmful interference in a residential installation. This device generates, uses and can radiate radio frequency energy and, if not installed and used in accordance with the instructions, may cause harmful interference to radio communications.
However, there is no guarantee that interference will not occur in a particular installation. If this device does cause harmful interference to radio or television reception, which can be determined by turning the device off and on, the user is encouraged to try to correct the interference by one or more of the following measures:
--Reorient or relocate the receiving antenna.
--Increase the separation between the device and receiver.
--Connect the device into an outlet on a circuit different from that to which the receiver is connected.
--Consult the dealer or an experienced radio/TV technician for help

Changes or modifications not expressly approved by the party responsible for compliance could void the user's authority to operate the equipment