

成品尺寸：78x120mm

英文



Wireless Microphone

Manual

Product Size

1) Microphone

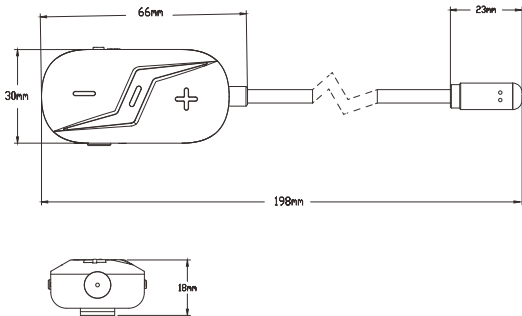

2) Receiver

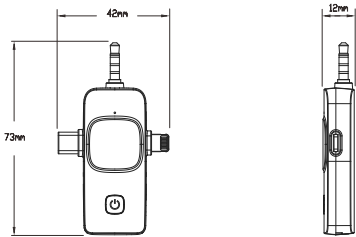

1

Function Introduce

1) Microphone

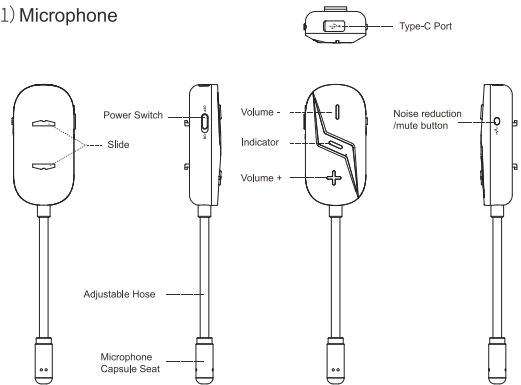

Function	Operation	Indicator
Turn On	Turn the switch to the ON position	Blue light flashing
Turn Off	Turn the switch to the OFF position	No light flashing
Pairing with RX	Automatic pairing and connection between TX and RX when turned on	Indicator long light
Disconnect	RX turned off or TX turned off	Indicator flashing
Noise Reduction	Long press the button for 2 seconds	Green indicator long light
Mute	Short press the button	Red indicator long light
Volume +	Short press the volume up button to increase one level; Min-Medium-Max	/
Volume -	Short press the volume down button to lower one level; Max-Medium-Min	/
Low battery Alarm	Voltage lower than 3.3V	Red indicator flashing
Low battery shutdown	Automatically shut down when voltage drops below 3.1V	No light flashing
Charging	Plug in a 5V charger	When charging red indicator lng light and goes off when fully charged.

2

2) Receiver

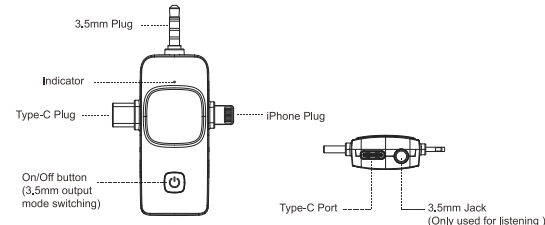

Note:
1.Pay attention to the below issues when using a 3.5mm socket:
1) When using it on 3-pole sockets such as power amplifiers, it is necessary to select the corresponding power amplifier mode before inserting it for use.
2) When using it on 4-pole sockets such as a mobile phone or computer, you need to select the corresponding phone mode before inserting it for use.
3) When using it on 3-pole sockets such as camera devices, you need to select the corresponding camera mode before inserting it for use.
2. When using Type-C or iPhone socket, any mode can be used.
3.TX does not have noise reduction by default. It needs to be manually selected for noise reduction function and does not have memory function.
After shutting down and restarting, the default state will be restored.

Function	Operation	Indicator
Turn On	Press the power button for 3 second	Red-Green indicator flashing alternately
Turn Off	Press the power button for 3 second	All lights go off
Disconnect	RX turned off or TX turned off	Red-Green indicator flashing alternately
Pairing with RX	Automatic pairing and connection between TX and RX when turned on	Green and Blue indicators long light
Power Amplifier mode	Click the button	Green indicator long light
Mobile Mode	Click the button	Blue indicator long light
Camera Mode	Click the button	Green and Blue indicators long light
Low Power	Voltage lower than 3.3V	Red light flashing
Charging	Charging	Red light long light on
	Fully charged	Red indicator goes out

3

Operation

Step 1: Turn the microphone power switch to the ON position and turn it on. The blue indicator light will flash, indicating successful startup.It can automatically pair with the receiver, and the indicator light will remain on after successful pairing.

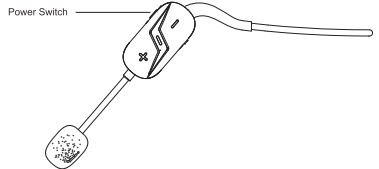

Step 2: Press and hold the power button to turn on the device. The red and green lights will flash alternately to indicate successful startup. After automatic pairing with the transmitter, it will indicate The light stays on, select the corresponding usage mode, and insert the corresponding plug of the receiver and device into the device for use.

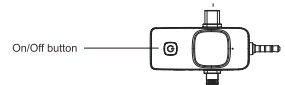
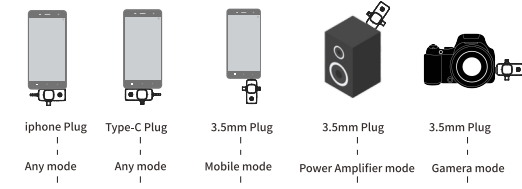

4

Step 3: After successful matching, the receiver selects the corresponding mode to connect to the device and can use the microphone to receive audio.

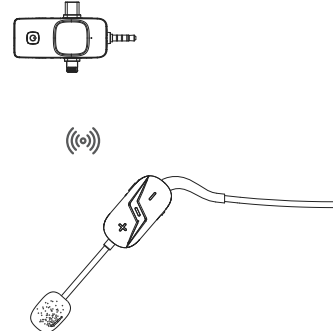
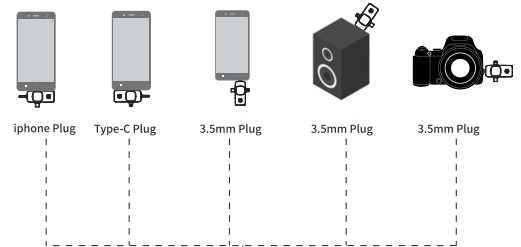

5

Specifications

Microphone Type	Condenser Capsule	Battery Capacity of Transmitter	200mAh
Directivity	Omnri-directional	Usage Time of Transmitter	About 6H
Sensitivity	~33±3dB	Battery Capacity of Receiver	110mAh
Impedance	2,2KΩ	Usage Time of Receiver	About 6H
S/N	64dB	Using Distance	>10m
Frequency Response	70Hz-20KHz		

Packing List

Microphone (With headbow)	X1
Receiver	X1
Windscreen Sponge	X1
Charging Cable	X1
Manual	X1

6

FCC Warning Statement: Changes or modifications to this unit not expressly approved by the party responsible for compliance could void the user's authority to operate the equipment. This equipment has been tested and found to comply with the limits for a Class B digital device, pursuant to Part 15 of the FCC Rules. These limits are designed to provide reasonable protection against harmful interference in a residential installation. This equipment generates, uses and can radiate radio frequency energy and, if not installed and used in accordance with the instructions, may cause harmful interference to radio communications.

However, there is no guarantee that interference will not occur in a particular installation. If this equipment does cause harmful interference to radio or television reception, which can be determined by turning the equipment off and on, the user is encouraged to try to correct the interference by one or more of the following measures:
- Reorient or relocate the receiving antenna.
- Increase the separation between the equipment and receiver.
- Connect the equipment into an outlet on a circuit different from that to which the receiver is connected.
- Consult the dealer or an experienced radio/TV technician for help.

This device complies with Part 15 of the FCC Rules. Operation is subject to the following two conditions: (1) this device may not cause harmful interference, and (2) this device must accept any interference received, including interference that may cause undesired operation.

FCC Radiation Exposure Statement
The device has been evaluated to meet general RF exposure requirement. The device can be used in portable exposure condition without restriction.



Made in China