

User Manual

用户手册

After unpacking, please confirm that the accessories are complete.

开箱后请确认配件齐全



Printer * 1
夹子说打印机*1

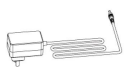

Power Adapter *1
电源适配器*1



Paper Tray *1
放纸架*1



User Manual * 1
说明书*1

Power on the printer before use.

使用前打印机通电

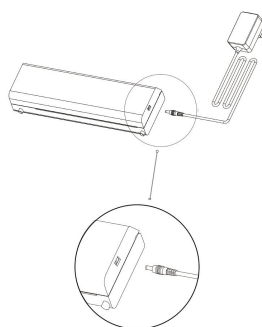

Tip: After the printer is directly connected to the power supply, it will automatically turn on!

提示: 打印机直接连接电源后, 将会自动开机!

Turn on the print service for the first time

首次使用打开打印服务

1. Download APP
下载APP

Scan the QR code on the device to download.
扫描设备上的二维码即可下载

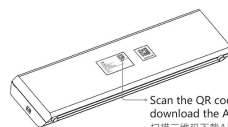

Scan the QR code to download the APP.
扫描二维码下载APP

2. Click to add device
点击添加设备

Scan the QR code of "Scan code to add device" at the bottom of the device. (This process needs to turn on the Bluetooth of the mobile phone.)
扫设备底部"扫码添加设备"二维码(此过程需打开手机蓝牙)

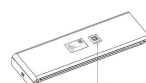
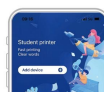

Scan the QR code to bind device.
扫码绑定设备

Easy to link, free to print.

轻松链接打印更自由



1. Supports file printing of chat software such as WeChat, QQ, DingTalk, etc.
支持微信、QQ、钉钉等聊天软件的文件打印

2. Support printing in DOC, JPG, PDF, XLS, PPT and other formats.
支持DOC、JPG、PDF、XLS、PPT等格式打印

3. Support mobile phones to print documents.
支持手机文件打印

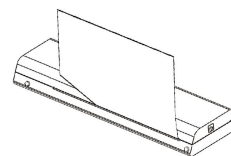

Prompt

提示:

Roll Paper: After completing a print, simply manually spread out the paper along the edge of the printer's casing to keep it neat and aligned.
卷纸: 完成一张打印后, 手动将纸沿设备的上壳边缘整齐展开即可

Folding Paper: After completing a print, simply manually tear the paper neatly along the tear line to separate it.
折纸: 完成一张打印后, 手动将纸沿撕裂线整齐撕开即可

Maintenance and replacement
of consumables.

使用维护更换耗材

Paper Roll Replacement Process:
卷纸更换流程:

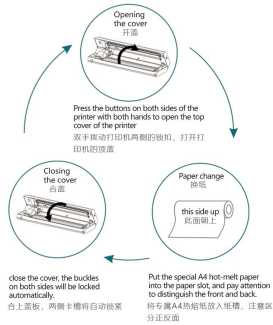

Folding Paper Replacement Process:
折叠纸更换流程:

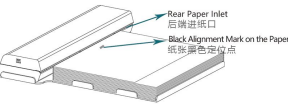

- 1.Place the A4 folded paper flat on the paper tray;
将A4折叠纸平放在放纸架上;
- [Precautions] ①Place the side with the black alignment mark facing down;②Place the end with the black alignment mark close to the rear paper inlet of the printer.
[注意事项] ①带有黑色定位点的面向下放置;②带有黑色定位点的这端靠近打印机后端进纸口。
- 2.Insert the first sheet of paper through the rear paper inlet, aligning the front edge of the paper with the front paper outlet of the printer.
把第一张纸从后进纸口引入，纸张前缘和打印机前缘出纸口平齐即可。

Hazardous Substances Statement.

有害有害物质申明

Part name 部分名称	Harmful substances 有害物质					
	铅 (Pb)	汞 (Hg)	镉 (Cd)	六价铬 (Cr6+)	多溴联苯 (PBBs)	多溴二苯醚 (PBDEs)
shell 外壳	○	○	○	○	○	○
Internal accessories 内部配件	○	○	○	○	○	○
circuit board 电路板	○	○	○	○	○	○
Internal cables 内部线缆	○	○	○	○	○	○

○ Indicates that the content of the hazardous substance in all homogeneous materials of the part is below the limit requirement specified in GB/T 26125-2011 "Limit Requirements for Restricted Substances in Electrical and Electronic Products".

表示该有害物质在该部件所有均质材料中的含量均在GB/T 26125-2011《电子电气产品中限制物质的限量要求》规定的限量要求以下。

X Indicates that the content of the hazardous substance in at least one homogeneous material of the component exceeds the limit requirement specified in GB/T 26125-2011 "Limit Requirements for Restricted Substances in Electrical and Electronic Products".

表示该有害物质至少在该部件的某一均质材料中的含量超过GB/T 26125-2011《电子电气产品中限制物质的限量要求》规定的限量要求。

③ This symbol is the pollution control symbol of electronic information products, indicating that the environmental protection use period of this product is 10 years, and it can be recycled and should not be discarded at will.

该符号是电子信息产品污染控制标志，标识本产品的环保使用期限为10年，并且可以回收利用，不应随意丢弃。

Note: The illustrations of products, accessories, user interface, etc. in this manual are schematic diagrams and are for reference only.

提示:本说明书中的产品、配件、用户界面等插图均为示意图,仅供参考。

Due to product updates and upgrades, there may be slight differences between the actual product and the schematic diagram, please refer to the actual product.

由于产品的更新和升级，产品实物与示意图可能略有差异，请以实物为准。

For the latest product information, please contact the official customer service.

如需获取产品最新资讯,请与客服联系。

product information

产品信息

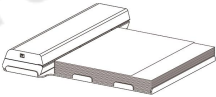

model: portable printer 型号: 便携式打印机	
device size: 300*85*40mm 机身尺寸:300*85*40mm	working voltage: 8.4V/3A 工作电压:8.4V/3A
Printing width: 210mm 打印宽度:210mm	Printing precision: 200DPI 打印精度:200DPI
printing speed: 2 sheets of A4/min 打印速度:2张A4/min	print mode: Thermal printing 打印方式: 热敏打印
Connection method: Bluetooth 连接方式: 蓝牙	Net weight of bare metal: 0.58kg 裸机净重: 0.58kg
Body color: Pearl white/Macaron pink/Knight Grey/Sea Sky Blue 机身颜色: 珍珠白/马卡龙粉/骑士灰/海空蓝	

Precautions

注意事项

1.Do not pull during printing to avoid damaging the print head.
请勿在打印过程中拉扯，以免损坏打印头。

2.The printing process may cause the print head to overheat, please do not touch it directly to prevent scalding.
打印过程可能造成打印头过热,请勿直接触碰，以防烫伤。

3.Do not use it near a fire source, outdoors under the hot sun or other hot places.
请勿在火源旁、户外烈日下或其它炎热地方使用。

4. Do not use this product in areas where it may be exposed to liquids such as water or oil, or in areas with high humidity and dust.
请勿在可能接触到水、油等液体或高湿度、多灰尘地带使用本产品。

5. Please be sure to use the official power adapter, otherwise it may cause dangerous situations such as overheating and fire on the printer.
请务必使用官方附带的电源线进行充电使用,否则可能会导致打印机过热、起火等危险情况。

6. A three-pack policy is not available if a machine malfunctions due to the non-use of official printing paper
若因未使用官方指定打印纸而产生机器故障，将无法享受三包政策。

FCC Requirement

changes or modifications not expressly approved by the party responsible for compliance could void the user's authority to operate the equipment.

This device complies with Part 15 of the FCC Rules. Operation is subject to the following two conditions:

- (1) this device may not cause harmful interference, and
- (2) this device must accept any interference received, including interference that may cause undesired operation.

Note: This equipment has been tested and found to comply with the limits for a Class B digital device, pursuant to Part 15 of the FCC Rules. These limits are designed to provide reasonable protection against harmful interference in a residential installation. This equipment generates, uses, and can radiate radio frequency energy, and if not installed and used in accordance with the instructions, may cause harmful interference to radio communications. However, there is no guarantee that interference will not occur in a particular installation. If this equipment does cause harmful interference to radio or television reception, which can be determined by turning the equipment off and on, the user is encouraged to try to correct the interference by one or more of the following measures:

- Reorient or relocate the receiving antenna.
- Increase the separation between the equipment and receiver.
- Connect the equipment into an outlet on a circuit different from that to which the receiver is connected.
- Consult the dealer or an experienced radio/TV technician for help.

This equipment complies with FCC radiation exposure limits set forth for an uncontrolled

environment. This equipment should be installed and operated with a minimum distance of 5mm

between the radiator & your body. This transmitter must not be co-located or operating in

conjunction with any other antenna or transmitter.