

ORALUCE

Smart Light Bulb

User Manual

English Version

Dear Customer,
Thank you for choosing ORALUCE Smart LED Bulb. This introduction will help you install and use your new bulb correctly. Please read them carefully before using them and keep them for future reference. If you need further assistance, please contact our online customer service via email(penny@oraluce.com). We wish you lots of fun with your new bulbs!

Package contents

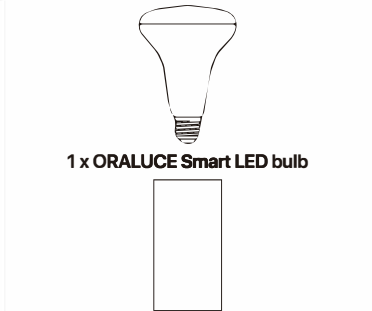

Parts of the LED bulb

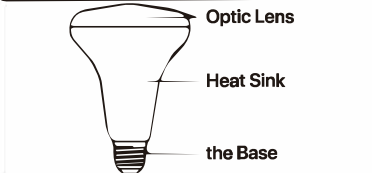
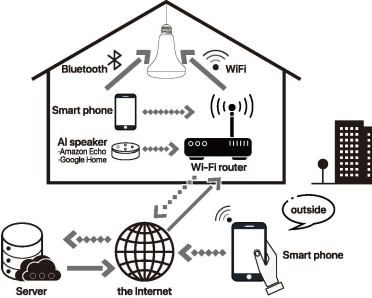
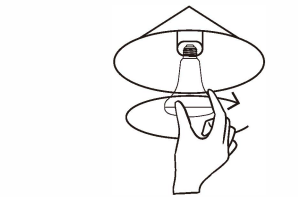

Image of using "Smart Life"



How to install?

01.Installing the light bulb
-Install the bulb and turn on the power



Note:
(For indoor use only, do not expose the bulb to water or moisture)
1.Make sure the power is off during installation remove or examine the bulb.
2.Do not use this product with a dimmer (for example a desk lamp with a dimmer) to avoid damaging the product.
3.Do not turn the bulb on and off at short intervals, as this will shorten the life of the bulb.
4.Make sure that the available voltage is between AC120V, 50/60Hz.
5.Do not use this product in a wet environment
6.Do not use the bulb in a narrow, unventilated lampshade as it may cause weak signals or heat dissipation problems.

How to use it?

Download APP and registration



Download the "Smart Life" APP from the APP Store (for IOS) and Google Play Store (for Android) and register with your email/IOS/ Google account.

Step 1. Connect the light with your Smartphone. Open the "Smart Life"app and log in with your registered account. Click on "Add Device" to enter the add device page. choose the "Add Manually" and "Lighting"option and select "Light Source (Wi-Fi)" from the list of "Light Source "to go to the light connection page. Step 2. Connect the smart bulb to your Wi-Fi. Select the 2.4GHz Wi-Fi network and enter password,click "Next", follow the steps below to connect your device:
①Power on the bulb;
②Turn on-off-on-off-on-off-on-off-on the smart bulb quickly, and wait a few seconds;
③Ensure the light is blinking rapidly.

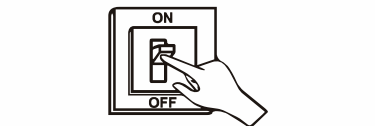

Note: If the device does not blink rapidly, turn off the power for 10 seconds and repeat the above steps. Confirm the light is blinking rapidly, press "Next" go to Adding device...

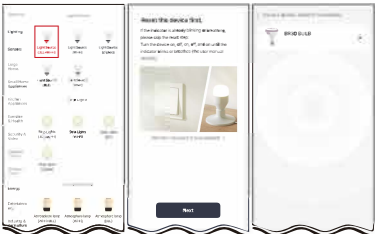

Step 3the smart bulb will be displayed on the home page of the app after device added successfully. You can click "Switch" to turn on/off the bulb, click "Bright" to adjust the brightness of the bulb, or click "Color Temp" to adjust the color temperature of the bulb.

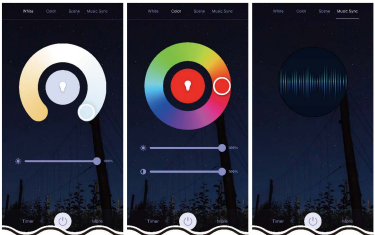

Step 4. click "Wi-Fi Bulb" to enter the detailed "Wi-Fi Bulb" operation page. You can adjust the light color according to your preference in this page, or use the scenes defined by the APP (you can also edit and modify the parameters of each scene according to your preference). You can also set the automatic on/off time for the smart bulb by clicking the "left time" and "Schedule".

Step 5. Use your voice to control the smart bulb You can open the sound control function by Clicking the sound icon on the top right corner of the "Home" page, then you can control the bulb with your voice through your phone. The Smart bulb provides a variety of third-party voice support, such as Alexa, Google Assistant and other common smart speakers. You can find these functions in the "Me" page. In the "Smart" page, click the "+" on the upper right corner, the smart bulb can be adjusted automatically according to the weather, device status, time and other conditions. Tip: If you have added more smart bulbs, you can also create the bulbs group through "Home Management" to control multiple bulbs at same time. More creative uses are waiting for you to explore...

Instructions

- 1.Before using this product, pls make sure that the voltage is suitable for the operating voltage of this product. If the voltage used is out of the Specified voltage, may damage the product and also cause safety risks.
- 2.Do not disassemble this product, as light-emitting diodes cause damage to eyes.
- 3.The bulb overheats while working. Do not use it in a closed container for an extended period. Provide sufficient ventilation for the bulb to allow for heat dissipation.
- 4.Make sure the power is off before Installation to avoid the risk of electric shock.
- 5.For indoor use only. Use only in dry places.
- 6.The light source of this product is irreplaceable light- emitting diodes (LED).
- 7.Do not use this product together with emergency exits or emergency lighting.
- 8.This bulb can not work properly when connected to a standard (incandescent) dimmer or dimmer control.
9. If the weight of the new bulb is obviously larger than the old bulb to be replaced, pls be aware that the added weight will decrease the Mechanical stability of some lighting fixtures and bulb holder.

Product parameters

Brand: ORALUCE	Product: Wi-Fi Smart Bulb
Bulb type: LED	Bulb base: E26
Power:12W	Dimmable: YES
Dimension:3.7in*5.3in	Luminous flux:1280LM
Voltage:AC120V 50/60Hz	
Color: RGB+CW (2700-6500K)	
Color rendering index:≥80	
Wireless standardize 802.11 b/g/n	
Wireless type: Wi-Fi 2.4GHz&Bluetooth	
Adjustable color temperature: YES	

Warranty

ORALUCE Smart Bulb has a 60-day free replacement warranty. Within 30 days of purchase, the 18-month extended warranty can be registered for free at: penny@oraluce.com

Q&A

Q: My LED light bulb cannot be connected to the network.
A: If you cannot connect to the network, you may have connected to a network in the 2.4GHz band network. Set the 2.4GHz band network to different names on the Wi-Fi router settings page, and then connect to the 2.4GHz band network.
Q: Can the LED light bulb used in the socket with dimming function?
A: It cannot be used for dimming function equipment.



Scan the QR code for detailed use of the "Smart Life" app

FCC Statement
This equipment has been tested and found to comply with the limits for a ClassB digital device, pursuant to part 15 of the FCC rules. These limits are designed to provide reasonable protection against harmful interference in a residential installation. This equipment generates, uses and can radiate radio frequency energy and, if not installed and used in accordance with the instructions, may cause harmful interference to radio communications. However, there is no guarantee that interference will not occur in a particular installation. If this equipment does cause harmful interference to radio or television reception, which can be determined by turning the equipment off and on, the user is encouraged to try to correct the interference by one or more of the following measures: -Reorient or relocate the receiving antenna. -Increase the separation between the equipment and receiver. -Connect the equipment into an outlet on a circuit different from that to which the receiver is connected. -Consult the dealer or an experienced radio/TV technician for help. To assure continued compliance, any changes or modifications not expressly approved by the party.
Responsible for compliance could void the user's authority to operate this equipment. (Example- use only shielded interface cables when connecting to computer or peripheral devices).
This equipment complies with Part 15 of the FCC Rules. Operation is subject to the following two conditions:
(1) This device may not cause harmful interference, and
(2) This device must accept any interference received, including interference that may cause undesired operation.
FCC Radiation Exposure Statement:
The equipment complies with FCC Radiation exposure limits set forth for uncontrolled environment. This equipment should be installed and operated with minimum distance 20cm between the radiator and your body
To assure continued compliance, any changes or modifications not expressly approved by the party 1 Responsible for compliance could void the user's authority to operate this equipment

Manufacturer
Chongqing Little Jungle Network Technology Co., Ltd.
Manufacturer Address
No. 319, Hailer Road, Jiangbei District, Chongqing, China
Tel
+8613567911647
E-mail
penny@oraluce.com