

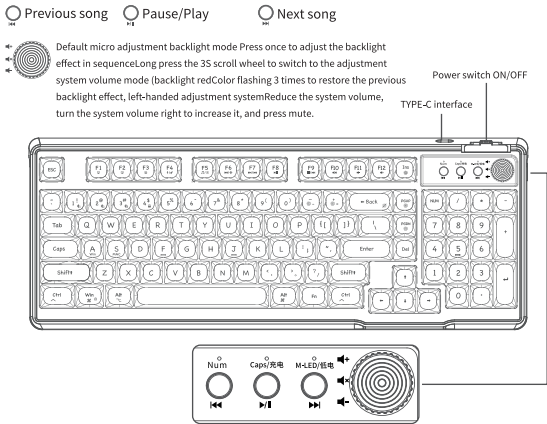

# V98

instruction

- 1、 The product is applicable to the keyboard, which adopts Bluetooth 5.0 standard/2.4G standard - two working modes and is connected to related devices for operation. The 2.4G mode of the product can run on computer systems such as Win2000, WindXP, Vista, Win7, Win8, Win10, MAC, etc. Bluetooth mode can run on theBluetooth version of mobile phone system.
- 2、 Hardware requirements include a Bluetooth 5.0 standard phone or computer with a USB port available for connecting devices.
- 3、 Switch, knob and button indication



- 4、 Dormancy mechanism  
After 3 minutes of inactivity in Bluetooth/2.4G mode, turn off the backlight and enter first level sleep, 2.4GIn mode, there is no action for 10 minutes to enter deep sleep, and in Bluetooth mode, there is no action for 30 minutes to enterEnter deep sleep.
- 5、 Indicator light  
1. NUM LED: numeric keyboard lock indication;  
2. CAPS LED: letter case indication; Charging indicator light: Single color light for chargingThe state is on, and the full light is off;  
3. Low battery indicator light M-LED RGB: Battery low voltage alarm, red quick indication of low voltageAlarm: The keyboard battery level is below 3.6V, and the low voltage indicator light starts to flash quickly. At the same time, the back of the keyboardThe light is forced to turn off (the keyboard button function is normal), and the battery level is about 3.1V. The keyboard is forced to turn off.
- 6、 Product attributes  
Two stage foot support; Multi function button knob; Anti slip foot stickers; 2000 milliampere battery;Size: H: 40mm L: 405mm W: 156mm
- 7、 Lighting settings  
Backlight switch control:  
1. FN+INS adjustment backlight mode: The backlight defaults to RGB streamer, neon, circular breathingMixed colors: Everbright, Everbright Red, Everbright Green, Everbright Blue, Everbright Orange, Everbright Green, Everbright PurpleAlways bright white and extinguished.  
2. Backlight brightness adjustment: FN+PGUP brightness increases, FN+PGDN brightness decreases.10 level brightness adjustment function.  
3. Backlight breathing rate and horse running speed adjustment: By FN+"-"/FN+"="Control adjustment, FN+"- " speed slows down, FN+"=" speed increases, 5-speed adjustable.

Authorized by Yundao Industrial (Shenzhen) Co., Ltd.  
Room 1810, 18th Floor, Jinhua Building No.103 Fuyong Section, Guangshen Road, Bao'an District, Shenzhen  
Manufacturer: Jiangxi Jichi Technology Co., Ltd.  
Building 3, Godfrey Industrial Park, Lvdao Avenue, Qingyuan District, Jian City, Jiangxi Province  
Contact number: 0755-23089616  
Website: www.eweadn.cn  
Product execution standard number: Keyboard GB/T 14081-2010 Mouse GB/T 20245-2010  
Attention: The product pictures are for reference only and may differ from the actual product. Please refer to the actual product. We apologize for any inconvenience caused!

#### 8、 Button composite function

WIN system (FN+A switching system)

Combination	function	Combination	function
FN+F1	Screen brightness-	FN+F10	mute
FN+F2	Screen brightness+	FN+F11	Vol
FN+F3	Convert Window	FN+F12	Volume increase
FN+F4	microphone	FN+Win	Lock WIN key
FN+F5	Player	FN+1!	BT1
FN+F6	Previous song	FN+2@	BT2
FN+F7	Next song	FN+3#	BT3
FN+F8	play/pause	FN+4¥	2.4G
FN+F9	cease		

MAC system (FN+S switching system)

Combination	function	Combination	function
F1	Screen brightness-	F7	Previous song
F2	Screen brightness+	F8	Pause/Play
F3	array	F9	Next song
F4	launchpad	F10	mute
F5	Exhale Siri	F11	Vol
F6	screenshot	F12	Volume increase

FN+W interchanges W S A D with ↑ ↓ ← →, defaults to the normal function key;Press and hold FN+ESC for 3 seconds to restore factory settings.

#### 9、 Connection method:

2.4G connection

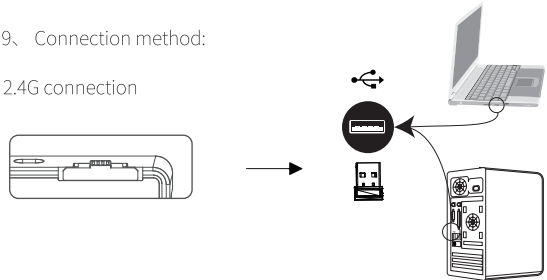

2.4G mode: Turn the power switch to the "ON" state, and FN+4 enters 2.4G mode (M-LED RGB green flashing quickly, pairing successful, stop flashing) Insert the dedicated receiver that has already matched the code,The keyboard can be used normally.

Bluetooth connectivity



Bluetooth name (EWEADN-V98)

Bluetooth mode: Turn the power switch to the "ON" position, There are three Bluetooth channels in total:  
FN+1! Bluetooth 1 {M-LED RGB light blue will flash quickly}  
FN+2 @ Bluetooth 2 {M-LED RGB light purple will flash quickly}  
FN+3 # Bluetooth 3 {M-LED RGB light green will flash quickly}  
Open the Bluetooth device pairing on the computer, and the keyboard can be used normally.

#### 10、 List of items

1. 1 keyboard,
- 2 TYPE-C charging cable,
- 3 2.4G receiver,
- 4 manual warranty card



V98keyboard



TYPE-C Charging cable

2.4G receiver

FCC Caution:  
This device complies with part 15 of the FCC Rules. Operation is subject to the following two conditions: (1) This device may not cause harmful interference, and (2) this device must accept any interference received, including interference that may cause undesired operation.  
Any changes or modifications not expressly approved by the party responsible for compliance could void the user's authority to operate the equipment.  
NOTE: This equipment has been tested and found to comply with the limits for a Class B digital device, pursuant to Part 15 of the FCC Rules. These limits are designed to provide reasonable protection against harmful interference in a residential installation. This equipment generates, uses and can radiate radio frequency energy and, if not installed and used in accordance with the instructions, may cause harmful interference to radio communications. However, there is no guarantee that interference will not occur in a particular installation.  
If this equipment does cause harmful interference to radio or television reception, which can be determined by turning the equipment off and on, the user is encouraged to try to correct the interference by one or more of the following measures:  
-- Reorient or relocate the receiving antenna.  
-- Increase the separation between the equipment and receiver.  
-- Connect the equipment into an outlet on a circuit different from that to which the receiver is connected.  
-- Consult the dealer or an experienced radio/TV technician for help.  
The device has been evaluated to meet general RF exposure requirement. The device can be used in portable exposure condition without restriction.

120mm

84mm

105g铜版纸 覆哑膜