

WIFI SMART TOUCH SWITCH

LIVE + NEUTRAL WIRE  
OR SINGLE LIVE WIRE  
PRODUCT INSTRUCTIONS

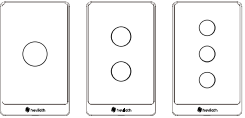

Thank you very much for buying our products. In order to make our products better service for you, please read this manual in detail and save for future reference.

BEFORE INSTALLATION

1. Before installation, please cut off the power supply first, check if there is any leakage of electricity, it is strictly prohibited to install in the electrified state.
2. Before installing the product, please make sure that the original circuit, lighting, electrical insulation measures work properly.
3. For safety and sensitivity of wireless remote control, please use plastic bottom box instead of metal bottom box.
4. This product is electronic products, the installation environment should ensure dry, normal room temperature, avoid in high temperature, high humidity, easy devaluation to use. In the induction cooker, microwave oven, radio station and other strong electromagnetic wave environment may cause the normal use.
5. Before installation, make sure the load power is within the required range.

INSTALLATION INSTRUCTIONS

01 Installation instructions

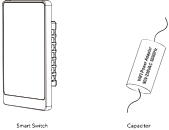

The picture is for reference only, please refer to the real one.

1

02 wiring instructions  
as shown below, the single-line switch without neutral wire, only a single wire, if there is a neutral wire in the wall, still only need live wire. Capacitor can only be connected to L-L.

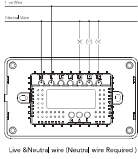

Live & Neutral wire (Neutral wire Required)

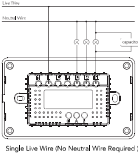

Single Live Wire (No Neutral Wire Required)

[Warning] Do not install the Switch while it is in the state of electricity, this may affect or damage the PCB board.

2

INSTALLATION INSTRUCTIONS

01 as shown below, with the appropriate tools to pry off the panel.

02 Use two screws (M4 \* 20mm) to install the frame on the inner box.

03 Fasten the panel

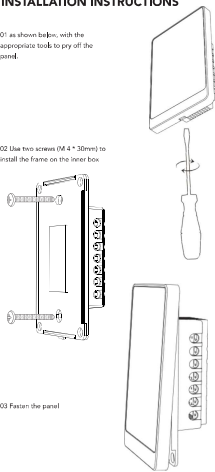

3

LINK SETTINGS

01 Download the App  
Please scan the QR code or download TUTA APP.



02 Products into the distribution network mode

Long Press L1 light button about 10S, when L1 button orange indicator flash into the distribution mode, as shown in the following diagram.

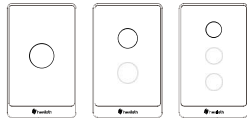

2 Gang and 3 Gang can only press the L1 light button

4

03 Automatically connect to the internet  
according to the tips of the App to operate.

1. Make sure your phone is connected to your home Wi-Fi network. App smart page → + sign in upper right-hand corner → find device activation.
2. Go to the device list interface and select the appropriate model according to the category.
3. When the product into the distribution network mode, this time will automatically search for products.
4. If the addition fails, please retry or consult customer service.

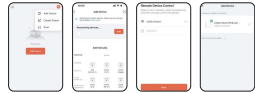

04 manual networking  
according to the tips of the App to operate.

1. Make sure your phone is connected to your home Wi-Fi network. App smart page → + sign in upper right-hand corner → find device activation.
2. Go to the device list interface and select the appropriate model according to the category.
3. Follow the App tips until it shows "Device connected to network successfully."
4. If the addition fails, please retry or consult customer service.



5

BASIC OPERATION

01 The orange light is on, and the white light is off.

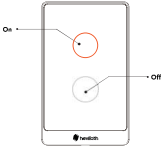

02 reset setting

In the switch on state, long press any button on the cover to open until the flash of the Orange Light, release hand, press this button again for 10s until it stops blinking and the switch resumes the factory setting.

03 remote control

As long as there is a network, download the free APP Smart Life, Any Time, Any Place your smartphone to control your home appliances.

04 single-wire system : Must Read job!

Whether there is a neutral line in the circuit, you can use the switch. If you connect without a neutral line, you need to insert the LED indicator into the "L1" light (just install one), but if you connect the neutral line, you don't need the adapter.

6

05 Installation tips:

During installation, always turn off the main power until the panel is installed, but if you want the switch by touching the plug-in directly (without the plug panel), please turn off the power for 3 minutes, then install the panel before electrifying, and you're good to go.

06 Voice Control

compatible with Smart Life, Tuya protocols, Amazon Alexa, Google Home Assistant and Tts in iOS or Android, you can control your home appliances simply by giving voice commands to Amazon Alexa or Google Assistant.

FCC Warning

This device complies with part 15 of the FCC Rules. Operation is subject to the following two conditions: (1) This device may not cause harmful interference, and (2) this device must accept any interference received, including interference that may cause undesired operation.

Any changes or modifications not expressly approved by the party responsible for compliance could void the user's authority to operate the equipment.  
NOTE: This equipment has been tested and found to comply with the limits for a Class B digital device, pursuant to Part 15 of the FCC Rules. These limits are designed to provide reasonable protection against harmful interference in a residential installation. This equipment generates, uses and can radiate radio frequency energy and, if not installed and used in accordance with the instructions, may cause harmful interference to radio communications. However, there is no guarantee that interference will not occur in a particular installation.

If this equipment does cause harmful interference to radio or television reception, which can be determined by turning the equipment off and on, the user is encouraged to try to correct the interference by one or more of the following measures:

- Reorient or relocate the receiving antenna.
  - Increase the separation between the equipment and receiver.
  - Connect the equipment into an outlet on a circuit different from that to which the receiver is connected.
  - Consult the dealer or an experienced radio/TV technician for help.
- This equipment complies with FCC radiation exposure limits set forth for an uncontrolled environment. This equipment should be installed and operated with minimum distance 20cm between the radiator and your body.

7

PRODUCT SPECIFICATION

manufacturer:	Coof(Tuya China Intelligent CO., Ltd
Product size:	118x72x35 (mm)
Color:	black, white
Material:	toughened glass, Frame PC + ABS
Voltage:	105-240VAC 50/60Hz
Power:	Power: single resistance load 400W max Capacitive load 200W max Max Total Power 1200W max
Total amperage capacity:	10A
Operating temperature:	-20°C ~ 50°C (or indoor use)
Switch type:	touch switch
Button number:	1 gang, 2 gang, 3 gang
certification:	FCC
Whether including batteries:	No
Wireless connection:	WiFi 2.4GH

ACCESSORIES

Installation screws: 2 pcs  
Switch: 1pcs  
Capacitor: 1pcs  
Installation manual: 1 PCS

WARRANTY TIPS

1. The invoice is an important evidence of free maintenance, please keep it properly.
2. The warranty period is one year, subject to the invoice date.
3. The products damaged due to improper use and storage, excessive load power supply, lightning and other force majeure factors will not be covered by the warranty.

CERTIFICATE

Inspector  
the product is approved to leave the  
factory after passing the inspection

