

# Barbecue thermometer



## User Manual

### Wireless smart meat thermometer

#### 1.Product Instructions



PROBE    Host/Signal Amplifier    AIBBQ APP

Thank you for purchasing and using our wireless smart meat thermometer. Please read this manual carefully before using this product.

#### BATTERY INSTRUCTIONS

- Please use a 5V household charger that meets the safety regulations to charge the equipment. Fast charging is not supported.
- This device does not support charging while using
- If the device is not used for a long time, please ensure that it is charged at least once every 3 months to prevent irreparable damage caused by excessive discharge of the battery

#### 2.Product Specifications

Bluetooth Version 5.1	Internal temperature: -20~100°C / -4~212°F
APP name: ALINK - AIBBQ	Ambient temperature: 0~300°C/32~572°F
Wireless distance : Max 300 feet	Probe charging time: 120min
Probe standby time: 24 hours	Host/Repeater Charging Time: 2~3 hours
Host/Repeater Charging Time: 2~3 hours	Waterproof: IP 67 (probe)

#### 3.Key setting

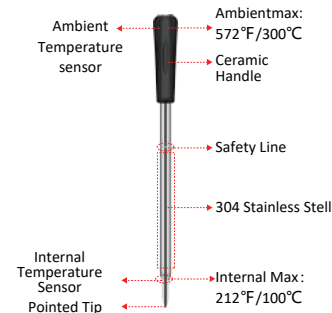

#### 4.Operating instructions:

- 1) Please place the probe on the hub before use and charge the hub until the power indicator (Light No. 3) turns blue ;
- 2) Please charge the probe for more than 1 hour before use and it will work for at least 30 hours of active use.
- 3) The indicator light is red when the host is charging, and blue when fully charged.
- 4) Press the power button before use, when the light No. 3 is blue, it means the hub is fully charged.
- 5) Undock the probe, you will hear a "beep" from the hub, and the light No. 2 will flash blue within 3 seconds, indicating that the probe is connected.
- If the light No. 2 is not lit, the probe needs to be put back in the hub and removed until it blinks blue.
- If the light No.2 flashes red, it means that the power of the probe is low and needs to be charged.
- 6) Light No. 1 will flash blue after the probe is removed and will turn a steady blue when connecting to app.
- 7) After reaching the preset temperature, APP and hub will alarm at the same time. Press the power button to turn off the alarm.

#### 5.Connect to the app for use

Place the hub near (but never in or on) the cooking appliance. The hub works quickest and most efficiently if placed near the probe during cooking, especially if the probe is in a closed environment.



#### 6.Download the APP

Search the keyword "AIBBQ" in App Store or Google play or scan the following QR code.

NOTE: The APP does not have a cloud server and will not collect personal information from users. Please rest assured to use it!



iOS 11.0 and above

#### 7.Install applications and connect devices.

- ① Turn on Bluetooth on your phone (iOS system) The Android system must have both Bluetooth and location service enabled, as well as allow notification services. (Notification includes alarm sound and pop-up icon)

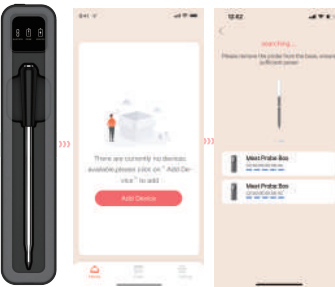
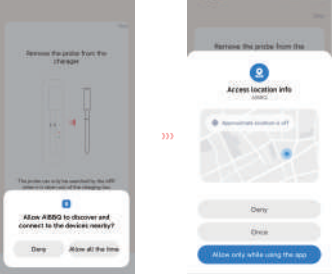

1. Turn on the device and open the APP (AIBBQ)
2. Open the APP and click "Add Device"
3. Find the device

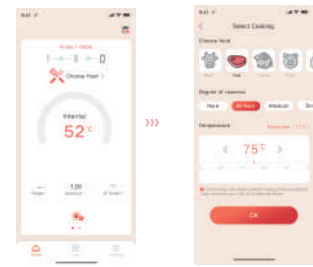

4. Successfully connected to Click "Choose Food" Choose the food
5. Choose the food that needs to be cooked



6. Start cooking, Food cooking completion reminder Click "A-Target" Set environmental

#### 8.Attention!

In order to better communicate with mobile phones and allow wireless transmission distance to be farther, please keep the host within 10 feet of the cooker. Due to the high surface temperature of cooking equipment, please do not place the host directly on the surface of cooking equipment or in a high-temperature environment. The ambient temperature for safe use of the host is: -20°C to +85°C.

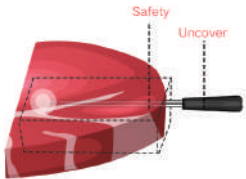

The insertion method of the probe is related to the sensing temperature. The wrong insertion method will cause inaccurate temperature measurement or direct damage to the probe



One-third of the probe    Probe partially exposed    Exceeds probe graduation line



Direct to flames



#### 9.Important security information

- Use the probe only for the intended purpose. The probe is designed for meat (food).
- To prevent the risk of electric shock, do not immerse the charging block in water or other liquid.
- To avoid damage to the probe, the probe must be inserted into the safety line in the meat.
- In order to maintain the best performance of the product, please do not insert any part of the probe's ceramic handle into the meat.
- Do not use the probe in a microwave oven or pressure cooker.
- Do not expose the wireless grill thermometer and probe directly to flames. Do not drop the probe on a hard surface.
- The probe cannot be washed in a dishwasher. Wash the probe with soap and water before and after using by hand.
- When putting it back into the charger or the wireless grill thermometer, make sure the probe is completely dry.
- The probe is waterproof, but it should not be immersed in water. Do not immerse in water for a long time.
- Please pay attention to the tip of the probe to avoid injury.
- During the cooking process or just after cooking, the probe will be very hot, please do not touch them with bare hands.
- Do not immerse the probe in cold water after cooking. Wait until the probes cool down by themselves before washing.
- The probe is not a toy. Close supervision is required if you use the probe near children.
- Do not use this product outdoors in rain, thunderstorm or

other severe weather conditions.

#### Common Q&A and Precautions:

1. Open the APP, when the probe is put back into the box for a few seconds and then take it out, if the APP can't automatically search for the charging box and the probe (which has been connected before), please manually click on the circle icon on the APP to refresh it.
  2. 3 seconds interval is needed between taking out the probe from the charging box and putting it back quickly, to avoid the slow response of the program causing failure to connect to the phone.
  3. Long press the button for 8s, the charging box device is forced to restart.
  4. Battery with NTC function can be charged at -10~50°C. If beyond the range, it will stop charging.
  5. When the temperature of the probe reaches 100°C, the charging box buzzer will continue to alarm.
- LED light indication description:**
1. A charging box battery indicator: red and blue color.
  2. When the button is pressed, the charging case shows red light if there is no power; the charging case shows blue light if there is power. Press the key, the light is off.
  3. When the charging case is connected to type C external charging, it shows red light, and when it is full, it shows blue light. Remove charging, the light is off.
  4. A probe connection and battery indicator: red and blue.
  - 4.1 After the probe is connected after the power is turned on, if the pin power is too low, it shows red blinking. If the power level is normal, the display flashes blue (lasting 100ms/interval 2S). The light will be off when the probe is disconnected.
  - 4.2 When the probe is put into the charging box for charging, the light is off.
  5. A charging case Bluetooth connection indicator: blue.
  - 5.1 Put the probe out of the charging box, 3S later if don't be connected after 3 seconds, the blue light flashes, if connected, the light is always on. The light will be off after power off.

#### FCC statement

Any changes or modifications not expressly approved by the party responsible for compliance could void the user's authority to operate the equipment.

This device complies with part 15 of the FCC Rules. Operation is subject to the following two conditions:

- (1) This device may not cause harmful interference,
- (2) This device must accept any interference received, including interference that may cause undesired operation.

#### FCC Radiation Exposure Statement :

This equipment complies with FCC radiation exposure limits set forth for an uncontrolled environment.

#### WEEE Compliance

Correct Disposal of This Product (Waste Electrical & Electronic Equipment) (Applicable in countries with separate collection systems) This marking on the product, accessories or literature indicates that the product and its electronic accessories should not be disposed of with other household waste at the end of their working life. To prevent possible harm to the environment or human health from uncontrolled waste disposal, please separate these items from other types of waste and recycle them responsibly to promote the sustainable reuse of material resources. Household users should contact either the retailer where they purchased this product, or their local government office, for details of where and how they can take these items for environmentally safe recycling. Business users should contact their supplier and check the terms and conditions of the purchase contract. This product and its electronic accessories should not be mixed with other commercial wastes for disposal.

**FCC Statement**

This device complies with part 15 of the FCC rules. Operation is subject to the following two conditions: (1) this device may not cause harmful interference, and (2) this device must accept any interference received, including interference that may cause undesired operation.

Changes or modifications not expressly approved by the party responsible for compliance could void the user's authority to operate the equipment.

NOTE: This equipment has been tested and found to comply with the limits for a Class B digital device, pursuant to part 15 of the FCC Rules. These limits are designed to provide reasonable protection against harmful interference in a residential installation. This equipment generates uses and can radiate radio frequency energy and, if not installed and used in accordance with the instructions, may cause harmful interference to radio communications. However, there is no guarantee that interference will not occur in a particular installation. If this equipment does cause harmful interference to radio or television reception, which can be determined by turning the equipment off and on, the user is encouraged to try to correct the interference by one or more of the following measures:

- Reorient or relocate the receiving antenna.
- Increase the separation between the equipment and receiver.
- Connect the equipment into an outlet on a circuit different from that to which the receiver is connected.
- Consult the dealer or an experienced radio/TV technician for help.

The device has been evaluated to meet general RF exposure requirement. The device can be used in portable exposure condition without restriction.