

# Tattoo Printer

A9, A7, A7s, A7 Pro ,  
A8, A8s, A8 Pro ,  
A9s, A9 Pro,  
A10, A10s, A10 Pro,  
JD-158, JD-158T, JD-158 Pro , JD-158 Max  
P93s, P93 Pro , P93  
A6

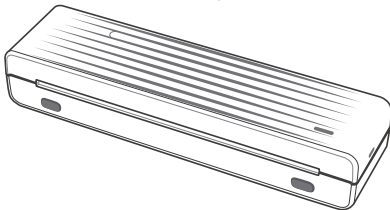

Please read the instruction manual carefully before using the product.

Version:1.0

INSTRUCTION MANUAL

## Product Sketch

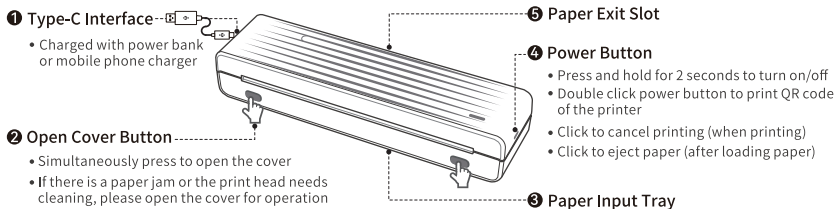

## Power Indicator Status

- White light stays on: Normal startup
- Blue light stays on: The app is connected to the printer
- Green light is always on: Full charge
- Red light is always on: Cover opened / Over-heat / Charging
- Red light flashing slowly: Low battery. Please charge in time

## Paper Installation Instructions

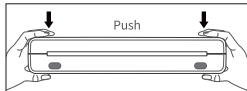

- ① Ensure the cover is closed tightly.

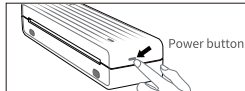

- ② Press and hold the power button for 2 seconds to turn on.

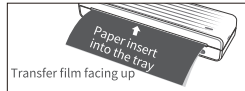

- ③ Align with the paper feed slot and insert until it is drawn in and cannot be pulled out. (Note: If a paper jam occurs, press the cover open button to remove the paper.)

## App Printing

### Step 1: App Download

Search for [AiYin ] on Google Play or App Store, or scan the following QR code to download App.



App Download

## Step 2: App connects to printer

- ① Press and hold the power button for 2 seconds to turn on the printer.
- ② Open the [PeriMonkey] App, enter the interface of connecting the device, and click to connect to the discovered printer.  
Or press the power button twice to print the QR code, then connect the printer by scanning the code.  
(Tips: Don't connect printer in the mobile phone bluetooth settings.)
- ③ After the printer is connected, open the function provided by the App to operate printing.

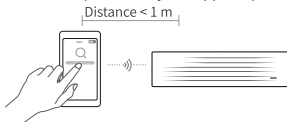

## PC Printing

- ① Press and hold the power button for 2 seconds to turn on the printer. Connect the printer and computer with the original Type-C data cable.
- ② Please visit the official website, <https://www.ileadtek.com/en/download.html>, to download and install the printer driver for editing and printing.
- ③ After the driver is installed, select this printer when print documents on the computer.

## Paper Holder

Please adjust the position of the paper guide according to the width of the printing paper to limit paper misalignment and prevent content from printing askew.

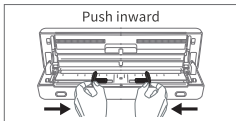

① Shrink the Paper Bin

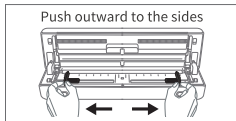

② Enlarge Paper Bin

## Clean the Printer Head

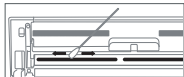

- ① Please turn off the printer and open the printer cover and take out the paper.
- ② Dip a cotton cloth or cotton swab with medical alcohol, and wipe gently along the center to the periphery of the printer head.
- ③ After cleaning the printer head, do not use the printer immediately. Please wait for 1 to 2 minutes, use the printer after the alcohol has completely evaporated.

## Charging Instructions

- 5V $\overline{=}$ 2A input, recommend to use mobile phone charger for charging.
- Recommend to charge the battery fully before using.
- If printer has not been used for a long time, please charge it every 3 months, to avoid long-term natural wear and tear of lithium batteries can not be charged.

## Notes

- This product does not come with a power adapter. If you need to charge it using a power adapter, please purchase and use one that is locally certified and meets the required standards.
- Using an incorrect battery pack can be dangerous.
- Please do not put the battery into a fire or heating furnace, and do not dispose of the battery mechanically or by cutting.
- Please do not expose the battery to extremely high temperatures, as this may cause it to leak combustible liquids or gases.
- Please do not expose the battery to extremely low air pressure, as this may cause it to leak combustible liquids or gases.
- Using this device in a residential area may cause radio interference.



Attention! The paper tearing blade has sharp edges. Please be careful not to touch it to avoid injury.



Attention! Hot parts! After printing, do not touch the print head to avoid overheating and burns. Turn off the power and wait for half an hour before touching the print head.



This product must be used under adult supervision.

## FCC Warning

This device complies with Part 15 of the FCC Rules. Operation is subject to the following two conditions:

(1) This device may not cause harmful interference, and (2) this device must accept any interference received, including interference that may cause undesired operation.

NOTE 1: This equipment has been tested and found to comply with the limits for a Class B digital device, pursuant to part 15 of the FCC Rules. These limits are designed to provide reasonable protection against harmful interference in a residential installation. This equipment generates, uses and can radiate radio frequency energy and, if not installed and used in accordance with the instructions, may cause harmful interference to radio communications. However, there is no guarantee that interference will not occur in a particular installation. If this equipment does cause harmful interference to radio or television reception, which can be determined by turning the equipment off and on, the user is encouraged to try to correct the interference by one or more of the following measures:

- Reorient or relocate the receiving antenna.
- Increase the separation between the equipment and receiver.
- Connect the equipment into an outlet on a circuit different from that to which the receiver is connected.
- Consult the dealer or an experienced radio/TV technician for help.

NOTE 2: Any changes or modifications to this unit not expressly approved by the party responsible for compliance could void the user's authority to operate the equipment.

The device has been evaluated to meet general RF exposure requirement. The device can be used in portable exposure condition without restriction.

## Thanks for choosing us!

### Customer Support

Please kindly contact us if you have any trouble or question when installing and using.

 [support@aiyin.com](mailto:support@aiyin.com)

 [www.aiyin.com](http://www.aiyin.com)

 [help.aiyin.com](http://help.aiyin.com)  
How can we help you today?

Scan the following QR code to talk with us



at 10am to 10pm EST

Scan or upload this QR code using  
the WhatsApp camera to add us

Manufacturer: Xiamen AiYin Technology Co., Ltd.