

PRODUCT MANUAL

SKU: B0812-00001-CL

BEFORE YOU BEGIN

1. Please read the instructions carefully and verify that each item is in the list.
2. Please retain these installation instructions for further reference and parts ordering information.

Estimated installation time:

15 minutes

IMPORTANT

1. Please read the installation instructions carefully before you start.
2. If the vehicle is clean and free of other debris, it will be easy to install.
3. For your safety and to ensure a satisfactory installation, please complete all the installation steps in the order shown below.

PRODUCT INFORMATION

- ① Wiring Harness With LED strip
- ② Sealing Strip
- ③ Tie

x1

x1

x10

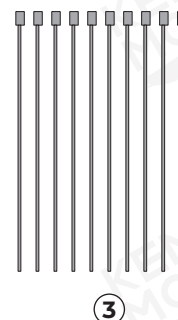
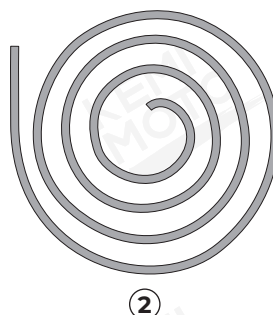
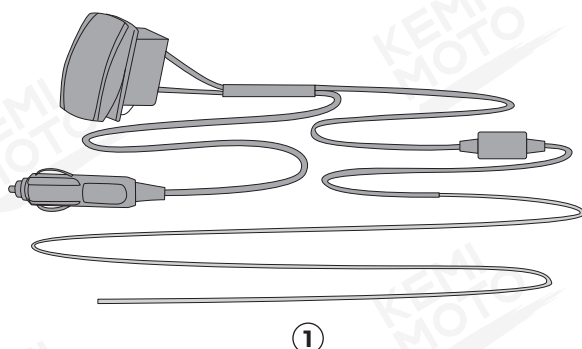

INSTALLATION TIPS - Take adapting to Defender model as an example

- ① Use a flat-head screwdriver to pry open the cover at the indicated position.

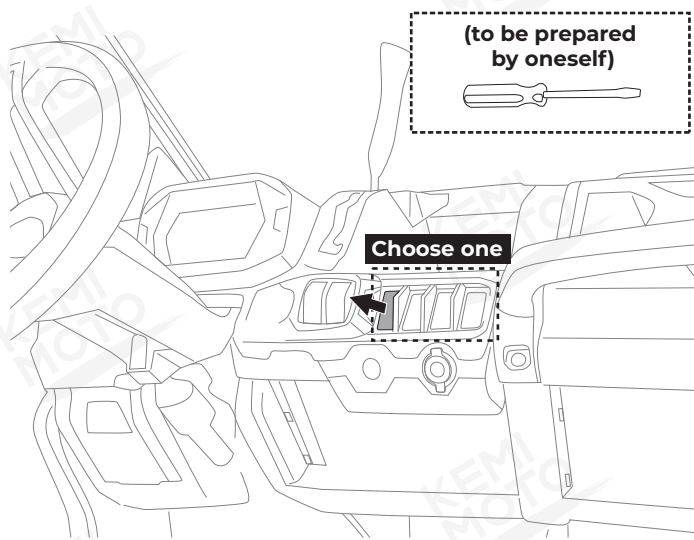

- ② Insert the wiring harness with LED strip [1] through the indicated hole below the switch.

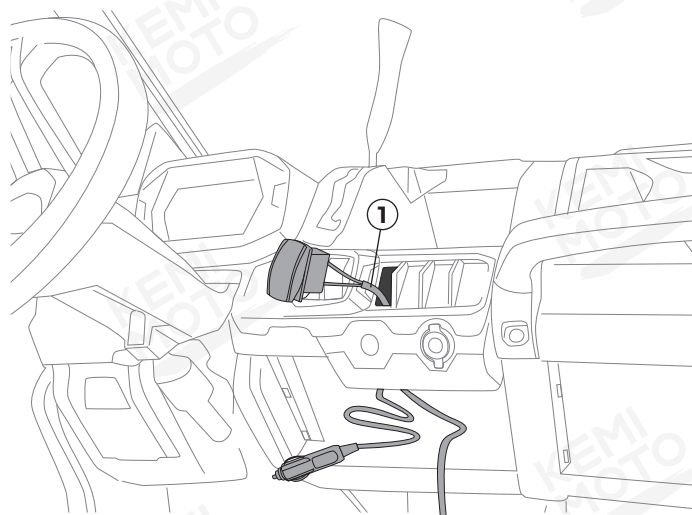

- 3** Secure the switch in the indicated hole and insert the cigarette lighter into the cigarette lighter socket.

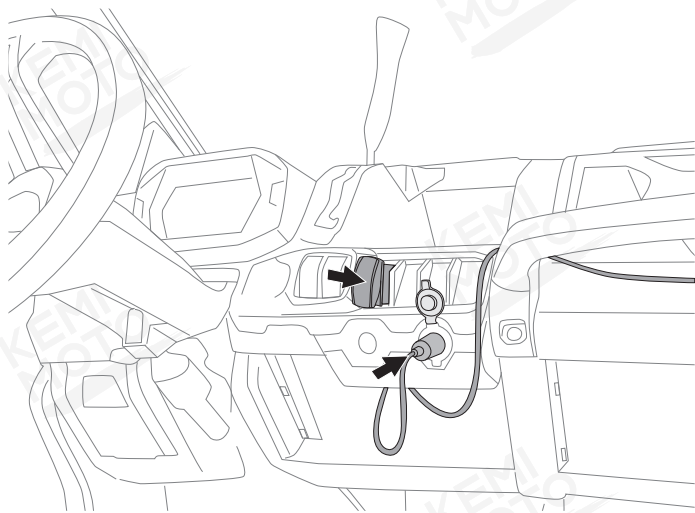

- 4** Remove the windshield of the vehicle and cut any excess sealing strip [2] based on the length of the bottom of the windshield.



- 5** Separate the sealing strip [2] and stick the LED strip [1] in the middle of the sealing strip [2], then tightly pinch the sealing strip [2] onto the windshield edge. (Please do not apply excessive force)

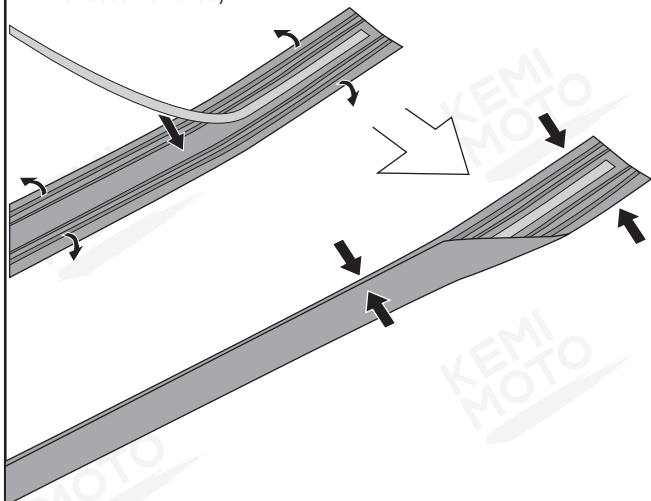

- 6** Reinstall the windshield.

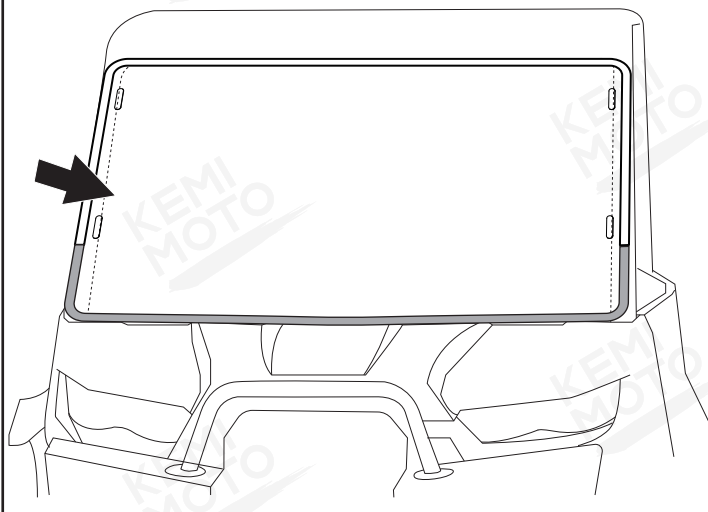

- 7** Use zip ties to tidy up any excess wires. Use ties[3] to secure the Wiring harness.

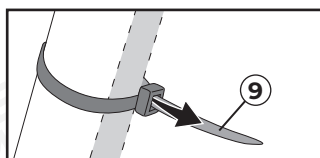

(to be prepared by oneself)

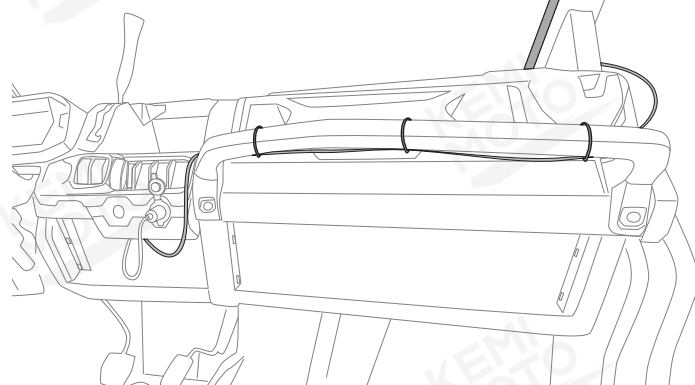

NOTE

The end of the LED strip [1] can be cut according to the length of the windshield.
Three led lights in one unit, which can be cut from the middle of the metal part.

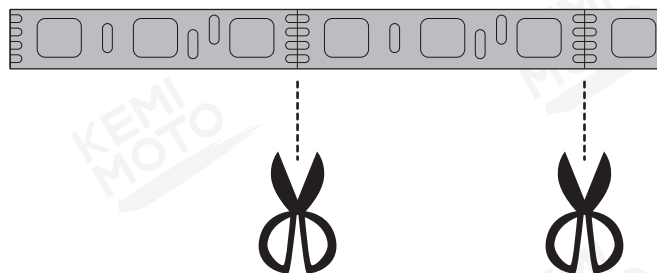

Scan the QR code, download the control APP, then open the APP and connect to Bluetooth to control the RGB lights.

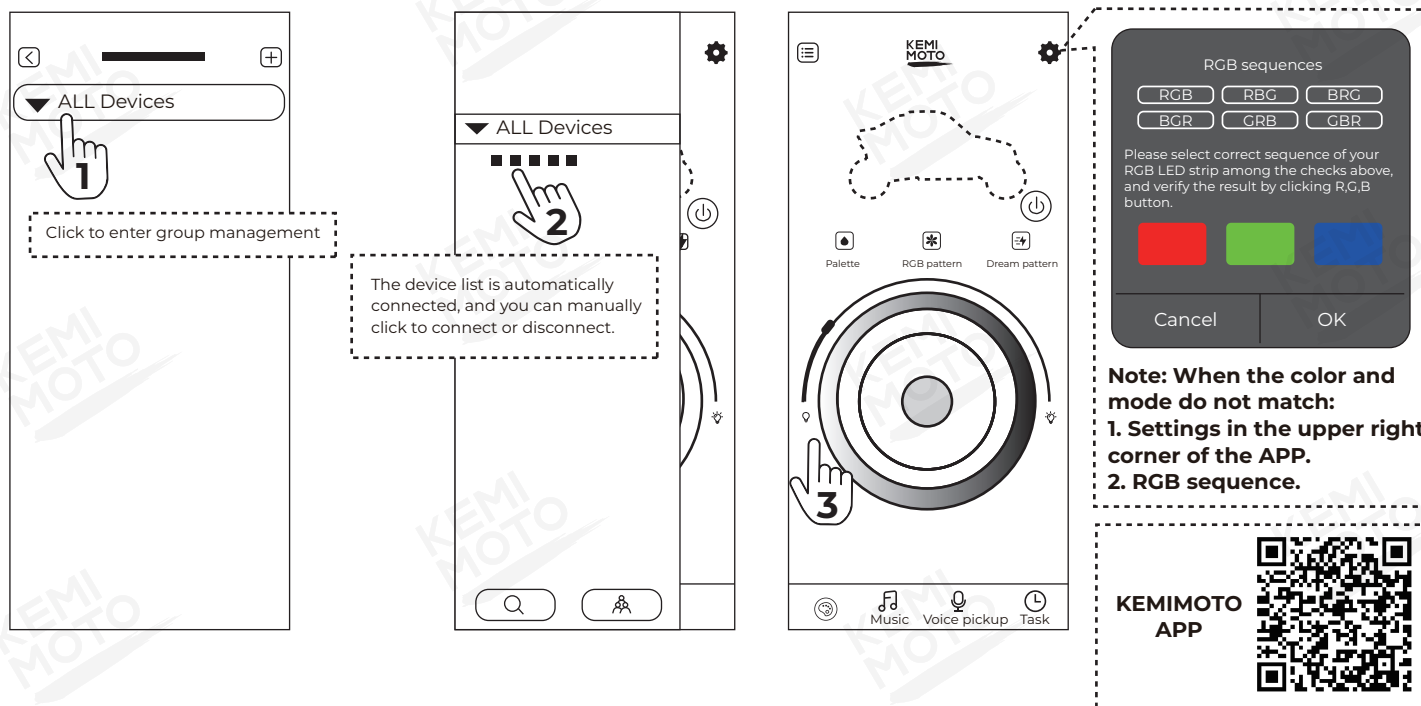

FCC Caution:

This device complies with part 15 of the FCC Rules. Operation is subject to the following two conditions: (1) This device may not cause harmful interference, and (2) this device must accept any interference received, including interference that may cause undesired operation.

Any Changes or modifications not expressly approved by the party responsible for compliance could void the user's authority to operate the equipment.

Note: This equipment has been tested and found to comply with the limits for a Class B digital device, pursuant to part 15 of the FCC Rules. These limits are designed to provide reasonable protection against harmful interference in a residential installation.

This equipment generates uses and can radiate radio frequency energy and, if not installed and used in accordance with the instructions, may cause harmful interference to radio communications. However, there is no guarantee that interference will not occur in a particular installation. If this equipment does cause harmful interference to radio or television reception, which can be determined by turning the equipment off and on, the user is encouraged to try to correct the interference by one or more of the following measures:

- Reorient or relocate the receiving antenna.
- Increase the separation between the equipment and receiver.
- Connect the equipment into an outlet on a circuit different from that to which the receiver is connected.
- Consult the dealer or an experienced radio/TV technician for help.

This equipment complies with FCC radiation exposure limits set forth for anuncontrolled environment. This equipment should be installed and operated with minimum distance 20cm between the radiator & your body.