

PRODUCT MANUAL

SKU: B0810-00101CL

BEFORE YOU BEGIN

1. Please read the instructions carefully and verify that each item is in the list.
2. Please retain these installation instructions for further reference and parts ordering information.

IMPORTANT

1. Please read the installation instructions carefully before you start.
2. If the vehicle is clean and free of other debris, it will be easy to install.
3. For your safety and to ensure a satisfactory installation, please complete all the installation steps in the order shown below.

PRODUCT INFORMATION

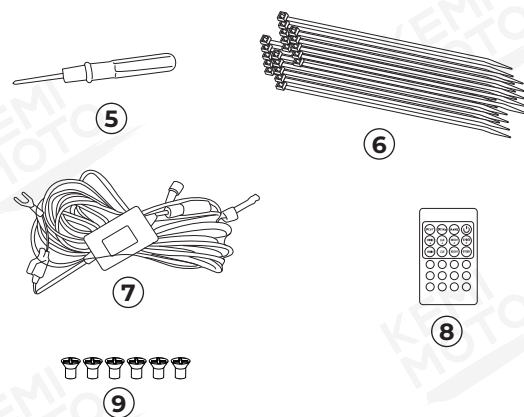
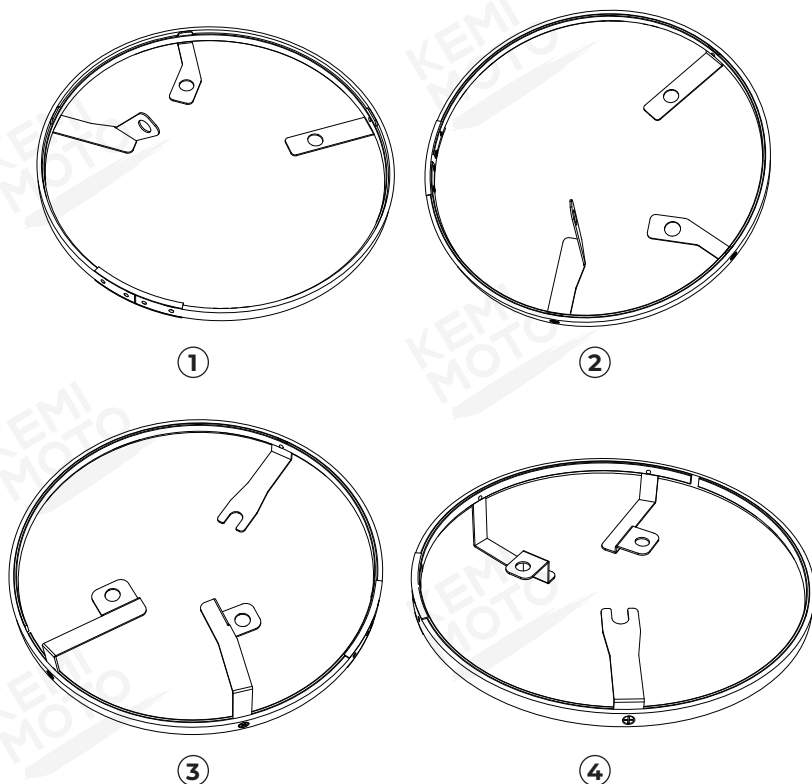

- | | |
|-------------------------------|-----|
| ① L - Front Hub Light | x1 |
| ② R - Front Hub Light | x1 |
| ③ L - Rear Hub Light | x1 |
| ④ R - Rear Hub Light | x1 |
| ⑤ Cross/Flat-Head Screwdriver | x1 |
| ⑥ Tapes | x20 |
| ⑦ Wire Harness | x1 |
| ⑧ Remote Control | x1 |
| ⑨ M4*8 Screw | x6 |

INSTALLATION TIPS

STEP 1

Right front tire

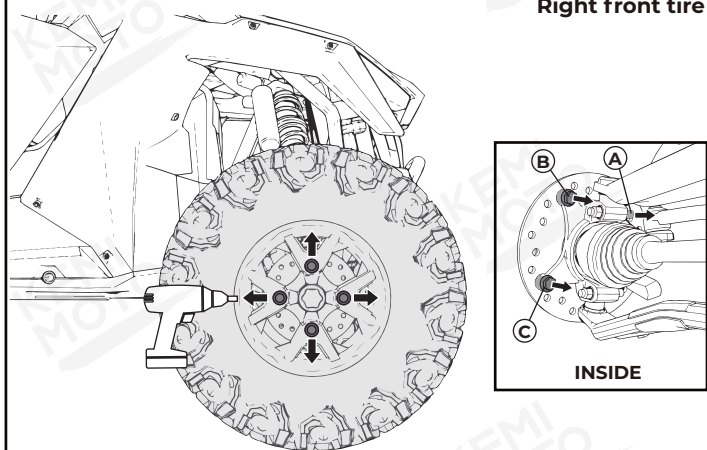

Remove the tire, then unscrew screws A, B, and C.

STEP 2

Right front tire

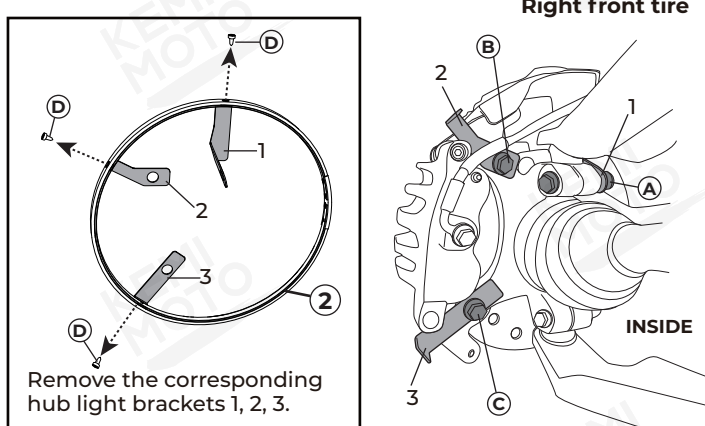

Remove the corresponding hub light brackets 1, 2, 3.

Insert them into the corresponding slots A-1, B-2, C-3 (pay attention to the direction of the bracket bending), slightly tighten screws A, B, and C just enough to clamp the bracket without fully tightening them.

STEP 3

Right front tire

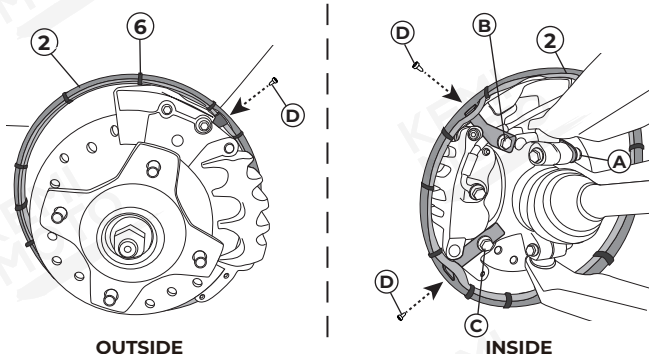

Insert the outer ring of the R-front hub light ② into the bracket, align the holes with the bracket holes, and lock the removed small hub light screws D back onto the bracket, then tighten screws A, B, and C.

STEP 4

Right front tire

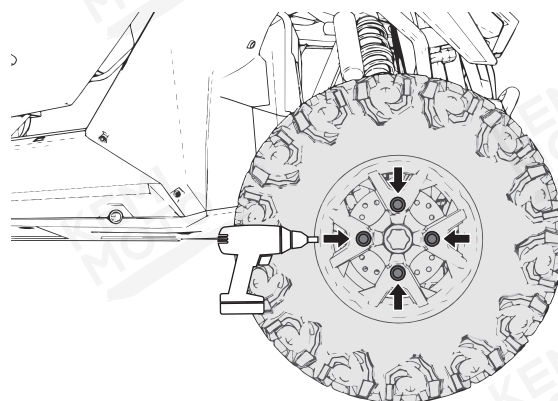

Finally reinstall the front right tire and tighten the screws.

STEP 5

Right rear tire

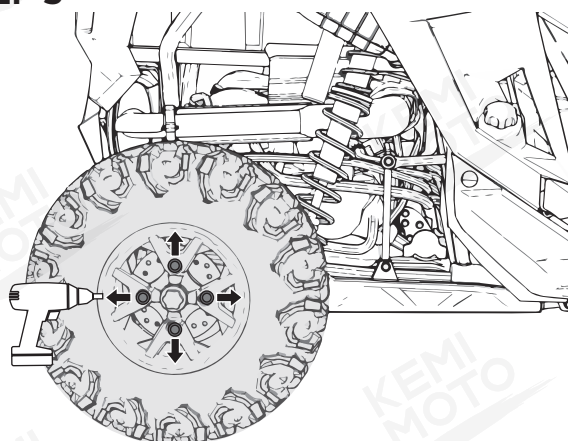

Remove the right rear tire.

STEP 6

Right rear tire

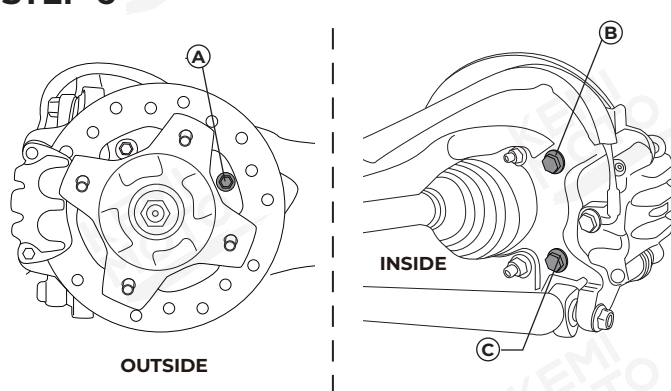

Loosen screw A to rotate out the height of the installation bracket, and remove screws B and C.

STEP 7

Right rear tire

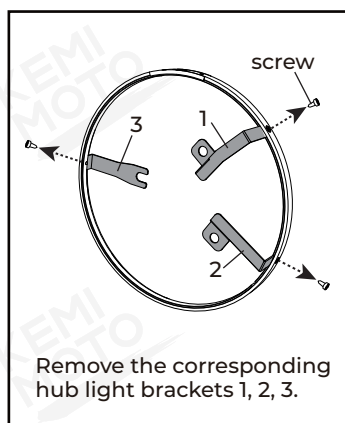

Remove the corresponding hub light brackets 1, 2, 3.

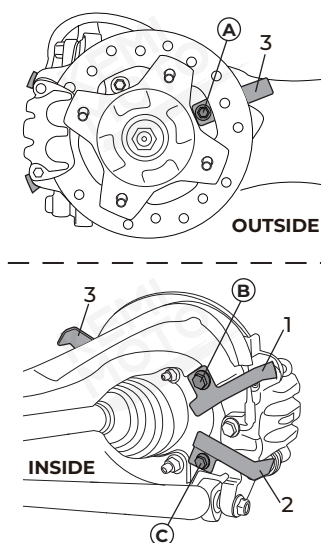

Insert them into the corresponding slots A-1, B-2, C-3 (pay attention to the direction of the bracket bending), slightly tighten screws A, B, and C just enough to clamp the bracket without fully tightening them.

STEP 8

Right rear tire

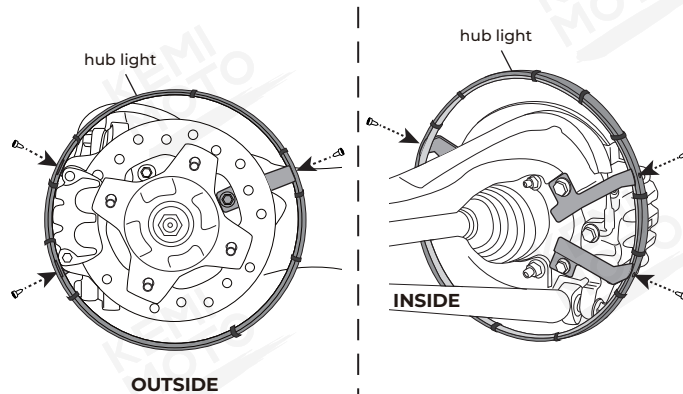

Insert the outer ring of the hub light into the bracket, align the holes with the bracket holes, and lock the removed small hub light screws back onto the bracket, then tighten screws A, B, and C.

STEP 9

Right rear tire

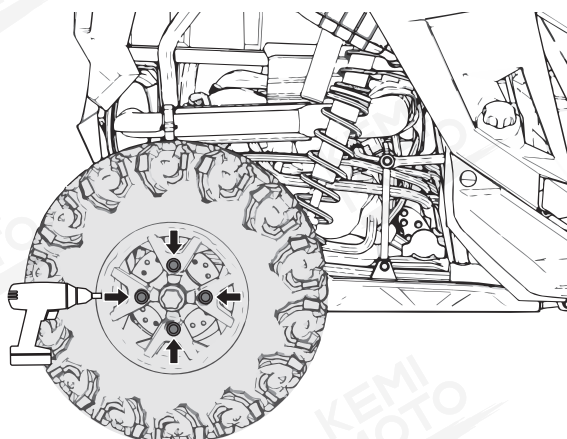

Finally reinstall the right rear tire and tighten the screws.

STEP 10

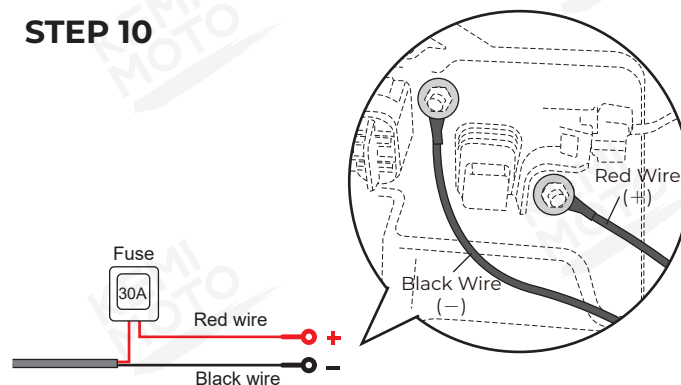

For power instructions: Lift the driver's seat, find the original car power supply, and connect the corresponding positive and negative terminals.

REMOTE CONTROL

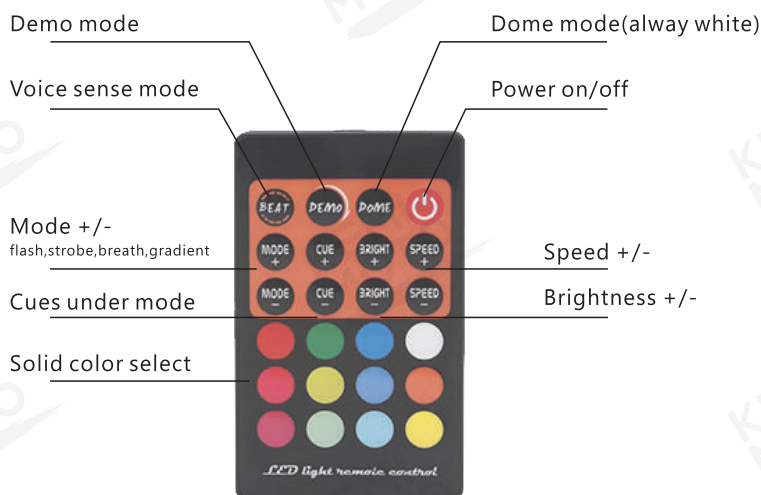

Note: take off the insulation piece before use

GET THE DEDICATE APP FOR IT

Download the app in Google play, or App store scan the barcode.



Click to download



Location access allow is necessary

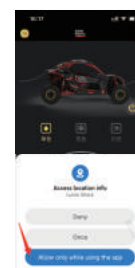

FCC Caution:

This device complies with part 15 of the FCC Rules. Operation is subject to the following two conditions: (1) This device may not cause harmful interference, and (2) this device must accept any interference received, including interference that may cause undesired operation.

Any Changes or modifications not expressly approved by the party responsible for compliance could void the user's authority to operate the equipment.

Note:

This equipment has been tested and found to comply with the limits for a Class B digital device, pursuant to part 15 of the FCC Rules. These limits are designed to provide reasonable protection against harmful interference in a residential installation. This equipment generates uses and can radiate radio frequency energy and, if not installed and used in accordance with the instructions, may cause harmful interference to radio communications. However, there is no guarantee that interference will not occur in a particular installation. If this equipment does cause harmful interference to radio or television reception, which can be determined by turning the equipment off and on, the user is encouraged to try to correct the interference by one or more of the following measures:

- Reorient or relocate the receiving antenna.
- Increase the separation between the equipment and receiver.
- Connect the equipment into an outlet on a circuit different from that to which the receiver is connected.
- Consult the dealer or an experienced radio/TV technician for help.

This equipment complies with FCC radiation exposure limits set forth for an uncontrolled environment. This equipment should be installed and operated with minimum distance 20cm between the radiator & your body