

PRODUCT MANUAL

SKU: B0805-00203-CL

BEFORE YOU BEGIN

1. Please read the instructions carefully and verify that each item is in the list.
2. Please retain these installation instructions for further reference and parts ordering information.

IMPORTANT

1. Please read the installation instructions carefully before you start.
2. If the vehicle is clean and free of other debris, it will be easy to install.
3. For your safety and to ensure a satisfactory installation, please complete all the installation steps in the order shown below.

PRODUCT INFORMATION

- | | |
|--|----|
| ① Light | x1 |
| ② Bracket A | x2 |
| ③ Bracket B | x1 |
| ④ M4*8 cross round head self-tapping screw | x6 |
| ⑤ Wiring Harness | x1 |
| ⑥ Ties | x3 |

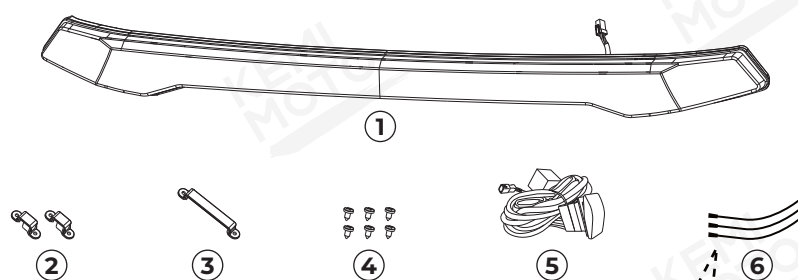

Estimated installation time:

15-30 minutes

Required tools: **(to be prepared by oneself)**

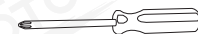

Phillips Screwdriver



One-Word Screwdriver

INSTALLATION TIPS

STEP1: Remove the switch from the wiring harness [5].

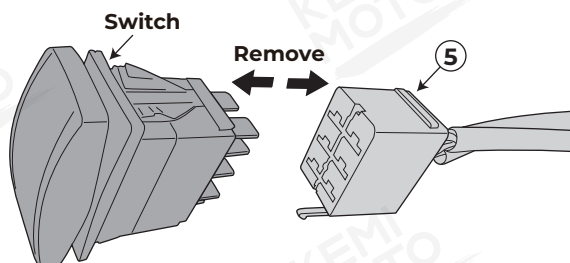

STEP2: Remove the hood as shown.

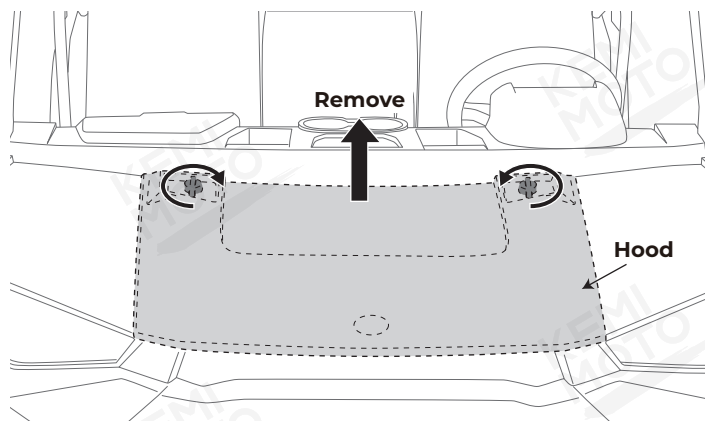

STEP3: Remove the screws shown in the picture and take out the cup holder.

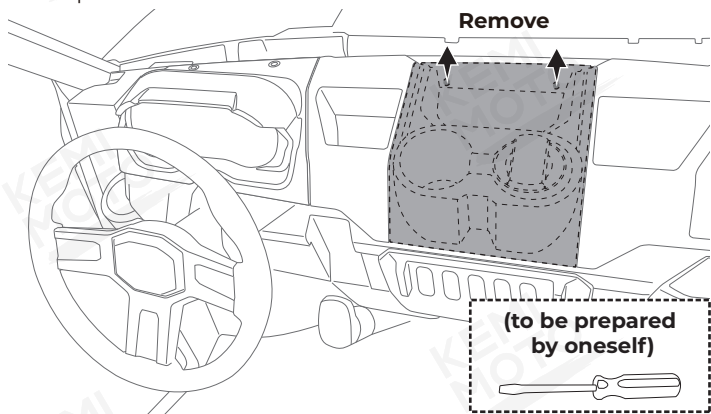

STEP4: Select one of the decorative panels and pry it out.

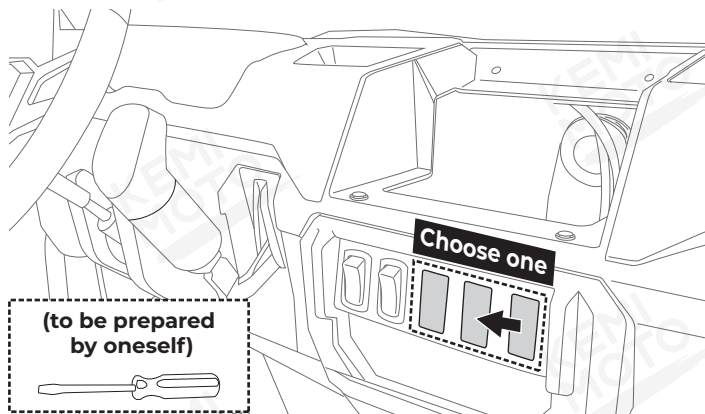

STEP5: Insert the switch in the designated hole, and then install the wiring harness [5] and switch.

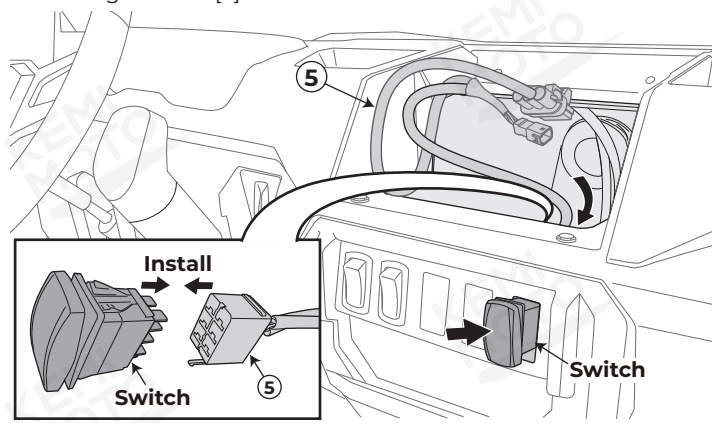

STEP6: Pass the two plugs of the wiring harness [5] through the holes in the picture.

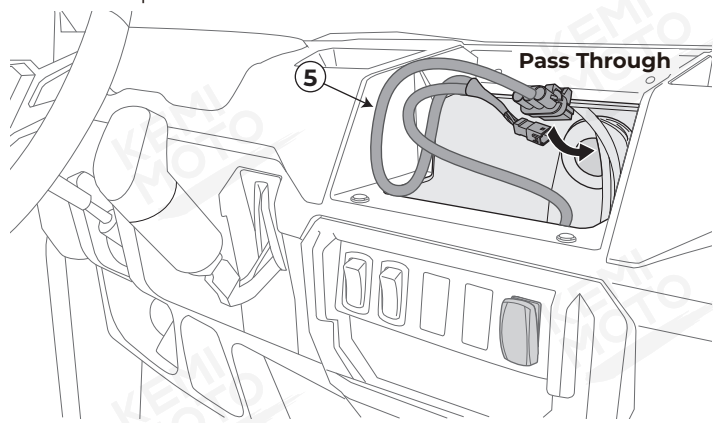

STEP7: Select one of the battery interface and remove its cover.

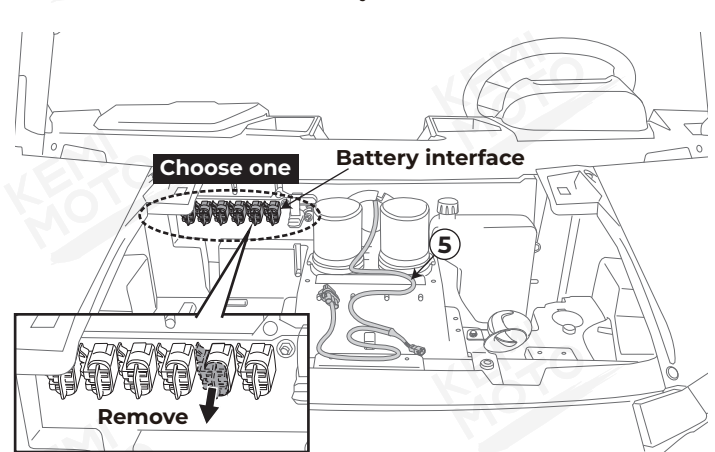

STEP8: Insert the plug [A] of the wiring harness [5] into the battery interface.

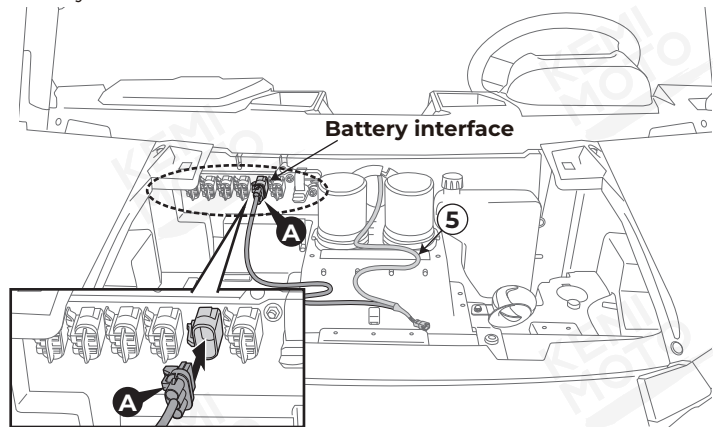

STEP9: Tear off the clear paper of the double sided tape.

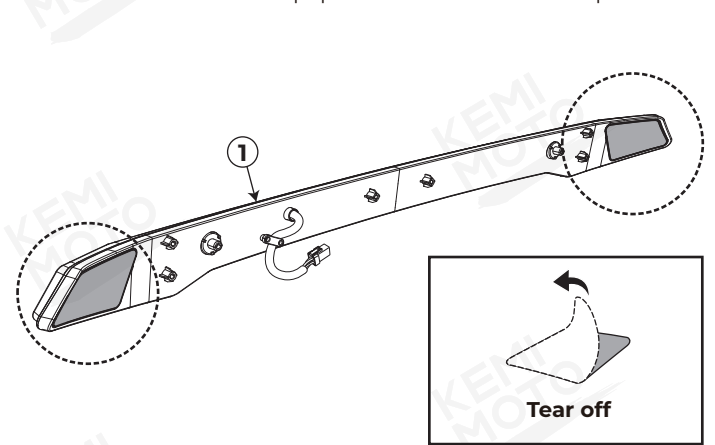

STEP10: Place the light [1] at the position shown on the front of the vehicle.

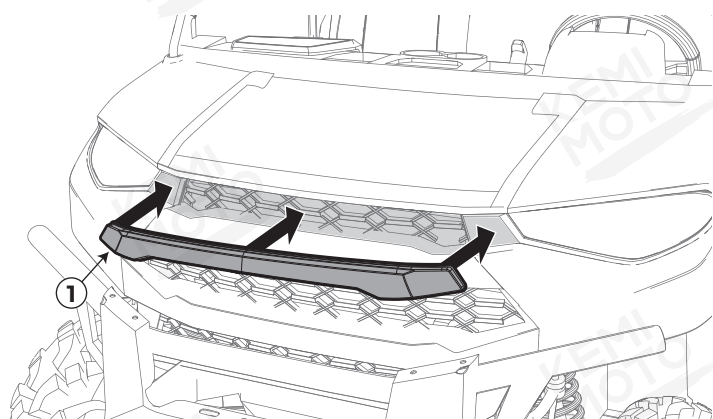

STEP11: Use bracket [2][3] and screws [4] to fix the light[1].

STEP12: Connect the plug [B] of the harness [5] to the plug of the light [1].

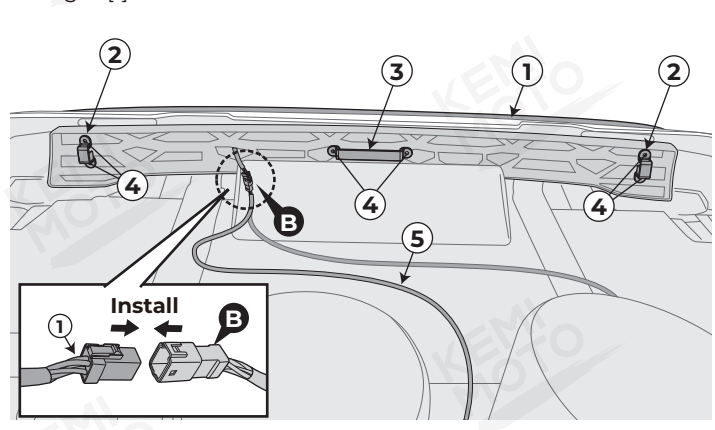

STEP13: Reinstall the disassembled parts from steps 2-3.

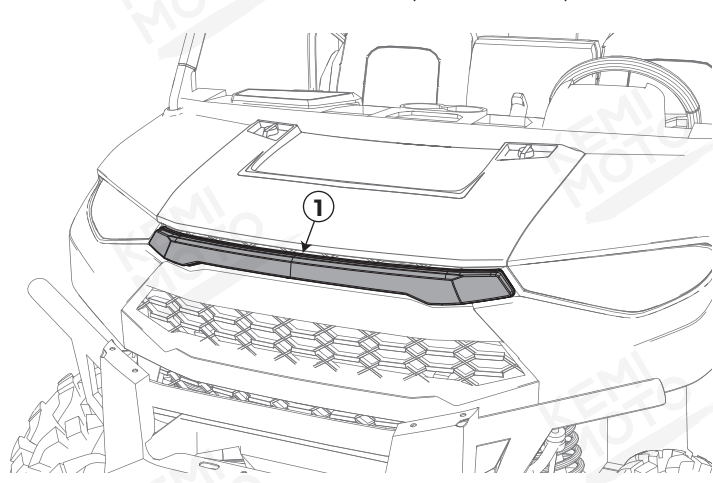

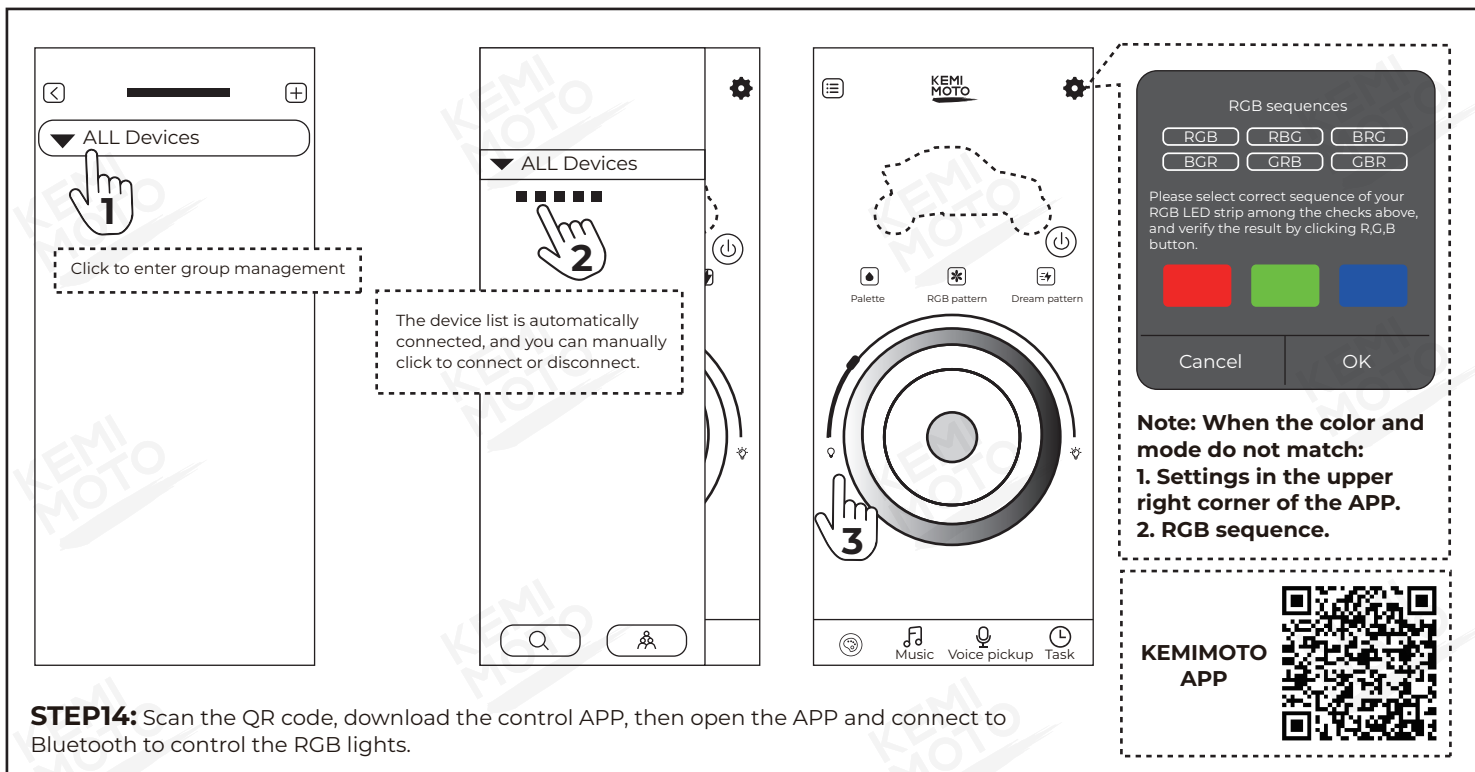

FCC STATEMENT

This device complies with Part 15 of the FCC Rules. Operation is subject to the following two conditions:

- (1) This device may not cause harmful interference, and
- (2) This device must accept any interference received, including interference that may cause undesired operation.

Warning: Changes or modifications not expressly approved by the party responsible for compliance could void the user's authority to operate the equipment.

NOTE: This equipment has been tested and found to comply with the limits for a Class B digital device, pursuant to Part 15 of the FCC Rules. These limits are designed to provide reasonable protection against harmful interference in a residential installation.

This equipment generates uses and can radiate radio frequency energy and, if not installed and used in accordance with the instructions, may cause harmful interference to radio communications. However, there is no guarantee that interference will not occur in a particular installation. If this equipment does cause harmful interference to radio or television reception, which can be determined by turning the equipment off and on, the user is encouraged to try to correct the interference by one or more of the following measures:

- Reorient or relocate the receiving antenna.
- Increase the separation between the equipment and receiver.
- Connect the equipment into an outlet on a circuit different from that to which the receiver is connected.
- Consult the dealer or an experienced radio/TV technician for help.

FCC RADIATION EXPOSURE STATEMENT

This equipment complies with FCC radiation exposure limits set forth for an uncontrolled environment. This equipment should be installed and operated with minimum distance 20cm between the radiator & your body