

EN

Smartwatch

User Guide

Preliminary understanding of the product

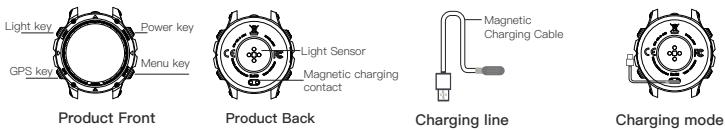

Procedure For Use

You can use the watch by following the steps below:

- 1 Wear → 2 Boot Up → 3 Setting the watch → 4 Start Using

1 Wearing a Watch

In order for the watch to measure data more accurately, you need to be aware of the following:

1. Place the watch about two fingers from the wrist bone.
2. Adjust the strap to a comfortable degree of elasticity, keep the gap between the strap and the wrist at about one finger, so that the back of the watch is close to the skin.

2 Boot Up

Press and hold the "ON/OFF key for 3 seconds" to turn on the watch.
Tip: If the watch does not turn on, charge the watch for about 10 minutes and then wait for the watch to turn on automatically.

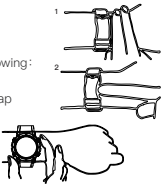

3 Setting The Watch

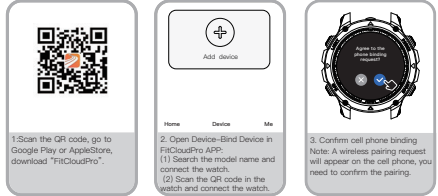

Common Functions

7 Menu Styles

Press the lower right SPORT button of the watch to enter the menu, Double click to switch to different menu styles, as shown in the right figure

GPS Function

Press the GPS button on the lower left of the watch to enter the physical training and turn on the GPS exercise mode, as shown in the right figure

Altitude Barometer

1. Altitude and pressure display screen scroll down to switch to altimeter
2. Click on Calibrate for altitude calibration
3. The altitude parameter in the watch can be adjusted according to the values of other altimeters or altitude parameters.



4 Start Using

Touch screen operation
Supports full screen touch
(swipe, tap, long press)

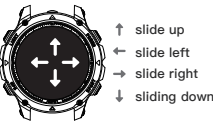

Product Specification

screen	1.46"360*360 IPS
Weight	81g
battery capacity	540mAh
body size	Ø50*14.3mm
Compatible system	Android 5.1 or IOS 8.2 or above supports

Precaution

- 1: Not intended for use in bathing, diving, water skiing or other activities involving heat, hot air or high velocity water.
- 2: Watches may be due to firmware upgrades, the interface or the use of changes in the way is a normal phenomenon, please refer to the product's upgrades to the introduction shall prevail.

If you have any problems with the product, you can go to "My → FAQ or Feedback" in the FitCloudPro App to find a solution.

Procedure For Use

Information to User

This device complies with part 15 of the FCC rules. Operation is subject to the following two conditions: (1) this device may not cause harmful interference, and (2) this device must accept any interference received, including interference that may cause undesired operation.

Important

Changes or modifications not expressly approved by the party responsible for compliance could void the user's authority to operate the equipment.

NOTE: This equipment has been tested and found to comply with the limits for a Class B digital device, pursuant to part 15 of the FCC Rules. These limits are designed to provide reasonable protection against harmful interference in a residential installation. The uses of equipment generates and radiates radio frequency energy, if not installed and used in accordance with the instructions, may cause harmful interference to radio communications. However, there is no guarantee that interference will not occur in a particular installation. If this equipment does cause harmful interference to radio or television reception, which can be determined by turning the equipment off and on, the user is encouraged to try to correct the interference by one or more of the following measures:

- Reorient or relocate the receiving antenna.
- Increase the separation between the equipment and receiver.
- Connect the equipment into an outlet on a circuit different from that to which the receiver is connected.
- Consult the dealer or an experienced radio/TV technician for help.

The device has been evaluated to meet general RF exposure requirement. The device can be used in portable exposure condition without restriction.