

POPLIGHT

User Manual

Product Description:

POPLIGHT IS A WALL LIGHTING THAT INSTALLS AND REMOVES IN SECONDS WITHOUT ANY DAMAGE TO YOUR WALL 

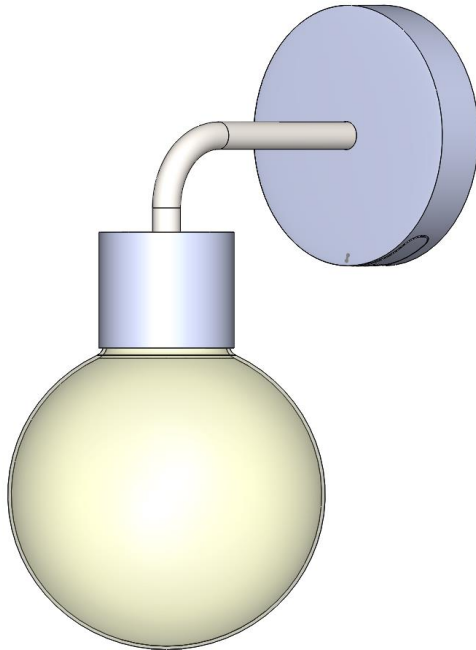

The product includes:

- Lithium-ion Battery (Voltage: 3.7V; Capacity: 4000mAh)
- Bluetooth module (version 5.2)
- LED (brightness: 6000K, 4500K, 3000K)

How to install Poplight:

1. Open the box. Remove the first and second layer of cardboard.
2. Lift Poplight from the box. Use the lever on the Poplight base to remove the battery pack from Poplight. Pop out the battery pack and remove the tape that's labeled 'Remove me' from the battery pack.
3. Use the USB-C charging cable that was in the box to charge the battery pack while you install Poplight.
4. Holding Poplight firmly in one hand from the light fixture base, swivel the removable Poplight base from the Poplight fixture in a counterclockwise direction. This should be done gently but with some pressure applied. You've now separated the base from the Poplight fixture.
5. Remove both pieces of paper on the two pieces of double-sided sticky tape that are already attached to the Poplight base.
6. Identify where you want Poplight to go. Once decided, use the level to adjust the base so you apply your Poplight correctly. Then, firmly press on the base to make a good connection with the wall. Three to four presses are sufficient. Be sure to apply pressure over the area where the tape is sticking to the wall.
7. Now that the base is installed, hold Poplight from the fixture base and swivel Poplight onto the base that's attached to your wall. Simply line up the circle of the Poplight light fixture base with the Poplight base on your wall, tilt the Poplight fixture to the left so the bulb is angled to 10 o'clock, then connect the fixture to the base. Now you can swivel Poplight clockwise to correctly attach the light fixture to the base. Poplight should now be installed level to your wall.
8. Unplug your charging Poplight battery and gently insert the battery into Poplight until it clicks into place. The Poplight logo should be facing towards you while you insert the battery pack.
9. With the battery inserted, tap the button on the side of the battery pack that is visible from the underside of Poplight. The button is to the left of the exposed battery pack.
10. You can choose to keep Poplight plugged into the USB-C charger during this time, or leave Poplight unplugged.

11. Now that you've turned on your Poplight, go to the Google Play or Apple App Store and download the Poplight app.
12. Once downloaded, be within 10 feet of your Poplight and find your Poplight in the app. For quick troubleshooting, step closer to your Poplight and be sure Poplight is on.
13. Once you find your Poplight, click Add in the app.
14. From Adjust Settings in the app you can toggle between color temperatures, dimness, and set a sleep timer for your Poplights.
15. You can also create a group of Poplights (for example two Poplights on either side of a bed) and group them together. Now, you can control the settings of all Poplights in each Group in just a few clicks.
16. You can name individuals and groups of Poplights using the app. The app also provides updates on the battery life of your Poplights.

How to remove Poplight:

1. To remove Poplight, firmly grasp the Poplight fixture from the base of the fixture with one hand. Swivel the fixture counter clockwise until it releases from the base.
2. Once the fixture is removed from the base, place the fixture in a safe spot by resting it on its side.
3. To remove the base from your wall, place one hand on the Poplight base, pressing it gently into the wall.
4. Use your other hand to **slowly pull downwards on one piece of the double-sided sticky tape until it is fully removed.** It is important that you pull straight down slowly (count to 5!).
5. With your hand still firmly pressed on the base, **pull down slowly** on the other piece of sticky tape until it is fully removed. It's important to keep your hand still pressed on the base until the second piece of sticky tape is fully removed.
6. The base should now be removed from the wall.
7. To reinstall your Poplight, reapply double sided sticky tape to the base with the 'wall side' of the tape facing out. Follow the directions for how to install Poplight again.

Note:

This equipment has been tested and found to comply with the limits for a Class B digital device, pursuant to part 15 of the FCC Rules. These limits are designed to provide reasonable protection against harmful interference in a residential installation. This equipment generates, uses and can radiate radio frequency energy and, if not installed and used in accordance with the instructions, may cause harmful interference to radio communications. However, there is no guarantee that interference will not occur in a particular installation. If this equipment does cause harmful interference to radio or television reception, which can be determined by turning the equipment off and on, the user is encouraged to try to correct the interference by one or more of the following measures:

- Reorient or relocate the receiving antenna.
- Increase the separation between the equipment and receiver.
- Connect the equipment into an outlet on a circuit different from that to which the receiver is connected.
- Consult the dealer or an experienced radio/TV technician for help.

Changes or modifications not expressly approved by the party responsible for compliance could void the user's authority to operate the equipment.

This device complies with Part 15 of the FCC Rules. Operation is subject to the following two conditions:

- (1) this device may not cause harmful interference, and
- (2) this device must accept any interference received, including interference that may cause undesired operation.