

Car MP3 FM Transmitter

Model: W1

Features

1. The device can detect car battery voltage.
2. With build-in microphone, supports Bluetooth hands-free calls for safe phone calls.
3. Support mobile phone A2DP function, after Bluetooth connection can directly play HD music.
4. Support for U-disk for music playback, Compatible to MP3/WMA/WAV/ FLAV/APE music formats.
5. Build-in USB & Type-C charging output.

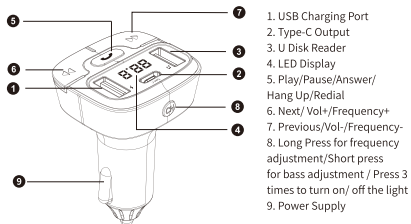

Operation Instruction

1. Start the car engine.
2. Plug the device into the car cigarette lighter hole, the LED light on and display screen flash alternately.
3. Turn on the BT of the mobile phone and search for the product BT name "W1", then connect them successfully, there will be a voice prompt, the rhythm light and display are on after the pairing connection. The device has the memory function, it can be automatically connected after the device is turned on again. (Ensure the mobile phone BT is enabled.)
4. Turn on the car FM radio, tune it to a blank frequency. Long press " CH " to enter the frequency modulation mode. After entering the LED will keep flashing. Adjust the FM channel that matches your car's radio channel. Long press ◀ or ▶ to quickly adjust the frequency. If no action within 5 seconds, the system will automatically confirm the exit.

Frequency-	Short press ◀, long press for quick adjustment
Frequency+	Short press ▶, long press for quick adjustment

Music playback

When connected to BT, you can play music on your phone through BT wireless transmission to your car stereo. You can control the music Play/Pause and Previous/Next song by operating the mobile phone or the device, can also play the music in the U disk.

Play/Pause	Click	⏮
Previous Song	Click	◀
Next Song	Click	▶
Vol+	Long press	▶▶
Vol-	Long press	◀◀

Switch BT/ U-disk input music sources	Click 📞 three times
Bass Adjustment	Short press CH

Press "CH" to adjust the bass effect, and the LED screen will show " bRS "; Press "CH" again to turned off the bass effect , the LED display show " nDr "



Make and Receive Calls

When the device is successfully connected, you can answer or make calls hands-free to keep you safe driving.

Answer/Hang up the call	Click 📞
Reject the call	Long press 📞
Redial	Double Click 📞

Charging Function

This device with 3 interfaces. The one with music symbol can read U disk and play the music in it. The remaining ones are for charging.

Parameter

BT Version: 5.4
Working Voltage: 12V-24V
Limit Voltage: 9-26V
USB-A Output: 5V/2.4A
Type-C Output: 5V/2.4A
FM Frequency: 88.1-108.0MHz
BT Effective Distance: 10M

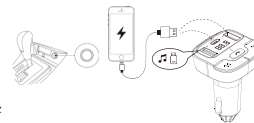

NOTE: This equipment has been tested and found to comply with the limits for a Class B digital device, pursuant to part 15 of the FCC Rules. These limits are designed to provide reasonable protection against harmful interference in a residential installation. This equipment generates, uses and can radiate radio frequency energy and, if not installed and used in accordance with the instructions, may cause harmful interference to radio communications. However, there is no guarantee that interference will not occur in a particular installation. If this equipment does cause harmful interference to radio or television reception, which can be determined by turning the equipment off and on, the user is encouraged to try to correct the interference by one or more of the following measures:

- Reorient or relocate the receiving antenna.
- Increase the separation between the equipment and receiver.
- Connect the equipment into an outlet on a circuit different from that to which the receiver is connected.
- Consult the dealer or an experienced radio/TV technician for help.

Changes or modifications not expressly approved by the party responsible for compliance could void the user's authority to operate the equipment.

This device complies with Part 15 of the FCC Rules. Operation is subject to the following two conditions:

- (1) this device may not cause harmful interference, and (2) this device must accept any interference received, including interference that may cause undesired operation.

RF Exposure Warning Statements:

This equipment complies with FCC radiation exposure limits set forth for an uncontrolled environment. This equipment shall be installed and operated with minimum distance 20cm between the radiator & body.