

Epronic carplay PND

This manual is for "Q8" series radios and some features may differ.

Please refer to the actual product you purchased.

Any installation or usage questions, please contact our Technical Support Center at epronic@outlook.com

Wireless Android Auto



Wireless CarPlay



Note: Different car players and mobile phones have different connection interfaces. All pictures in this manual are for reference only. Please refer to the actual product pictures.

Line diagram:

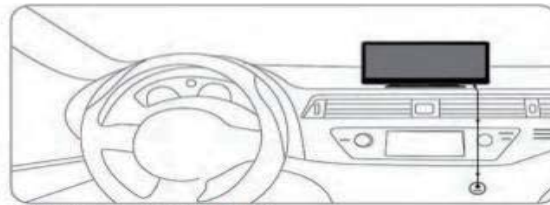

Cigarette lighter wiring diagram

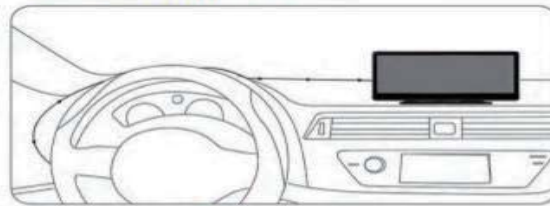

Fuse box power wiring diagram



Wireless module: 2.4GHz

Power supply mode: type-c/AUX/2.5mm AV-IN

Storage: TF card (C10/U1 and above support up to 128GB)

Camera: pull out two ways

Voltage: 12-24V

Main interface:



- 1.Front and Backup Camera interface
- 2.Wireless Carplay/Android Auto
- 3.Screencast: Airplay/Android Mirror
- 4.Volume adjustment/Play or pause song.
- 5.Time setting(manually or automatically by phone connected)
- 6.FM transmitter(keep this unit and your car into same channel
- 7.Bluetooth
- 8.Recorder video playback/take pictures
- 9.Brightness adjustment
- 10.Machine setting

Phone Connection :

Setting--**Mobile Link**--Choose different connection methods

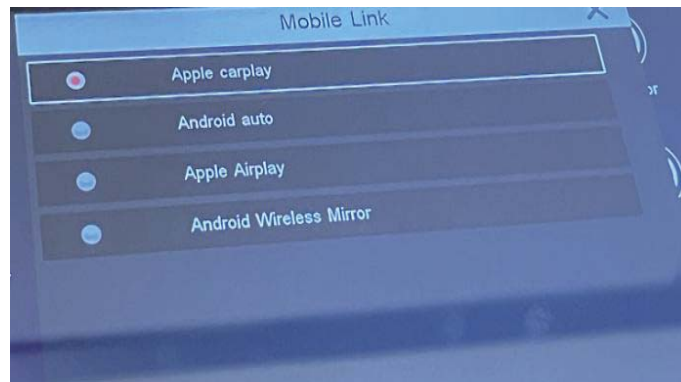

Wireless Carplay/Android Auto:

1. Connect the radio to your iPhone via Bluetooth.
2. If you cannot connect, you need to connect your phone to the radio's hotspot.
3. Car radio with Android Auto: Android 12 and earlier phones are supported. For Android phones, please download the Android Auto application on your phone first.

Airplay/Android Wireless Mirror:

Android phones two-way control via usb or wifi connection, IOS one-way control via wifi. Synchronous display all contents of your phone.

Note for Carplay function

1. The Carplay function only supports iPhone connection

Note for Android Auto function

1. The Android Auto function can only support the connection of Android phones, and the Huawei version of phones does not support connection
2. Your Android phone needs to support Google services and install Android Auto software

Other matters needing attention

1. The built-in Carplay APP of different machines are different.

Backup Camera:



This unit only support 1080P AHD Backup Camera.

ASIN: B0C4TZ5229

- Camera power cable: 2.5mm AV-IN
- Red connection to reverse the positive light,
black to reverse the negative light.

Quick & Easy Installation



Loop Recording:

Click "Recorder"--Switching front/rear view;



Split Screen: Carplay & Dash CAM

Setting--**Carplay position**--Getting Carplay and front cam split screen function



How to get sounds work?

Multiple Sound Playback Channels

Bluetooth:

Bluetooth Transmit for Carplay/Android Auto: The wireless carplay stereo can transmit car play/android auto audio to car speakers via BT. CARPLAY call sound channel is in the CARPLAY channel, not in the BT channel, if you are connected to BT in CARPLAY to make a call to cut the channel, otherwise there is no sound.

AUX:

AUX port is near the power cable. The side 3.5mm connector is not functional. Connect this portable carplay screen and the car through

FCC WARNING

This device complies with part 15 of the FCC Rules. Operation is subject to the following two conditions: (1) This device may not cause harmful interference, and (2) this device must accept any interference received, including interference that may cause undesired operation.

Note: This equipment has been tested and found to comply with the limits for a Class B digital device, pursuant to part 15 of the FCC Rules. These limits are designed to provide reasonable protection against harmful interference in a residential installation.

FCC WARNING

This equipment generates, uses and can radiate radio frequency energy and, if not installed and used in accordance with the instructions, may cause harmful interference to radio communications.

However, there is no guarantee that interference will not occur in a particular installation. If this equipment does cause harmful interference to radio or television reception, which can be determined by turning the equipment off and on, the user is encouraged to try to correct the interference by one or more of the following measures:

- Reorient or relocate the receiving antenna.**
- Increase the separation between the equipment and receiver.**

FCC WARNING

—Connect the equipment into an outlet on a circuit different from that to which the receiver is connected.

—Consult the dealer or an experienced radio/TV technician for help.

Note: The Grantee is not responsible for any changes or modifications not expressly approved by the party responsible for compliance. such modifications could void the user's authority to operate the equipment.

FCC Radiation Exposure Statement:

The equipment complies with FCC Radiation exposure limits set forth for uncontrolled environment. This equipment should be installed and operated with minimum distance 20cm between the radiator and your body