

✶PUSHKA™



Pushka Home

User Manual

FCC Statement

1. This device complies with Part 15 of the FCC Rules. Operation is subject to the following two conditions:

(1) This device may not cause harmful interference.

(2) This device must accept any interference received, including interference that may cause undesired operation.

2. Changes or modifications not expressly approved by the party responsible for compliance could void the user's authority to operate the equipment.

NOTE:

This device has been tested and found to comply with the limits for a Class B digital device, pursuant to Part 15 of the FCC Rules. These limits are designed to provide reasonable protection against harmful interference in a residential installation.

This device generates uses and can radiate radio frequency energy and, if not installed and used in accordance with the instructions, may cause harmful interference to radio communications. However, there is no guarantee that interference will not occur in a particular installation. If this equipment does cause harmful interference to radio or television reception, which can be determined by turning the equipment off and on, the user is encouraged to try to correct the interference by one or more of the following measures: Reorient or relocate the receiving antenna.

Increase the separation between the equipment and receiver.

Connect the equipment into an outlet on a circuit different from that to which the receiver is connected.

Consult the dealer or an experienced radio/TV technician for help.

This equipment complies with FCC radiation exposure limits set forth for an uncontrolled environment. This equipment should be installed and operated with minimum distance 20cm between the radiator & your body.

Warnings

Please follow these simple guidelines to avoid some untoward incidents. Failure to do these may be dangerous or illegal.

TURN ON SAFELY

Do not turn on the device in areas where it is prohibited or when it may cause interference and danger.

ROAD SAFETY

Obey all road safety laws. Avoid using device and concentrate on driving instead.

INTERFERENCE

All wireless devices may be sensitive to interference, which may affect its performance.

TURN OFF IN HOSPITALS

Follow all restrictions. Turn off the device near medical equipment.

TURN OFF ON AIRCRAFTS

Put off the device before boarding. Wireless devices can cause interference on aircrafts.

TURN OFF WHEN REFUELING

Do not use the device near refueling stations or combustible chemicals.

USE SENSIBLY

Only qualified personnel may install or repair this product.

ENHANCEMENTS AND BATTERIES

Use only appropriate battery. Do not use non-authorized batteries as it may damage the device.

WATER-RESISTANCE

Your device is not water-resistant. Keep it dry.

BACKUP COPIES

It is advisable for you to back-up copies or keep a written record of all important information stored in your device.

CONNECTING TO OTHER DEVICES

When connecting to any external device, read its user's guide for detailed and safety instructions. Do not connect with incompatible products.

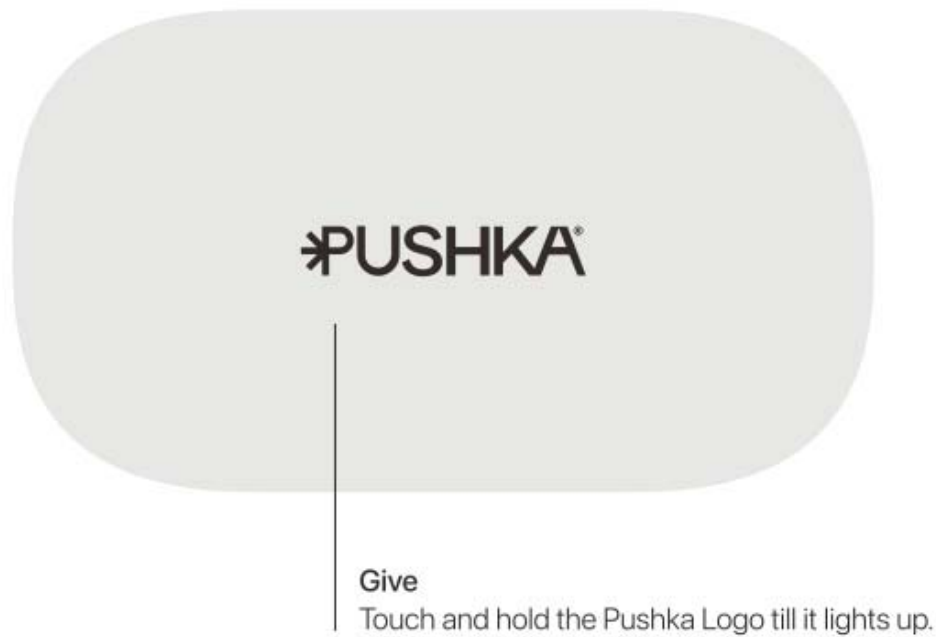
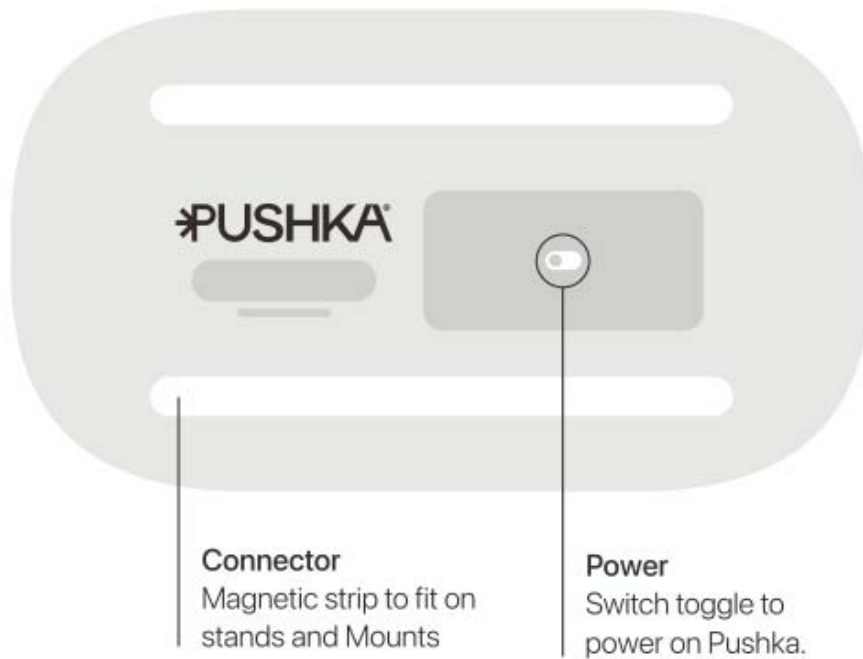

Color Indicator

Green	Successful transaction
Blue	Pushka going to sleep
Red	Transaction error

Start to Use

Turn the power switch to the right, turn on the device, and start the self check program.

After the device's blue light flashes and goes out, the device completes program detection and enters a sleep state.

When touching the logo area with your fingers, the device will be activated and start sending preset instructions to the server, which takes approximately 20 to 45 seconds. Based on the quality of the network environment at that time, the better the network quality, the less time it takes.

After the device completes sending instructions, the green light flashes, and then the blue light flashes to enter sleep again.

When the device program encounters an error and fails to complete the preset command sending, the device will turn on a red light for 5 seconds.

Reminder:

This device is a IoT device. the use LTE CAT-M1 network and supports LTE B2 B4 B12 B13 band.