

User manual

M57F Outdoor bluetooth lighting speaker



## what's in the box?



Bluetooth speaker\*1



Charging cable\*1



Instruction\*1



## Product figure

- 1.TWS
- 2.Light key
- 3.Volume"-"/ Last song
- 4.Pause/play incoming call answer/reject
- 5.On/Off

- 6.Volume"+"/ Next song
- 7.TYPE-C connector
- 8.pilot lamp
- 9.TF card
- 11.AUX

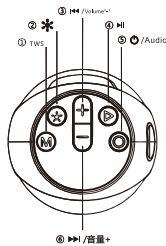

## 3.Music control

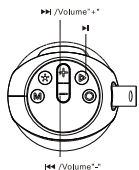

○/⏮ Short press x1 Volume"-"/" "+"

○/⏮ Long press Last/Next song

▷ Short press x1 Play/Pause

## 4.Answer the phone

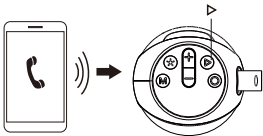

▷ Short press x1 Answer/Hang up

▷ Long press Reject call

▷ Short press x2 Dial the last call



## TWS mode

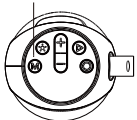

▷ Short press x2

Double click "M" TWS ON/OFF



## Product charge



Red light on The battery is charging

Red light off Fully charged

To preserve battery lifespan · fully charge at least once every 45days

## Specifications

| Product name       | LED Protoble Bluetooth Speaker |
|--------------------|--------------------------------|
| Model name         | M57F                           |
| Bluetooth version  | V5.3                           |
| Product size       | 94*91*213mm                    |
| Bluetooth distance | ≥10m ( open distance )         |
| Play time          | 4 hours                        |
| Play mode          | BT/TWS/TF/AUX                  |
| Battery            | 1200mAh                        |
| Charging input     | DC 5V-1000mAh                  |
| Charging time      | ≤ 2 hours( 5V/1A )             |
| Output power       | 10W                            |
| Distortion rate    | THD<10%                        |
| Frequency response | 20Hz-20KHz                     |
| The horn           | 57MM * 2                       |



## Bluetooth



### 1.Bluetooth connection

Turn on the speaker and Enter pairing mode

Long press

Lighting is runing fast if bluetooth device not connected , use the bluetooth device to search for " M57F " and click to connect.

Short press x1

Audio switch mode

Short press

disconnect bluetooth device

### 2.Light mode

Short press x1

Double click turn on/turn off



## Charging and battery information :

1. This product has a built-in non-removable and rechargeable battery. Please use theequipped micro USB cable to charge the battery.
- 2.The charging current voltage is 5V/1A · and the product can not be recharged with a chargerof more than 5V/1A.
- 3.Please choose the charger that passes the regular manufacturer's safety certification.
- 4.Repeated charging on the speaker will cause battery performance degradation overtime · which is a normal phenomenon for all rechargeable batteries.

## FCC STATEMENT

1. This device complies with Part 15 of the FCC Rules. Operation is subject to thefollowing two conditions:  
(1) This device may not cause harmful interference, and  
(2) This device must accept any interference received, including interference thatmay cause undesired operation.
2. Changes or modifications not expressly approved by the party responsible forcompliance could void the user's authority to operate the equipment.NOTE: This equipment has been tested and found to comply with the limits for aClass B digital device, pursuant to Part 15 of the FCC Rules. These limits are designedto provide reasonable protection against harmful interference in a residentialinstallation. This equipment generates uses and can radiate radio frequency energy and, if notinstalled and used in accordance with the instructions, may cause harmfulinterference to radio communications. However, there is no guarantee thatinterference will not occur in a particular installation. If this equipment does causeharmful interference to radio or television reception, which can be determined byturning the equipment off and on, the user is encouraged to try to correct theinterference by one or more of the following measures:  
Reorient or relocate the receiving antenna.  
Increase the separation between the equipment and receiver.  
Connect the equipment into an outlet on a circuit different from that to whichthe receiver is connected.  
Consult the dealer or an experienced radio/TV technician for help.