

PEACHBITE WATCH season2

User Manual

Quick Access to User Page



Quick Access to User Manual



Caution for Use

❗ Please read all of the following to use this product safely.

We and the manufacturer are not liable for damage, failure, or accidents caused by failure to follow the prohibitions and recommendations while using this device.

Prohibitions

- Do not submerge the device in water or pour water over it.
- Do not disassemble internal circuit components when replacing the band.
- Do not use this device for purposes other than monitoring the health of your pet.
- Do not throw or subject the device to strong shocks.
- Do not spray any substances onto the device.
- Use a 220V adapter compatible with the included charging cable's USB connection for power.
- (Applies to South Korea)

Recommendations

- Avoid using outdoors on rainy days.
- Please use the included charging cable for charging.
- It is possible to charge the watch or power the relay using an external battery for charging.
- (USB 5V output).

주식회사 맥스케이코리아

(08504) 서울 금천구 가산디지털2로 165 백상스타타워2차 608호

EMAIL contact@maxkkorea.com WEB www.peachbite.pet TEL +82-2-867-9319

COMPOSITION AND PART NAMES

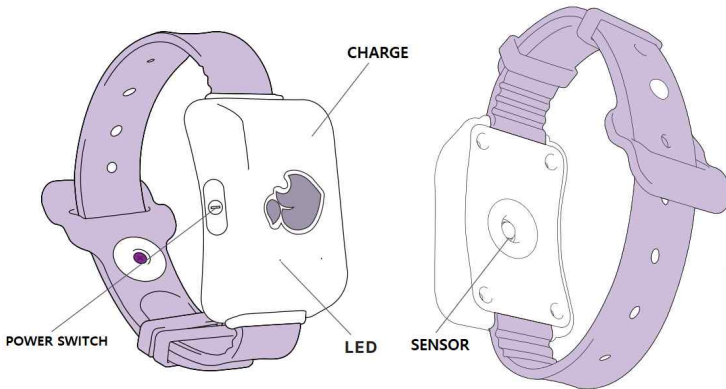
**PEACHBITE WATCH**

A device composed of sensors and a charging part,
which is worn by pets to measure their biometric data.

COMPOSITION AND PART NAMES

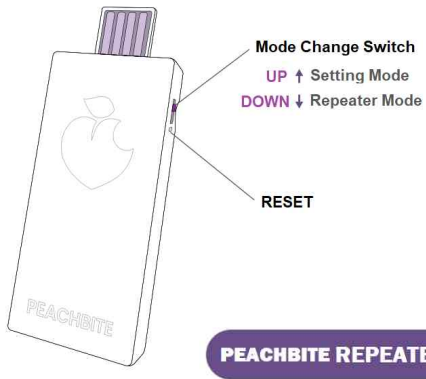

DEVICE COMPOSITION

- PEACHBITE WATCH
- PEACHBITE REPEATER
- 5pin USB Charging Cable
- Device QR Code
- User Manual

Receives pet's data from the Peachbite Watch and transmits it to the server, allowing you to check the pet's health status from anywhere at anytime.

INSTALLATION FOR FIRST USER



Preparations

Mobile phone, Peachbite watch, Peachbite repeater, power supply adapter or power bank,
home Wi-Fi ID and password (general Wi-Fi, not 5G)

REGISTERING YOUR PET

STEP 01

After completing the mobile registration (<https://app.peachbite.co.kr/>), start registering your pet! Register your profile picture and press the Next button.

TIP. It looks prettier if you upload it as a square (1:1) ratio photo.

STEP 02

Enter your pet information and click the Next button to complete your pet registration!

Please register your pet's photo

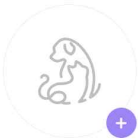

Register your profile picture

TIP

정방향 (1:1) 사진으로 올리면
더 예쁘게 보여요

NEXT

STEP 01

Please enter your pet's information

반려동물 종류 (Pet's type)

반려동물 품종 Breeds of pet

반려동물 이름 Pet's name

반려동물 생년월일(YYYYMMDD) Birth date

반려동물 몸무게(kg) Pet's weight

반려동물 성별 Gender

Register

STEP 02

REGISTERING A REPEATER

STEP 01

After completing pet registration, press the start button for repeater registration

STEP 02

Enter the 12-digit ID attached to the repeater

Or, press the QR code button to recognize the provided repeater QR code.



Pet registration complete!

**Shall we register
the repeater?**

START

STEP 01

QR code recognition



Repeater No.

**Enter the 12-digit ID
attached to the repeater**

**Or, press the QR code
button to recognize the
provided repeater QR
code.**

NEXT

STEP 02

REGISTER YOUR WATCH

STEP 01

After completing the repeater registration, press the watch registration start button

STEP 02

Select a pet to register to the watch on the home screen.

STEP 03

Enter the 12-digit ID attached to the Watch Or, press the QR code button to recognize the provided Watch QR code. Watch ID is in the original box



Repeater setup complete!

Shall we register the Watch?

START

STEP 01

나의 펫 리스트



2초-2 (6)

Test

Repeater select 선택해주세요.

Select a pet to register to the watch on the home screen.

NEXT

STEP 02

QR code recognition



Watch No.

Enter the 12-digit ID attached to the Watch

Or, press the QR code button to recognize the provided Watch QR code.

NEXT

STEP 03

REGISTERING A WATCH & SETTING UP A REPEATER

STEP 04

Basic setup is complete.
Turn on the watch and
follow the repeater and
indoor Wi-Fi settings.

STEP 05

Move the switch on the
side of the repeater up to
change to [Setting Mode]
and connect it to an
adapter or power bank.



Basic setup is complete!

Turn on the watch and follow
the repeater and indoor
Wi-Fi settings.

워치의 전원을 켜고
아이의 목에 채워주세요.
중계기 설정을 따라하시면서
우리 아이의 생체 정보를 가져오겠습니다.

START

STEP 04

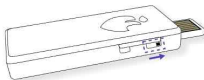

**Move the switch
on the side of the provided
repeater to the terminal
to change to the setting
mode and connect it to the
adapter (or power bank)
to supply power.**

**When power is supplied,
the center of the repeater
emits a purple light.**

NEXT

STEP 05

REGISTERING A WATCH & SETTING UP A REPEATER



Mobile Phone [Settings] ► Connections [Wi-Fi]
'Peachbite Gateway' Select
Password 'i@love@pet' enter



STEP 06

Select 'Peachbite Gateway' in your phone's Wi-Fi settings and enter 'i@ love@pet' in the password field.

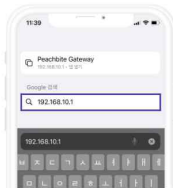

Your Browser
'192.168.10.1' Enter



STEP 07

Connect by entering '192.168.10.1' in the browser

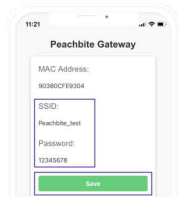

To connect the Repeater to Wi-Fi
Your **Wi-Fi SSID & Password** Enter and Save



STEP 08

Enter the Wi-Fi name you are using in SSID and the Wi-Fi password in Password and save it. 5G Wi-Fi is not supported. Wi-Fi input requires case sensitivity. 9

REGISTERING A WATCH & SETTING UP A REPEATER



Remove REPEATER from USB port
(Power OFF)

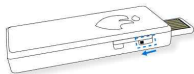

STEP 09

**REPEATER**

Setting Mode → Repeater Mode Change
Re-energize the REPEATER
(Insert into USB port)

Repeater is connected to Wi-Fi,
Blue light flickers in Repeater Mode.

NEXT

STEP 09

After cutting off the power supply to the repeater (removing it from the USB port), switch the repeater from setup mode to transmission mode, and supply power to the repeater again.

(Insert into USB port)

If the repeater is connected to indoor Wi-Fi, the blue light blinks in repeater mode.

SETTING UP A HOTSPOT FOR A WALK [ANDROID]

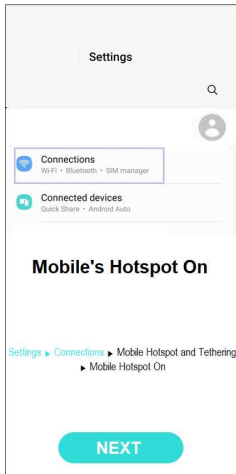

STEP 01

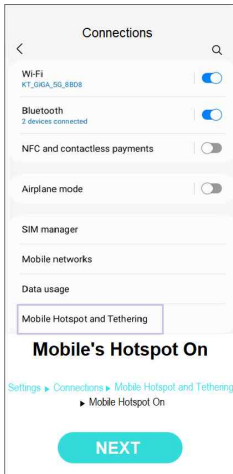

STEP 02

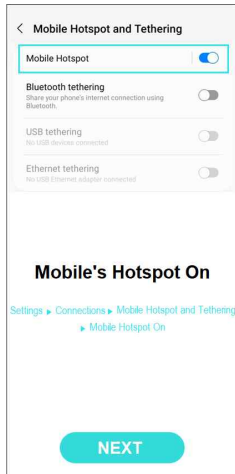

STEP 03

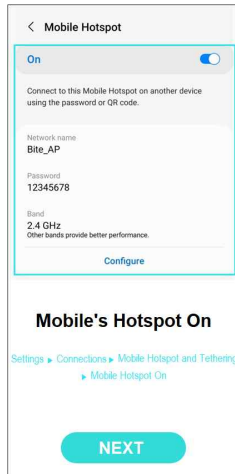

STEP 04

SETTING UP A HOTSPOT FOR A WALK [IOS]

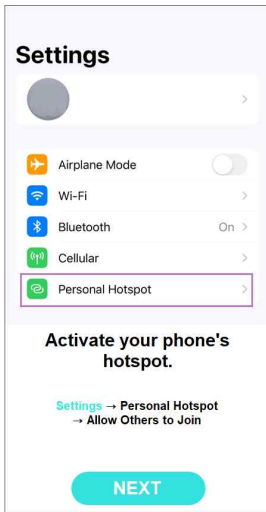

10/16/2023 STEP 01

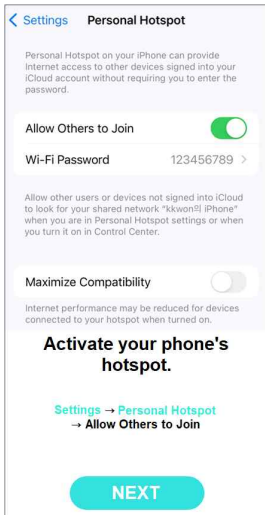

STEP 02

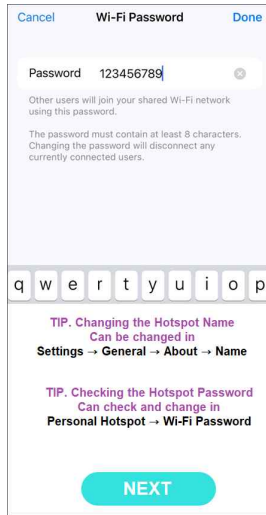

STEP 03

SETTING UP A HOTSPOT FOR A WALK[Android+IOS]

GateWay ID: C4DEE2C143E4

AP1: Hotspot Network name

PW: Hotspot Password

AP2: (선택) 예비 보호자 핫스팟

PW2: (선택) 예비 보호자 핫스팟

Save

GateWay ID: C4DEE2C14408

Hotspot information enter,
Click the **Save** button.

NEXT

STEP 04

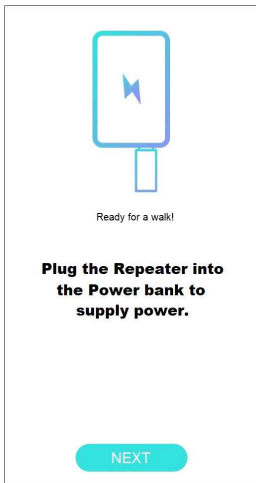

STEP 05

STEP 04

You can designate a hotspot for walking with your dog when selecting a registered repeater

Please enter the hotspot information you checked earlier.

AP1: Enter parental hotspot name

PW: Enter parental hotspot password Please save after entering

STEP 05

After the initial setting, you can just connect the repeater to the power bank and leave immediately when walking.

Enjoy an exciting walk now!

LED LIGHTS

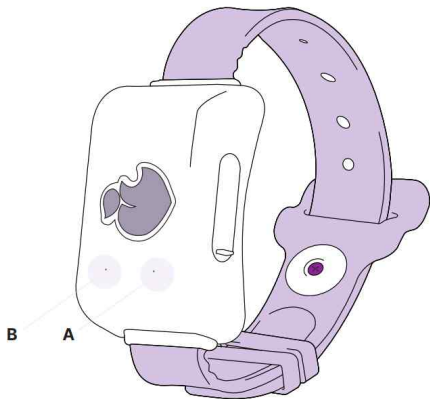

- Charing The red or orange light on A lights up and the device does not operate.
- Full charge : A yellow-green light turn on.
- Device On-Off : Press and hold the power button, B will flash a blue light quickly.
- Device On : The light of B flashes weakly once every 0.5 seconds.

LED LIGHTS

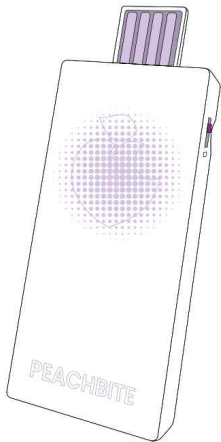

- Purple Light : The Repeater is in the setting mode.
- Blue Light : The Repeater is setup correctly and is ready to receive data.
- Red Light : Repeater's settings are incorrect.
- When the blue light is blinking, the WATCH and the REPEATER are sending and receiving data.

SPECIFICATION

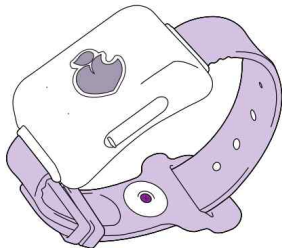

Model	PEACHBITE WATCH PbW-S1_KR		
Battery	Lithium Polymer Battery	Usage Time	10 Days
Charging Time	4 Hour	※ The usage time may vary depending on the number of times the battery is used.	
Charging Type	Micro USB 5pin	Body Material	PC
Communication	Bluetooth	Strip Material	Silicon
Weight	Large : 67g / Small 50g	KC Certification	R-R-mkK-PbW

SPECIFICATION



Model	PEACHBITE REPEATER PbG-S2
Battery	Constant power supply
Communication	Wi-Fi / Bluetooth
Weight	11g
Body Material	ABS
KC Certification	R-R-mkK-PbG-S2

Product A/S

- For questions about device repair, handling, management, and apps, contact the customer service center or the place where you purchased the device.
- Please receive the warranty after confirming that the 'purchase date' and 'dealer information' are written at the place of purchase.
- In the case of a paid A/S request, if there is no purchase warranty, you must present the purchase receipt specifying the product name and place of purchase.
- The warranty period is one year from the date of purchase. If you request repair within the warranty period, please contact the customer service center or the place of purchase.
- The warranty period can be applied based on the contents of the warranty or purchase details.
- Repair fees will be charged for breakdowns caused by customer negligence, such as damage due to impact or submersion.
- After the warranty period has elapsed, paid repairs are provided through the customer service center.
- However, if 3 years have passed since the release date of the product, repair may be difficult depending on availability of parts.

Warranty

Buyer Name / Contact No.:

Date of purchase / Place of purchase :

Model & Size :

WATCH ID :

REPEATER ID :

※ Supplied with QR code.

Customer Consulation

MAX K Inc. (USA)

9945 Warwana Rd, Houston Texas 77080

EMAIL contact@maxkkorea.com **WEB** www.peachbite.pet **TEL** +82-2-867-9319

NOTE:

This equipment has been tested and found to comply with the limits for a [Class B digital device](#), pursuant to part 15 of the FCC Rules. These limits are designed to provide reasonable protection against [harmful interference](#) in a residential installation. This equipment generates, uses and can radiate [radio frequency energy](#) and, if not installed and used in accordance with the instructions, may cause [harmful interference](#) to radio communications. However, there is no guarantee that interference will not occur in a particular installation. If this equipment does cause [harmful interference](#) to radio or television reception, which can be determined by turning the equipment off and on, the user is encouraged to try to correct the interference by one or more of the following measures:

- Reorient or relocate the receiving antenna.
- Increase the separation between the equipment and receiver.
- Connect the equipment into an outlet on a circuit different from that to which the receiver is connected.
- Consult the dealer or an experienced radio/TV technician for help.

FCC Radiation Exposure Statement:

This equipment complies with FCC radiation exposure limits set forth for an uncontrolled environment. This equipment should be installed and operated with minimum distance 20cm between the radiator & your body.

This device complies with Part 15 of the FCC Rules. Operation is subject to the following two conditions:

- (1) This device may not cause harmful interference, and
- (2) this device must accept any interference received, including interference that may cause undesired operation.

Caution: Any changes or modifications to the equipment not expressly approved by the party responsible for compliance could void user's authority to operate the equipment