

PORTABLE POWER STATION

User Manual

SENCI

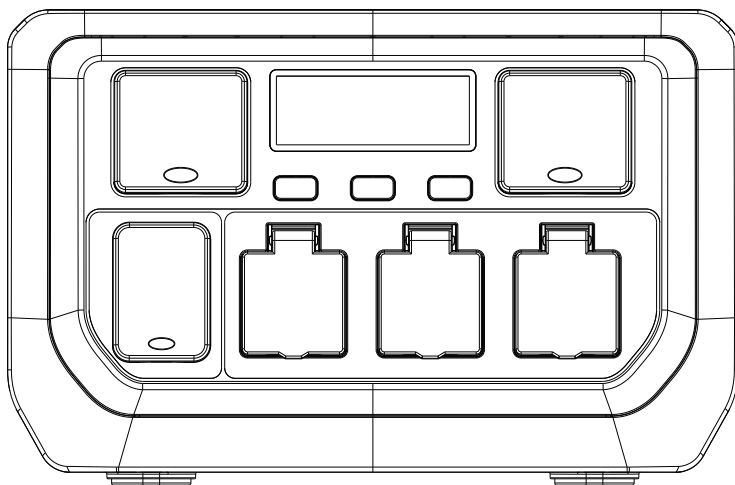

SC-1200

Disclaimer

Before use, please read the user manual of this product to ensure correct use after complete understanding. After reading, please keep the user manual for future reference. If you do not operate this product properly, you may cause serious injury to yourself or others, or cause product damage and property damage. By using this product, you will be deemed to have understood, approved and accepted the full terms and contents of this document. The user undertakes to be responsible for his actions and all consequences arising therefrom. Senci shall not be liable for any loss caused by the user's failure to use the product in accordance with the User Manual. In compliance with the laws and regulations, the Company has the right to the final interpretation of this document and all documents related to this product. Updates, modifications or terminations are subject to notice.

Please visit Senci's official website for the latest product information.

This newly designed solar generator SC-1200 uses high-quality lithium-ion batteries as the main body for energy storage. Compact size, light weight, large capacity, easy to carry, with built-in USB ports, DC and AC outputs, this unit can provide power solutions to you quickly and easily wherever you are in outages or outdoors.

Please read this user manual carefully before using this unit. If you have any questions, please feel free to contact us.

- Use the Power Cable provided to charge the unit and keep it works properly.
- Please read this manual before using this unit, check whether the product is in good condition and whether the accessories are complete.
- Product upgrades, appearance and screen printing will be adjusted locally without notice, please refer to the actual product.

WHAT YOU GET

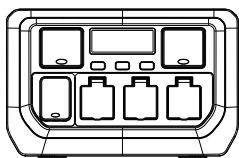

Portable Power Station

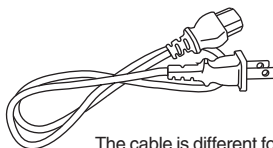

The cable is different for different regions.

Power Cable

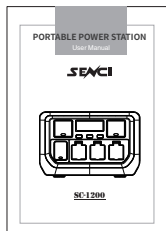

User Manual

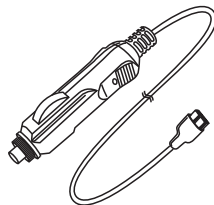

Car Charger Cable

CATALOG

Safety Instructions	04
Product Specifications	05
Product appearance introduction	06
Smart LCD Display Screen	07
Recharging Ways	08
How to Use	09
Tips for Use	10
Potential Failure Analysis	12

Safety Instructions

Usage

- Do not use the product near a heat source, such as a fire source or a heating furnace. 2. Avoid contact with any liquid. Do not immerse the product in water or get it wet. Do not use the product in rain or humid environments.
- Do not use the product in an environment with strong static electricity/magnetic fields
- Do not disassemble the product in any way or pierce the product with sharp objects.
- Avoid using wires or other metal objects that may result in a short circuit.
- Do not use unofficial components or accessories. If you need to replace any components or accessories, please visit official SENCI channels to check relevant information.
- When using the product, please strictly follow the operating environment temperature specified in this user manual. If the temperature is too high, it may result in a fire or explosion. If the temperature is too low, the product performance may be severely reduced, or the product may cease to work.
- Do not stack any heavy objects on the product.
- Do not lock the fan forcibly during use or place the product in an unventilated or dusty area.
- Please avoid impact, falls, or severe vibrations when using the product. In case of a severe external impact, turn off the power supply immediately and stop using the product. Ensure the product is well fastened during transportation to avoid vibrations and impacts.
- If you accidentally drop the product into water during use, please place it in a safe open area, and stay away from it until it is completely dry. The dried product should not be used again, and should be properly disposed of according to Section 2.2 below. If the product catches fire, we recommend that you use the fire extinguishers in the following order: water or water mist, sand, fire blanket, dry powder, and finally a carbon dioxide fire extinguisher.
- Use a dry cloth to clean off dirt on the product ports
- Rest the product on a flat surface to avoid damages caused by the product falling over. If the product is overturned and severely damaged, turn it off immediately, place the battery in an open area, keep it away from combustible matter and people, and dispose of it in accordance with local laws and regulations.
- Ensure that the product is kept out of reach of children and pets.

Disposal Guide

- If conditions permit, make sure that the battery is fully discharged before disposing of it in a designated battery recycling bin. The product contains batteries with potentially dangerous chemicals, so it is strictly prohibited to dispose of it in ordinary trash cans. For more details, please follow the local laws and regulations on battery recycling and disposal.
- If the battery cannot be fully discharged due to a product failure, please do not dispose of the battery directly in the battery recycling box. In such case, you should contact a professional battery recycling company for further processing.
- Please dispose of over-discharged batteries that cannot be recharged.

UN38.3 Made in China



Product Specifications

Basic Specifications

Net weight: 14.5kg

Dimension: 341*228*236mm

Battery Capacity: 45Ah, 1152Wh.

Battery cycle life: ≥ 3000 times, remaining capacity $> 80\%$ (LiFePO₄)

Type of protection: High temperature protection, low temperature protection, over discharge protection, over charge protection, over load protection, short circuit protection, over current protection

Output

Wireless Charging : 15W

DC 5521 Output $\times 2$: 13.6V \approx 5A, total 8A.

Car Outlet Output: 13.6V \approx 8A

(DC 5521 Output (2)+ Car Outlet Output: Total 8A max.)

FAST CHARGE Output $\times 2$: 5V \approx 2.5A, 9V \approx 2A, 12V \approx 2A(24W max)

USB-C 100W Output $\times 2$: 5V \approx 3A, 9V \approx 3A, 12V \approx 3A, 15V \approx 3A, 20V \approx 5A
(100W max), total 200W.

AC Output $\times 3$: 110V \sim 50Hz, total 1200W.

Input

PV Input: 18V–25V \approx 20A max; 12V, 100W max.

AC Input : 100V \sim 120Vac 50–60Hz, 700W max.

Product appearance introduction

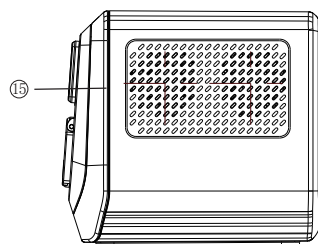
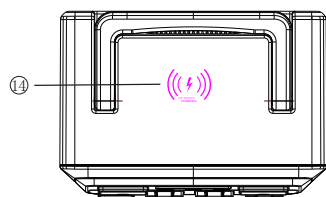
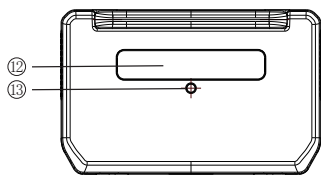
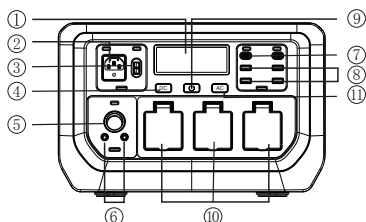

1.LCD display

Display the power and usage status of the unit.

2.AC Recharging Input

Insert the power cord connector into this port and then connect it to the mains.

3.Car/Solar input

Support 3(100W) solar panels in parallel, and support 18-25V,300W input; Support car max 100W.

4.DC output switch

This button controls the product's auto charge output and the DC output of the two DC output ports.

5.Car output

6.DC output

This port is an output port, so input charging is prohibited.

7.USB-C 100W output

8.FAST CHARGE output

9.Power switch

Click the power button to turn on the product, turn on the USB output port and top wireless charging.
Double click the power button to enter ECO mode.
Long press the power button to turn off.

10.110V AC output

Charge a device with a voltage requirement of 110V.(Do not support all excess appliances, the power of the power of the powered device should be less than 1200W).

11.AC output switch

This button controls the AC outputs, turn off this switch when not in use.

12.LED light

The LED light has five modes, including: three brightness adjustments (25%, 50%, 100%), SOS mode and pop mode.

13.LED light button

Choose the mode of the LED light.

14.Wireless charging

It supports 15W wireless charging function.

15.Cooling fan

Colling fan prevent the unit from overheating. Be careful not to obstruct the heat dissipation holes.

Smart LCD Display Screen

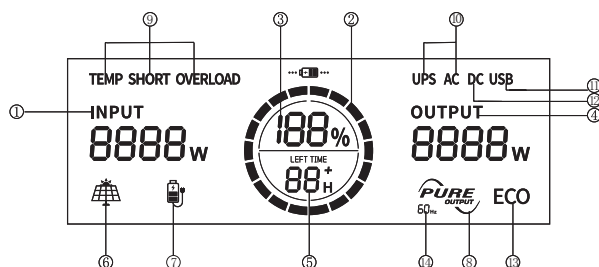

1.Input power

Display the current input power of the unit in watts in real time.

2.Battery indicator

Display the remaining battery, and the icon rotates when charging and discharging.

3.Battery charge percentage

Display the percentage of remaining battery, and when the remaining battery is less than 5%, charge it.

4.Output power

Display the current output power of the unit in watts in real time.

5.Remaining charge/discharge time

The remaining charging/discharging time is based on the current power consumption of the unit.

6.Solar panel charging / Car charging

When the product recognizes the charging input of the solar panel or car charging, this icon will light up.

7.AC Recharging Input

When the product is connected to mains charging, this icon will light up.

8.Pure sine wave

When the AC output is used, pure sine wave AC output icon appears on the screen.

9.TEMP SHORT OVERLOAD

When the product triggers the protection mechanism, the corresponding icon will light up.

10.AC output

When AC output occurs, the AC icon will light up; When bypassing input and output, the UPS icon will light up;

11.USB output icon

When the USB output port is in use, the USB output icon appears on the screen.

12. DC output

When the Dc output port is in use, the Dc output icon appears on the screen.

13.ECO mode

After double-clicking the power button to enter energy-saving mode, the ECO icon will light up.

14. Frequency Display Icon

When the frequency displays 50/60 Hz, it indicates the current frequency status.

Recharging Ways

Example 1:

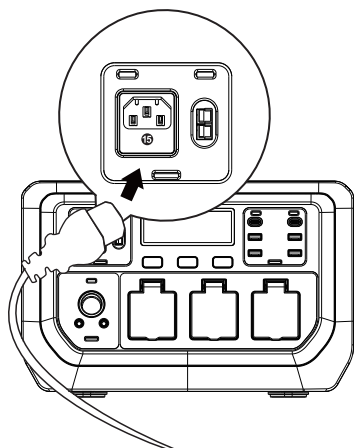

AC Charger Cable

When the AC input current is continuously greater than 15A, the AC input port thermal protector will protect itself, and the button will pop up automatically. After confirming that the product has no fault, press the AC input overload protector to resume charging;

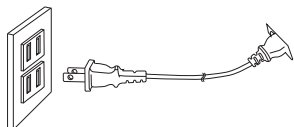

Wall Charger

It takes about 1 hours to recharge 80%.
It takes about 1.6 hours to recharge 100%.



2%

Charging: the battery level indicator rotates.



100%

Fully charged: all battery segments will be lit and remain solid.

Example 2:

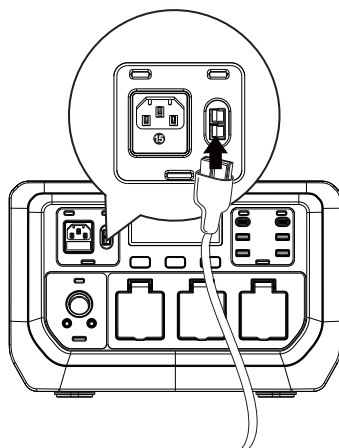

Anderson connector

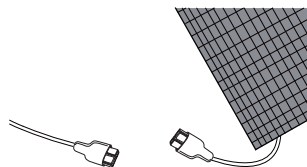

Solar Panel

Charging time is determined by the light intensity and light area.
(solar panels are optional accessories)



2%

Charging: the battery level indicator rotates.



100%

Fully charged: all battery segments will be lit and remain solid.

How to Use

Example 1:

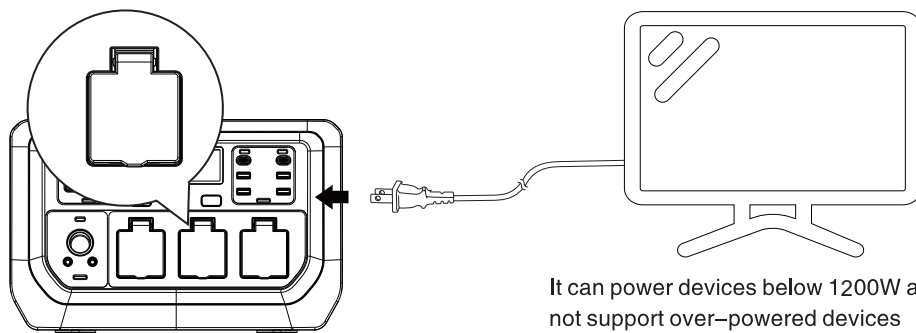

Example 2:

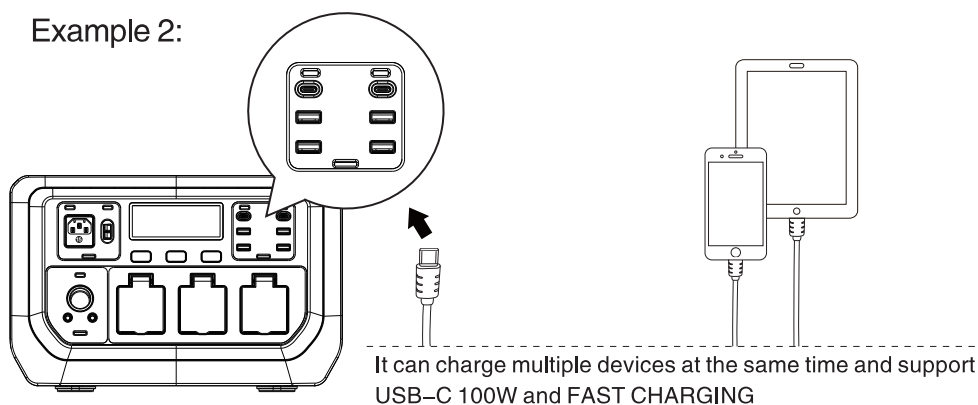

Example 3:

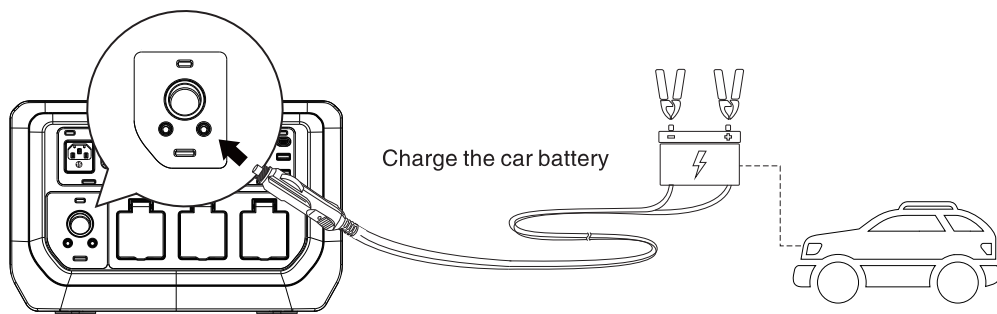

How to Use

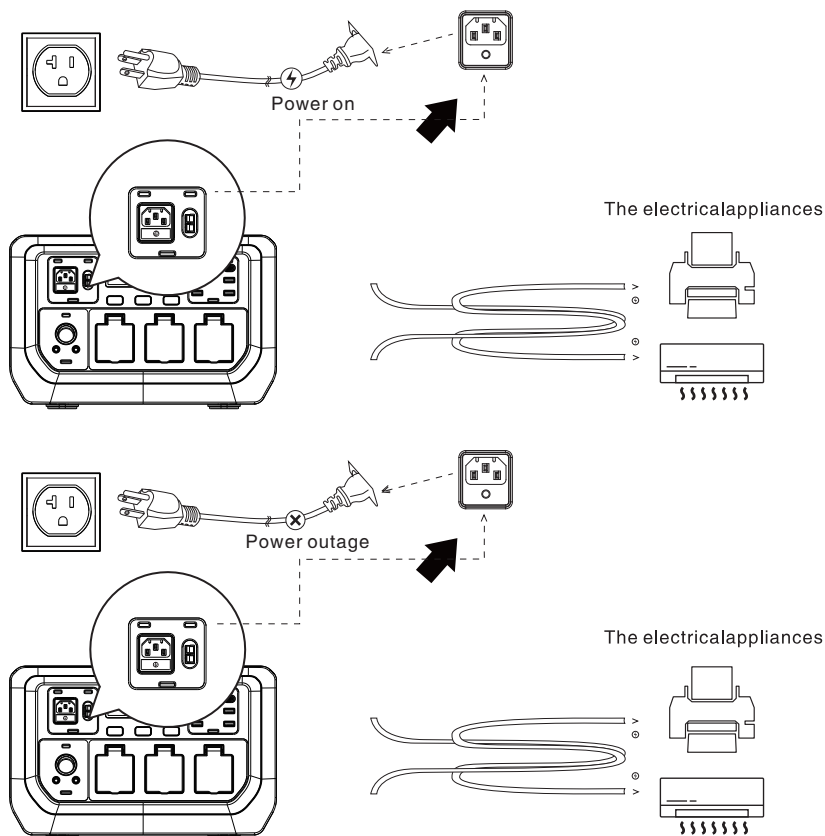

This product supports UPS function, connect the power plug to the AC input port of this product through the AC charging power cord, the electrical appliances can use the AC output port of this product to work (at this time, the AC power comes from the Mains electricity, not the station supply), when the Mains electricity is suddenly cut off, this product will automatically switch to the station supply mode within 25ms. It is recommended to use only one load during the utilization, do not use more than one load at the same time to avoid the overload protection of this product. If the power supply can not operate normally or not according to the instructions caused data loss, our company will not be responsible for it.

Note: When connecting to the mains, you need to switch on the AC output first and make sure the UPS function icon is lit before switching off the machine to enter the UPS switching function. Under normal conditions, the mains power is supplied directly to the load, when the product is fully charged (SOC is shown as 100%).

Tips for Use

- This unit has built-in high-quality LiFePO₄ batteries, large capacity, long-lasting and durable. We recommend that you use it in the range of 5 to 35°C environment.
- If you do not use this unit for a long time, check that all switches are off.
- In order to extend the life span of this unit (LiFePO₄ battery), it is recommended to charge once in every 3 months, at least once in every 6 months, to prevent the battery from losing power.
- During the use of this unit, do not block the fan exhaust. This unit integrates overload, overheating, short circuit, over voltage, under voltage and other safety protection technologies, after troubleshooting, turn off the power switch and reopen it to reset the power supply to work again, if the reopening switch is invalid, you need to connect to the charger to charge 5s to wake up the battery, the unit can work normally.
- The LED illumination can be adjusted to five modes 25%,50%, 100% brightness, SOS mode, and flashing mode. Every time it can be adjusted by clicking the light button repeatedly with 1S interval.

Recycling

Please send the used electronics, batteries and packaging materials to the recycle bin especially for LiFePO₄ batteries. This can help with waste disposal and promote material recycling, to protect environment!

Battery Information

This unit has built in high quality LiFePO₄ batteries. Do not disassemble the unit and remove the battery privately in case of destroying the unit. Batteries can be charged and discharged hundreds of times or more.

Statement

Please be aware that this manual is only for this unit SC-1200 and does not represent the manual for others. In addition, this manual is provided as a guide only, the pictures in this manual are for reference only, and all statements, information and suggestions in this manual do not constitute any express or implied warranty. We are always dedicate to the improvement of product itself, therefore, the appearance and performance of units may be slightly different from this manual, please understand.

Potential Failure Analysis

1. Why is the LCD screen not lit up during charging operation?

Analysis: Once no operation for a long time, the LCD display will enter the energy-saving mode: turn off the display back light board, adjust the display brightness. It may cause the illusion that the display is closed.

Solution: Tap the power/AC/DC switch to wake up the display.

2. Why does the charger heat up while charging?

Analysis: When the charger is in a room temperature environment, the surface temperature should be lower than 70°C, if the charger temperature is lower than 70°C, it is normal, if it is higher than 70°C, it may be a charger malfunction, except for extreme environments such as high temperature.

Solution: Charge at 0~40°C or replace with a new charger with the same specification.

3. Why does the appliance not work when plug into AC port?

Analysis: This unit can only support appliances within 1200W, to check if the loaded appliances exceed the rated output power, if so, it will trigger overload protection.

Solution: Remove the load appliance, turn on the switch again, and the unit can be used normally.

4. Why is the output suddenly stopped during the use of this unit in high temperature?

Analysis: In extreme environment with high temperatures, overheating protection may occur in use.

Solution: Turn off the unit, after its automatic cooling, turn on the switch, it can be used normally. It is recommended to work below 40°C.

FCC Statement

1.This device complies with Part 15 of the FCC Rules. Operation is subject to the following two conditions:

(1)This device may not cause harmful interference.

(2)This device must accept any interference received, including interference that may cause undesired operation.

2. Changes or modifications not expressly approved by the party responsible for compliance could void the user's authority to operate the equipment.

Note:This equipment has been tested and found to comply with the limits for a class B digital device,pursuant to Part 15 of the FCC Rules. These limits are designed to provide reasonable protection against harmful interference in a residential installation.

This equipment generates uses and can radiate radio frequency energy and,if not installed and used in accordance with the instructions,may cause harmful interference to radio communications.However,there is no guarantee that interference will not occur in a particular installation.if this equipment does cause harmful interference to radio or television reception,which can be determined by turning the equipment off and on,the user is encouraged to try to correct the interference by one or more of the following measures:

- Reorient or relocate the receiving antenna.
- Increase the separation between the equipment and receiver.
- Connect the equipment into an outlet on a circuit different from that to which the receiver is connected.
- Consult the dealer or an experienced radio/TV technician for help.

The device has been evaluated to meet general RF exposure requirement.

The device can be used in portable exposure condition without restriction.