

说明书尺寸：130*85mm

舒眠音箱

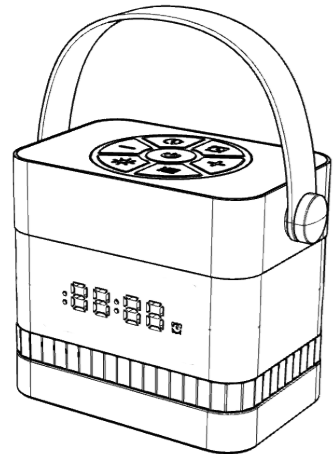

用户手册

感谢您购买及使用本产品！
为了给您带来更好的使用体验，在使用产品前请仔细阅读本用户手册，并请妥善保管，以便日后参考，谢谢。

产品特点

- 本产品是一款多功能舒眠音箱，集成了音箱，白噪音，氛围灯，时钟，闹钟等功能为一体，整体简约而不简单；
- 内置七首白噪音，包含虫鸣，篝火，海浪，乡村，鸟鸣，雨声等，让您在快节奏的生活中，亲近自然享受片刻宁静，释放内心压力享受惬意时光；
- 智能光唤醒功能，模拟日出过程，先光后声，三档渐亮唤醒，科学唤醒，体验更舒适，起床无压力；
- 蓝牙5.4快连播放，专业全频调音，人声清透立体，低频强劲有力，高保真5w全频喇叭，打造属于你的音乐空间；
- 现代极简设计，重塑家居美学，是音箱也是艺术品，置于室内彰显独特风格为家庭增添艺术美感；

产品规格

产品名称：舒眠音箱	产品型号：D05
产品材质：pc+ABS+布料+皮革	产品尺寸：140mm*83mm*170mm
蓝牙版本：5.4	电源接口：TYPE-C
输入电流：5V/2A-5V/3A	喇叭功率：4Q5W
蓝牙传输距离：10-15米	信噪比：DAC:108dB- ADC:98dB
产品功率：充电电流:5W-MAX 功放：1X5W	执行标准：GB 4943.1-2022

配件清单：

主机*1、说明书*1、数据线*1。



产品描述

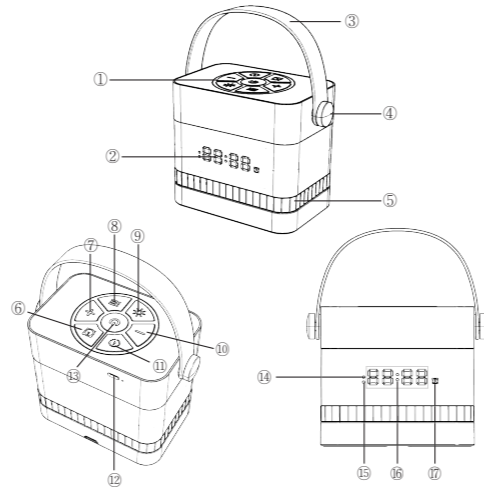

①	功能按键	⑩	上一曲/音量-
②	时间显示区域	⑪	定时按键
③	提手	⑫	Type-c 充电口
④	装饰帽	⑬	开机按键
⑤	氛围灯	⑭	蓝牙指示灯
⑥	闹钟按键	⑮	充电指示灯
⑦	下一曲/音量+	⑯	时间显示区域
⑧	模式按键	⑰	闹钟
⑨	灯光按键		

操作说明

一、开关机

- 长按3秒开关键，开启/关闭机器；

二、蓝牙

- 机器开启状态，单击模式键，打开蓝牙；
- 开启蓝牙功能后,进入待配对状态，蓝牙指示灯闪烁；
- 打开手机或其它设备的蓝牙设置；
- 在蓝牙界面搜寻名称为“D05 ”的设备；
- 蓝牙连接成功,产品提示音响起；
- 蓝牙模式下,双击开关键，断开当前蓝牙连接,指示灯闪烁等待新设备连接；
- 再次双击开关键，重新连接上一次连接设备；

三、白噪音

- 机器开启状态，双击模式键，打开白噪音；
- 打开白噪音成功，产品提示音响起；
- 单击“+”键，切换下一曲；长按“+”键，音量加；
- 单击“-”键，切换上一曲；长按“-”键，音量减；
- 再次单击模式键，关闭白噪音功能；

四、夜灯

机器开机默认第2档亮度

- 第 1 次短按灯光键，夜灯第 3 档亮度；
- 第 2 次短按灯光键，夜灯关闭；
- 第 3 次短按灯光键，夜灯第 1 档亮度；
- 第 4 次短按灯光键，夜灯第 2 档亮度，依次循环；

五、调节音量

- 蓝牙模式下,长按音量“-”键，音箱音量减小；
- 蓝牙模式下,短按音量“+”键，音箱音量调大；

- 闹钟设置 / 闹钟设置完成后单击闹钟键,单击按音量一键，数字减少；
- 闹钟设置 / 闹钟设置完成后单击闹钟键,单击按音量+键，数字增加；

六、时钟设置

- IDLE模式下,单击“+”“-”调节时钟显示亮度,3 档 -2 档 -1 档 - 关闭，循环设置；
- 连接蓝牙时间自动更新，长按模式键5秒进入手动时间调节；
- 小时部分闪烁，短按音量+、音量一键,设置小时时间；
- 单击时钟键保存后,进入分钟设置界面,分钟部分闪烁；
- 短按音量+、音量一键,设置分钟时间；
- 单击时钟键保存后,返回时钟显示；

注：设置时钟过程，如 1 分钟无操作,自动保存当前时钟显示；

七、闹钟设置

- 短按闹钟键，打开/关闭闹钟，短按闹钟键，打开闹钟，如果未设置过闹钟，默认时间为00:00,如果设置过闹钟，闹钟为上一次设置时间；
- 长按闹钟键,进入闹钟设置模式,小时部分闪烁，短按音量+、音量一键,设置小时时间；
- 短按闹钟键保存后,进入分钟设置界面,分钟部分闪烁，短按音量+、音量一键,设置分钟时间；
- 短按闹钟键,进入闹铃音量设置；
- 短按闹钟键,保存闹钟设置；

注：设置闹钟过程，如10S无操作,自动退出闹钟设置模式；

八、贪睡模式

- 当闹铃响起,单击任意键进入贪睡模式；
- 间隔 5 分钟后,闹钟再次响起,单击任意键进入贪睡模式；
- 间隔 5 分钟后,闹钟再次响起,再次单击，退出贪睡模式；

注：当闹铃响起,双击任意键即可直接退出贪睡模式;贪睡模式闹铃，响铃时间为 30 分钟,无操作主动退出闹铃；

九、光唤醒联动

- 设置闹钟成功后,闹钟提前 15 分钟亮起 1 档夜灯；
 - 闹钟提前 10 分钟,自动亮起 2 档夜灯；
 - 闹钟提前 5 分钟,自动亮起 3 档夜灯；
 - 闹钟正点，响起闹铃；
 - 单击任意键,进入贪睡模式，双击任意键，关闭闹钟；
- 注：当打开灯光,光唤醒联动功能维持当前灯光亮度;当设置闹钟响起间隔时间低于15分钟,机器不打开光唤醒联动功能；

十、定时关机

- 单击定时键，开启定时功能-15分钟-30分钟-1小时-3小时/关，依次循环；
 - 双击定时键，取消定时；
 - 定时为一次性，不会重复启动；
- 注：定时模式下，屏幕显示，15-30-1-3，3秒内无操作默认设置成功，正点设备断电；

注意事项

注意事项

- 使用电源适配器充电，请配套使用获得CCC认证的电源适配器；
- 电量过低情况下，接上电源适配器后可能无法立即开机工作，需要先充电少许时间，方可正常开机工作；
- 请勿长时间在阳光直射或高温的地方使用、存放本产品；
- 请勿分解或改造本产品，以免导致机器故障或损坏；
- 请将本产品远离水或其它液体，如不小心粘上液体，请马上用干纸巾或干布擦干净；
- 产品工作环境温度范围为 0~45℃；
- 请勿放置在超过 6°的倾斜面上使用；
- 本产品内置锂电池，不得暴露在过热的环境中；
- 为了保证电池的有效使用寿命，请保证至少每2个月充一次电；

保修卡

请妥善保管此卡,本公司将以此卡作为保修凭证
感谢您购买本产品，本产品的保修期为购买期之日起12个月，请务必妥善保管，并填写详细相关信息。以备保修使用。

产品型号: _____ 购买日期: _____

经销商名称: _____

用户姓名: _____ 联系电话: _____

地址: _____

退货理由: ☐ 退货 ☐ 换货 ☐ 保障

保修条件

需要维修服务时，请出示本卡并请详细填写相关内容,本公司向用户提供自产品购买日起12个月保用期

保修范围

在正常使用状态下出现的质量问题，并非外力破坏造成的损坏，产品保修期间,因无法使用该产品而造成的不便或损坏，本公司均承担任何责任，原则上产品属于保修期间的用户不需支付费用，但着人力损坏则需酌情收取检测或零配件费用，产品超出保修期的一律收费。

以下情况不能享受保修

人力损坏:如因使用不当，错误造成破坏，外观不正常磨损、摔损、电路销毁、挤压变形、异物进入、受潮、产品上的密封标签被涂改或撕毁、以及其他任何可见人为损坏，其他情况如用户自身身原因(擅自拆装修改、使用不惧、操作不当进水等人为情况)所造成的损坏，因不可抗力造成的损坏，如地震、水灾、火灾、台风或战争等。

MADE IN P.R.C
FCC CE RoHS

说明书尺寸：130*85mm

Sleeping speaker

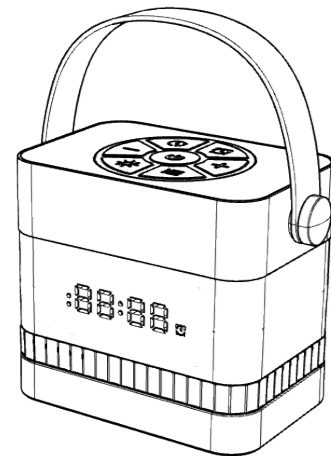

MANUAL

Thank you for buying and using this product!

In order to bring you a better user experience, please read this user manual carefully before using the product. Please keep it safe for future reference. Thank you.

Product Features

This product is a multifunctional sleeping speaker, which integrates the functions of speaker, white noise, ambient light, clock, alarm clock and so on, and is simple but not simple as a whole;

Built-in seven white noises, including insects, bonfires, waves, countryside, birds, rain, etc., allow you to enjoy a moment's peace close to nature, release your inner pressure and enjoy a pleasant time in a fast-paced life;

Intelligent light wake-up function, simulating the sunrise process, first light and then sound, third gear gradually bright wake-up, scientific wake-up, more comfortable experience, no pressure to get up;

Bluetooth 5.4 fast link playback, professional full-frequency tuning, clear and three-dimensional voice, powerful low frequency, high fidelity 5w full-frequency speaker, to create your own music space;

Modern minimalist design, reshaping home aesthetics, is both a sound box and a work of art, which is placed indoors to show the unique style and add artistic beauty to the family;

Product Specifications

Product name: Sleeping speaker products

Product model: D05

Material: pc+ABS+ cloth+leather

Product size: 140mm*83mm*170mm

Bluetooth version: 5.4

Power connection: TypeC-C

Input current: 5V/2A-5V/3A

Horn power: 4Ω5W

Bluetooth transmission distance: 10-15m

Signal-to-noise ratio: DAC:108dB-ADC:98dB

Product power: charging current: 5W-MAX
power amplifier: 1X5W

Implementation standard: GB 4943.1-2022

Accessories List:

Host *1, instruction manual *1, data line *1.



Product Description

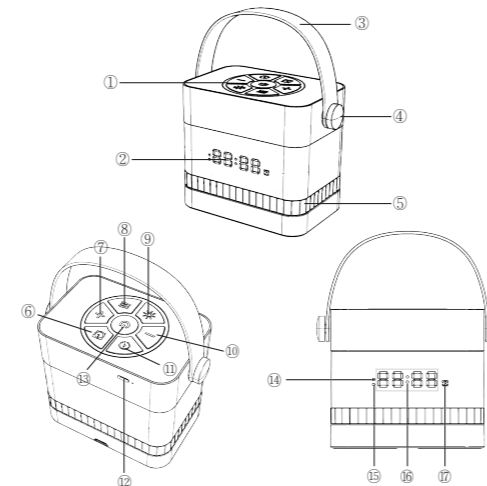

①	Function key	⑩	Previous song/volume-
②	Time display area	⑪	Timing key
③	Handle	⑫	Type-c charging port
④	Decorative cap	⑬	Boot button
⑤	Atmosphere lamp	⑭	Bluetooth indicator lamp
⑥	Alarm clock button	⑮	Charging indicator lamp
⑦	Next song/volume+	⑯	Time display area
⑧	Mode key	⑰	Alarm clock
⑨	Light key		

Handling instruction

1、Switch machine

1. Press and hold the switch for 3 seconds to turn on/off the machine;

2、Bluetooth

- When the machine is on, click the mode key to turn on Bluetooth;
- After turning on the Bluetooth function, enter the state of waiting for pairing, and the Bluetooth indicator flashes;
- Turn on the Bluetooth settings of the mobile phone or other devices;
- Search the Bluetooth interface for the device named "D05";
- The Bluetooth connection is successful, and the product prompt sounds;
- In Bluetooth mode, double-click the ON key to disconnect the current Bluetooth connection, and the indicator light flashes to wait for the new device to connect;
- Double-click the on key again to reconnect the last connected device;

3、White noise

- When the machine is on, double-click the mode key to turn on the white noise;
- The white noise is turned on successfully, and the product prompt sounds;
- Click the+key to switch to the next song; Long press the "+"key to increase the volume;
- Click the "-"key to switch to the previous song; Press and hold the "-"key for a long time to reduce the volume;
- Click the mode key again to turn off the white noise function;

4、Night light

The default brightness of the second gear when the machine is turned on.

- Press the light button for the first time, and the third brightness of the night light;
- Press the light button for the second time, and the night light will turn off;
- Short press the light button for the third time, and the first brightness of the night light;
- Press the light button for the fourth time, and the second brightness of the night light will be cycled in turn;

5、Adjust the volume

- In Bluetooth mode, press and hold the volume "-"key for a long time to reduce the volume of the speaker;
- In Bluetooth mode, press the volume "+"button for a short time to increase the volume of the speaker;

- After the alarm clock setting/alarm clock setting is completed, click the alarm button, and click the volume button to reduce the number;
- After the alarm clock setting/alarm clock setting is completed, click the alarm clock button and press the volume+button to increase the number;

6、Clock setting

- In Idle mode, click "+"and "-"to adjust the display brightness of the clock, and set it in cycle from 3rd gear to 2nd gear to 1st gear.
- Connect the Bluetooth time to update automatically, and press the mode key for 5 seconds to enter the manual time adjustment;
- The hour part flashes. Press the Volume+and Volume button briefly to set the hour time;
- Click the clock button to save, and enter the minute setting interface, and the minute part flashes;
- Press the Volume+and Volume button briefly to set the minute time;
- Click the clock button to save and return to the clock display;

Note: Set the clock process, if there is no operation for 1 minute, the current clock display will be automatically saved;

7、Alarm clock setting

- Press the alarm button short to turn on/off the alarm clock, and press the alarm button short to turn on the alarm clock. If the alarm clock has not been set, the default time is 00:00. If the alarm clock has been set, the alarm clock is the last setting time;
 - Press and hold the alarm clock button for a long time to enter the alarm clock setting mode, and the hour part flashes; press and hold the volume+and volume button for a short time to set the hour time;
 - Press the alarm button for a short time to save, then enter the minute setting interface, and the minute part flashes. Press the volume+and volume button for a short time to set the minute time;
 - Press the alarm button briefly to enter the alarm volume setting;
 - Press the alarm button briefly to save the alarm settings;
- Note:** In the process of setting the alarm clock, if there is no operation for 10S, the alarm clock setting mode will be automatically exited;

8、Sleepiness mode

- When the alarm goes off, click any key to enter the snooze mode;
 - After an interval of 5 minutes, the alarm clock rings again, and click any key to enter the snooze mode;
 - After an interval of 5 minutes, the alarm clock rings again, click again to exit the snooze mode;
- Note:** When the alarm goes off, double-click any key to exit the snooze mode directly; Sleepy mode alarm, the ringing time is 30 minutes, and the alarm is automatically exited without operation;

9、Light wake-up linkage

- After setting the alarm clock successfully, the alarm clock lights up the first night light 15 minutes in advance;
 - The alarm clock will automatically light up the second night light 10 minutes in advance;
 - The alarm clock will automatically light up the third night light 5 minutes in advance;
 - The alarm clock is on time, and the alarm goes off;
 - Click any key to enter snooze mode, double-click any key to turn off the alarm clock;
- Note:** When the light is turned on, the light wake-up linkage function maintains the current light brightness; When the interval between setting the alarm clock to sound is less than 15 minutes, the machine will not turn on the light wake-up linkage function;

10、Timing shutdown

- Click the timing button to turn on the timing function -15 minutes -30 minutes -1 hour -3 hours/off, and cycle in turn;
 - Double-click the timing key to cancel the timing;
 - The timing is one-time and will not be started repeatedly;
- Note:** In the timed mode, the screen shows that the default setting of no operation is successful within 15-30-1-3 seconds, and the punctual equipment is powered off.

Matters need attention

Points for attention

- Use a power adapter to charge, please use a CCC certified power adapter;
- If the battery is too low, you may not be able to start working immediately after connecting the power adapter, and you need to charge it for a little time before you can start working normally;
- Do not use or store this product in direct sunlight or high temperature places for a long time;
- Do not disassemble or transform this product, so as not to cause machine failure or damage;
- Please keep this product away from water or other liquids. If liquid is accidentally stuck, please wipe it with a dry paper towel or dry cloth immediately.
- The working environment temperature range of the product is 0 ~ 45 C;
- Do not use it on an inclined surface exceeding 6°;
- This product has a built-in lithium battery and must not be exposed to an overheated environment;
- In order to ensure the effective service life of the battery, please ensure that it is charged at least once every 2 months;

warranty card

Please keep this card properly. The company will take this card as the warranty certificate Thank you for purchasing this product. The warranty period of this product is 12 months from the date of purchase. Please keep it properly and fill in detailed relevant information for warranty use.

Product model: _____ Date of purchase: _____

Dealer name: _____

User name: _____ Contact number: _____

Address: _____

Explain the reason: ☐ Return goods ☐ Exchange goods ☐ Guarantee

Warranty conditions

When warranty service is required, please show this card and fill in the relevant contents in detail.

The company provides users with a 1 2-month warranty period from the date of purchase

Warranty scope

The quality problem that appears under the normal use condition, is not the damage caused by the external force damage, the product warranty period, because can not use the inconvenience or damage caused by the product, the company assumes any responsibility, principle. The product belongs to the warranty period users do not have to pay the cost, but in the case of human damage is necessary to charge testing or spare parts costs, products beyond the warranty period of a-law charges.

Warranty is not available under the following circumstances

Manpower damage: for example, due to improper use, improper damage, abnormal wear and tear of appearance, falling damage, circuit destruction, . extrusion deformation, entry of foreign matters, moisture, alteration or tearing of sealing labels on products, and any other visible man-made damage, and other conditions, such as the user's own personal reasons (unauthorized disassembly and modification, unafraid use, improper operation, water ingress, etc.) Damage caused by force majeure, such as earthquake, flood, fire, typhoon or war.

MADE IN P.R.C
FCC CE RoHS

FCC Caution

This device complies with part 15 of the FCC Rules. Operation is subject to the following two conditions: (1) This device may not cause harmful interference, and (2) this device must accept any interference received, including interference that may cause undesired operation.

Any changes or modifications not expressly approved by the party responsible for compliance could void the user's authority to operate the equipment.

NOTE: This equipment has been tested and found to comply with the limits for a Class B digital device, pursuant to Part 15 of the FCC Rules. These limits are designed to provide reasonable protection against harmful interference in a residential installation. This equipment generates, uses and can radiate radio frequency energy and, if not installed and used in accordance with the instructions, may cause harmful interference to radio communications. However, there is no guarantee that interference will not occur in a particular installation.If this equipment does cause harmful interference to radio or television reception, which can be determined by turning the equipment off and on, the user is encouraged to try to correct the interference by one or more of the following measures:

- Reorient or relocate the receiving antenna.
- Increase the separation between the equipment and receiver.
- Connect the equipment into an outlet on a circuit different from that to which the receiver is connected.
- Consult the dealer or an experienced radio/TV technician for help.

The device has been evaluated to meet general RF exposure requirement. The device can be used in portable exposure condition without restriction.