

User Manual Amoul Man

Product Information

Thank you for choosing Amoul Man.

For the correct use of the product, please read and understand this Operator's Manual carefully before use. After reading, please keep this Manual in an easily accessible place.

This Manual introduces the product according to the most complete configuration, and some of the content may not be applicable to the model you bought. If you have any question, please contact the Company.

Product name:	CPR Manikin
Model:	N/A
Name of manufacturer:	AMBULANC (SHENZHEN) TECH. CO., LTD.
Production address:	3rd Floor, Block C, Building #5, Skyworth Innovation Industry Park, Tang Tou 1st Road, Shiyan, Baoan District, Shenzhen 518108, China
Manual version:	2.0
Manual revised on:	07. 2023

Intellectual Property Right

© 2023 AMBULANC (SHENZHEN) TECH. CO., LTD. All rights reserved.

The intellectual property of this product and this Operator's Manual belongs to AMBULANC (SHENZHEN) TECH. CO., LTD., including but not limited to patent right, trademark right, and copyright.

AMBULANC (SHENZHEN) TECH. CO., LTD. reserves the right of final interpretation of this Operator's Manual.

AMBULANC (SHENZHEN) TECH. CO., LTD. has the right to treat this Operator's Manual as confidential information. Without the written permission of AMBULANC (SHENZHEN) TECH. CO., LTD., any individual or organization shall neither disclose nor allow other persons or organizations to obtain all or part of the information by any means.

Without the written permission of AMBULANC (SHENZHEN) TECH. CO., LTD., no individual or organization shall publish, modify, copy, distribute, rent, or adapt all or part of this Manual or translate the same into other languages.



Amoul is a registered trademark or trademark of AMBULANC (SHENZHEN) TECH. CO., LTD. The trademark and related Ambulanc marks are intangible properties of AMBULANC (SHENZHEN) TECH. CO., LTD. The use of trademarks or marks not belonging to AMBULANC (SHENZHEN) TECH. CO., LTD. in this Operator's Manual is for editing purposes only, and the rights of such trademarks or marks belong to their respective owners.

Declaration

AMBULANC (SHENZHEN) TECH. CO., LTD. reserves the right to modify this Manual without prior notice. AMBULANC (SHENZHEN) TECH. CO., LTD. reserves the right to change the technology without prior notice.

AMBULANC (SHENZHEN) TECH. CO., LTD. reserves the right to change the product specification without prior notice.

AMBULANC (SHENZHEN) TECH. CO., LTD. does not make any form of guarantee for this information, including but not limited to the guarantee liability for implied merchantability and fitness for a specific purpose.

Unless otherwise specified, the terms "Ambulanc" and "the Company" in this Operator's Manual refer to AMBULANC (SHENZHEN) TECH. CO., LTD.

Unless otherwise specified, the term "patient simulator" in this Manual refers to the Amoul Man.

The product pictures in this Operator's Manual are for reference only and are not identical to the actual product, all subject to the actual product.

AMBULANC (SHENZHEN) TECH. CO., LTD. considers itself responsible for the safety, reliability, and performance of the product only under the following circumstances:

The assembly, expansion, readjustment, improvement, and repair are carried out by persons approved by AMBULANC (SHENZHEN) TECH. CO., LTD.;

- Relevant electrical equipment conforms to Chinese national standards; and
- The product is used in line with this Operator's Manual.

AMBULANC (SHENZHEN) TECH. CO., LTD. shall bear no responsibility for the safety, reliability, and operation of the product in the following cases:

- Any component of the product is disassembled, stretched, or readjusted;
- The product has been repaired or modified by persons not authorized by AMBULANC (SHENZHEN) TECH. CO., LTD.; or
- The product is not used correctly according to this Operator's Manual.

Maintenance Service

Coverage of free service:

Any product that meets the coverage of warranty regulations of AMBULANC (SHENZHEN) TECH. CO., LTD. is entitled to the free service.

Coverage of paid service:

AMBULANC (SHENZHEN) TECH. CO., LTD. will charge for the service of any product that exceeds the coverage of the warranty regulations of AMBULANC (SHENZHEN) TECH. CO., LTD.

Within the warranty period, the following cases are not covered:

1. Man-made damage;
2. Improper use;
3. Grid voltage exceeds the specified range of the product;
4. Force majeure; or Any part or consumable has been replaced without permission by AMBULANC (SHENZHEN) TECH. CO., LTD., or the product has been repaired by persons not authorized by AMBULANC (SHENZHEN) TECH. CO., LTD.

Important Information



Warning:

Only use the product in dry environments; do not expose the product directly to any liquid.

If the product will not be used for a long time, please remove the battery.

If you find any smoke or odor from the product, please immediately turn off it and stop using it.

If the product has been stored in a cold environment, heat it to room temperature before use and ensure that there is no condensation, as condensation may damage internal electronic elements.

Do not interchange the defibrillation electrode and ECG electrode of the Amoul Man's chest.

When using the defibrillator, follow the manufacturer's Operator's Manual, especially safety rules.

-
- Before starting actual training, the trainer should inform the students how to use the defibrillator correctly and remind them of the potential dangers of not following safety rules.
 - Amoul Man is very sensitive to moisture, so please ensure that it is not wetted, or it may cause internal short circuits.

Contents

1. CPR Introduction	1
2. Product Profile	3
2.1. Specification parameters	3
2.2. Functional configuration	3
2.2.1. Chest compression	4
2.2.2. Rotatable head	4
2.2.3. Blood circulation display	4
2.2.4. Bluetooth+APP	4
2.2.5. Electrocardio (ECG) function	4
2.2.6. Defibrillation function	4
3. Product Description	5
3.1. Front view of product	5
3.2. Side view of product	6
3.3. Signal indicator light	7
4. Product Use Guidelines	8
4.1. Chest compression	8
4.2. Rescue breathing	8
4.3. Defibrillation	8
4.4. Standby	9
5. APP Operation Guide	9
5.1. Student mode	10
5.2. Teacher mode	13
6. Cleaning and Replacement	15
6.1. Clean the head, neck, and body	15
6.2. Cleaning clothes	15
7. Product Configuration	15
8. Quality Assurance	16
9. After-sales Service Unit	16

1. CPR Introduction

Cardiac pulmonary resuscitation (CPR) is a series of actions established by the American Heart Association (AHA) in its "Chain of Survival" to make emergency response to cardiac arrest, which includes five links.

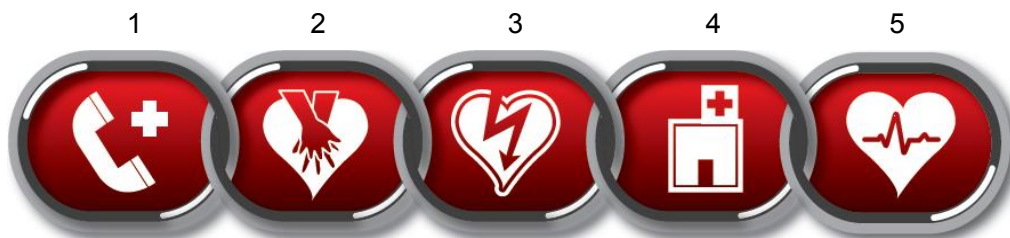

Figure 1-1

1. Early recognition and call for emergency assistance

If a patient suddenly falls to the ground, rescuers should quickly check if the patient has no response and breath, immediately dial the emergency call, loudly call for help, and activate the emergency medical service system (EMSS) and request to bring an automated external defibrillator (AED).

2. Early CPR

The CPR process follows the steps of performing chest compressions (C) first, followed by maintaining airway open (A) and rescue breathing (B). If there is only one rescuer on site, the rescuer should dial the emergency call first and then perform CPR immediately. If there are two or more rescuers, one of them should dial the emergency call, and the other should perform CPR at the same time.

In case of one first-aid person, he/she should perform 5 compression/ventilation cycles (approximately 2 min) before re-check and evaluation of the patient. If the patient still lacks circulatory signs, he/she should perform external defibrillation (if necessary) and followed by CPR. In case of two first-aid persons, one performs chest compressions, and the other maintains airway open and performs rescue breath, while detecting carotid pulsation to evaluate the compression effect. In case of more than two rescuers, the compressor should be replaced every 2 min to avoid reducing the compression effect due to fatigue.

Chest compression

Compression applied to: the junction of 1/3 below the ribs or the center of the person's chest, between the nipples.

Compression method: Tilt the front half of the body forward, straighten the wrist, elbow, and shoulder joints, use the hip joint as the fulcrum to apply vertical downward force, and use the gravity of the upper body to perform chest compression.

Rate: 100 /min at least

Comprehension depth: at least 5 cm; after pressing, leave the chest fully rebound; the time for pushing and releasing should be basically the same.

Compression/ventilation: 30/2

Maintain the airway open

Head-tilt chin-lift or jaw-thrust maneuver

Rescue breathing

Mouth to mouth: open the airway→pinch the nostrils shut→mouth to mouth→inhale normally→blow slowly (for more than 1s), with the chest clearly rising→release the mouth and nostrils→the patient exhaling→the chest falling back.

3. Defibrillation using a defibrillator

The use of a defibrillator can be summarized into three steps: Pressing the power switch; Paste the plate electrodes, and the host of defibrillator start the rhythm analysis; and

Wait for the results of heart rhythm analysis. If a defibrillation indication is issued, press the "Shock" button, or the defibrillator automatically initiates the shock.

4. Effective advanced life support

Start nursing work of advanced life support to restore natural cycle.

A series of resuscitation measures implemented by professional rescuers and medical staff using first-aid supplies and drugs, mainly including the establishment of artificial airways, mechanical ventilation, cycle assistance instruments, application of drugs and liquids, electric defibrillation, evaluation of condition and efficacy, and maintenance of organ function after resuscitation.

5. Comprehensive nursing care after cardiac arrest

Transfer the patient to a medical organization or professional clinic.

After the patient's autonomous cycle is restored, the medical organization should systematically conduct evaluation activities that can improve the quality of life of surviving patients after cardiac arrest treatment.

The initial goals include:

Maximizing cardiopulmonary function and perfusion of important organs;

Timely transferring to a hospital with comprehensive treatment for cardiac arrest after out-of hospital cardiac arrest; and

Trying to identify and treat the direct causes of the cardiac arrest and prevent its recurrence.

2. Product Profile

Amoul Man is a simulator used in simulation of real rescue activities during CPR, such as chest compressions and external defibrillation, through open airways. It provides advanced operational guidance and simulated patient for training, covering all advanced life support training content, and can be used for CPR technology training in basic life support (BLS) and advanced cardiac life support (ACLS). Amoul Man has a visual circulation system that can simulate important ECG signals in the human body, supporting advanced life rescue training.

Amoul Man has the size of a normal adult and provides realistic anatomical features of the human body. It is wirelessly connected to an Android device equipped with an Amoul application through Bluetooth, and CPR operations can be viewed in real time through the Amoul application. The parameters include the patient's ventilation volume, ventilation rate, chest compression depth results, compression times, compression rate, chest rebound, chest compression ratio, and safe defibrillation shock times. These results can be analyzed, managed, downloaded, and shared.

2.1 Chest compression

Trainees can simulate rescuers performing chest compressions on the Amoul Man, with the depth values displayed in millimeters on the APP. Soft chest and hard chest can be simulated by changing the type of chest spring. The thicker spring corresponds to a hard chest, and the thinner spring corresponds to a soft chest.

2.2. Rotatable head

The Amoul Man's head can be rotated left and right to simulate a real-life rescue scenario where a patient's airway is blocked by foreign objects, and the rescuer turns the face to one side to facilitate the removal of foreign objects from the patient's mouth.

2.3. Blood circulation display

During chest compression for CPR, carotid pulse signals can be observed on both sides of the neck.

2.4. Bluetooth+APP

Connect the Amoul Man to an Android device through Bluetooth and install the Amoul APP application on the device, and then you can view the real-time CPR operation results through the Android device.

2.5. Electrocardio (ECG) function

Place four ECG connectors at the specified positions on the chest of the Amoul Man to simulate the collection of ECG waveforms using 3–4 leads, and the ECG waveforms can be monitored on the Android device application.

2.6. Defibrillation function

Biphasic and single-phase defibrillation, and manual and semi-automated defibrillators or automated external defibrillator (AED) whose defibrillation energy reach 360 J are allowed for the Amoul Man.

3. Product Description

3.1. Front view of product

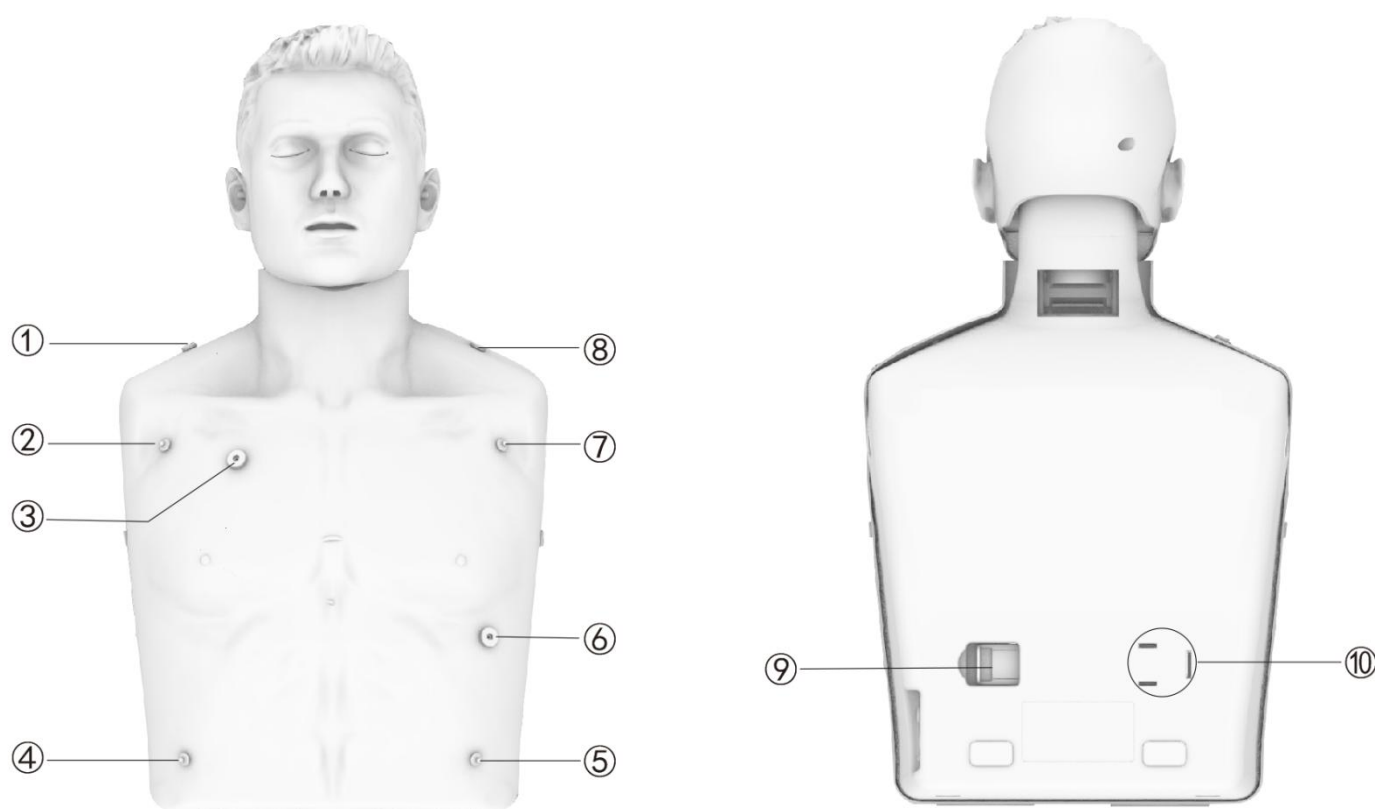

Figure 2-1 Front view

Part	Description
①&⑧: buckle	Used to buckle the upper body skin of Amoul Man
②: RA ECG lead buckle	Used to connect the RA ECG lead (only for AM9-H/AM9-W model)
③: Defibrillation electrode buckle	Used to connect the RR defibrillation plate electrode (only for AM9-H/AM9-W model)
④: RL ECG lead buckle	Used to connect the RL ECG lead (only for AM9-H/AM9-W model)
⑤: LL ECG lead buckle	Used to connect the LL ECG lead (only for AM9-H/AM9-W model)
⑥: Defibrillation electrode buckle	Used to connect the RL defibrillation plate electrode (only for AM9-H/AM9-W model)
⑦: LA ECG lead buckle	Used to connect the LA ECG lead (only for AM9-H/AM9-W model)
⑨: Prompt tone switch for chest compression	Move the switch to the right, and a mechanical sound prompt will sound when the chest is pushed down to a depth of more than 5 cm during training. Conversely, move the switch to the left to turn off the mechanical sound.
⑩: Switch buckle	Used to lock the prompt tone switch for chest compression

3.2. Side view of product

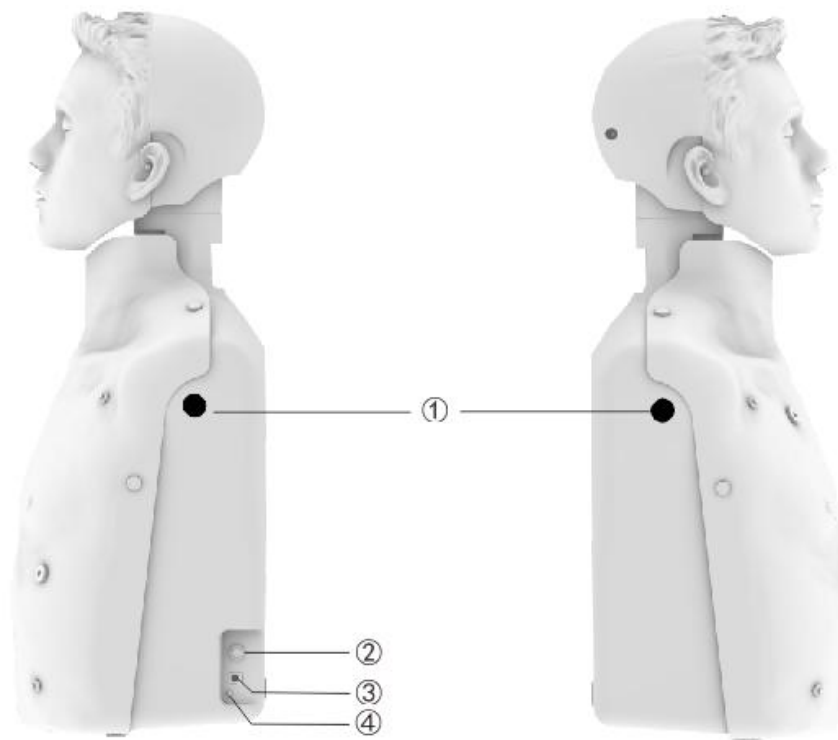

Figure 2-2 Side view

Part	Description
①: Mounting holes for arms	Used to install and secure the arms
②: Power switch	Used to turn on Amoul Man (not available for AM3-H and AM3-W models)
③: Power adapter interface	Used to connect the power adapter (not available for AM3-H and AM3-W models)
④: Power Indicator	When the power indicator light is red and flashing, it indicates that the battery is low, otherwise, it keeps on yellow.

3.3. Signal indicator light

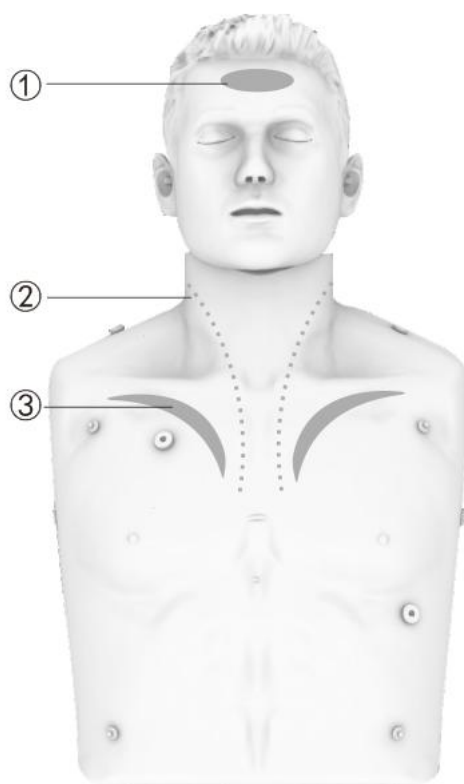

Figure 2-3 Signal indicator light

Part	Description
①: Indicator light for normal cycle	<p>When the compression depth and rate are correct, the head indicator light will light up.</p> <p>On the contrary, if any operation is incorrect, the head indicator light will not light up.</p>
②: Indicator lights for blood circulation	<p>Used to indicate the blood circulation from the heart to the brain during chest compressions. The speed of blood circulation depends on the depth and rate of the chest compression.</p>
③ Indicator light for chest compression depth	<p>The product measures the chest compression depth and pump out the corresponding blood based on this.</p> <p>If the compression depth meets the requirements, the light will light up longer. If the compression depth does not meet the requirements, the light will light up for shorter.</p>

4. Product Use Guidelines

4.1. Chest compression



Figure 3-1 Chest compression

Press the "Power" button, because of this function is not available for AM3-H and AM3-W models, similarly the indicators mentioned following are not available for AM3-H and AM3-W models.

Observe the power indicator light to ensure the normal operation of the product.

Start chest compression, and the indicator lights for blood circulation and compression depth will vary depending on the depth and rate of compression.

When the depth of chest compression exceeds 6 cm, the indicator light for compression depth will light up, and the compression rate exceeds 120/min, all indicator lights for blood circulation will light up.

During chest compression, only when the compression depth is greater than or equal to 5 cm, and the rate is greater than 100/min, the indicator light for normal circle will light up.

4.2. Rescue breathing



Attention:

Amoul Man does not provide a ventilation and hygiene system for the resuscitator. Therefore, mouth-to-mouth or mouth-to-nose blowing is not allowed. A disposable facial mask for mouth-to-mouth ventilation can be used.

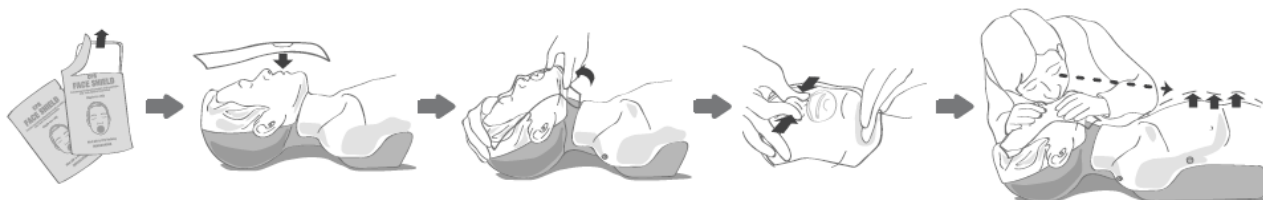

Figure 3-2 Rescue breathing

Tear open the packaging and remove the disposable mask for mouth-to-mouth breathing.

Connect the disposable mask for mouth-to-mouth breathing to the mouth of the Amoul Man.

Open the airway.

Use your thumb and index finger to pinch the nostrils shut and blow air into the mouth for ones.

After the ventilation, observe if there is rise and fall of the chest.

4.3. Defibrillation



Warning:

Do not interchange the defibrillation electrode and ECG electrode of the Amoul Man's chest. When using the defibrillator, follow the manufacturer's Operator's Manual, especially safety rules.

- Before starting actual training, the trainer should inform the students how to use the defibrillator correctly and remind them of the potential dangers of not following safety rules.
- Amoul Man is very sensitive to moisture, so please ensure that it is not wetted, or it may cause

internal short circuits.

If standard plate electrodes are used, buckle them onto the two defibrillation electrodes on the chest of the Amoul Man. After connecting the plate electrode, the rhythm analysis data can be read on the defibrillator screen. When defibrillation is needed, perform defibrillation shock operations on the Amoul Man.

Use of a manual defibrillation adapter may increase the conductive area of the plate electrodes, thus ensuring better contact between the plate electrode and the electrode. If a semi-automated defibrillator or an AED with a viscous chest electrode is used, install a dedicated adapter for the specific defibrillator (simulating viscous chest electrode) on the Amoul Man's chest defibrillation electrode so that the AED cable can be connected.

4.4. Standby

If chest compression is not performed to the Amoul Man for more than 2s, the indicator lights for blood circulation, compression depth, and normal cycle will turn off, and the Amoul Man will enter the standby mode. When the Amoul Man is in the standby mode, the power indicator light will turn green.

Performing chest compression to the Amoul Man in the standby mode may quickly awaken the Amoul Man to enter the compression mode. If the Amoul Man is not operated for 10min, it will automatically power off. If you want to use it again, turn on the power and then restart it.

The power consumption of the Amoul Man is very low in the standby mode, and please turn off the power if the Amoul Man will not be used for long.

When the power indicator light is red and flashing, it indicates that the battery is low. Please replace the battery promptly.

5. APP Operation Guide

1. Contact the salesperson to obtain the application installation package and download and install the application to an Android device. Note that the application interface may display different in a different android device, this manual will take the application interface of tablet PC as an example, it is similar to the mobile APP.

2. Open the Amoul application and select an operating mode: Student/Teacher

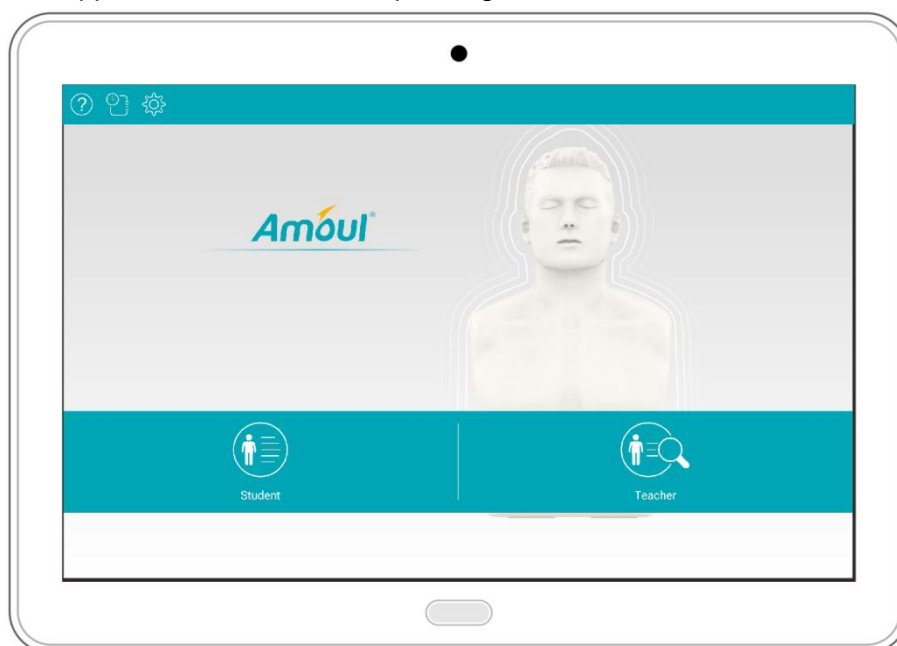

Figure 4-1 Menu interface

3. Turn on the power switch of the Amoul Man (the "Bluetooth" button of Amoul Man flashes every 2s), click on "Searching Available Manikin", and select the manikin from the Bluetooth list. If the list is not displayed, click on "RESCAN". After successful connection, the "Bluetooth" button light of the Amoul Man will be constantly blue. When connecting multiple manikins in the Teacher mode, the searched manikins can be added one by one.

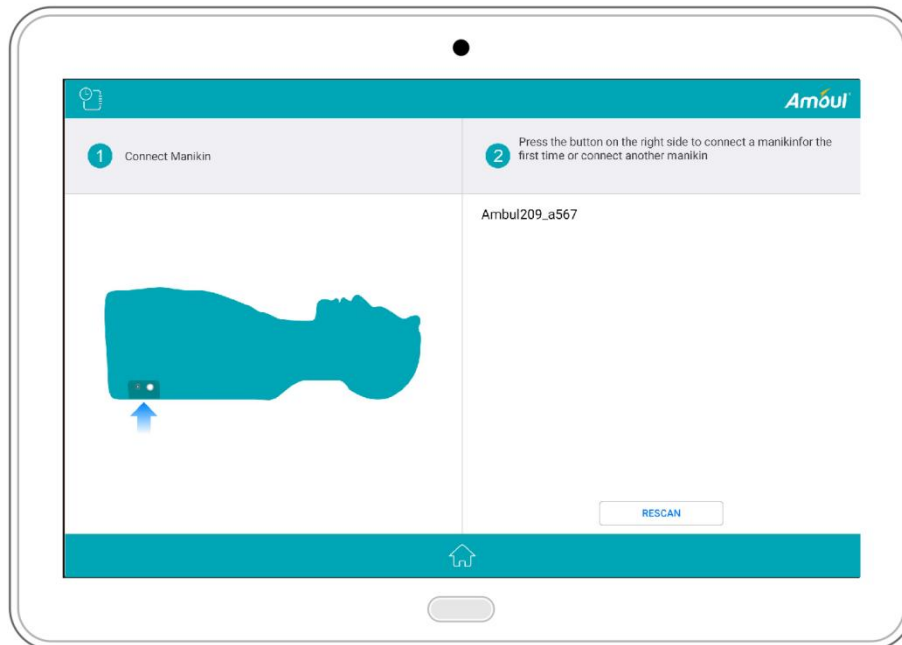

Figure 4-2 Connecting Bluetooth

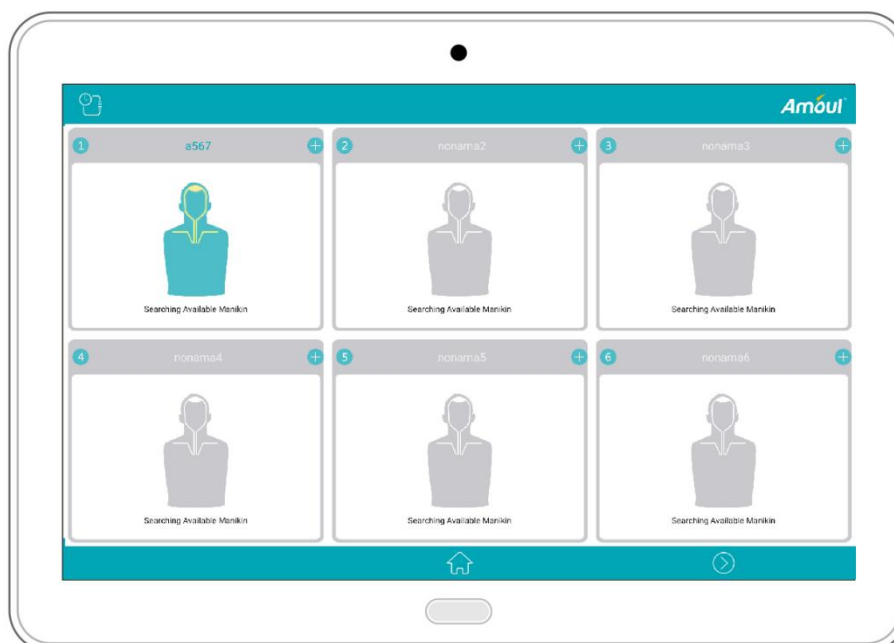

Figure 4-3 Connecting multiple manikins in the trainer mode

5.1. Student mode

After entering the student's main interface, "Self Training" and "Time-based Training" can be conducted.

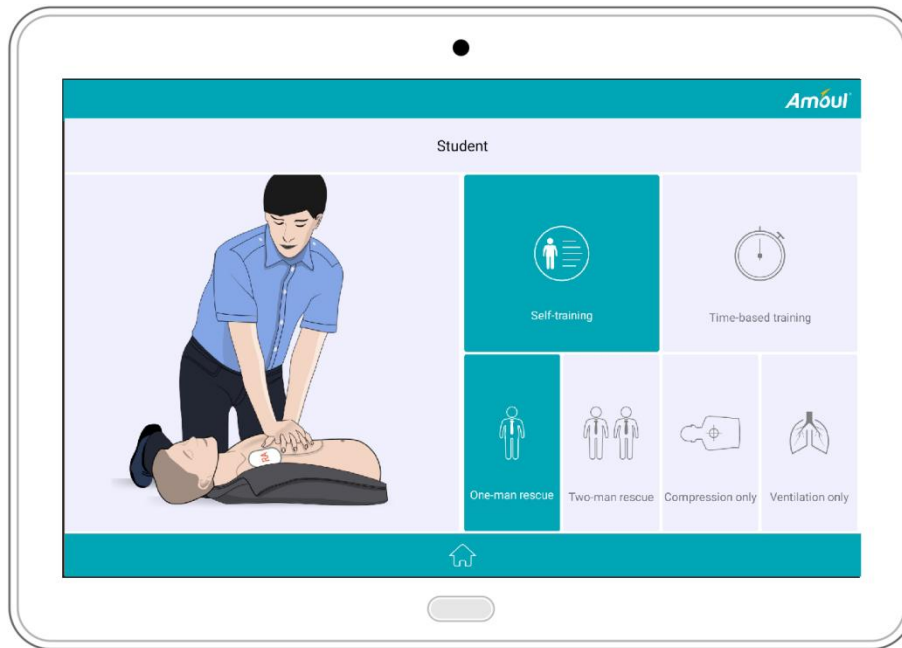

Figure 4-4 Self-training

Click on "Self Training" and select between the training content: One-man rescue, Two-man rescue, Compression Only, and Ventilation Only. After entering the training interface, click on "Start Training" to receive a single item training.

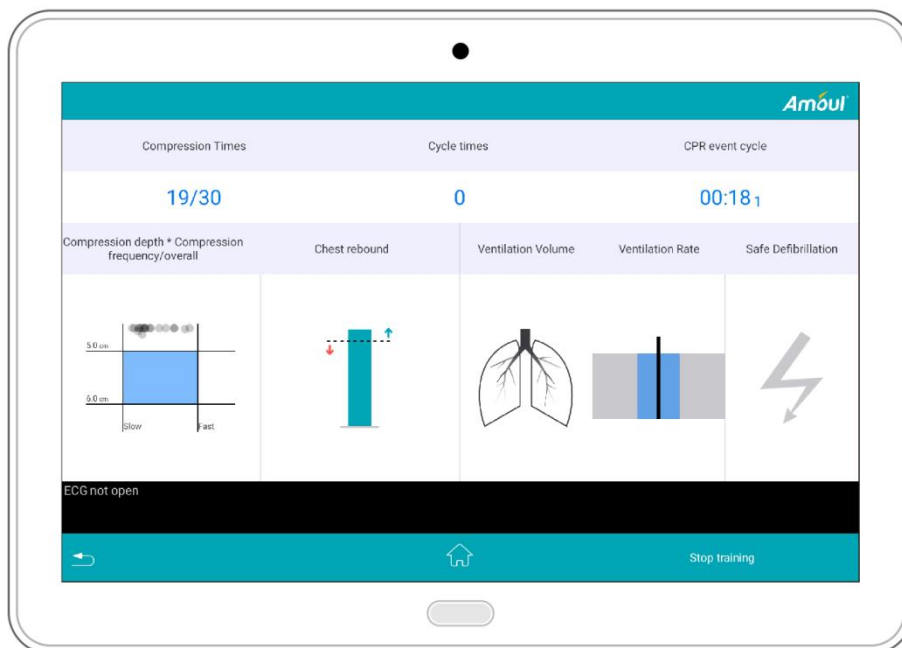

Figure 4-5 One-man rescue

Click on "Time-Based Training", set the training time in the pop-up page, click on "Start Training", and within the preset time, a set of CPR rescue activities including compression, ventilation, and defibrillation can be performed.

Click "Finish Training" or when the preset time is up, the screen enters the evaluation interface, as shown in the following figure. Swipe the screen left and right to view more evaluation results.

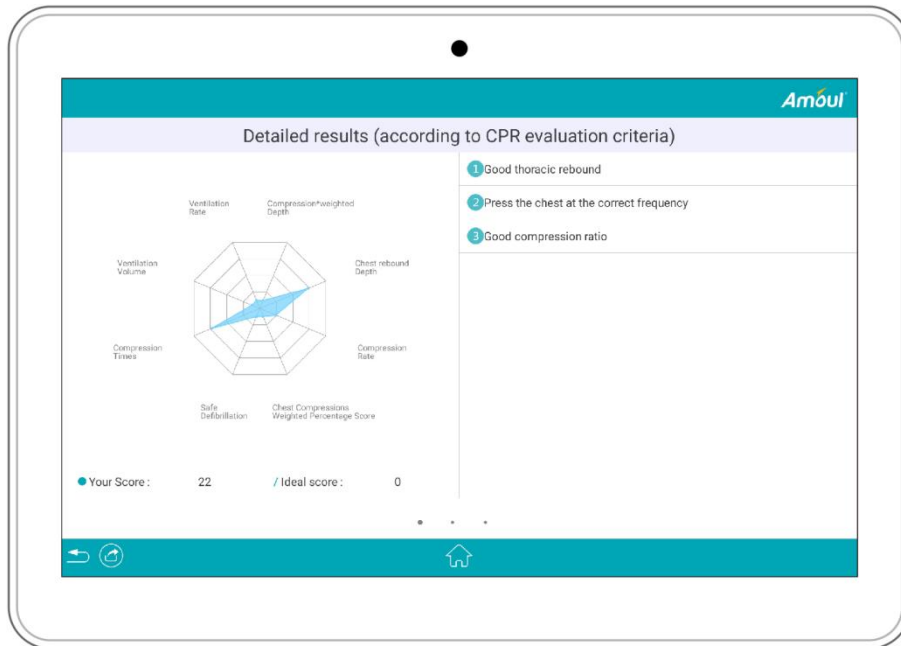

Figure 4-6 Evaluation results 1



Figure 4-7 Evaluation results 2

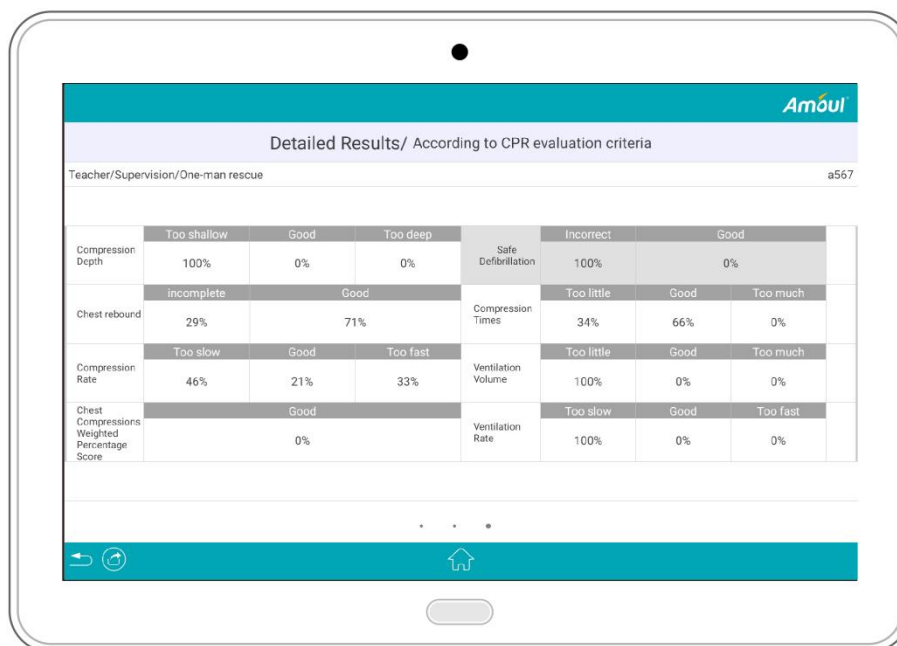

Figure 4-8 Evaluation results 3

5.2. Teacher mode

After entering the teacher's main interface, you can choose to supervise the training of trainees or evaluate the training results of them.

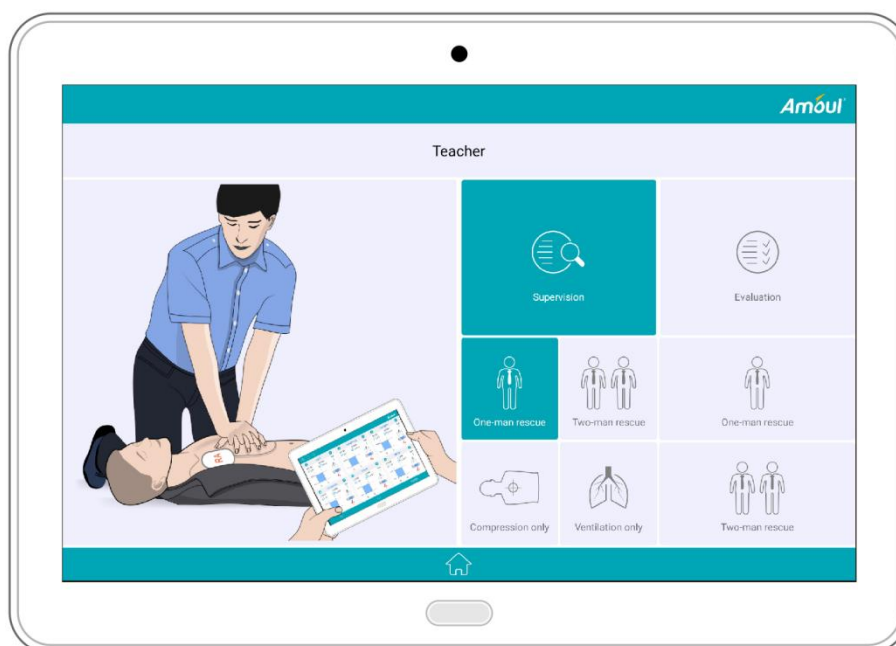

Figure 4-9 Supervision

Click on "Supervision" to select between the training content: One-man rescue, Two-man rescue, Compression Only, and Ventilation Only. After entering the training interface, you can supervise up to 6 trainees. Click "Start Training" to simultaneously train all trainees in a single item. Trainees' training data during the training process will be detected in real time, as shown in the following figure.



Figure 4-10 supervise multiple trainees

Click "Stop Training" to enter the evaluation interface, as shown in the following figure. Click a trainee to enter the corresponding evaluation interface, and swipe the screen left and right to view more evaluation results.

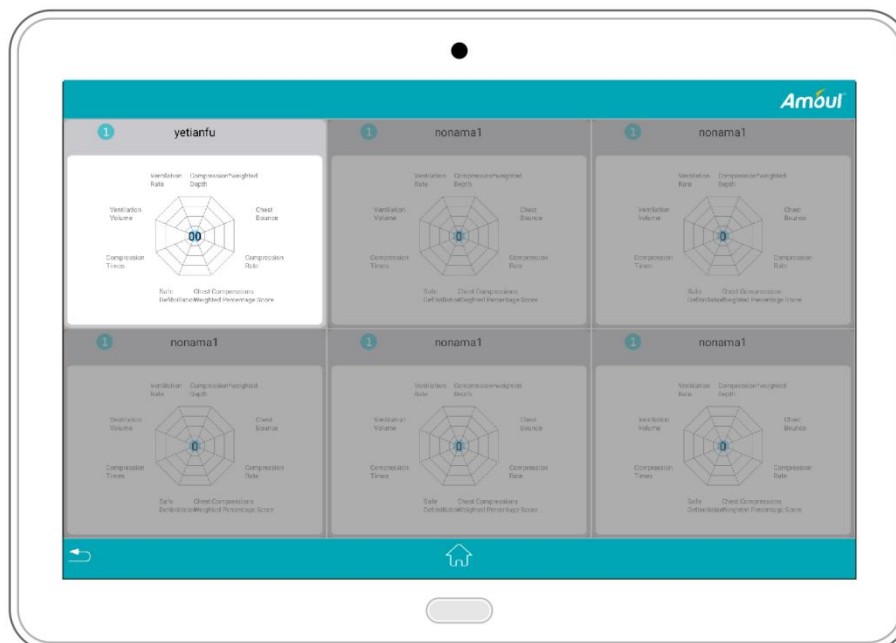





Figure 4-11 Evaluation results

1. It can be return to menu interface through click the icon  in the bottom left corner of the evaluation interface.
2. Training result data can be shared and downloaded through click the icon  in the bottom left corner of the evaluation interface;
3. More detailed instructions on the operation of the Amoul application can be obtained through click the icon  in the upper left corner of the interface.

6. Cleaning and Replacement

6.1. Clean the head, neck, and body

The following steps can be taken to remove the skin.

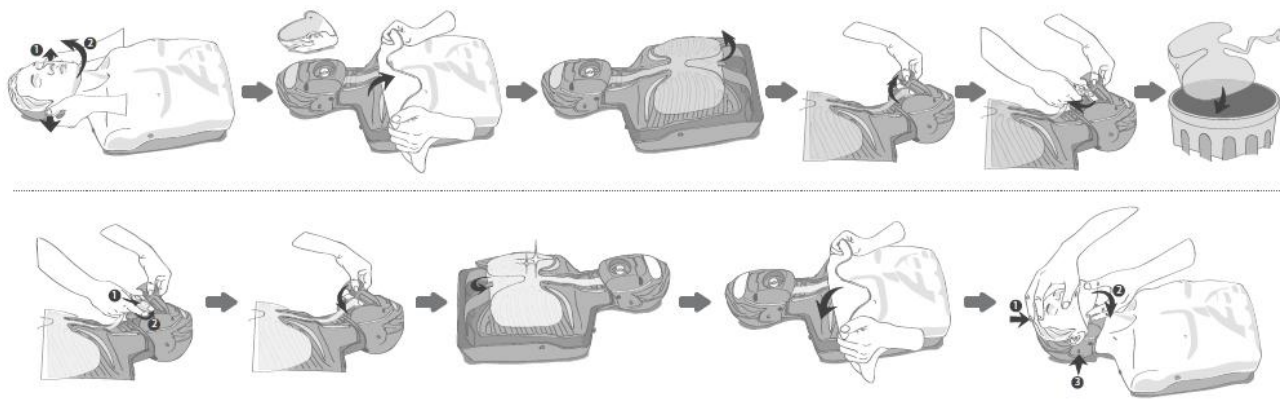

Figure 5-1

Wipe the skull, face, neck, and body with a cloth dipped in mild detergent, and then wipe again with a cloth dipped in water. When cleaning, never allow detergent or water or other solutions to soak into the skull, body, or instrument. If necessary, cover the connections between various parts of the body with cloths.

Applying lipstick or ballpoint pen to the model person will leave marks and penetrate the skin material, so remove the marks with alcohol as soon as possible.

6.2. Cleaning clothes

The matching clothes are made of 50% cotton and 50% polyester fiber and can be rinsed and dried with water at no higher than 40°C (104°F).

7. Product Configuration

No.	Name	Unit	Quantity	Basic	Standard	Upgraded	High-configured
1	Amoul Man	Unit	1	●	●	●	●
2	Android device	Unit	1	X	X	○	○
3	Disposable mask for mouth-to-mouth breathing (10 PCS)	Bag/box	1	●	●	●	●
4	Spring 2 (25 kg)	Unit	1	●	●	●	●
5	AC power adapter	Unit	1	X	●	●	●
6	Cloth bag+clothes	PCS	1	●	●	●	●
7	Operator's Manual	PCS	1	●	●	●	●
8	AED	Unit	1	○	○	○	●
9	Defibrillation plate electrode	Bag	1	X	X	X	●
10	ECG lead	Set	1	X	X	X	●

No.	Name	Unit	Quantity	Basic	Standard	Upgraded	High-configured
<p>Note:</p> <p>○ represents optional, ● represents standard, and X represents not available</p> <p>Models with arms and legs: The packaging materials, cloth bags, and clothing of the half body and full body models are different.</p> <p>Consumables description: disposable mask for mouth-to-mouth breathing, artificial lung bags.</p> <p>High configured: AED is a standard configuration, with auxiliary function for displaying electrocardiogram defibrillation;</p>							

8. Quality Assurance

The warranty period for the Amoul Man is 1 year, and the warranty does not cover consumables.

To make after-sales request for product quality, you must provide proof of buying the product. If the proof or proof of receipt is difficult to identify, you are not entitled to free after-sales service.

In case of the following circumstances, Ambulanc will charge for the maintenance service, and you will need to pay the maintenance fee and accessory fee:

- Man-made damage;
- Improper use;
- Grid voltage exceeds the specified range of the product;
- Force majeure; or
- Any component or accessory used or replaced with was not approved by Ambulanc, or the product has been repaired by persons not authorized by Ambulanc; or
- Other faults not caused by the finished product itself.

After the warranty period expires, Ambulanc can still provide paid maintenance services.

9. After-sales Service Unit

AMBULANC (SHENZHEN) TECH. CO., LTD.

Address: Building 8#, Skyworth Innovation Valley, Tangtou No.1 Road, Shiyan Subdistrict, Bao'an District, Shenzhen

Zip code: 518108

Toll-free service hotline: 400-9969-120

Telephone: +86-755 26072215 Fax: +86-755 23016012

Website: <http://www.amoulmed.com>

E-mail: service.intl@amoulmed.com

Federal Communications Commission (FCC) Statement. This device complies with part 15 of the FCC Rules. Operation is subject to the following two conditions:

(1) This device may not cause harmful interference, and (2) this device must accept any interference received,

including interference that may cause undesired operation. Note: This equipment has been tested and found to comply with the limits for a Class B digital device, pursuant to part 15 of the FCC Rules. These limits are designed to provide Reasonable protection against harmful interference in a residential installation. This equipment generates, uses and can radiate radio frequency energy and, if not installed and used in accordance with the instructions, may cause harmful interference to radio communications.

However, there is no guarantee that interference will not occur in a particular installation. If this equipment does cause harmful interference to radio or television reception, which can be determined by turning the equipment off and on, the user is encouraged to try to correct the interference by one or more of the following

measures:

- Reorient or relocate the receiving antenna.
- Increase the separation between the equipment and receiver.
- Connect the equipment into an outlet on a circuit different from that to which the receiver is connected.
- Consult the dealer or an experienced radio/TV technician for help.

Warning: Changes or modifications made to this device not expressly approved by TruCorp

may void the FCC authorization to operate this device. Note: The manufacturer is not responsible for any radio or TV interference caused by unauthorized modifications to this equipment. Such modifications could void the user's authority to operate the equipment.

RF exposure statement:

This device complies with FCC RF radiation exposure limits set forth for an uncontrolled environment. The device is installed and operated without restriction.

ISED Statement

-English: This device complies with Industry Canada license-exempt RSS standard(s). Operation is subject to the following two conditions: (1) This device may not cause interference, and (2) This device must accept any interference, including interference that may cause undesired operation of the device.

The digital apparatus complies with Canadian CAN ICES-3 (B)/NMB-3(B).

-French: Le présent appareil est conforme aux CNR d'Industrie Canada applicables aux appareils radio exempts de licence.

L'exploitation est autorisée aux deux conditions suivantes: (1) l'appareil

ne doit pas produire de brouillage, et (2) l'utilisateur de l'appareil doit accepter tout brouillage radioélectrique subi, même si le brouillage est susceptible d'en compromettre le fonctionnement.

L'appareil numérique du ciem conforme canadien peut-3 (b) / nmb-3 (b).

For Receiver:

This device meets the exemption from the routine evaluation limits in section 2.5 of RSS 102 and compliance with RSS 102 RF exposure, users can obtain Canadian information on RF exposure and compliance.

cet appareil est conforme à l'exemption des limites d'évaluation courante dans la section 2.5 du cnr-102 et conformité avec rss 102 de l'exposition aux rf, les utilisateurs peuvent obtenir des données canadiennes sur l'exposition aux champs rf et la conformité.

This equipment complies with Canada radiation exposure limits set forth for an uncontrolled environment. The device is installed and operated without restriction.

Cet équipement est conforme Canada limites d'exposition aux radiations dans un environnement non contrôlé. Die Installation und der Betrieb der Ausrüstung sind uneingeschränkt

For Transmitter:

This device meets the exemption from the routine evaluation limits in section 2.5 of RSS 102 and compliance with RSS 102 RF exposure, users can obtain Canadian information on RF exposure and compliance.

cet appareil est conforme à l'exemption des limites d'évaluation courante dans la section 2.5 du cnr-102 et conformité avec rss 102 de l'exposition aux rf, les utilisateurs peuvent obtenir des données canadiennes sur l'exposition aux champs rf et la conformité.

This equipment complies with Canada radiation exposure limits set forth for an uncontrolled environment. The device is installed and operated without restriction.

Cet équipement est conforme Canada limites d'exposition aux radiations dans un environnement non contrôlé. Die Installation und der Betrieb der Ausrüstung sind uneingeschränkt



AMBLANC(SHENZHEN)TECH.CO.,LTD



Add: 3rd Floor, Block C, Building #5, Skyworth Innovation Industry Park, Tang Tou 1st Road, Shiyan, Baoan District, Shenzhen 518108, China

Tel: +86-755 26072210

Fax: +86-755 23016012

Web site: www.amoulmed.com

E-mail: info@amoulmed.com