

PPNEST

Solar-Powered Wireless Security Camera

PPnest SolarCam P1 Pro

Quick Start Guide

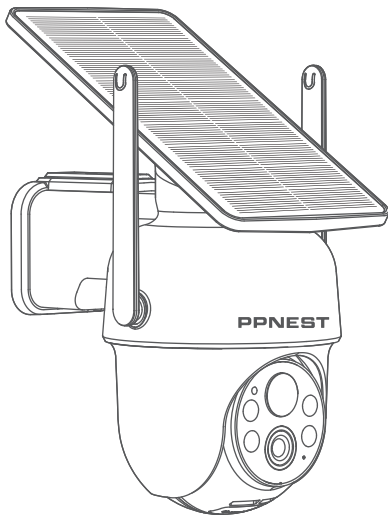

service@ppnest.com



<https://ppnest.com>

PPnest Care

Hi Customer

Thank you for choosing PPnest products. We have always put our customers first and foremost.

There are 3 things you should know before using this product:

1. Select 2.4G Wi-Fi

The product only supports 2.4G Wi-Fi, please select 2.4G Wi-Fi when setting up the app.

2. Select installation location.

Please use your mobile phone to test the coverage of the home Wi-Fi signal at the planned installation position before installation, so that the product can receive a better signal.

3. Micro SD Card and Cloud Storage Service

If you don't have a Micro SD card, it's ok. You can subscribe PPsmart cloud storage service in the app, no worrying about loss of video due to device or Micro SD card corruption.

 service@ppnest.com

 <https://ppnest.com>

TABLE OF CONTENTS

01 What's Included P01

02 Product Overview P02

03 Setting Up the System P03

04 Mounting the Camera P04-07

05 Notice P08-P10

06 Customer Service P11

What's Included

PPnest SolarCam P1 Pro



Camera

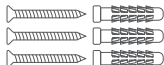

Screw Pack



USB-C Charging
Cable



Position Sticker



Security Sticker



Quick Start Guide

Product overview

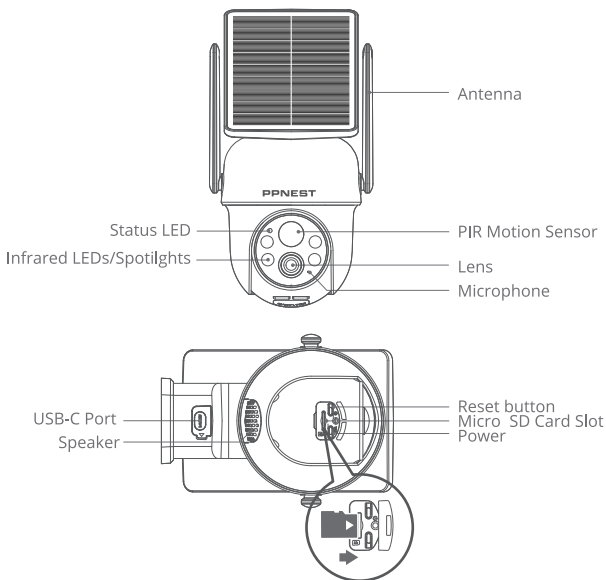

CAUTION: Please insert the Micro SD Card according to the direction shown in the diagram. Micro SD Card might JAM if inserted incorrectly and device could be damaged.

Micro SD Card Port: Support Micro SD Card for local storage (Max 128GB).

Reset button: Press and hold the button for 3 seconds, and then the device will be ready to be connected.

Card capacity requirements: 8-128GB.

Read and write speed requirements: class10 level.

File format: FAT32.

Setting Up the System

Download the PPsmart App from the app Store (iOS devices) or Google Play (Android devices).



Sign up for an PPsmart app account, then follow the onscreen instructions to complete the setup.

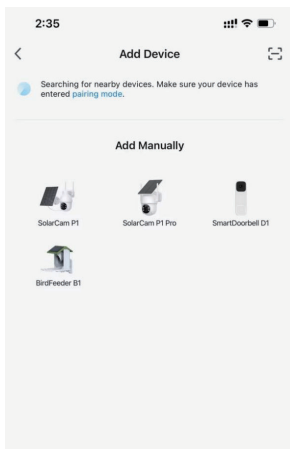
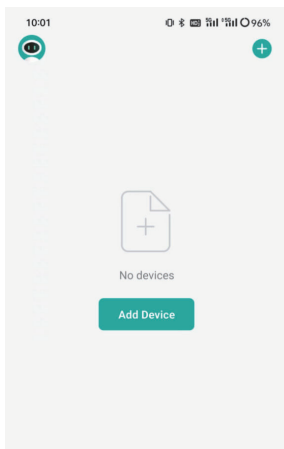

Mounting the Camera

Find a Good Mounting Spot

To find a spot to mount Camera, you need to test wireless signal strength.

- ① Open the **PPsmart app**, go to Camera Settings > Quick Start.
- ② To test the wireless signal strength, take your camera and phone to the location where you want to mount the camera.
- ③ Move the camera as close to the Wi-Fi Router as possible to get a better signal.

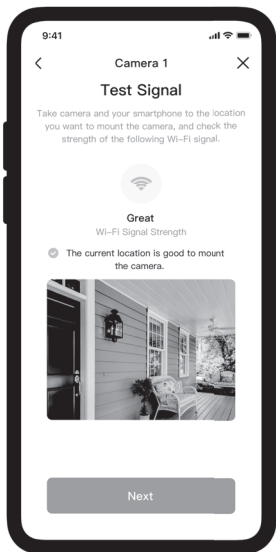

Setting Up the System

2. Register an account on your PPsmart app.

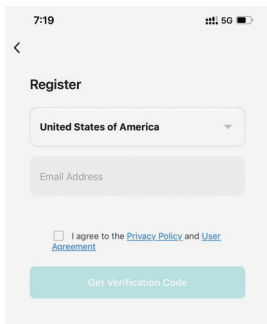

The screenshot shows the 'Register' screen of the PPsmart app. At the top, the status bar displays the time 7:19, 5G signal, and battery level. The screen has a back arrow in the top left. Below the title 'Register', there is a dropdown menu showing 'United States of America'. Below that is a text input field labeled 'Email Address'. At the bottom, there is a checkbox with the text 'I agree to the [Privacy Policy](#) and [User Agreement](#)'. A teal button labeled 'Get Verification Code' is at the very bottom.

STEP 1.
Enter your email address.

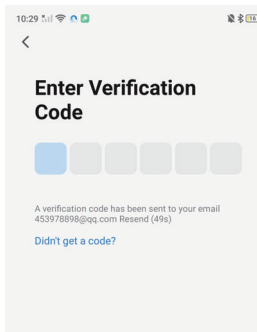

The screenshot shows the 'Enter Verification Code' screen of the PPsmart app. The status bar at the top shows the time 10:29, 5G signal, and battery level. There is a back arrow in the top left. The title 'Enter Verification Code' is centered. Below the title is a row of six input boxes for the verification code; the first box is highlighted in blue. Below the input boxes, text states: 'A verification code has been sent to your email 453978898@qq.com Resend (49s)'. At the bottom, there is a link that says 'Didn't get a code?'.

STEP 2.
Enter the verification code
and create a password.

Setting Up the System

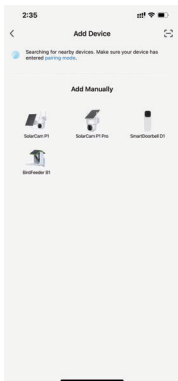

Open PPsmart app ,click "+" on the top right corner of the page , "Add Device" then select "SolarCam P1 Pro".

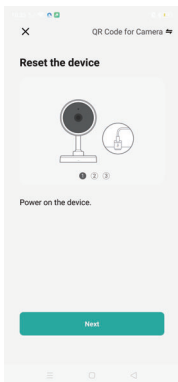

Make sure the indicator is flashing or a prompt tone is heard, then press "Next".

Setting Up the System

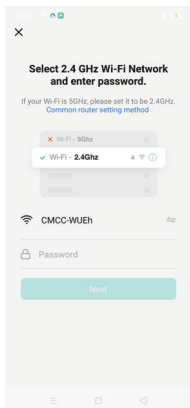

Enter wifi name and password, then press "Next".

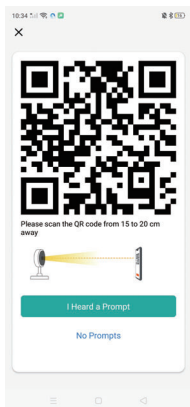

Scan the QR Code on your phone with camera. Heard a prompt tone, then press "I Heard a Prompt".

Setting Up the System

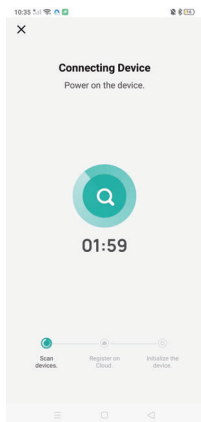

Wait for the network configuration completing.

*Please refer to the specific app interface if there are any difference.

Select Height

Hang Camera 2-3meters above the ground. This height maximizes the detection range of the motion sensor of Camera.

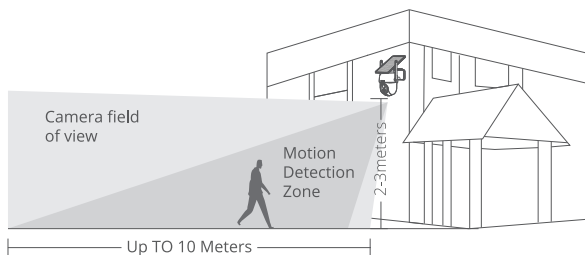

Select Location

1. When installing in the northern hemisphere, face the camera to the south, and when installing in the southern hemisphere, face the camera to the north.
2. Take care to install the camera so that the sun is not blocked by any items such as eaves, trees branches, etc.



Test the Wi-Fi signal at installation position

Use cell phone to test Wi-Fi signal quality at the installation position before installing camera, make sure the Wi-Fi router can provide good Wi-Fi signal.

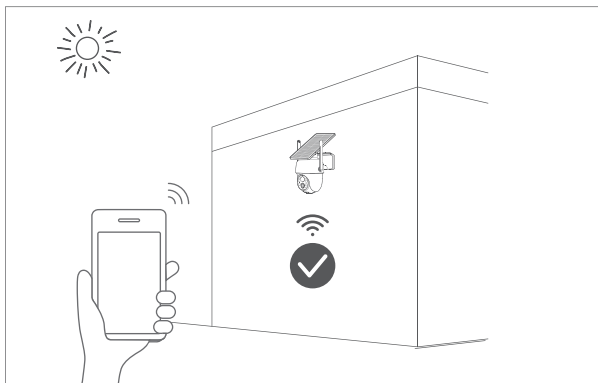
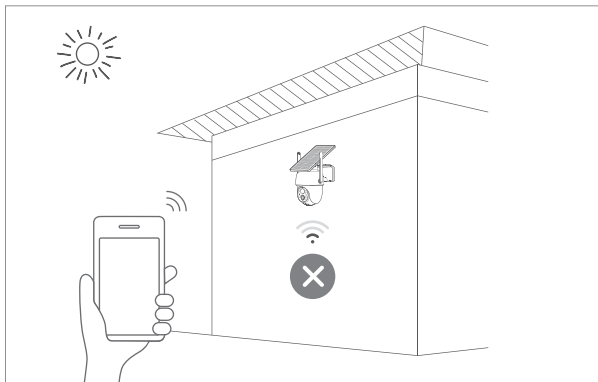

Installation

1. Drilling according to position sticker, drill bit: 15/64"(6 mm).
2. Insert the plugs.
3. Tighten the screws.

What is required:



Power Drill
(not provided)



15/64"(6mm)
Drill Bit

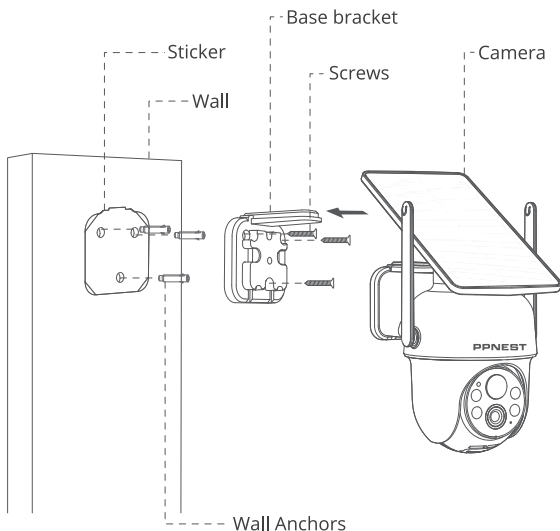

Notice

FCC Statement

This device complies with Part 15 of the FCC Rules. Operation is subject to the following two conditions: (1) this device may not cause harmful interference, and (2) this device must accept any interference received, including interference that may cause undesired operation.

Warning: Changes or modifications not expressly approved by the party responsible for compliance could void the user's authority to operate the equipment. Note: This equipment has been tested and found to comply with the limits for a Class B digital device, pursuant to Part 15 of the FCC Rules. These limits are designed to provide reasonable protection against harmful interference in a residential installation.

This equipment generates uses and can radiate radio frequency energy and, if not installed and used in accordance with the instructions, may cause harmful interference to radio communications. However, there is no guarantee that interference will not occur in a particular installation. If this equipment does cause harmful interference to radio or television reception, which can be determined by turning the equipment off and on, the user is encouraged to try to correct the interference by one or more of the following measures: (1) Reorient or relocate the receiving antenna. (2) Increase the separation between the equipment and receiver. (3) Connect the equipment into an outlet on a circuit different from that to which the receiver is connected. (4) Consult the dealer or an experienced radio/ TV technician for help.

FCC Radio Frequency Exposure Statement

The device has been evaluated to meet general RF exposure requirements.

The device can be used in fixed/mobile exposure condition. The min separation distance is 20cm.

IC Statement

This device contains licence-exempt transmitter(s)/receiver(s) that comply with Innovation, Science and Economic Development Canada's licence-exempt RSS(s). Operation is subject to the following two conditions:

- (1) This device may not cause interference.
- (2) This device must accept any interference, including interference that may cause undesired operation of the device.

L'émetteur/récepteur exempt de licence contenu dans le présent appareil est conforme aux CNR d'Innovation, Sciences et Développement économique Canada applicables aux appareils radio exempts de licence. L'exploitation est autorisée aux deux conditions suivantes :

- (1) L'appareil ne doit pas produire de brouillage;
- (2) L'appareil doit accepter tout brouillage radioélectrique subi, même si le brouillage est susceptible d'en compromettre le fonctionnement.

IC RF Statement

This equipment complies with IC RSS - 102 radiation exposure limits set forth for an uncontrolled environment. This equipment should be installed and operated with minimum distance 20cm between the radiator and your body.

Cet équipement est conforme aux limites d'exposition aux radiations IC CNR - 102 établies pour un environnement non contrôlé. Cet équipement doit être installé et utilisé avec une distance minimale de 20 cm entre le radiateur et votre corps.



This product complies with the radio interference requirements of the European Community.

Declaration of Conformity

Hereby, aosu declares that this device is in compliance with the essential requirements and other relevant provisions of Directive 2014/53/EU.

For the declaration of conformity, visit the Web site:<https://www.aosulife.com>.

This product can be used across EU member states.

Do not use the Device in the environment at too high or too low temperature, never expose the Device under strong sunshine or too wet environment.

The suitable temperature for Camera and accessories is -10°C—50°C.

RF exposure information: The Maximum Permissible Exposure (MPE) level has been calculated based on a distance of d=20 cm between the device and the human body. To maintain compliance with RF exposure requirement, use product that maintain a 20cm distance between the device and human body.



This product is designed and manufactured with high quality materials and components, which can be recycled and reused.



This symbol means the product must not be discarded as household waste, and should be delivered to an appropriate collection facility for recycling. Proper disposal and recycling helps protect natural resources, human health and the environment. For more information on disposal and recycling of this product, contact your local municipality, disposal service, or the shop where you bought this product.

Customer Service

Warranty

12-month limited warranty(The actual warranty period shall be implemented according to the requirements of local laws and regulations)

Email Us

Website <https://ppnest.com>

Email service@ppnest.com



PPNEST