

INSTRUCTION MANUAL

THERIZOSAURUS:



SAFETY PRECAUTIONS:

- Please read the instructions with your children before using the product for the first time. Stop the therizinosaurus with the remote control before picking it up.
- Keep hands, hair and clothing away from moving parts when the toy is operating.
- Do not use the therizinosaurus with the radio control in the street. Avoid collisions with people, animals and furniture.
- The wires are not to be inserted into socket-out-lets.

BATTERY WARNING:

- Rechargeable batteries must be removed before recharging.
- Rechargeable batteries must be recharged under the supervision of an adult.
- Do not mix different types of batteries or new batteries with old batteries.
- Only use batteries of the recommended type or an equivalent type.
- Take care to respect the + and - polarities when inserting batteries.
- Used batteries must be removed from the product.

CARE AND MAINTENANCE:

- Always remove the batteries from the transmitter if it is not used for a long time.
- Wipe the toy gently with a clean cloth.
- Keep the toy away from direct sources of heat.
- Do not immerse the toy in water, as this could damage electronic components.
- Replace batteries when they become less powerful.

2.4G REMOTE CONTROL OPERATION:

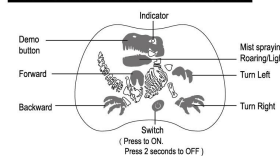

DEMO BUTTON:

- Click the button, the therizinosaurus will show the (forward/backward/turn left/turn right)wagging its tail,swaying its body with different sounds automatically.
- keep pressing the button for 3 seconds to turn off the sound mode, then keep repressing the button for 3 seconds to turn on the sound mode.

THERIZOSAURUS ASSEMBLE:



- Arm assembly: Align the top connection of the arm with the body connection port and insert it.
- Tail assembly: Press the button to plug out the tail.
- Plug in the tail to connect it back.

THERIZOSAURUS CHARGING:

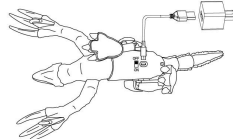

- Please insert the Micro USB plug of the USB cable into the USB socket from the bottom of the therizinosaurus.
- Then insert the another USB plug into the interface of the computer or other adapters (such as mobile phone charger).
- Full charging time takes about 2 hours; Opening time about 15 minutes.
- The indicator from the bottom of the therizinosaurus turn to solid RED when in charging. The indicator from the bottom of the Therizinosaurus turn to OFF when fully charged.
- Take away the USB cable, switch the power ON to start playing.

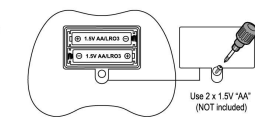

BATTERY INSTALLATION:

- Remove the screw of the battery cover at the bottom.
- Reload 2x1.5V "AA" batteries in the battery pack according to polarity + and -.
- Close the battery cover and tighten the screw of the transmitter anticlockwise and open the battery compartment.

INDICATOR:

- LED Indicator keep Flashing - Frequency connection or remote control signals fail.
- LED Indicator Constantly On - Frequency connected successfully or without any operating actions.

THERIZOSAURUS OPERATION:

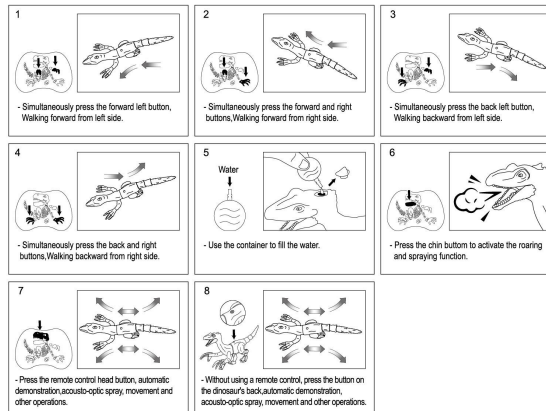

PROBLEM SOLVING:

THE PROBLEM	REASON	COUNTERMEASURES
Reaction of the power switch or indicator light off	- Low battery of therizinosaurus or the transmitter. - System program stop due to the therizinosaurus or the transmitter interference.	- Re-charge the dino or replace the battery of the transmitter. - Take out the battery and re-load into the system for system reset.
Out of control	- A remote therizinosaurus with the same frequency is operating around you and the therizinosaurus is locked with another transmitter. - Beyond the remote range.	- Move it to the place with no wireless interference. - Shut OFF the transmitter of the same type and re-start the machine.
Slow velocity or running or running failure	- Battery exhaustion. - Hair- soft things or other dirt are blocked on the hub. - Battery aging or poor motor.	- Re-charge the battery. - Contact the distributor to repair if it still cannot be restored after the failure exclusion.



Warnings!

This model is not safe for children under the age of three, as the small components may cause harm to them. Remove all packing materials and wire fasteners before giving the model to children.



Waste electrical and electronic equipment (WEEE): When this device reaches the end of its life, please remove all batteries and dispose of them separately. Take electrical devices to a collection centre for electronic equipment and household appliances. Other components can be disposed of with household waste.

OTHERS

Power saving mode: Remote control will be power off if without any operating actions. You should turn on the power button again to start.

FCC Statement

WARNING: Any changes or modifications not expressly approved by the party responsible for compliance could void the user's authority to operate this equipment.

NOTE: This equipment has been tested and found to comply with the limits for a Class B digital device, pursuant to Part 15 of the FCC Rules. These limits are designed to provide reasonable protection against harmful interference in a residential installation.

This equipment generates uses and can radiate radio frequency energy and, if not installed and used in accordance with the instructions, may cause harmful interference to radio communications. However, there is no guarantee that interference will not occur in a particular installation. If this equipment does cause harmful interference to radio or television reception, which can be determined by turning the equipment off and on, the user is encouraged to try to correct the interference by one of the following measures:

- Reorient or relocate the receiving antenna.
- Increase the separation between the equipment and receiver.
- Connect the equipment into an outlet on a circuit different from that to which the receiver is connected.
- Consult the dealer or an experienced radio/TV technician for help.

The device must not be co-located or operating in conjunction with any other antenna or transmitter.

RF warning for Portable device:

The device has been evaluated to meet general RF exposure requirement. The device can be used in portable exposure condition without restriction.

This device complies with Part 15 of the FCC Rules. Operation is subject to the= following two conditions : (1) this device may not cause harmful interference, and (2) this device must accept any interference received, including interference that may cause undesired operation.