

Instructions

Thank you for using the Bluetooth Finder!

This tracker is a product with Bluetooth 5.2 low-power technology, which can be set up in a dedicated mobile app software, Bundle items that are easily lost by users (such as keys, wallets, etc.) together to achieve one click search or locate lost items.

Equipped with a mobile remote control function, opening the app to control the phone to take photos or record, taking photos without asking for anyone, very practical.

APP Download Method-- Only for ios

Search for iSearching/Ufinder/Kindelf on the app Store or scan the QR code directly to download:



Use mode

(1)Switch on/off

Switch on: press button for 3 seconds then you will hear a"Di" sound for twice and indicator starts to flash all the time.

Switch off: press button for 4 seconds then you will hear that"Di" sound for once only and indicator flashing fast to go out.

(2) Device

Open APP into the "Device" interface as below.

Click "⊕", below graphic signs appeared.



A. Click "Unconnected", as graphic sign.

B. Appear "Connecting", as graphic sign.

C. After connected as graphic sign.

D: Click"Click alarm", as graphic sign. The device starts to make sound of"DiDi" all the time and will stop"DiDi" when clicking"Stop alarm" again. Double click of bluetooth device button, an alarm ring pre-set up will be happened and it will stop once click of that button again.

Click "Setting ", as graphic sign.

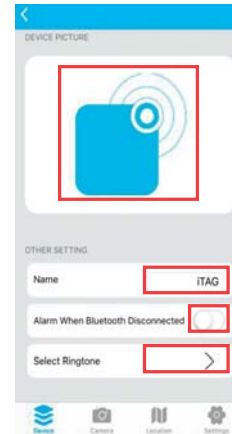

A. Click graphic signs to change the device picture as picture.

B.Change the device name as graphic signs.

C."Alarm when Bluetooth Disconnected" default in closed, can be opened by manual, otherwise smart phone won't alarm when it disconnects with bluetooth anti-lost device, recommend to open as graphic signs.

D.Click on "Select Ringtone" the right side to enter the ringtone interface, select the ringtone type as graphic sign.

(3)Camera

With camera function, single click on the device to have fun of selfie, and switch between front and rear camera freely.



Net weight of product: 12 grams

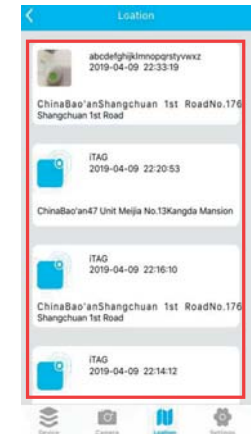
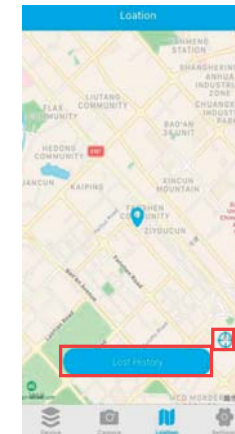

(4)Location

The device will work with positioning function when it gets disconnected with smartphone, which will keep the exact positioning location when disconnecting and is able to find the history of last seen position. Turning on GPS and keep smart phone connected with internet, otherwise map not updated.

(5)Settings

WIFI Do Not Disturb:Default in closed, but in a Wifi covering area when opened to get connected with a smart phone, the smart phone won't ring when disconnecting.

Silent Period: Default in opened, set up period from 23:00PM to 07 :00AM next day, non-interference can be set up closed or reset up the time period.

Recording: Get into below interface to use voice recorder, single click on button to start voice recording and click the button again to stop and recorded file will saved in wav format.

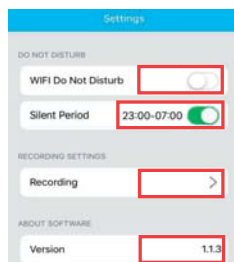

A. Default in closed,click onthe right to open.

B. Default in opened,click on the right to close or reset the Silent period.

C.Click on the right side to enter the recording interface.

Recording



D. Software Version.

Enter the recording interface,click the button to start recording,click the button again, stop recording,and automatiially generate a recording document.

Product specification

(1). Supported IOS and Android system: Recommended ios version 7.0 and above; The Android system needs 4.4 or above, and the phone needs to support the Bluetooth 4.0 standard.

(2). Support Bluetooth Low Energy (BLE), support two-way alarm. .

(3). Frequency range: 2.402-2 .480GHz.

Receiving sensitivity:- 94 dBm Operating environment:- 20 -70C°

Operating voltage:2.7-3.2V Standby current: less than 3uA.

Warning:

This device complies with Part 15 of the FCC Rules. Operation is subject to the following two conditions: (1) this device may not cause harmful interference, and (2) this device must accept any interference received, including interference that may cause undesired operation.

Changes or modifications not expressly approved by the party responsible for compliance could void the user's authority to operate the equipment.

NOTE: This equipment has been tested and found to comply with the limits for a Class B digital device, pursuant to Part 15 of the FCC Rules. These limits are designed to provide reasonable protection against harmful interference in a residential installation. This equipment generates, uses and can radiate radio frequency energy and, if not installed and used in accordance with the instructions, may cause harmful interference to radio communications. However, there is no guarantee that interference will not occur in a particular installation. If this equipment does cause harmful interference to radio or television reception which can be determined by turning the equipment off and on, the user is encouraged to try to correct the interference by one or more of the following measures:

--Reorient or relocate the receiving antenna.

-- Increase the separation between the equipment and receiver

--Connect the equipment into an outlet on a circuit different from that to which the receiver is connected.

--Consult the dealer or an experienced radio/TV technician for help

NOTE: This device and its antenna(s) must not be co-located or operation in conjunction with any other antenna or transmitter . The device has been evaluated to meet general RF exposure requirement. The device can be used in portable exposure condition without restriction.

Help

(1)Why can't the anti-lost device connect to smart devices (Mobile phones,tablets,etc)?

A.Confirm if the smart device is turning on Bluetooth.

B.Determine if the battery has power? If it is a button battery, pull out the battery,then load it, and connect the anti-lost device to the APP again.

C. Restart the smart device or restart the app.

(2)Why does the device alarm frequently?

Due to the differences in the materials of the products themselves, individual anti-lost devices may have frequent alarms. The following steps can be set tofurther improve the user experience.

A. Disconnect, no mobile phone alarm, "Alarm when Bluetooth Disconnected" in the "Setting" option in Device (default in closed), this option does not affect the function of the antilost device to find the phone.

B.In the "Settings", there is "WIFI Do Not Disturb" option to turn on (default in closed), the mobile phone is disconnected from the anti-lost device in this area, and the mobile phone will not sound an alarm.

C. There is a "Silent Period" option in "Settings" (Default in opened), the default time period is 23: 00- 07 : 00, and the time period can be changed according to the user's habits.

(3)The Working distance of the device?

The anti-lost device is a personal communication consumer product, it belongs to the Class 2 standard, and the general distance is 12 - 30 meters (without any barriers)

(4)Why is the device alarming frequently at home ?

Due to the poor penetration of the Bluetooth standard to the spacers, if there are more load-bearing walls in the actual living room, the anti-lost device will be frequently alarmed. It is recommended that the user can refer to the help point 2 to optimize the experience. If you are sensitive to this requirement, it is recommended to consider it. Please be cautious to purchase such products.

(5)How to distinguish the positive and negative of the button battery?

(If the accessory is not a button battery, skip it)

See the diagram.



Android/IOS/Google Play/MY APP



Choose one of the appropriate apps to download