

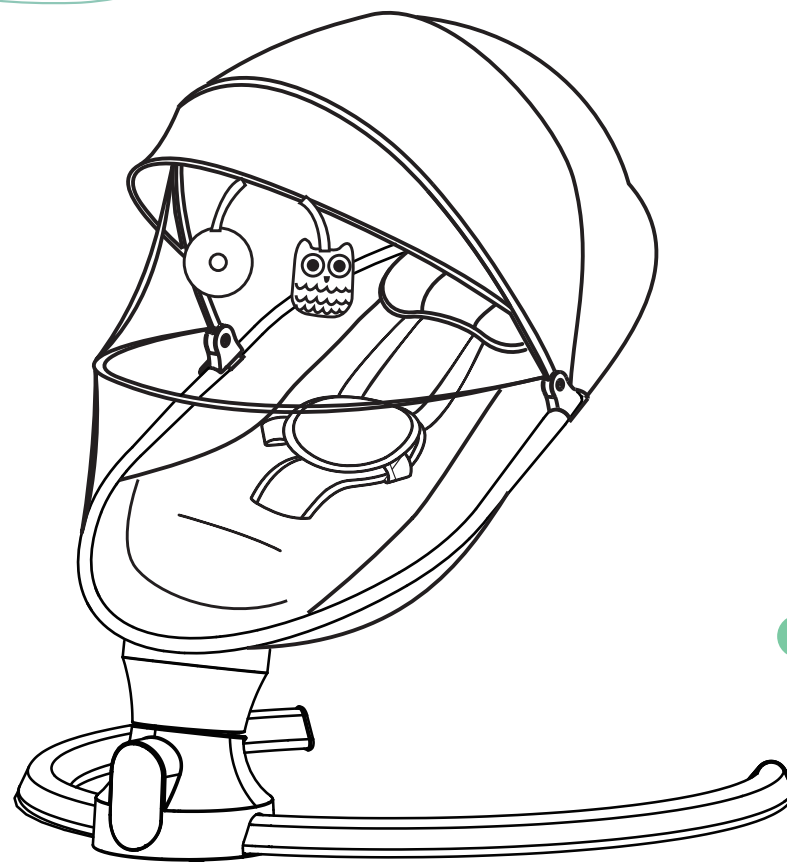

SMELLUCK

BABY SWING

User Manual









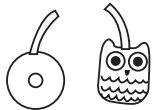

BB706

THIS USER MANUAL CONTAINS **IMPORTANT** SAFETY INFORMATION.
PLEASE READ CAREFULLY AND KEEP WELL FOR FUTURE REFERENCE.

Product Contents

Packing List-----	2
Product Introduction-----	3
Assembly Introduction-----	4
Use and Operation-----	6
Operating Introduction-----	9
WARNING-----	11
FCC Compliance Statements-----	13
Maintenance-----	14
Troubleshooting-----	14

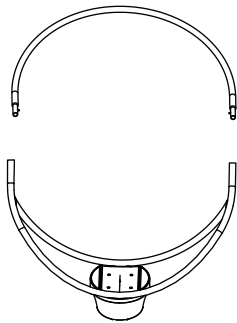
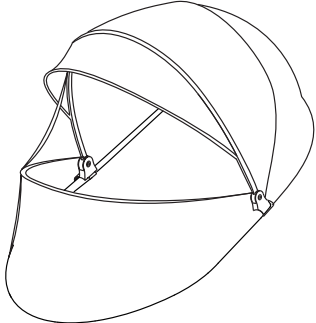
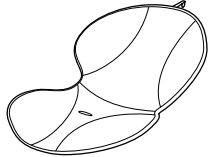
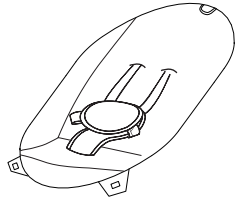
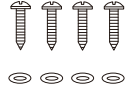
Packing List

- | | | |
|---|---|---|
| ① Plush toy*2 | ② Pillow*1 | ③ Remote controller*1 |
|  |  |  |
| ④ Adaptor+USB cable*1 | ⑤ Base Bracket*2 | ⑥ Base*1 |
|  |  |  |
| ⑦ Seat Frame*1 | ⑧ Canopy with Mosquito Net*1 | |
|  |  | |
| ⑨ Small Mattress*1 | ⑩ Seat Cover*1 | ⑪ Screws & Gaskets*4 |
|  |  |  |
| | | ⑫ Screwdriver*1 |
| | |  |

Note:It is not included in some products. Please refer to the actual product.

Make sure that all the following parts listed are included in the box.If any part is missing,please contact us before operating.

Product Introduction

Product Specification:

Product Name	BABY SWING
Model Number	BB706
Input Voltage	100-240V~
Output Voltage	5V
Output Current	1A
Frequency	50/60Hz
Application	Children up to a weight of 9kg or unable to sit up unaided
Main Material	100% polyester fiber,aluminium alloy base bracket

Product Features:

1. Swinging from side to side,with five gears mimicking human movement.
2. Protecting baby's spine design on the basis of human engineering.
3. Power supplied by safe 5V low voltage adapter.
4. One-button installation and disassembly,simple and convenient to use.
5. Seat cover made of environmental-friendly super soft fabric and non-textile, cozy,breathable and safe &removable and machine washable seat fabric.
6. Made of strong iron base bracket with light weight and strong hardness guaranteeing safety for baby.
7. Controlled by touching screen or remote controller,easy to operate.
8. With motion lock and safety belt for protection.
9. With built-in soft nature sounds &Bluetooth enabled for music.

Assembly Introduction

- 1.Connect the upper section of the seat frame to the lower section until you hear a "click" sound from the snap beads, indicating a successful connection;
- 2.Insert the two base bracket sections into the base and secure with screws and gaskets using a screwdriver;

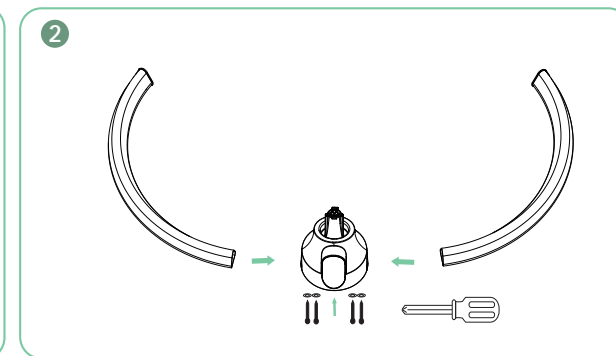
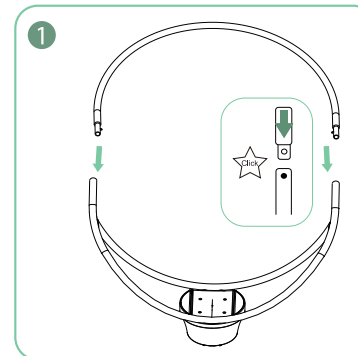

- 3.Align the "☁" shaped hole to install the seat frame to the base. To disassemble, pull out the base button first. Then press the seat frame button to remove the seat frame from the base ;

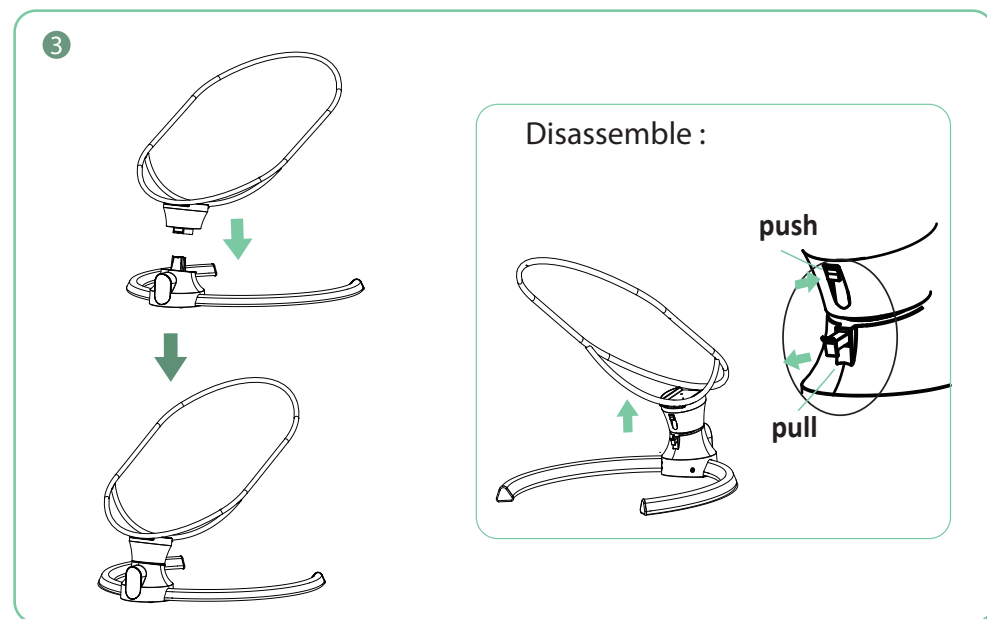

4.Place the seat cover on the seat frame and secure with the hoop-and-loop fastener;

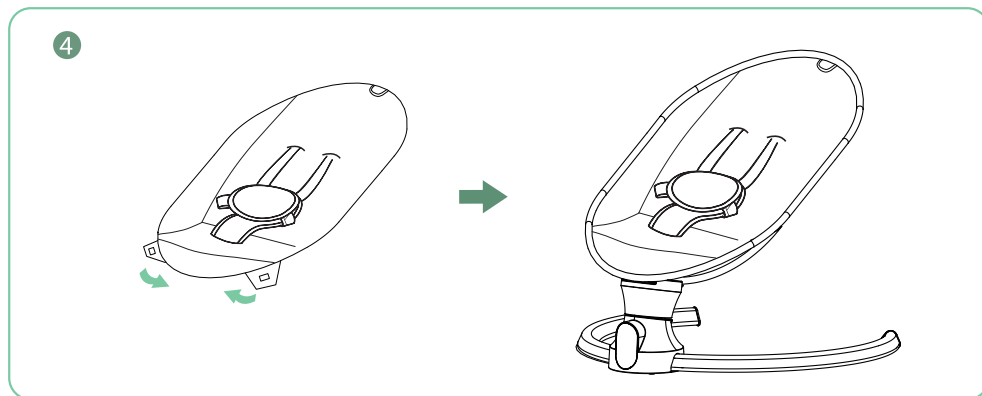

5. Attach the small mattress and headrest to the seat cover, and pass the lower strap of the harness through the mattress hole ;
Note:Some products are supplied with an integrated mattress without an additional small mattress. Please refer to the actual product.

5

A: Integrated mattress model

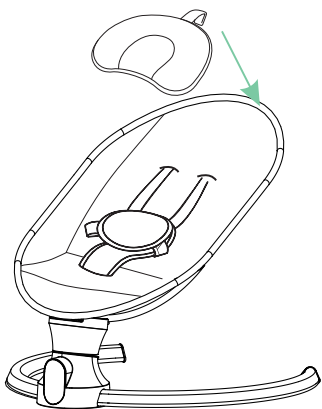

B: With small mattress model

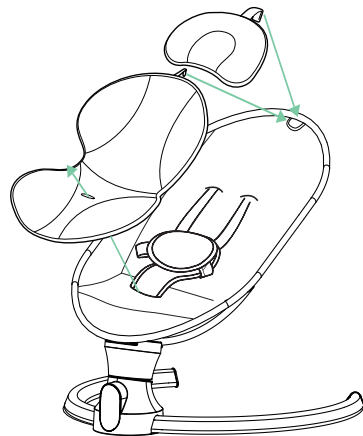

6.Install the canopy on the seat frame and secure with the hoop-and-loop fastener. Secure the toys to the hanging holes on the canopy with the hoop-and-loop fastener.;

6

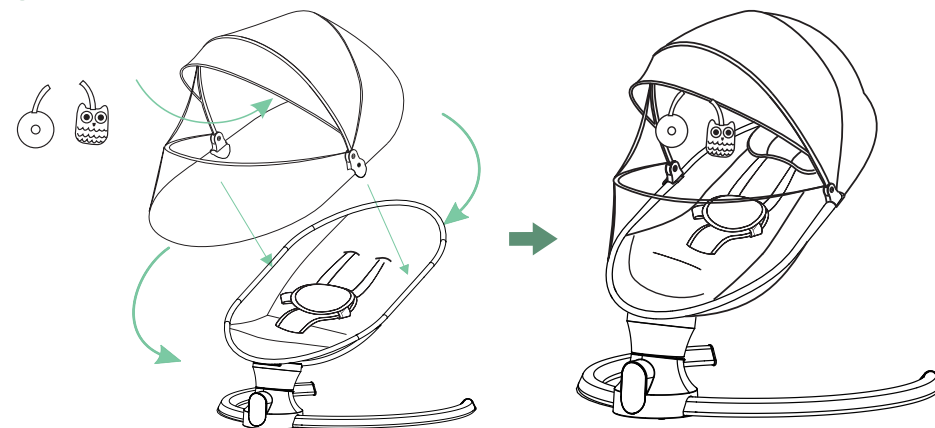

!WARNING:

Guardian should take good care of your child,prohibit to play accessories and avoid to get hurt or swallow!

Use and Operation

1.Connect to the power supply: Connect the plug of the power adapter to a 100-240V, 50/60Hz AC power supply or connect the DC interface to the power bank, and connect the other end to the power port on the electric swing.

Note: The output voltage of the adapter is 5V and the current is 1A. Do not use adapters of other specifications.

! WARNING:

- The power terminals must not be short-circuited.
- Do not use adapters other than those supplied with this product to power the product.
- Keep children away from working adapter.
- Check the adapter cable connection regularly.

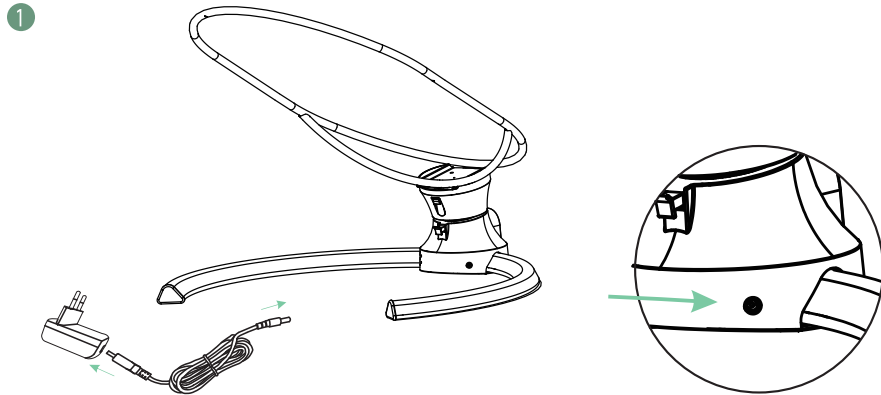

2. Place the baby into the swing and let his legs across both sides of the crotch support restraint, then turn the crotch support cover up. Adjust the seat belt on both sides and buckle up.

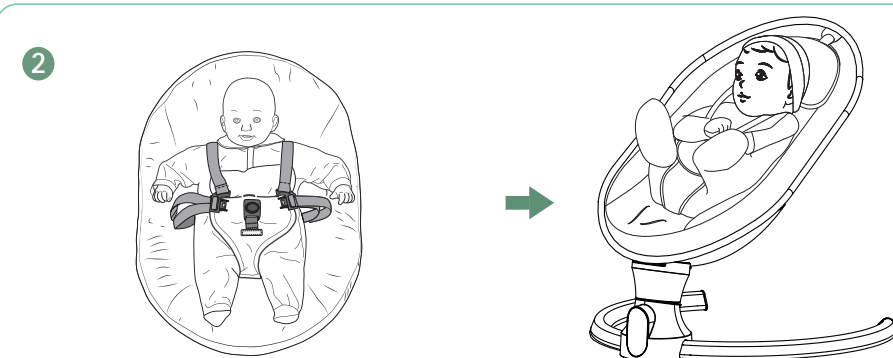

To secure and adjust the seat belts :

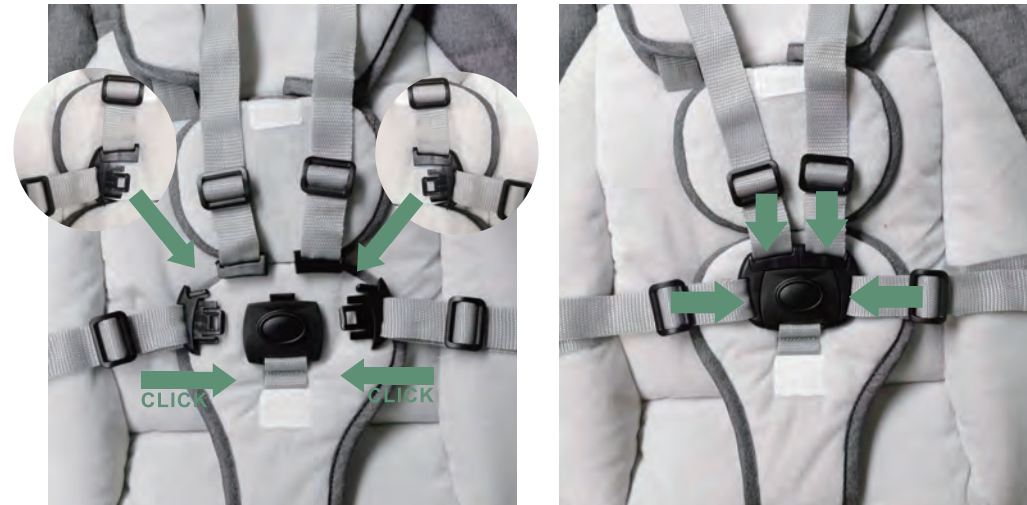

Note : Be sure to use the safety belt correctly when your baby lie on the baby swing for the safety of your child.

Operating Introduction

(1) Operation Panel Control :

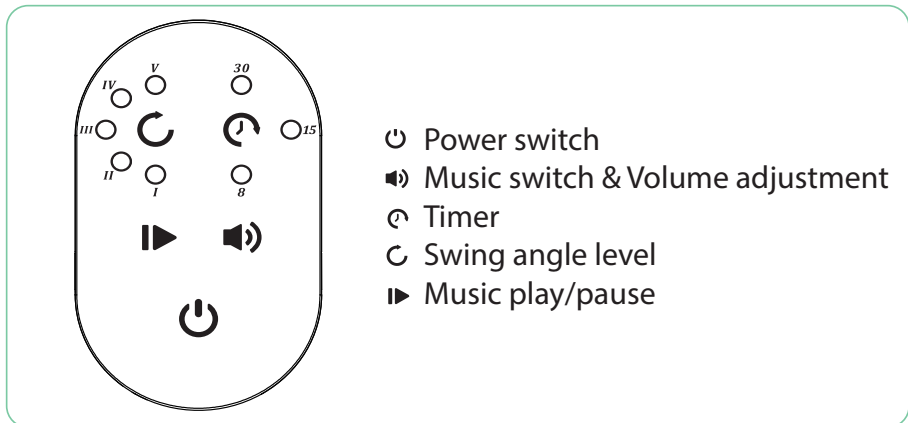

- Power switch:** After the electric swing is connected to the power supply, touch the button to turn it on, and touch it again to turn it off.
- Music switch & Volume adjustment:** Touch the button for 1 second to adjust the volume, and touch for 2-3 seconds to play the next song.
- Timer:** Touch the button once to set the timer for 8 mins, twice for 15 mins, three times for 30 mins. The 3 indicator lights correspond to the timer time in sequence: 8, 15 and 30 mins.
- Swing angle level:** Touch the button to switch the swing angle levels, increasing from I to V. The 5 indicator lights correspond to 5 levels: 0-0°, I-18°, II-21°, III-23°, IV-25° and V-31°. The maximum angle reaches 31° when the swing is unloaded, and the actual angle will decrease as the load increases.
- Music play/pause:** Touch the button to play the built-in music, and touch again to stop the music.

(2) Phone Control

1. Turn on Bluetooth in the mobile phone and connect to "BT-BABY2". After successful connection, songs can be played from the mobile phone;

2. Scan the following QR code to download and install the app for iOS or Android system, then follow the app instructions to use the electric swing.



iOS APP



Google APP

(3) Remote Control

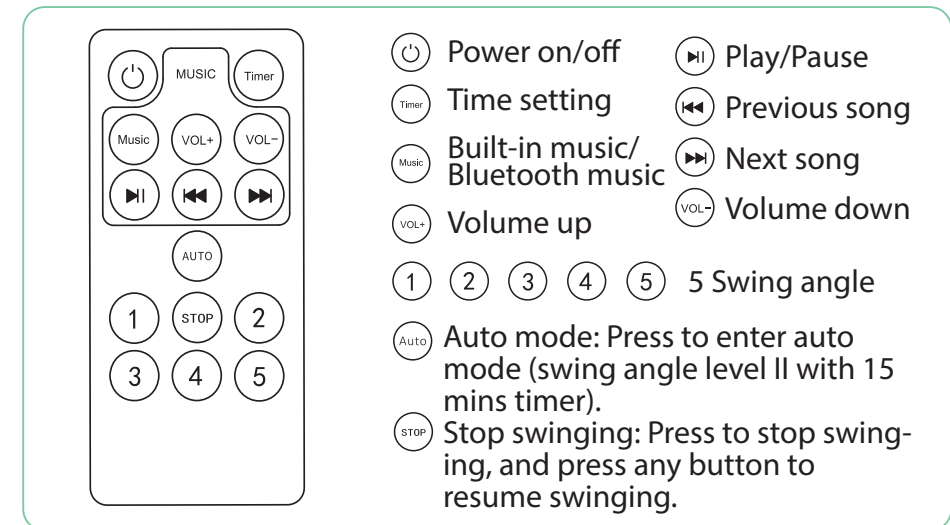

(4) Motion Lock

- Push the motion lock inward to lock the seat frame and stop the motion.
- Pull the motion outward to unlock the seat frame and the baby swing will swing again.

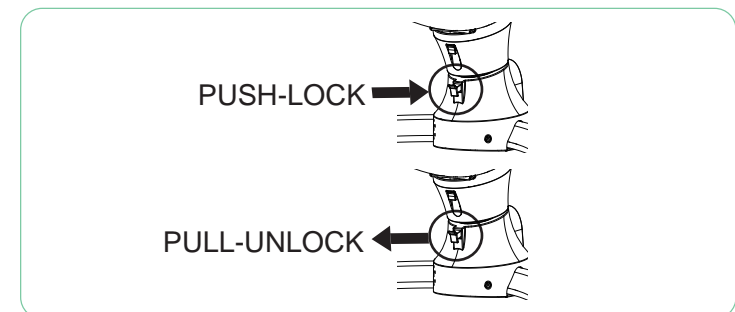

! WARNING

FALL and STRANGULATION HAZARDS :

Infants have suffered head injuries falling from product and have strangled in straps.

FALL HAZARD : Children have suffered head injuries falling from product.

● **ALWAYS** use restraints. Adjust to fit snugly.

● **STOP** using product when baby starts trying to sit up or has reached 20 lb, whichever comes first (approximately 6 months)

● Stay near and watch baby during use. This product is not safe for sleep or unsupervised use. If baby falls asleep, remove baby as soon as possible and place baby on a firm, flat sleep surface such as a crib or bassinet.

FALL HAZARD : Children have suffered head injuries falling from product.

● **ALWAYS** use restraints. Adjust to fit snugly.

● **NEVER** lift or carry baby in product.

● **STOP** using product when baby starts trying to sit up or has reached 9KG, whichever comes first.

● The upright position is only for children who have developed enough upper body control to sit up without tipping forward.

● **ALWAYS** place product on floor. Never use on any elevated surface.

SUFFOCATION HAZARD : Babies have suffocated when seats tipped over on soft surfaces.

● **NEVER** use on a bed, sofa, cushion, or other soft surface.

● Stay near and watch baby during use. This product is not safe for sleep or unsupervised use.

If baby falls asleep, remove baby as soon as possible and place baby on a firm, flat sleep surface such as a crib or bassinet.



! WARNING

● **INGESTION HAZARD :** This product contains a button cell or coin battery.

● **DEATH** or serious injury can occur if ingested.

● A swallowed button cell or coin battery can cause **internal Chemical Burns** in as little as 2 hours.

● **KEEP** new and used batteries **OUT OF REACH** of **CHILDREN**.

● **SEEK immediate medical attention** if a battery is suspected to be swallowed or inserted inside any part of the body.



● Remove and immediately recycle or dispose of used batteries according to local regulations and keep away from children. **DO NOT** dispose of batteries in household trash or incinerate.

● Even used batteries may cause severe injury or death.

● Call a local poison control center for treatment information.

● This product contains a CR2025, DC3V coin battery. A coin battery can cause serious internal chemical burns if swallowed.

● Non-rechargeable batteries are not to be recharged.

● **DO** not force discharge, recharge, disassemble, heat above 132F (60°C) or incinerate. Doing so may result in injury due to venting, leakage or explosion resulting in chemical burns.

● Ensure the batteries are installed correctly according to polarity (+ and -).

● Do not mix old and new batteries, different brands or types of batteries, such as alkaline, carbon-zinc, or rechargeable batteries.

● Remove and immediately recycle or dispose of batteries from equipment not used for an extended period of time according to local regulations.

● Always completely secure the battery compartment. If the battery compartment does not close securely, stop using the product, remove the batteries, and keep them away from children.

FCC Compliance Statements

This device complies with Part 15 of the FCC Rules. Operation is subject to the following two conditions :

(1) this device may not cause harmful interference, and
(2) this device must accept any interference received, including interference that may cause undesired operation.
Note: This equipment has been tested and found to comply with the limits for a Class B digital device, pursuant to Part 15 of the FCC Rules. These limits are designed to provide reasonable protection against harmful interference in a residential installation. This equipment generates, uses and can radiate radio frequency energy and, if not installed and used in accordance with the instructions, may cause harmful interference to radio communications. However, there is no guarantee that interference will not occur in a particular installation. If this equipment does cause harmful interference to radio or television reception, which can be determined by turning the equipment off and on, the user is encouraged to try to correct the interference by one or more of the following measures :

- Reorient or relocate the receiving antenna.
- Increase the separation between the equipment and receiver.
- Connect the equipment into an outlet on a circuit different from that to which the receiver is connected.
- Consult the dealer or an experienced radio/TV technician for help.

Caution : Changes or modifications not expressly approved by the party responsible for compliance could void the user's authority to operate the equipment.
This equipment complies with FCC radiation exposure limits set forth for an uncontrolled environment.
This transmitter must not be co-located or operating in conjunction with any other antenna or transmitter. The base bracket should be installed and operated with minimum distance 10cm between the radiator and your body.

Maintenance

1. Clean the base bracket and seat frame with wet cloth and a mild detergent. Dry thoroughly then. Please do not use corrosive cleaner.
2. Removable and washable fabric
 - Seat fabric: Clean it with wet cloth and a mild detergent, and dry it.
 - Canopy: Take it off and put a little cleaner, wash it gently by hands. Rinse it with clean water, and then hang it to dry, avoiding exposure to the sun.
 - Pillow: Tear the Velcro off and take the pillow off. Put a little cleaner, wash it gently by hands, and then rinse it with clean water, hand it avoiding exposure to the sun.
3. Please check this baby swing regularly. Make sure of each part is well connected and well installed. Stop using for poor connection and connect/ install it again if necessary.
4. This product contains electronic components, which shall not be used in water or in a humid environment. Please ensure the product is dry, and store it in a cool and dry place, avoiding direct sunshine for a long time.

Troubleshooting

No.	Problem	Solution
1	The machine cannot start normally	1. Check if the power plug is loose and not fully plugged into the socket. If so, make sure it is properly connected. 2. Check if the power cord is damaged. If so, disconnect it from the power supply and replace it.
2	The power light keeps flashing	The adapter does not match. Please use an adapter with an output voltage of 5V and a current of 1A.
3	The machine cannot swing after normal start-up	Make sure the motion control button is unlocked, as the machine will not swing if it is locked.

Manufacturer(Produced by):

Foshan Besun Technology Co Ltd.

ADD: No.2 Floor 4-5, Yucheng North Road, Xiyong Village, Lunjiao Street, Shunde District, Foshan City, Guangdong, China

If you have any questions about the installation or the product, please feel free to contact us, we will solve your problem right away.

<http://www.smelluck.com>

Mail: smelluck@gmail.com