

J3

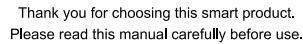

01

Product name	Wireless Bluetooth headset
Wireless version	V5.3
Transmission distance	10 m
Charge Adaptation	DC 5V / 1A
Charging box battery	250mAh
Headphone battery	25mAh
Product bare weight	47.3g
Product size	63*63*27.1mm
Product material	ABS+PC
Charging interface	Type-C

02

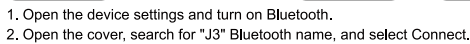

03

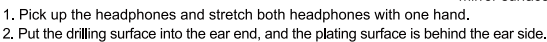

04

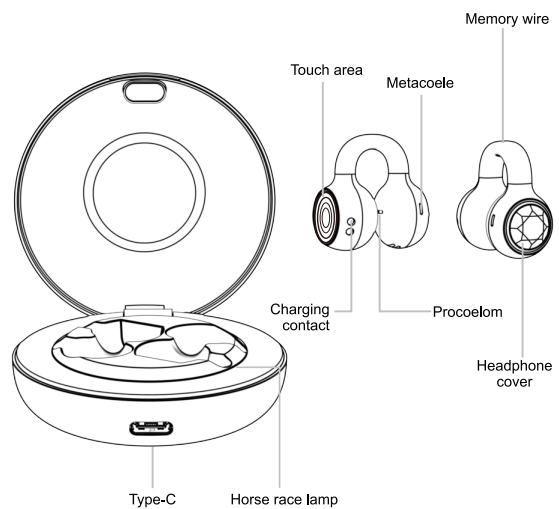

05

Pause play	Click left ear/right ear
Previous song	Double click right ear
Next song	Double click left ear
Voice assistant	Press and hold your left/right ear for 3 seconds
Volume down	Three strikes on the left ear
Volume plus	Three strikes on the right ear
Answer the phone	Click left ear/right ear
Hang up the phone	Click left ear/right ear
Call rejection	When an incoming call comes in, double-click the left/right multifunction key
Power on	Open the charging cover and turn on the earphone in the charging compartment
Power off	Put the earphone into the charging compartment and turn off the charging cover

06

1. When the charging bin is charging, the orange light breathes 5 times (10S) to turn off.
2. When the charging compartment is fully charged, the ice blue light (cold white) is on for 10S and goes out.
3. charging compartment power is insufficient, open the compartment cover, the orange light clockwise rotation three turns off (without headphones), the orange light clockwise rotation three turns off; orange light counterclockwise horse race three turns off (with headphones), after breathing three times off.
4. headphones into the warehouse, light once off, close the warehouse to the headphones charging; ice blue (cold white) light (low battery when the ice orange light) counterclockwise horse race three times, breathing three times off.
5. Earphone charging: Plug in the charging cable, orange light breathing 5 times off.
6. When the headset is fully charged, the ice blue (cold white) light is on for 10S and the light is off.
7. Headphones waiting to be paired; The orange and blue lights flash alternately.
8. When the headphone battery is low, the red light blinks every 5 seconds.

07

1. To minimize the risk of fire or battery damage, do not expose this product to rain or moisture.
2. To reduce the risk of fire, please do not cover this product with flammable materials such as blankets and bedding.
3. To prevent product damage, it is strictly prohibited to disassemble the equipment without permission. For maintenance, please consult the equipment after-sales service department.
4. Do not use the product when it is overheated.
5. Do not use any other battery power supply and accessories other than those specified in this manual.
6. Do not use self-made batteries or modify batteries.

08

This device complies with Part 15 of the FCC Rules. Operation is subject to the following two conditions:

(1) This device may not cause harmful interference, and (2) this device must accept any interference received, including interference that may cause undesired operation.

NOTE 1: This equipment has been tested and found to comply with the limits for a Class B digital device, pursuant to part 15 of the FCC Rules. These limits are designed to provide reasonable protection against harmful interference in a residential installation. This equipment generates, uses and can radiate radio frequency energy and, if not properly installed and used, may cause harmful interference to radio communications. However, there is no guarantee that interference will not occur in a particular installation. If this equipment does cause harmful interference to radio or television reception, which can be determined by turning the equipment off, the user is encouraged to try to correct the interference by one or more of the following measures:

- Reorient or relocate the receiving antenna.
- Increase the separation between the equipment and receiver.
- Connect the equipment into an outlet on a circuit different from that to which the receiver is connected.
- Consult the dealer or an experienced radio/TV technician for help.

NOTE 2: Any changes or modifications to this unit not expressly approved by the party responsible for compliance could void the user's authority to operate the equipment.

The device has been evaluated to meet general RF exposure requirement. The device can be used in portable exposure condition without restriction.